

Senny L. Foust
DEPUTY OIL & GAS INSPECTOR

MAY 04 1998

JICARILLA APACHE TRIBE
ENVIRONMENTAL PROTECTION OFFICE
P.O. BOX 507
DULCE, NEW MEXICO 87528

CA 424
SUBMIT 1 COPY TO
NATURAL RESOURCE DEPT
AND OIL & GAS ADMINISTRATION

PIT REMEDIATION AND CLOSURE REPORT

Approved

Operator: CONOCO, INC. Telephone: (505) 324-5884
Address: 3315 Bloomfield Hwy., Farmington, NM 87401
Facility or Well Name: AXI APACHE J #21
Location: Unit or Qtr/Qtr Sec I Sec S T2S R5W County RIO ARriba
Pit Type: Separator ☒ Dehydrator ☐ Other ☐
Land Type: RANGE

Pit Location: Pit dimensions: length 34', width 32', depth 19'
(Attach diagram) Reference: wellhead ☒, other ☐
Footage from reference: 125'
Direction from reference: 62 Degrees ☐ East ☐ North ☒ West ☒ South

Depth To Groundwater: (Vertical distance from contaminants to seasonal high water elevation of groundwater)	Less than 50 feet (20 points) 50 feet to 99 feet (10 points) Greater than 100 feet (0 points)	<u>0</u>
Distance to an Ephemeral Stream (Downgradient dry wash greater than ten feet in width)	Less than 100 feet (10 points) Greater than 100 feet (0 points)	<u>0</u>
Distance to Nearest Lake, Playa, or Watering Pond (Downgradient lakes, playas and livestock or wildlife watering ponds)	Less than 100 feet (10 points) Greater than 100 feet (0 points)	<u>0</u>
Wellhead Protection Area: (Less than 200 feet from a private domestic water source, or: less than 1000 feet from all other water sources)	Yes (20 points) No (0 points)	<u>0</u>
Distance To Surface Water: (Horizontal distance to perennial lakes, ponds, rivers, streams, creeks, irrigation canals and ditches)	Less than 100 feet (20 points) 100 feet to 1000 feet (10 points) Greater than 1000 feet (0 points)	<u>0</u>

RANKING SCORE (TOTAL POINTS): 0

CA424

Date Remediation Started: _____ Date Completed: 8/29/96

Remediation Method: Excavation ☒ Approx. cubic yards 500
(check all appropriate sections) Landfarmed ☒ Insitu Bioremediation _____
Other _____

Remediation Location: Onsite ☒ Offsite _____
(i.e. landfarmed onsite, name and location of offsite facility)

General Description of Remedial Action: ExcavationGroundwater Encountered: No ☒ Yes _____ Depth _____

Final Pit: Sample location see Attached Documents
Closure Sampling: _____
(if multiple samples, attach sample results and diagram of sample locations and depths)

Sample depth 19'Sample date 8/29/96 Sample time 1035

Sample Results

Soil: Benzene	(ppm)	_____	Water: Benzene	(ppb)	_____
Total BTEX	(ppm)	_____	Toluene	(ppb)	_____
Field Headspace	(ppm)	<u>0.0</u>	Ethylbenzene	(ppb)	_____
TPH	(ppm)	<u>52</u>	Total Xylenes	(ppb)	_____

Groundwater Sample: Yes _____ No ☒ (If yes, attach sample results)

I HEREBY CERTIFY THAT THE INFORMATION ABOVE IS TRUE AND COMPLETE TO THE BEST OF MY KNOWLEDGE AND BELIEF

DATE 8/29/96 PRINTED NAME Jeffrey C. Blagg, P.E. #11607SIGNATURE Jeffrey C. Blagg AND TITLE President

AFTER REVIEW OF THE PIT CLOSURE INFORMATION, PIT CLOSURE IS APPROVED IN ACCORDANCE TO THE JICARILLA APACHE TRIBE PIT CLOSURE ORDINANCE.

APPROVED: YES ☒ NO _____ (REASON) _____SIGNED: Kenn C. Mamm DATE: 8-29-96

CLIENT: <u>CONOCO</u>	BLAGG ENGINEERING, INC. P.O. BOX 87, BLOOMFIELD, NM 87413 (505) 632-1199	LOCATION NO: <u>CA924</u> C.O.C. NO: _____
-----------------------	--------------------------------------------------------------------------------	-----------------------------------------------

FIELD REPORT: CLOSURE VERIFICATION	PAGE No: <u>1</u> of <u>1</u>
------------------------------------	-------------------------------

LOCATION: NAME: <u>AXI APACHE</u> WELL #: <u>21</u> PIT: <u>SEP</u> QUAD/UNIT: <u>I</u> SEC: <u>5</u> TWP: <u>25N</u> RNG: <u>5W</u> PM: <u>NM</u> CNTY: <u>RA</u> ST: <u>NM</u> QTR/FOOTAGE: <u>NE/4</u> <u>SE/4</u> CONTRACTOR: <u>ACME/GARZA</u>	DATE STARTED: <u>8/29/96</u> DATE FINISHED: _____ ENVIRONMENTAL SPECIALIST: <u>NV</u>
-----------------------------------------------------------------------------------------------------------------------------------------------------------------------------------------------------------------------------------------------------------	---------------------------------------------------------------------------------------------

EXCAVATION APPROX. <u>34</u> FT. x <u>32</u> FT. x <u>19</u> FT. DEEP. CUBIC YARDAGE: <u>500</u>
DISPOSAL FACILITY: <u>ON-SITE</u> REMEDIATION METHOD: <u>LANDFARMED</u>
LAND USE: <u>RANGE</u> LEASE: <u>CONTRACT #147</u> FORMATION: _____

FIELD NOTES & REMARKS:	PIT LOCATED APPROXIMATELY <u>125</u> FT. <u>562W</u> FROM WELLHEAD. DEPTH TO GROUNDWATER: <u>>100'</u> NEAREST WATER SOURCE: <u>>1000'</u> NEAREST SURFACE WATER: <u>>1000'</u> NMDCD RANKING SCORE: <u>0</u> NMDCD TPH CLOSURE STD: <u>5000</u> PPM
SOIL AND EXCAVATION DESCRIPTION:	CHECK ONE: <input type="checkbox"/> PIT ABANDONED <input checked="" type="checkbox"/> STEEL TANK INSTALLED

SIDEWALLS: PALE ORANGE TO OK. YELL. ORANGE SAND / NON-COHESIVE SLIGHTLY MOIST, FIRM, NO APPARENT HC ODOR IN ANY OF THE OVM SAMPLES, NO STAINING OBSERVED ON ANY OF THE SIDEWALLS.

BOTTOM: LT GRAY CLAY SLIGHTLY PLASTIC, SLIGHTLY MOIST, STIFF TO VERY STIFF, NO APPARENT HC ODOR IN OVM SAMPLE

FIELD 418.1 CALCULATIONS

TIME	SAMPLE I.D.	LAB No:	WEIGHT (g)	mL. FREON	DILUTION	READING	CALC. ppm
1035	⑤ @ 19'	TM-1813	5	20	1:1	13	52

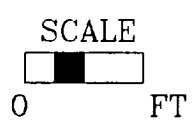

PIT PERIMETER

OVM RESULTS

PIT PROFILE

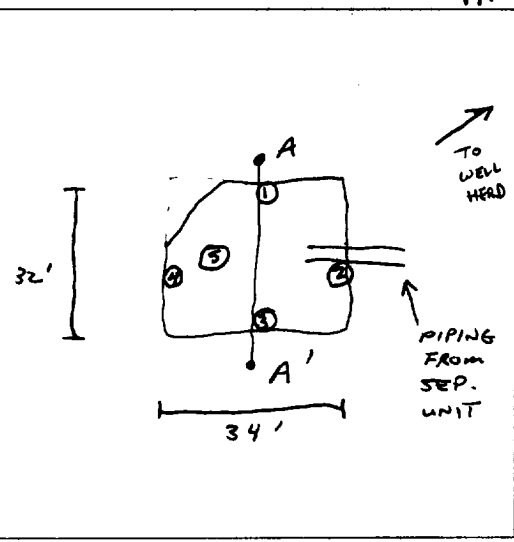

SAMPLE ID	FIELD HEADSPACE PID (ppm)
1 @ 15'	0.0
2 @ 15'	0.0
3 @ 15'	0.0
4 @ 14'	0.0
5 @ 19'	0.0

LAB SAMPLES		
SAMPLE ID	ANALYSIS	TIME

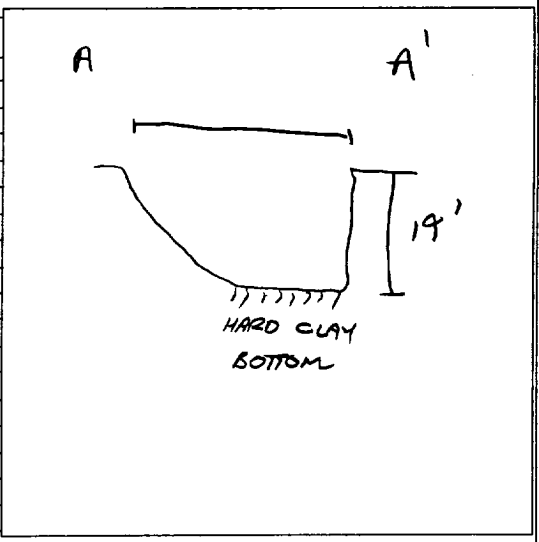

TRAVEL NOTES: CALLOUT: <u>8/29/96 MORN.</u> ONSITE: <u>8/29/96 MORN.</u>

BLAGG ENGINEERING, INC.

P.O. Box 87, Bloomfield, New Mexico 87413

Phone: (505)632-1199 Fax: (505)632-3903

**FIELD MODIFIED EPA METHOD 418.1
TOTAL PETROLEUM HYDROCARBONS**

Client:	CONOCO	Project #:	
Sample ID:	5 @ 19'	Date Analyzed:	08-29-96
Project Location:	AXI Apache J #21	Date Reported:	08-29-96
Laboratory Number:	TPH-1813	Sample Matrix:	Soil

Parameter	Result, mg/kg	Detection Limit, mg/kg
-----	-----	-----
Total Recoverable Petroleum Hydrocarbons	52	20

ND = Not Detectable at stated detection limits.

QA/QC:	QA/QC Sample TPH mg/kg	Duplicate TPH mg/kg	% *Diff.
	-----	-----	-----
	1420	1344	5.50

*Administrative Acceptance limits set at 30%.

Method: Modified Method 418.1, Petroleum Hydrocarbons, Total
Recoverable, Chemical Analysis of Water and Waste,
USEPA Storet No.4551, 1978

Comments: Separator Pit - CA424

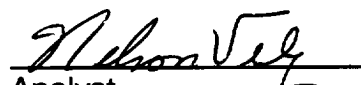
Analyst

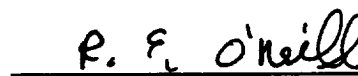
Review

CA424

**JICARILLA APACHE TRIBE
ENVIRONMENTAL PROTECTION OFFICE
P.O. BOX 507
DULCE, NEW MEXICO 87528**

SUBMIT 1 COPY TO
NATURAL RESOURCE DEPT
AND OIL & GAS ADMINISTRATION

ON-SITE SOIL REMEDIATION REPORT

Operator: Conoco, Inc. **Telephone:** (505) 324-5884
Address: 3315 Bloomfield Hwy., Farmington, NM 87401
Facility or Well Name: AXI APACHE J #21
Location: Unit or Qtr/Qtr Sec I Sec 5 T~~Z~~SN R~~S~~W County RIO ARriba
Land Type: RANGE

Date Remediation Started: 8/29/96 **Date Completed:** 8/22/97
Remediation Method: Landfarmed X Approx. cubic yards 500
Composted _____
Other _____

Depth To Groundwater: (pts.) 0
Distance to an Ephemeral Stream (pts.) 0
Distance to Nearest Lake, Playa, or Watering Pond (pts.) 0
Wellhead Protection Area: (pts.) 0
Distance To Surface Water: (pts.) 0
RANKING SCORE (TOTAL POINTS): 0

Final Closure Sampling:
Sampling Date: 8/20/97 **Time:** 0815
Sample Results:
Field Headspace (ppm) 0.0
TPH (ppm) 34.9 **Method** 8015
Other _____

I HEREBY CERTIFY THAT THE INFORMATION ABOVE IS TRUE AND COMPLETE TO THE BEST OF MY KNOWLEDGE AND BELIEF

DATE 8/22/97 **PRINTED NAME** Jeffrey C. Blagg, P.E. #11607
SIGNATURE Jeffrey C. Blagg **AND TITLE** President

AFTER REVIEW OF THE SOIL REMEDIATION INFORMATION, ON-SITE REMEDIATION IS APPROVED IN ACCORDANCE TO THE JICARILLA APACHE TRIBE PIT CLOSURE ORDINANCE.

APPROVED: YES X NO _____ (REASON) _____

SIGNED: Kevin C. Mammill **DATE:** 9-2-97

CLIENT: CONOCOBLAGG ENGINEERING, INC.
P.O. BOX 87, BLOOMFIELD, NM 87413
(505) 632-1199LOCATION NO: CA424C.O.C. NO: 5389

FIELD REPORT: LANDFARM/COMPOST PILE CLOSURE VERIFICATION

LOCATION: NAME: AXI APACHE J WELL #: 21 PITS: SEPDATE STARTED: 8/20/97QUAD/UNIT: I SEC: 5 TWP: 25N RNG: 5W PM: Nm CNTY: RA ST: Nm

DATE FINISHED: _____

QTR/FOOTAGE: NE 1/4 SE 1/4 CONTRACTOR: ACMEENVIRONMENTAL
SPECIALIST: NV

SOIL REMEDIATION:

REMEDICATION SYSTEM: LANDFARMEDAPPROX. CUBIC YARDAGE: 500LAND USE: RANGELIFT DEPTH (ft): 12"-24"

FIELD NOTES & REMARKS:

DEPTH TO GROUNDWATER: >100' NEAREST WATER SOURCE: >1000' NEAREST SURFACE WATER: >1000'NMOC PARKING SCORE: 0 NMOC TPH CLOSURE STD: 5000 PPM

MOSTLY DK. YELL. BROWN SAND, NON COHESIVE, SLIGHTLY MOIST, FIRM,
NO APPARENT DISCOLORATION OBSERVED IN ANY OF THE SAMPLE PTS, NO
APPARENT HC ODOR IN DUM SAMPLE, 5 PT. COMPOSITE
COLLECTED FOR LAB ANALYSIS.

CLOSED

FIELD 418.1 CALCULATIONS

SAMP. TIME	SAMPLE I.D.	LAB No:	WEIGHT (g)	mL. FREON	DILUTION	READING	CALC. ppm

SKETCH/SAMPLE LOCATIONS

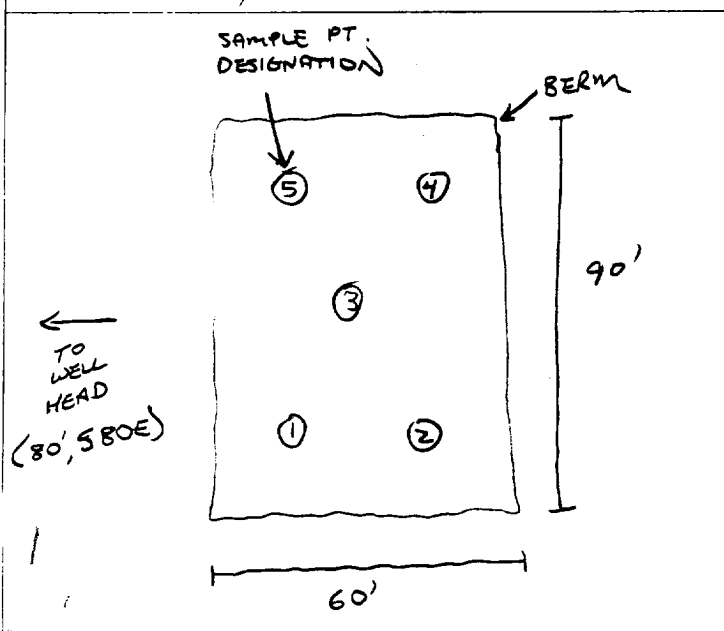

OVM RESULTS

LAB SAMPLES

SAMPLE ID	FIELD HEADSPACE PID (ppm)	SAMPLE ID	ANALYSIS	TIME	RESULTS
LF-1	0.0	LF-1	TPH (8015)	0815	34.9

SCALE



0 FT

TRAVEL NOTES:

CALLOUT: NAONSITE: 8/20/97

ENVIROTECH LABS

PRACTICAL SOLUTIONS FOR A BETTER TOMORROW

EPA METHOD 8015 Modified Nonhalogenated Volatile Organics Total Petroleum Hydrocarbons

Client:	Blagg / Conoco	Project #:	04034-10
Sample ID:	LF - 1	Date Reported:	08-21-97
Laboratory Number:	B905	Date Sampled:	08-20-97
Chain of Custody No:	5389	Date Received:	08-20-97
Sample Matrix:	Soil	Date Extracted:	08-20-97
Preservative:	Cool	Date Analyzed:	08-21-97
Condition:	Cool and Intact	Analysis Requested:	8015 TPH

Parameter	Concentration (mg/Kg)	Det. Limit (mg/Kg)
Gasoline Range (C5 - C10)	6.3	0.2
Diesel Range (C10 - C28)	28.6	0.1
Total Petroleum Hydrocarbons	34.9	0.2

ND - Parameter not detected at the stated detection limit.

References: Method 8015, Nonhalogenated Volatile Organics, Test Methods for Evaluating Solid Waste, SW-846, USEPA, July 1992.

Comments: AXI APACHE J #21 Landfarm. 5 pt. Composite.

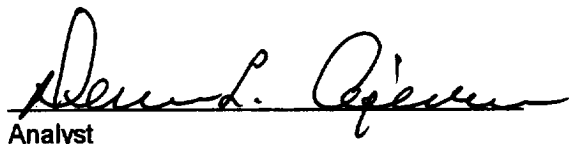
Analyst

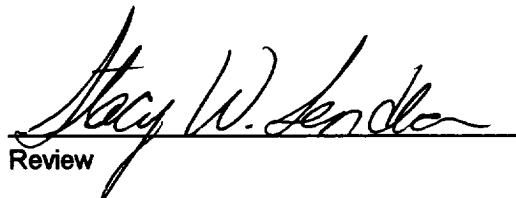
Review

ENVIROTECH INC.