

Denny G. Frost
DEPUTY OIL & GAS INSPECTOR

FEB 08 1999

JICARILLA APACHE TRIBE

ENVIRONMENTAL PROTECTION OFFICE

P.O. BOX 507
DULCE, NEW MEXICO 87528

SUBMIT 1 COPY TO
NATURAL
RESOURCE DEPT
AND OIL-GAS
ADMINISTRATION

Approved
PIT REMEDIATION AND CLOSURE REPORT

Operator: PNM Gas Services (Conoco) Telephone: 324-3764

Address: 603 W. Elm Street Farmington, NM 87401

Facility or Well Name: Axi Apache J-23

Location: Unit: D Sec. 8 T. 25 N R. 5 W County Rio Arriba

Pit Type: Separator ☒ Dehydrator ☐ Other ☐

Land Type: Jicarilla Apache

Pit Location: Pit dimensions: length 20' width 20' depth 3'

(Attach diagram) Reference: wellhead ☒ other ☐

Footage from reference: 108'

Direction from reference: 45 Degrees ☒ East ☒ North ☐ South
of
West

Depth to Ground Water:

(Vertical distance from contaminants to seasonal high water elevation of ground water)

Less than 50 feet (20 points)
50 feet to 99 feet (10 points)
Greater than 100 feet (0 points)

0

Wellhead Protection Area:

(Less than 200 feet from a private domestic water source, or, less than 1,000 feet from all other water sources)

Yes (20 points)
No (0 points)

0

Distance to Surface Water:

(Horizontal distance to perennial lakes, ponds, rivers, streams, creeks, irrigation canals and ditches)

Less than 200 feet (20 points)
200 feet to 1,000 feet (10 points)
Greater than 1,000 feet (0 points)

0

Distance to Ephemeral Stream (dry wash):

(Horizontal distance to all downgradient streams having a width of at least 10 feet)

Less than or equal to 100 feet (10 points)
Greater than 100 feet (0 points)

0

Distance to Nearest Lake, Playa, or Watering Pond:

(Horizontal distance to all downgradient lakes, playas, and livestock or wildlife water ponds)

Less than or equal to 100 feet (10 points)
Greater than 100 feet (0 points)

0

RANKING SCORE (TOTAL POINTS):

0

Date Remediation Started: 7/20/98 Date Completed: 11/2/98

Remediation Method: Excavation X Approx. Cubic Yards 200

(Check all appropriate sections)

Landfarmed X Amount Landfarmed (cubic yds): 200

Other _____

Remediation Location: Onsite X Offsite _____

(i.e., landfarmed onsite, name and location of offsite facility)

General Description of Remedial Action:

Removed Contaminated Soil from all four side walls as to get a below 100ppm headspace reading. Pit bottom is sandstone rock 3PT Composite of PIT bottom
EXCAVATION SIZE 24'X25'X9'

Ground Water Encountered: No X Yes _____ Depth _____

Final Pit Closure Sampling:

Sample Location North, East, South, West Side walls and Pit bottom

(if multiple samples, attach sample result and diagram of sample locations and depths.)

Sample depth 9'

Sample date 7/20/98 Sample time 1051

Sample Results

Soil: Benzene (ppm) ND Water: Benzene (ppb) _____

Total BTEX (ppm) 196 Toluene (ppb) _____

Field headspace (ppm) 952 Ethylbenzene (ppb) _____

TPH 38 ppm Method 8015 Total Xylenes (ppb) _____

Ground Water Sample: Yes _____ No X (If yes, attach sample results)

I HEREBY CERTIFY THAT THE INFORMATION ABOVE IS TRUE AND COMPLETE TO THE BEST OF MY KNOWLEDGE AND MY BELIEF

DATE 7/28/98 PRINTED NAME Roy Burnham

SIGNATURE Roy Burnham AND TITLE Environmental Technician II

AFTER REVIEW OF THE PIT CLOSURE INFORMATION, PIT CLOSURE IS APPROVED IN ACCORDANCE TO JICARILLA APACHE TRIBE PIT CLOSURE ORDINANCE.

APPROVED: YES X NO _____ (REASON): _____

SIGNED: Ken C. Marshall DATE: 7-28-98

Ax1 Hpache J-23
Sec 8 T25N R5W unit D
Conoco

Site Drawing

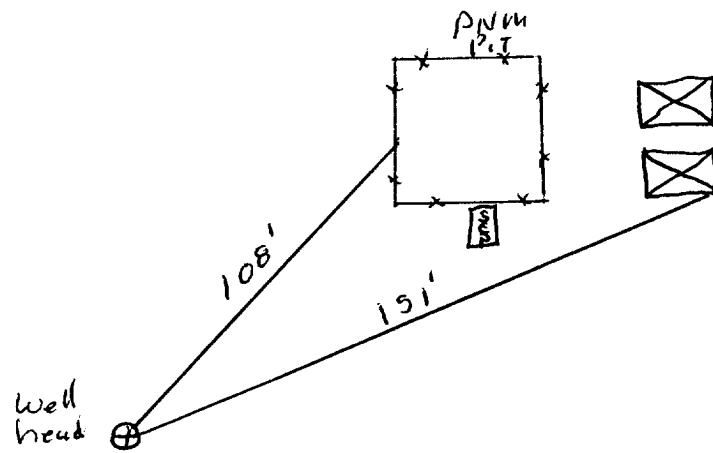

Hx1 HPACne J-LS
ec-8 T25N R5W unit (D)
CONOCO

EXCAVATION DRAWING

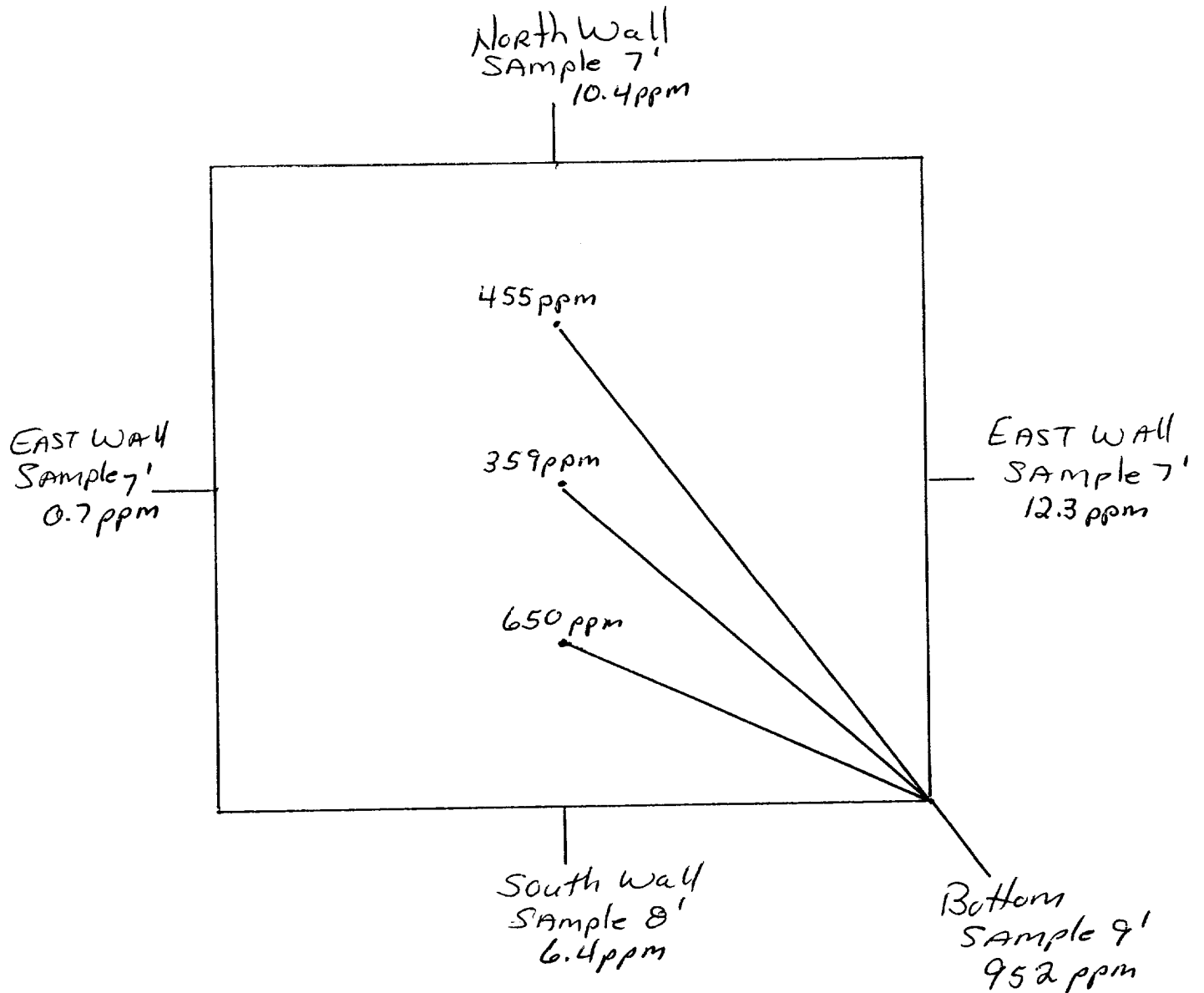

OFF: (505) 325-5667

ON SITE
TECHNOLOGIES, LTD.

LAB: (505) 325-1556

Date: 28-Jul-98

On Site Technologies, LTD.

CLIENT: PNM - Public Service Company of NM
Project: PNM Pit Remediation
Lab Order: 9807061

CASE NARRATIVE

Samples were analyzed using the methods outlined in the following references:

Test Methods for Evaluating Solid Waste, Physical/Chemical Methods, SW846, 3rd Edition

All method blanks, laboratory spikes, and/or matrix spikes met quality assurance objectives.

OFF: (505) 325-5667



LAB: (505) 325-1556

ANALYTICAL REPORT

Date: 28-Jul-98

Client:	PNM - Public Service Company of NM	Client Sample Info:	Axi Apache J-23
Work Order:	9807061	Client Sample ID:	9807201051; 3pt. Comp. Bottom
Lab ID:	9807061-04A	Matrix:	SOIL
Project:	PNM Pit Remediation	Collection Date:	7/20/98 10:51:00 AM
		COC Record:	7067

Parameter	Result	PQL	Qual	Units	DF	Date Analyzed
DIESEL RANGE ORGANICS		SW8015				Analyst: HR
T/R Hydrocarbons: C10-C28	38	25		mg/Kg	1	7/24/98
BTEX		SW8020A				Analyst: HR
Benzene	ND	2		µg/Kg	2	7/23/98
Toluene	10	4		µg/Kg	2	7/23/98
Ethylbenzene	21	2		µg/Kg	2	7/23/98
m,p-Xylene	130	4		µg/Kg	2	7/23/98
o-Xylene	35	2		µg/Kg	2	7/23/98

196
•196 ppm

Qualifiers:

PQL - Practical Quantitation Limit
ND - Not Detected at Practical Quantitation Limit
J - Analyte detected below Practical Quantitation Limit
B - Analyte detected in the associated Method Blank

S - Spike Recovery outside accepted recovery limits
R - RPD outside accepted recovery limits
E - Value above quantitation range
Surr: - Surrogate

P.O. BOX 2606 • FARMINGTON, NM 87499

1 of 1

OFF: (505) 325-5667



LAB: (505) 325-1556

ANALYTICAL REPORT

Date: 28-Jul-98

Client:	PNM - Public Service Company of NM	Client Sample Info:	Axi Apache J-23
Work Order:	9807061	Client Sample ID:	9807201050; 4pt. Comp. Walls
Lab ID:	9807061-03A	Matrix:	SOIL
Project:	PNM Pit Remediation	Collection Date:	7/20/98 10:50:00 AM
		COC Record:	7067

Parameter	Result	PQL	Qual	Units	DF	Date Analyzed
DIESEL RANGE ORGANICS		SW8015				Analyst: HR
T/R Hydrocarbons: C10-C28	32	25		mg/Kg	1	7/24/98

Qualifiers:

PQL - Practical Quantitation Limit
ND - Not Detected at Practical Quantitation Limit
J - Analyte detected below Practical Quantitation Limit
B - Analyte detected in the associated Method Blank

S - Spike Recovery outside accepted recovery limits
R - RPD outside accepted recovery limits
E - Value above quantitation range
Surr: - Surrogate

1 of 1

P.O. BOX 2606 • FARMINGTON, NM 87499

Environmental Sciences, Inc. is an Equal Opportunity Employer.

JICARILLA APACHE TRIBE
ENVIRONMENTAL
PROTECTION OFFICE
P.O. BOX 507
DULCE, NEW MEXICO 87528

SUBMIT 1 COPY TO
NATURAL
RESOURCE DEPT
AND OIL-GAS
ADMINISTRATION

ON-SITE SOIL REMEDIATION REPORT

Operator: PNM Gas Services (Conoco) Telephone: 324-3764
Address: 603 W. Elm Street Farmington, NM 87401
Facility or Well Name: Ax, Apache J-23
Location: Unit: D Sec. 8 T. 25 N R. 5 W County Rio Arriba
Land Type: Jicarilla Apache

Date Remediation Started: 7/20/98 Date Completed: 10/8/98
Remediation Method: Landfirmed X Approx. cubic yards 200
Composted
Other

Depth to Ground Water: (pts.) Ø
Distance to an Ephemeral Stream: (pts.) Ø
Distance to Nearest Lake, Playa,
or Watering Pond: (pts.) Ø
Wellhead Protection Area: (pts.) Ø
Distance to Surface Water: (pts.) Ø
Ranking Score (Total Points): Ø

Final Closure Sampling:

Sampling Date: 9/30/98 Time 1630
Sampling Results:
Field Headspace (ppm) 0.9
TPH (ppm) 64 Method 8015
Other

I HEREBY CERTIFY THAT THE INFORMATION ABOVE IS TRUE AND COMPLETE TO THE BEST OF MY KNOWLEDGE AND BELIEF

DATE 10/25/98 PRINTED NAME Roy Burnham
SIGNATURE Roy Burnham AND TITLE Environmental Technician II

AFTER REVIEW OF THE SOIL REMEDIATION INFORMATION, ON-SITE REMEDIATION APPROVED IN ACCORDANCE TO THE
JICARILLA APACHE TRIBE PIT CLOSURE ORDINANCE

APPROVED: YES X NO (REASON) use as Backfill

SIGNED: Kenn C Marshall DATE: 11-2-98

Ax1 Apache J-23
Sec-8 T-25N R-5W UNIT D
Conoco

LAND FARM DRAWING

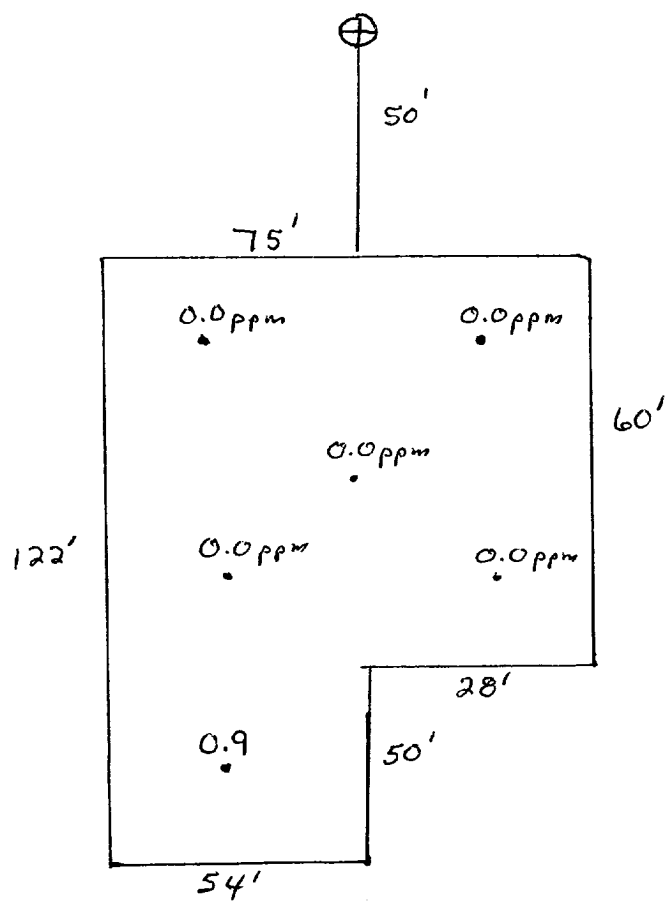

OFF: (505) 325-5667



LAB: (505) 325-1556

ANALYTICAL REPORT

Date: 14-Oct-98

Client:	PNM - Public Service Company of NM	Client Sample Info:	Axi Apache J-23 LF
Work Order:	9810006	Client Sample ID:	9809301630; 6pt. Composite
Lab ID:	9810006-03A	Matrix:	SOIL
Project:	Jicarilla Landfarms	Collection Date:	9/30/98 4:30:00 PM
		COC Record:	7510

Parameter	Result	PQL	Qual	Units	DF	Date Analyzed
DIESEL RANGE ORGANICS		SW8015				Analyst: DC
T/R Hydrocarbons: C10-C28	64	25		mg/Kg	1	10/8/98

Qualifiers:

- PQL - Practical Quantitation Limit
- ND - Not Detected at Practical Quantitation Limit
- J - Analyte detected below Practical Quantitation Limit
- B - Analyte detected in the associated Method Blank

- S - Spike Recovery outside accepted recovery limits
- R - RPD outside accepted recovery limits
- E - Value above quantitation range
- Surr: - Surrogate

1 of 1

P.O. BOX 2606 • FARMINGTON, NM 87499

- TECHNOLOGY BLENDING INDUSTRY WITH THE ENVIRONMENT -