

UNITED STATES  
DEPARTMENT OF THE INTERIOR  
GEOLOGICAL SURVEY

## APPLICATION FOR PERMIT TO DRILL, DEEPEN, OR PLUG BACK

30-039-20568

5. LEASE DESIGNATION AND SERIAL NO.  
**JICARILLA 146 CONTRACT**

6. IF INDIAN, ALLOTTEE OR TRIBE NAME  
**Jicarilla Apache Tribe**

7. UNIT AGREEMENT NAME

8. FARM OR LEASE NAME  
**Jicarilla Contract 146**

9. WELL NO.  
**23**

10. FIELD AND POOL, OR WILDCAT  
**Gonzales Mesa-Otero Chacra**

11. SEC., T., R., M., OR BLK.  
AND SURVEY OR AREA  
**NW/4 NW/4 Section 9,  
T-25-N, R-5-W**

12. COUNTY OR PARISH  
**Rio Arriba**

13. STATE  
**New Mexico**

1a. TYPE OF WORK  
DRILL ☒ DEEPEN ☐ PLUG BACK ☐b. TYPE OF WELL  
OIL WELL ☐ GAS WELL ☒ OTHER ☐ SINGLE ZONE ☐ MULTIPLE ZONE ☒2. NAME OF OPERATOR  
**AMOCO PRODUCTION COMPANY**3. ADDRESS OF OPERATOR  
**501 Airport Drive, Farmington, New Mexico 87401**4. LOCATION OF WELL (Report location clearly and in accordance with any State requirements.)  
At surface  
**870' FNL & 790' FNL, Section 9, T-25N, R-5W**  
At proposed prod. zone  
**Same**

14. DISTANCE IN MILES AND DIRECTION FROM NEAREST TOWN OR POST OFFICE\*

15. DISTANCE FROM PROPOSED\*  
LOCATION TO NEAREST  
PROPERTY OR LEASE LINE, FT.  
(Also to nearest drlg. unit line, if any)  
**300'**16. NO. OF ACRES IN LEASE  
**2557.2**18. DISTANCE FROM PROPOSED LOCATION\*  
TO NEAREST WELL, DRILLING, COMPLETED,  
OR APPLIED FOR, ON THIS LEASE, FT.  
**790'**19. PROPOSED DEPTH  
**5400'**17. NO. OF ACRES ASSIGNED  
TO THIS WELL  
**160**21. ELEVATIONS (Show whether DF, RT, GR, etc.)  
**6737' Gr. (ungraded)**20. ROTARY OR CABLE TOOLS  
**Rotary**  
22. APPROX. DATE WORK WILL START\*  
**October 1972**

## 23. PROPOSED CASING AND CEMENTING PROGRAM

SIZE OF HOLE	SIZE OF CASING	WEIGHT PER FOOT	SETTING DEPTH	QUANTITY OF CEMENT
12-1/4"	8-5/8"	23#	400'	300 sx
7-7/8"	5-1/2"	14#	5400'	700 sx - two stage

Amoco proposes to drill a Mesaverde-Chacra dual well, as described above. The well will be drilled to a TD of 5400' with rotary tools. The production casing will be cemented in two stages with a stage tool set 200' below the Chacra. Second stage cement will cover the Pictured Cliffs. Completion procedure will be determined from open hole logs. Copies of Location and Acreage Dedication Plat are attached. Copies of logs will be submitted upon completion.

IN ABOVE SPACE DESCRIBE PROPOSED PROGRAM: If proposal is to deepen or plug back, give data on present productive zone and proposed new productive zone. If proposal is to drill or deepen directionally, give pertinent data on subsurface locations and measured and true vertical depths. Give blowout preventer program, if any.

24. Original Signed by  
SIGNED **J. ARNOLD SNELL** TITLE **Area Engineer** DATE **Sept. 27, 1972**

(This space for Federal or State office use)

PERMIT NO. APPROVAL DATE

APPROVED BY TITLE DATE

CONDITIONS OF APPROVAL, IF ANY:

\*See Instructions On Reverse Side

U. S. GEOLOGICAL SURVEY  
DURHAM, N.C.

## Instructions

**General:** This form is designed for submitting proposals to perform certain well operations, as indicated, on all types of lands and leases for appropriate action by either a Federal or a State agency, or both, pursuant to applicable Federal and/or State laws and regulations. Any necessary special instructions concerning the use of this form and the number of copies to be submitted, particularly with regard to local, area, or regional procedures and practices, either are shown below or will be issued by, or may be obtained from, the local Federal and/or State office.

**Item 1:** If the proposal is to redrill to the same reservoir at a different subsurface location or to a new reservoir, use this form with appropriate notations. Consult applicable State or Federal regulations concerning subsequent work proposals or reports on the well.

**Item 4:** If there are no applicable State requirements, locations on Federal or Indian land should be described in accordance with Federal requirements. Consult local State or Federal office for specific instructions.

**Item 14:** Needed only when location of well cannot readily be found by road from the land or lease description. A plat, or plats, separate or on this reverse side, showing the roads to, and the surveyed location of, the well, and any other required information, should be furnished when required by Federal or State agency offices.

**Items 15 and 18:** If well is to be, or has been directionally drilled, give distances for subsurface location of hole in any present or objective production zone.

**Item 22:** Consult applicable Federal or State regulations, or appropriate officials, concerning approval of the proposal before operations are started.

**NEW MEXICO OIL CONSERVATION COMMISSION  
WELL LOCATION AND ACREAGE DEDICATION PLAT**

Form O-102  
Supersedes O-120  
Effective 1-1-65

All distances must be from the outer boundaries of the section.

Owner <b>Amoco Production Company</b>			Lease <b>Jicarilla Contract 146</b>		Well No. <b>23</b>
Unit Number <b>0</b>	Section <b>9</b>	Township <b>25N</b>	Range <b>5W</b>	County <b>Rio Arriba</b>	
Actual Location of Well: <b>670</b> feet from the <b>North</b> line and <b>790</b> feet from the <b>West</b> line					
Ground Level Elev. <b>6757 ft ungr.</b>		Producing Formation <b>Mesa Verde-Chacra</b>		Pool <b>Otero Chacra-Gonzales Mesa Pool Fmt.</b>	Dedicated Acreage <b>160</b> Acres

1. Outline the acreage dedicated to the subject well by colored pencil or hatchure marks on the plat below.
2. If more than one lease is dedicated to the well, outline each and identify the ownership thereof (both as to working interest and royalty).
3. If more than one lease of different ownership is dedicated to the well, have the interests of all owners been consolidated by communitization, unitization, force-pooling, etc?

☐ Yes ☐ No If answer is "yes," type of consolidation \_\_\_\_\_

If answer is "no," list the owners and tract descriptions which have actually been consolidated. (Use reverse side of this form if necessary.) \_\_\_\_\_

No allowable will be assigned to the well until all interests have been consolidated (by communitization, unitization, forced-pooling, or otherwise) or until a non-standard unit, eliminating such interests, has been approved by the Commission.

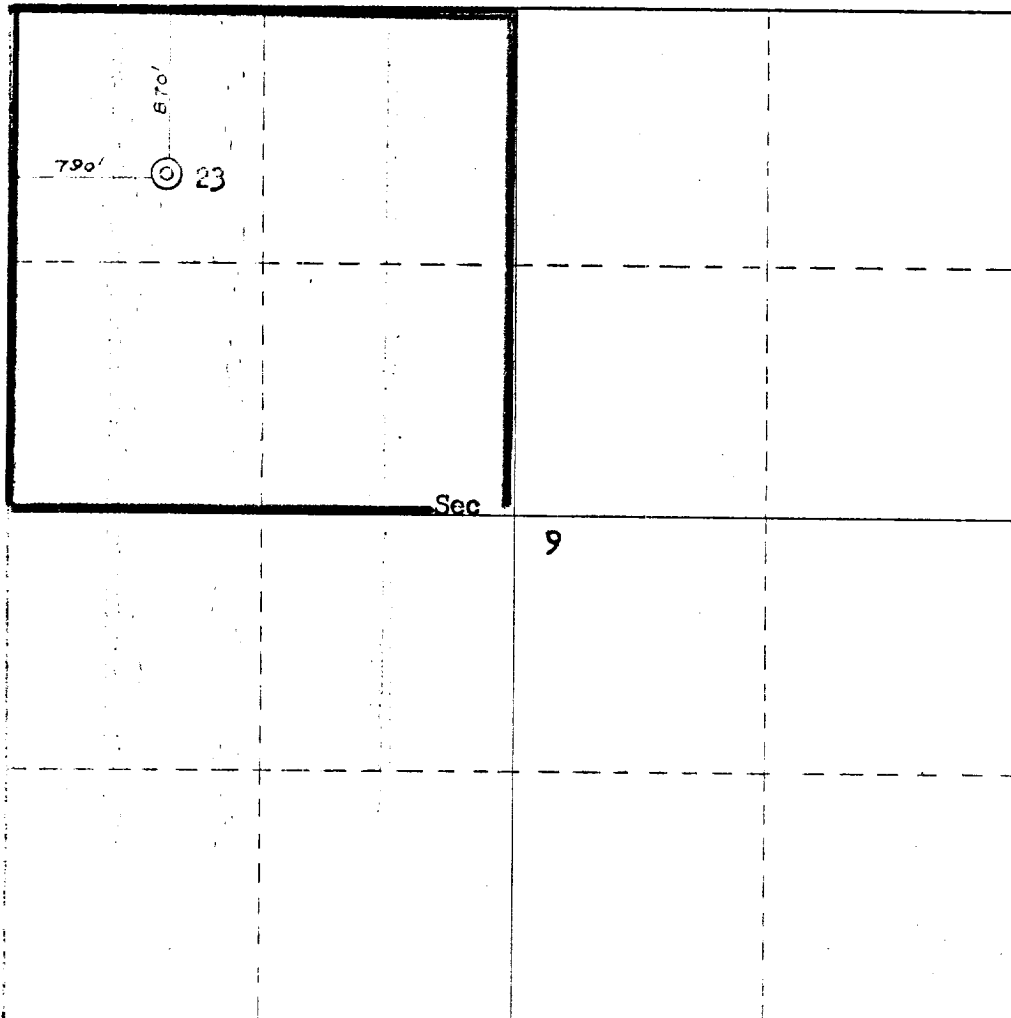
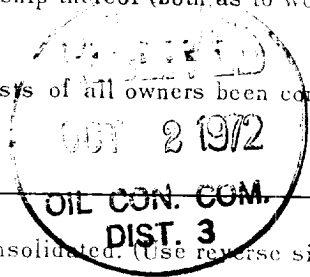

**CERTIFICATION**

I hereby certify that the information contained herein is true and complete to the best of my knowledge and belief:

*J. Arnold Snell*  
Name  
**J. Arnold Snell**  
Position  
**Area Engineer**  
Company  
**AMOCO PRODUCTION COMPANY**

Date  
**September 27, 1972**

I hereby certify that the well location shown on this plat was plotted from field notes of actual surveys made by me or under my supervision, and that the same is true and correct to the best of my knowledge and belief.

Date Surveyed  
**September 22, 1972**  
Registered Information Engineer and Land Surveyor  
*Frank B. Kerr Jr.*  
Cert. No. **3970**

