

30-039-20743

NEW MEXICO OIL CONSERVATION COMMISSION

Form C-101
Revised 1-1-65

NO. OF COPIES RECEIVED	4
DISTRIBUTION	
SANTA FE	1
FILE	1 ✓
U.S.G.S.	2
LAND OFFICE	1
OPERATOR	1

5A. Indicate Type of Lease STATE <input checked="" type="checkbox"/> FEE <input type="checkbox"/>
5. State Oil & Gas Lease No. E-809-15

APPLICATION FOR PERMIT TO DRILL, DEEPEN, OR PLUG BACK

1a. Type of Work b. Type of Well OIL WELL <input type="checkbox"/> GAS WELL <input checked="" type="checkbox"/> OTHER <input type="checkbox"/> DRILL <input checked="" type="checkbox"/> DEEPEN <input type="checkbox"/> PLUG BACK <input type="checkbox"/> SINGLE ZONE <input checked="" type="checkbox"/> MULTIPLE ZONE <input type="checkbox"/>		7. Unit Agreement Name Canyon Largo Unit
2. Name of Operator El Paso Natural Gas Company		8. Farm or Lease Name Canyon Largo Unit
3. Address of Operator PO Box 990, Farmington, NM 87401		9. Well No. 220
4. Location of Well UNIT LETTER I LOCATED 1740 FEET FROM THE South LINE AND 1080 FEET FROM THE East LINE OF SEC. 2 TWP. 24N RGE 7W NMPM		10. Field and Pool, or Wildcat Ballard Pictured Cliffs
		12. County Rio Arriba
		19. Proposed Depth 2405'
		19A. Formation Pictured Cliffs
		20. Rotary or C.T. Rotary
21. Elevations (Show whether DF, RT, etc.) 6676'GL	21A. Kind & Status Plug. Bond Statewide	21B. Drilling Contractor
		22. Approx. Date Work will start

PROPOSED CASING AND CEMENT PROGRAM

SIZE OF HOLE	SIZE OF CASING	WEIGHT PER FOOT	SETTING DEPTH	SACKS OF CEMENT	EST. TOP
12 1/4"	8 5/8"	24.0#	120'	106 cu.ft.	circ.
6 3/4"	2 7/8"	6.4#	2405'	265 cu.ft.	1650'

Selectively perforate and sandwater fracture the Pictured Cliffs formation.

The SE/4 of Section 2 is dedicated to this well.

APPROVAL VALID
FOR 90 DAYS UNLESS
DRILLING COMMENCED,
EXPIRES 11-7-73

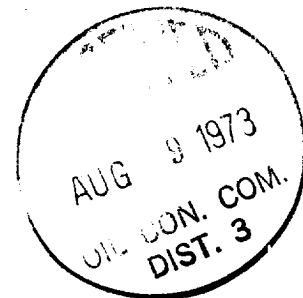

IN ABOVE SPACE DESCRIBE PROPOSED PROGRAM: IF PROPOSAL IS TO DEEPEN OR PLUG BACK, GIVE DATA ON PRESENT PRODUCTIVE ZONE AND PROPOSED NEW PRODUCTIVE ZONE. GIVE BLOWOUT PREVENTER PROGRAM, IF ANY.

I hereby certify that the information above is true and complete to the best of my knowledge and belief.

Signed W. H. Dukes Title Drilling Clerk Date August 9, 1973

(This space for State Use)

APPROVED BY Cecilia Clark TITLE SUPERVISOR DIST. #3 DATE AUG 9 1973

CONDITIONS OF APPROVAL, IF ANY:

**NEW MEXICO OIL CONSERVATION COMMISSION
WELL LOCATION AND ACREAGE DEDICATION PLAT**

Form C-102
Supersedes C-128
Effective 1-1-65

All distances must be from the outer boundaries of the Section.

Operator El Paso Natural Gas Company			Lease Canyon Largo Unit (E-809-15)		Well No. 220
Unit Letter I	Section 2	Township 24N	Range 7W	County Rio Arriba	
Actual Footage Location of Well: 1740 feet from the South line and 1080 feet from the East line					
Ground Level Elev. 6676	Producing Formation Pictured Cliffs	Pool Ballard Pictured Cliffs	Dedicated Acreage: 160.00 Acres		

1. Outline the acreage dedicated to the subject well by colored pencil or hachure marks on the plat below.
2. If more than one lease is dedicated to the well, outline each and identify the ownership thereof (both as to working interest and royalty).
3. If more than one lease of different ownership is dedicated to the well, have the interests of all owners been consolidated by communitization, unitization, force-pooling, etc?

☒ Yes ☐ No If answer is "yes," type of consolidation **Unitization**

If answer is "no," list the owners and tract descriptions which have actually been consolidated. (Use reverse side of this form if necessary.) _____

No allowable will be assigned to the well until all interests have been consolidated (by communitization, unitization, forced-pooling, or otherwise) or until a non-standard unit, eliminating such interests, has been approved by the Commission.

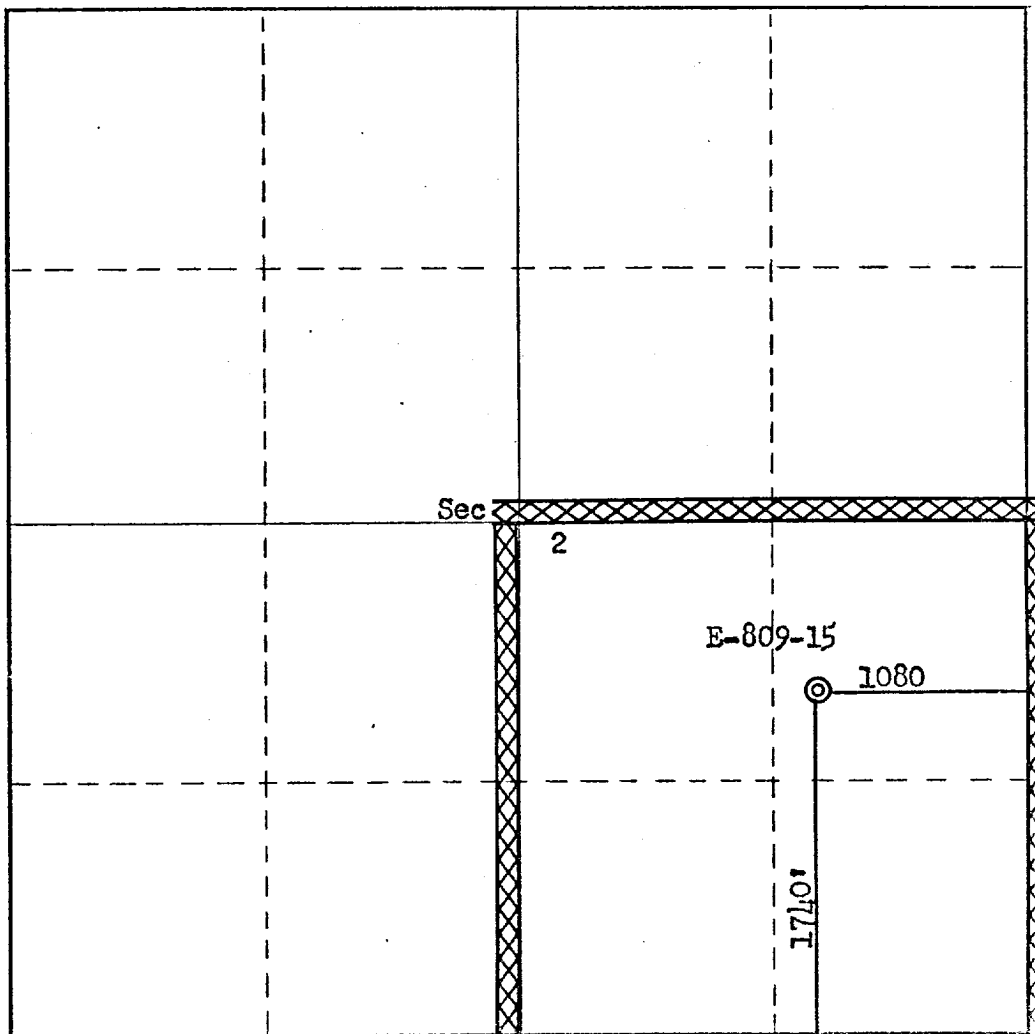

CERTIFICATION

I hereby certify that the information contained herein is true and complete to the best of my knowledge and belief.

Original Signed by

Name **D. G. Brisco**

Drilling Clerk

Position

El Paso Natural Gas Co.

Company

August 9, 1973

Date

I hereby certify that the well location shown on this plat was verified from field notes of actual surveys made by me or under my supervision, and that the same is true and correct to the best of my knowledge and belief.

Date Surveyed

July 31, 1973

Registered Professional Engineer
and/or Land Surveyor

Fred B. Korr Jr.

Certificate No.

3950

