

UNITED STATES  
DEPARTMENT OF THE INTERIOR  
GEOLOGICAL SURVEY

## APPLICATION FOR PERMIT TO DRILL, DEEPEN, OR PLUG BACK

1a. TYPE OF WORK  
DRILL ☒ DEEPEN ☐ PLUG BACK ☐

## b. TYPE OF WELL

OIL WELL ☒ GAS WELL ☐ OTHER ☐ SINGLE ZONE ☐ MULTIPLE ZONE ☐

## 2. NAME OF OPERATOR

Continental Oil Company

## 3. ADDRESS OF OPERATOR

Box 460, Hobbs, N.M. 88240

## 4. LOCATION OF WELL (Report location clearly and in accordance with any State requirements.\*)

At surface

L 2270' FSL + 770' FWL

At proposed prod. zone

Same

## 14. DISTANCE IN MILES AND DIRECTION FROM NEAREST TOWN OR POST OFFICE\*

## 15. DISTANCE FROM PROPOSED\*

LOCATION TO NEAREST  
PROPERTY OR LEASE LINE, FT.  
(Also to nearest drlg. unit line, if any)

## 16. NO. OF ACRES IN LEASE

18. DISTANCE FROM PROPOSED LOCATION\*  
TO NEAREST WELL, DRILLING, COMPLETED,  
OR APPLIED FOR, ON THIS LEASE, FT.

## 19. PROPOSED DEPTH

8100'

17. NO. OF ACRES ASSIGNED  
TO THIS WELL

160

## 20. ROTARY OR CABLE TOOLS

Rotary

## 21. ELEVATIONS (Show whether DF, RT, GR, etc.)

7182' GR

## 22. APPROX. DATE WORK WILL START\*

5-1-78

## 23. PROPOSED CASING AND CEMENTING PROGRAM

SIZE OF HOLE	SIZE OF CASING	WEIGHT PER FOOT	SETTING DEPTH	QUANTITY OF CEMENT
12 1/4"	New 8 3/8" CSG	24 #	1000'	600 SX Circ
7 7/8"	New 5 1/2" CSG	15.5 + 17 #	8100'	1385 SX

IT IS Proposed To Drill A Straight Hole To A  
T.D. OF 8,100 and Complete AS A West Lindvith  
Gallup Dakota Oil Well,

See Attached For B.O.P. Program.

See Attached ~~For~~ Proposed Well Plan For Formation Tops, Logging, Etc.



IN ABOVE SPACE DESCRIBE PROPOSED PROGRAM: If proposal is to deepen or plug back, give data on present productive zone and proposed new productive zone. If proposal is to drill or deepen directionally, give pertinent data on subsurface locations and measured and true vertical depths. Give blowout preventer program, if any.

24.

SIGNED

Wm. A. Butterfield

TITLE

ADMIN. SUPV.

DATE

1-4-78

(This space for Federal or State office use)

PERMIT NO.

APPROVAL DATE

APPROVED BY

TITLE

DATE

CONDITIONS OF APPROVAL, IF ANY:

OK

OK

RECEIVED

JAN 10 1978

\*See Instructions On Reverse Side

USGS-Durango (6), El Paso, MTA, BEA, F 1- (2)

U. S. GEOLOGICAL SURVEY  
DURANGO, COLO.

NEW MEXICO OIL CONSERVATION COMMISSION  
WELL LOCATION AND ACREAGE DEDICATION PLAT

Form C-102  
Supersedes C-128  
Effective 1-1-65

All distances must be from the outer boundaries of the Section.

Operator <b>Continental Oil Company</b>			Lease <b>Jicarilla 22</b>		Well No. <b>9</b>
Unit Letter <b>L</b>	Section <b>21</b>	Township <b>25N</b>	Range <b>4W</b>	County <b>Rio Arriba</b>	
Actual Footage Location of Well:					
<b>2270</b> feet from the <b>South</b> line and <b>770</b> feet from the <b>West</b> line					
Ground Level Elev. <b>7182</b>	Producing Formation <b>Gallup Dakota</b>	Pool <b>West Linderoth</b>	Dedicated Acreage: <b>160</b> Acres		

1. Outline the acreage dedicated to the subject well by colored pencil or hachure marks on the plat below.
2. If more than one lease is dedicated to the well, outline each and identify the ownership thereof (both as to working interest and royalty).
3. If more than one lease of different ownership is dedicated to the well, have the interests of all owners been consolidated by communitization, unitization, force-pooling, etc?
 

☐ Yes    ☐ No    If answer is "yes," type of consolidation \_\_\_\_\_

If answer is "no," list the owners and tract descriptions which have actually been consolidated. (Use reverse side of this form if necessary.) \_\_\_\_\_

No allowable will be assigned to the well until all interests have been consolidated (by communitization, unitization, forced-pooling, or otherwise) or until a non-standard unit, eliminating such interests, has been approved by the Commission.

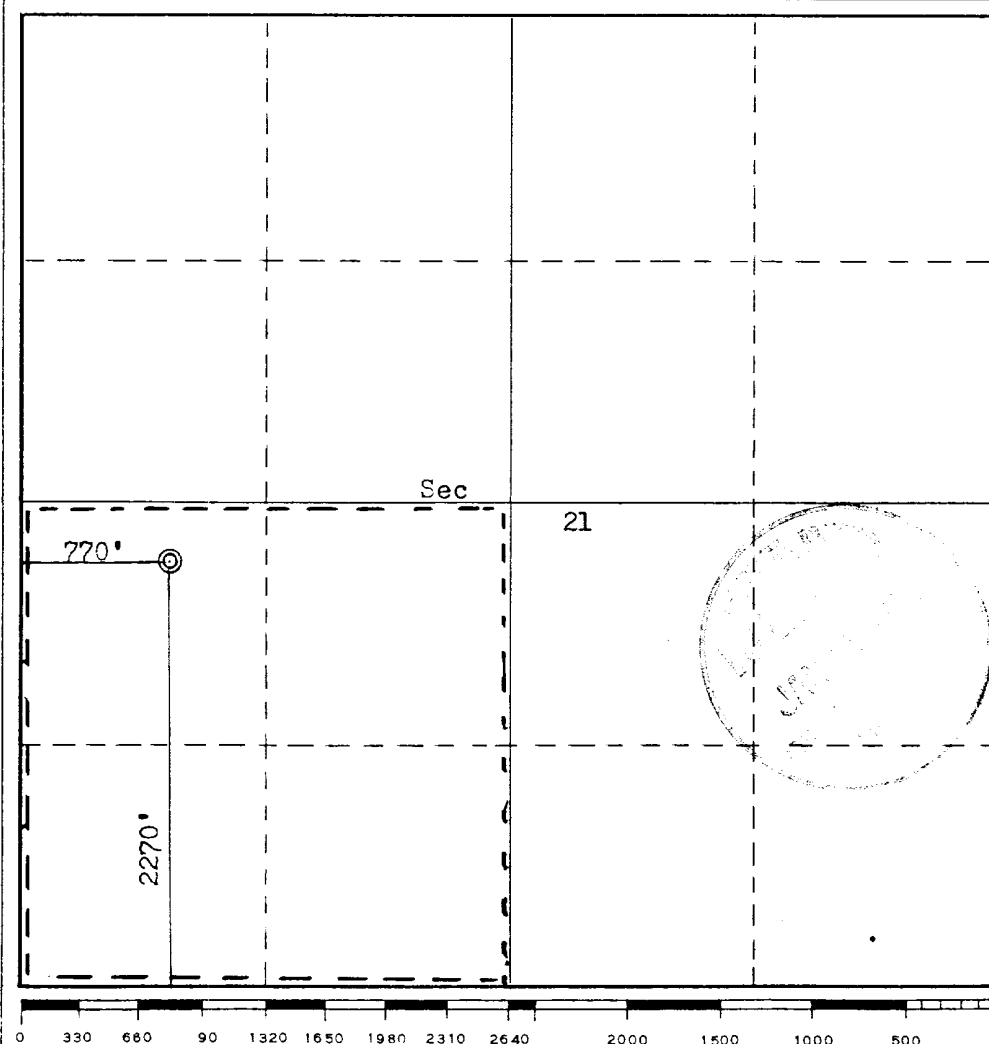

**CERTIFICATION**

I hereby certify that the information contained herein is true and complete to the best of my knowledge and belief.

Name Wm. A. Dutton  
 Position Admin. Supv.  
 Company Continental Oil Co.  
 Date 1-9-78

I hereby certify that the well location shown on this plat was plotted from field notes of actual surveys made by me or under my supervision, and that the same is true and correct to the best of my knowledge and belief.

Date Surveyed  
**November 16, 1977**

Registered Professional Engineer and/or Land Surveyor

Fred B. Kerr  
Fred B. Kerr, Jr.

Certificate No.  
**3950**

ATTACHMENT TO FORM 9-331 C  
APPLICATION FOR PERMIT TO DRILL

Continental Oil Company, Jicarilla 22 No. 9  
2270' FSL and 770' FWL of Section 21, T-25N, R-4W,  
Rio Arriba County, New Mexico

1. The geologic name of the surface formation is Cretaceous Sand.
2. The estimated tops of important geologic markers are shown on the attached Proposed Well Plan.
3. The estimated depths at which anticipated water, oil, gas or other mineral-bearing formations to be encountered are shown on attached Proposed Well Plan.
4. The proposed casing program is as follows:

Surface - new 8 5/8" 24# K-55 set at 1000'  
Production - new 5 1/2" 15.5# and 17# K-55 set at 8100'
5. A drawing of an API Series 900 Blowout Preventer Specification is attached. Pipe rams and blinds will be checked to 1,000 PSI for 30 minutes when BOP is installed. BOP will be checked when casing string is set and operated daily for checks.
6. The proposed mud program is as follows:

0-1000' Fresh Water Gel	8.5-9.0 pounds per gallon
1000-8100' KCL Poly Gel	8.5-9.0 pounds per gallon
7. The auxiliary equipment to be used is:
  - (1) Kelly cocks
  - (2) Floats at the bit
8. It is proposed to run SP-IES log from TD to 3300' and GR CAL CNL FDC PDC logs at selected intervals.
9. No abnormal pressures or temperatures are expected to be encountered in this well.
0. The anticipated starting date for this well is May 1, 1978, with a duration date of approximately 21 days.

CONTINENTAL OIL COMPANY  
Blow-out Preventer Specifications

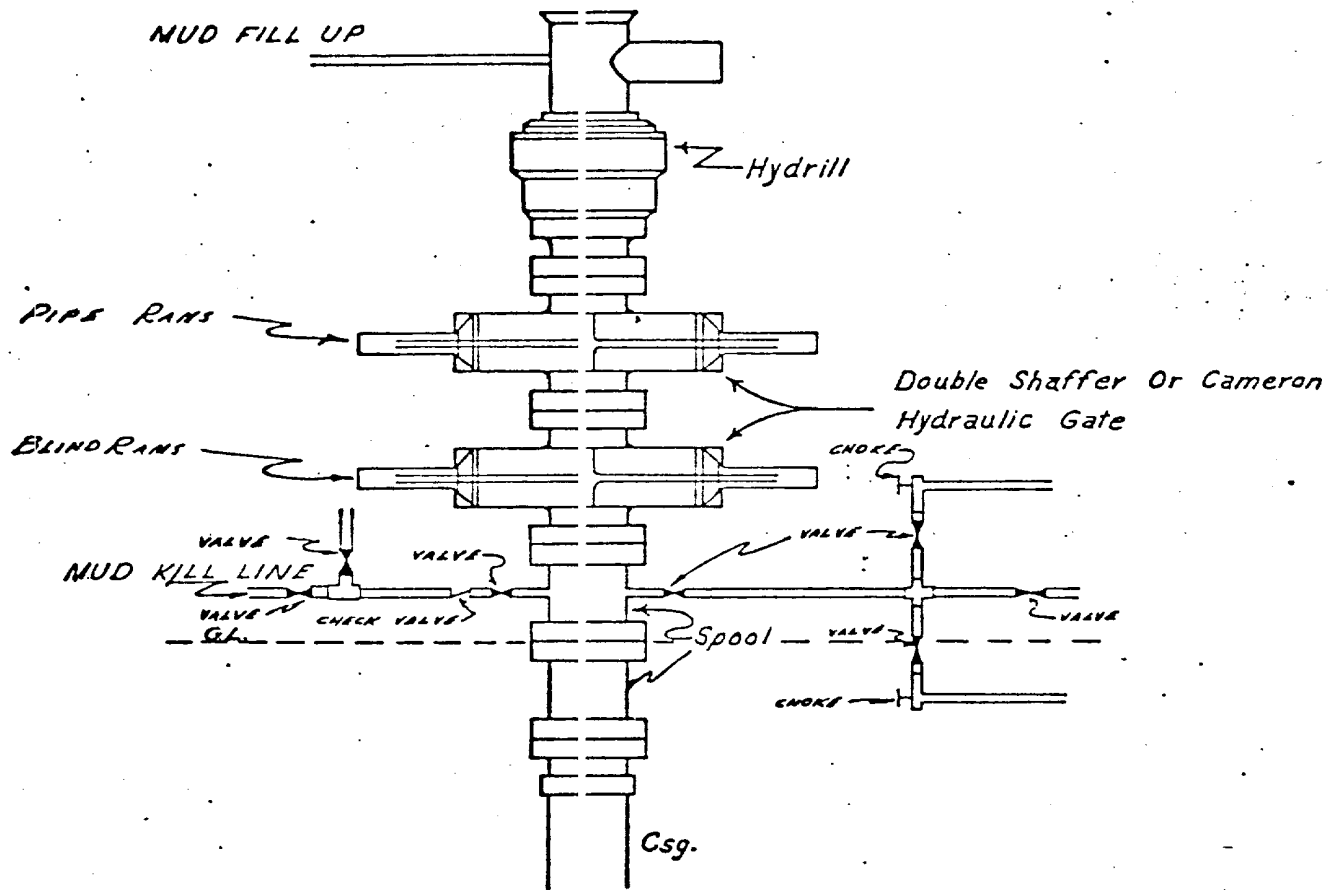

API Series 900

NOTE:

Manual and Hydraulic controls with closing unit no less than 75' from well head.  
Remote controls on rig floor.

DUE TO SUBSTRUCTURE CLEARANCE,  
HYDRILL MAY OR MAY NOT BE USED.

Jicoville 22 #9

# Proposed Well Plan

WELL NAME: Jicarilla 22 #9

COUNTY: Rio Arriba

LOCATION: 1980 FSL & 660 FWL

STATE: NM

Sec. 21, T25N, R4W

Est. 7195 KB

Est. 7180 GL

DEPTH	FORMATION TOPS & TYPE	DRILLING PROBLEMS	TYPE OF FORMATION EVALUATION	HOLE SIZE (IN)	CASING		FRACTURE GRADIENT (PPG)	FORMATION PRESSURE GRADIENT (PPG)	MUD	
					SIZE (IN)	DEPTH (FT)			WEIGHT (PPG)	TYPE
	<u>Cretaceous</u>									
<u>500</u>			<u>GEOLDS. APH</u>	<u>12 1/4</u>	<u>8 5/8</u>	<u>1000</u>	-	-	<u>8.5</u>	<u>FRESH</u>
			<u>0-10</u>						<u>TO</u>	<u>WATER</u>
									<u>9.0</u>	<u>GEL</u>
<u>2000</u>										
	<u>Ojo Alamo ss.</u>									
	<u>2740</u>									
<u>3000</u>	<u>Kirtland sh.</u>									
	<u>3125</u>									
	<u>Pic. Cliffs ss.</u>									
	<u>3425</u>									
<u>4000</u>										
	<u>Chacra ss.</u>		<u>Well Logs</u>							
	<u>4370</u>		<u>SP-IES</u>							
<u>5000</u>	<u>Mesa Verde ss.</u>		<u>TD-3200'</u>							
	<u>5160</u>		<u>2" &amp; 5"</u>							
			<u>GR-CAL-</u>							
			<u>CNL-FDC</u>							
			<u>Selected</u>							
			<u>Interval</u>							
			<u>2" &amp; 5"</u>							
<u>6000</u>										
	<u>Gallup ss.</u>		<u>PDC</u>							
	<u>6800</u>		<u>Selected</u>							
			<u>Interval</u>							
<u>7000</u>										
	<u>Dakota ss.</u>									
	<u>7620</u>									
	<u>Zone J</u>									
	<u>7830</u>									
	<u>Zone M</u>									
	<u>7930</u>									
<u>8000</u>	<u>TD</u>									
				<u>7 7/8</u>	<u>5 1/2</u>	<u>8100</u>	<u>13.0</u>	<u>LESS</u>	<u>8.5</u>	<u>KCL</u>
							<u>TO</u>	<u>THAN</u>	<u>TO</u>	<u>POLY</u>
							<u>14.0</u>	<u>8.5</u>	<u>9.0</u>	<u>GEL</u>

Date \_\_\_\_\_

Prepared by \_\_\_\_\_

SURFACE USE PLAN  
Continental Oil Company, Jicarilla 22 No. 9  
2270' FSL and 770' FWL of Section 21, T-25N, R-4W  
Lease Contract No. 60, Rio Arriba County, NM

The plan is to accompany "Application for Permit to Drill" the subject well. The following is a discussion of pertinent information concerning possible effect which the proposed drilling of the well may have on the environment of the well and road sides and surrounding acreage. A copy will be posted on the derrick floor so that all contractors and sub-contractors will be aware of all items of this plan.

1. Existing Roads

- A. The proposed well site is 2270' FSL and 770' FWL of Section 21, T-25N, R-4W, Rio Arriba County, New Mexico.
- B. Exhibit "A" is a portion of a Jicarilla 22 Lease map showing existing roads and proposed new road and location.
- C. The access roads are shown on Exhibits "A" and "B".

2. Planned Access Roads

The access road is approximately 2500' long approaching the well from the Northwest. Roads may be altered at the discretion of the Jicarilla Apache Tribe and will be constructed and maintained according to their specification.

3. Location of Existing Wells

See Exhibit "A".

4. Location of Existing and/or Proposed Facilities

- A. Tank Batteries: One 400 Bbl. tank and a production unit will be located on well site.
- B. Rehabilitation: Pits will be backfilled and leveled as soon as practical to original condition. Commencement of rehabilitation operations will immediately follow removal of drilling and completion equipment from location and rehabilitation of the surface is planned to be completed within 45 days from commencement.

5. Water Supply

The supply of water will be hauled from Largo Wash (See Exhibit "C").

6. Source of Construction Materials

Not applicable. Drilling pad to be compacted.

7. Methods for Handling Waste Disposal

Waste Disposal: Well cuttings will be disposed in reserve pit. Trash pit is shown on "Rig Layout", Exhibit "D". All detrimental waste will be buried with a minimum cover of 24' of dirt. See Exhibit "D" for location of pits.

8. Ancillary Facilities

None

9. Well Site Layout

Exhibit "D" shows the relative location and dimensions of the well pad, mud pit, reserve pit, trash barrel, etc.

10. Plans for Restoration of Surface

Pits will be backfilled and leveled as soon as practical to original condition. Commencement of rehabilitation operations will immediately follow removal of drilling and completion equipment from location. Surface will be leveled and properly conditioned as required by USGS after consulting with proper surface managing agency.

11. Other Information

A. Terrain: Broken, the well is located on a bench just below a ridge. The topography is that of steep slopes and arroyos. The land slopes to the northeast. See Exhibit "B", topographic map of area.

B. Soil: Sandy loam with sandstone outcrops.

C. Vegetation: Juniper, Pinon, Sagebrush, Yucca, Mountain Mahogany, Alkali Sacaton, Prickly Pear Cactus, Antelope Brush, and Blue Aster.

D. Surface Use: Suitable for grazing.

E. Ponds and Streams: None within one mile.

F. Water Wells: None within one mile.

G. Residences and Buildings: None within one mile.

H. Arroyos, Canyons, Etc: See attached topographic map, Exhibit "B".

I. Well Sign: Sign identifying and locating well will be maintained at drill site with the spudding of the well.

J. Open Pits: All pits containing mud or other liquids will be fenced.

K. Archaeological Resources: None observed.

12. Operator's Representative

Field personnel who can be contacted concerning compliance of this Surface Use Plan are as follows:

PRODUCTION AND DRILLING:

B. E. Anderson  
Petroleum Center Building  
Room 215  
501 Airport Drive  
Farmington, New Mexico  
Phone: (505) 327-9557

L. P. Thompson  
1001 North Turner  
Hobbs, New Mexico 88240  
Phone: (505) 393-4141

E. L. Oshlo  
1001 N. Turner  
Hobbs, New Mexico 88240  
Phone: (505) 393-4141

13. Certification

I hereby certify that I, or persons under my direct supervision, have inspected the proposed drill site and access route; that I am familiar with the conditions which presently exist; that the statements made in this plan are, to the best of my knowledge, true and correct; and that the work associated with the operations proposed herein will be performed by Continental Oil Company and its contractors and sub-contractors in conformity with this plan and the terms and conditions under which it is approved.

Jan 4, 1978  
Date

E. L. Oshlo  
E. L. Oshlo  
Assistant Division Manager

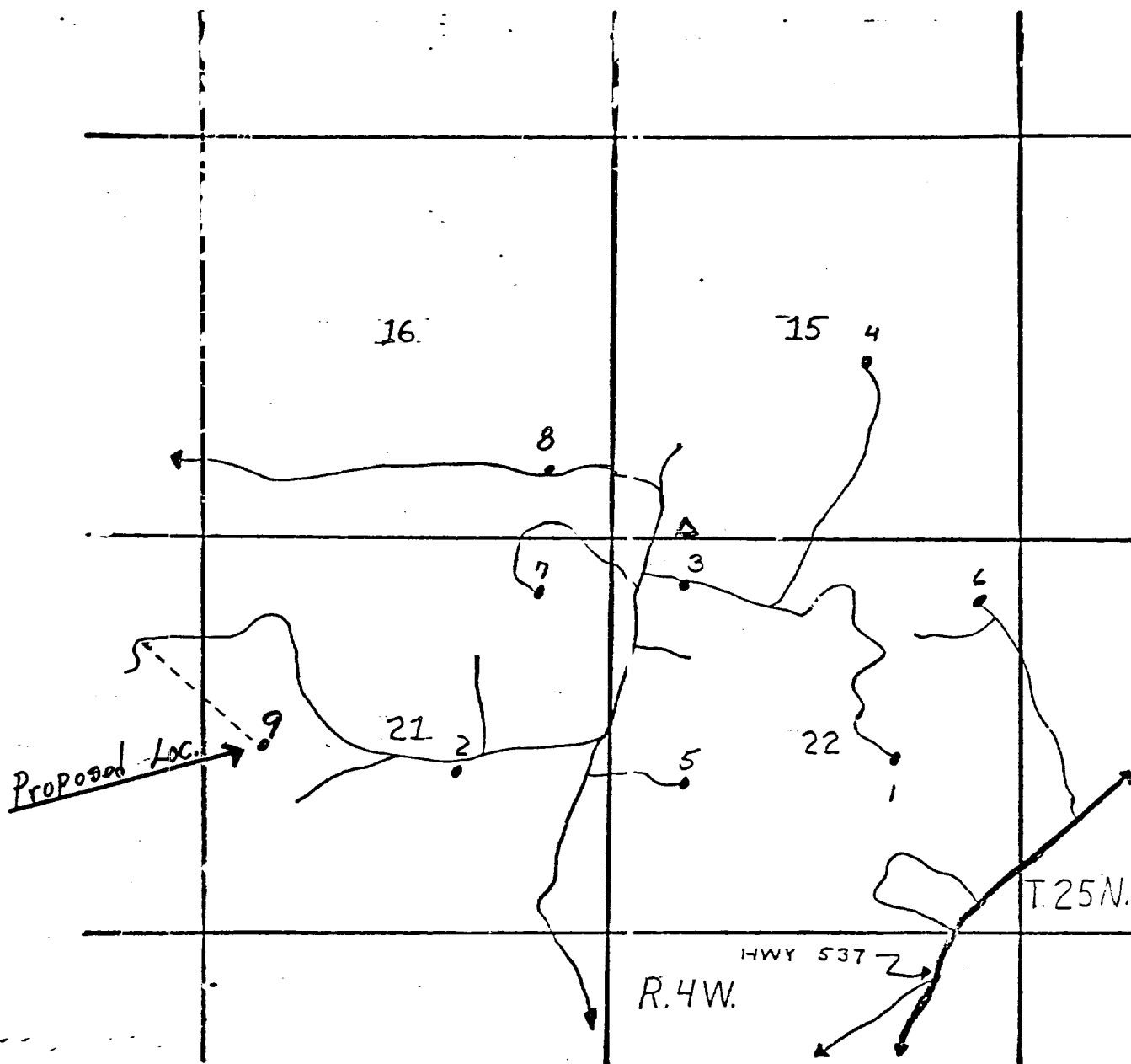

	
PRODUCTION DEPT. HOBBS DIV. JICARILLA "22" LEASE Well No. 9	
LEGEND	
•	CONOCO WELL.
△	TANK BATTERY
—	LEASE ROAD
---	HWY.
EXHIBIT "A"	
NTS CHAVEZ	



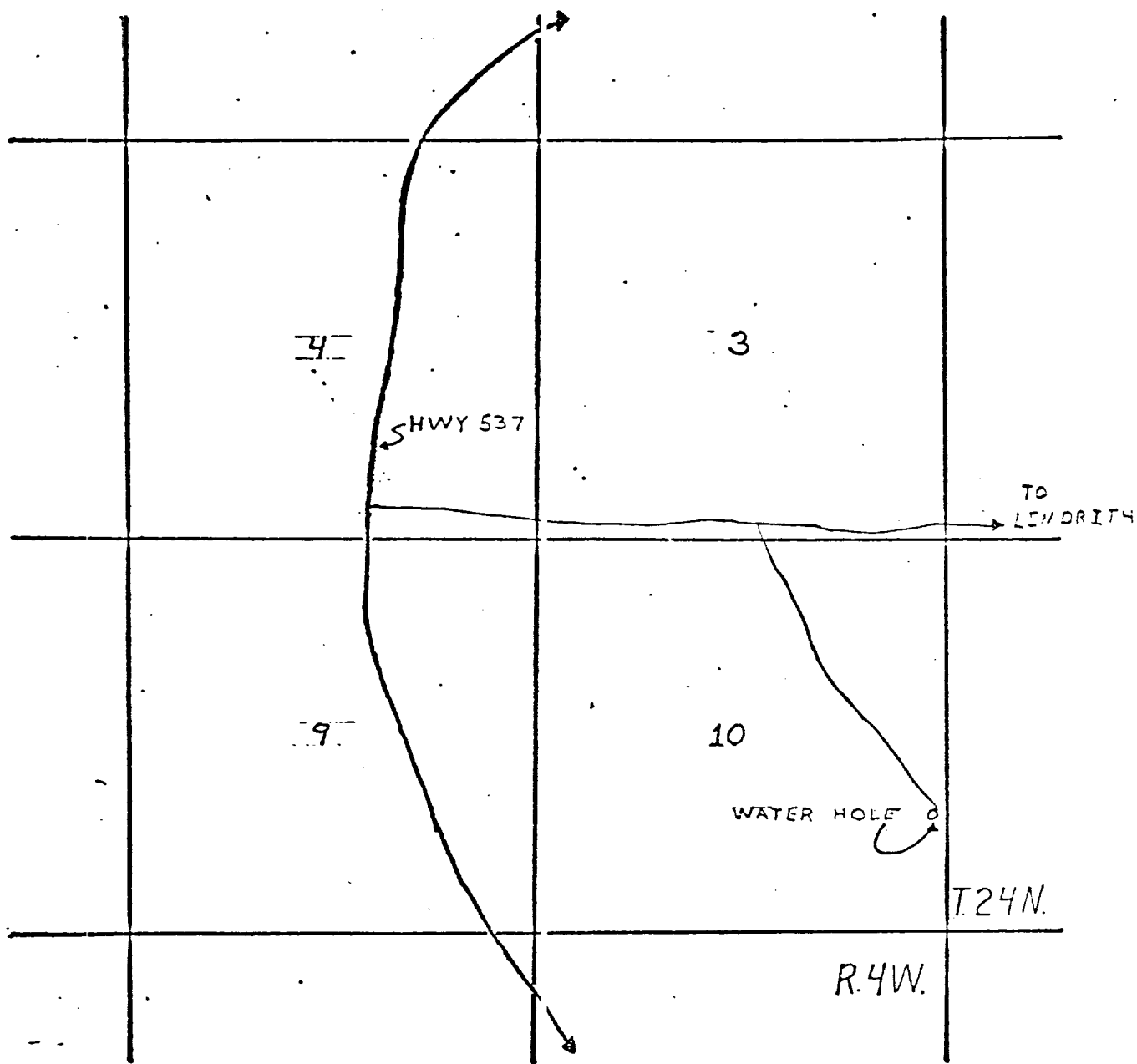

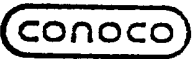

PRODUCTION DEPT. HOBBS DIV.

LARGO WATER HOLE

LEGEND

- CONOCO WELL
- △ TANK BATTERY
- LEASE ROAD
- HWY.

NTS  
CHAVEZ

EXHIBIT C

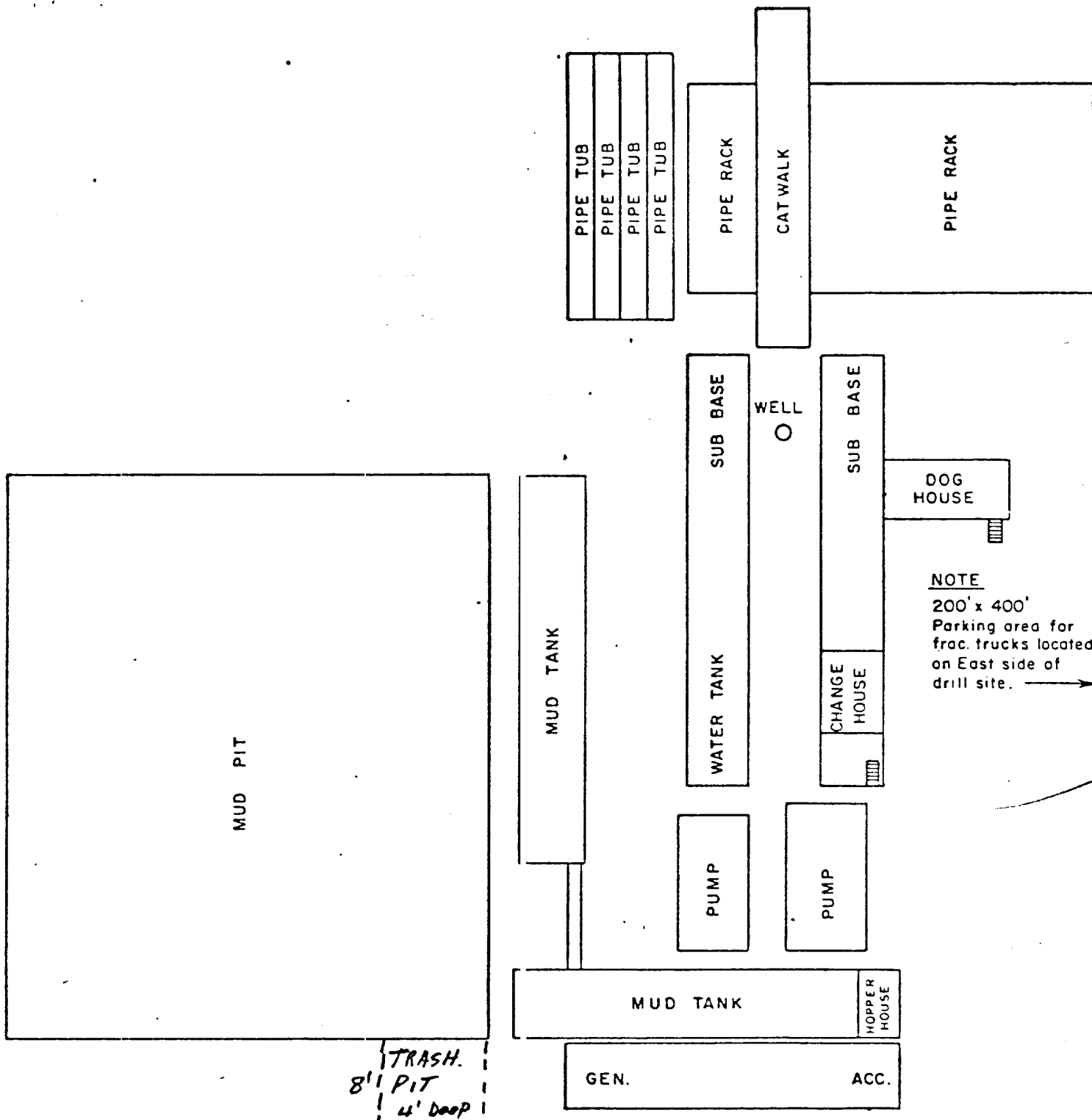

**NOTE**  
 200' x 400'  
 Parking area for  
 frac. trucks located  
 on East side of  
 drill site. →

APPROX. RIG SITE DIMENSIONS  
 160' x 200'

**CONTINENTAL OIL COMPANY**  
**PRODUCTION DEPARTMENT**



**RIG LAYOUT**

Jimmie 22 #9

EXHIBIT "D"

Engineer: [Redacted]      Draftsman: [Redacted]      Date: 1-4-73