

UNITED STATES
DEPARTMENT OF THE INTERIOR
GEOLOGICAL SURVEY

103

~~APPLICATION FOR PERMIT TO DRILL, DEEPEN, OR PLUG BACK~~

1a. TYPE OF WORK

DRILL ☐DEEPEN ☒PLUG BACK ☐

b. TYPE OF WELL

OIL
WELL ☐GAS
WELL ☒

OTHER

SINGLE
ZONE ☐MULTIPLE
ZONE ☐

2. NAME OF OPERATOR

Energy Reserves Group, Inc.

3. ADDRESS OF OPERATOR

Box 3280 Casper, Wyoming 82602

4. LOCATION OF WELL (Report location clearly and in accordance with any State requirements.*)

At surface

N 840' FSL & 1540' FWL (SE/SW)
At proposed prod. zone

14. DISTANCE IN MILES AND DIRECTION FROM NEAREST TOWN OR POST OFFICE*

Approximately 15 miles east from Counselors Trading Post

15. DISTANCE FROM PROPOSED*

LOCATION TO NEAREST
PROPERTY OR LEASE LINE, FT.
(Also to nearest drlg. unit line, if any)

1820'

16. NO. OF ACRES IN LEASE

2515.80

18. DISTANCE FROM PROPOSED LOCATION*

TO NEAREST WELL, DRILLING, COMPLETED,
OR APPLIED FOR, ON THIS LEASE, FT.

2400'

19. PROPOSED DEPTH

7600'±

17. NO. OF ACRES ASSIGNED
TO THIS WELL

5/ 320

20. ROTARY OR CABLE TOOLS

Rotary

21. ELEVATIONS (Show whether DF, RT, GR, etc.)

6807' Gr. (ungraded)

22. APPROX. DATE WORK WILL START*

August - Spetember, 1979

23. PROPOSED CASING AND CEMENTING PROGRAM

SIZE OF HOLE	SIZE OF CASING	WEIGHT PER FOOT	SETTING DEPTH	QUANTITY OF CEMENT
12 1/4"	8 5/8"	24#	500'±	Cement to surface
7 7/8"	4 1/2"	11.60#	7600'±	250sx.

CHANGE PLANS

and well name

Approval is requested to change plans on the above referenced well. It is proposed to drill this well to the Dakota Formation @ 7600'±. This well was originally scheduled and permitted to the Chacra Formation @ 4000'.



IN ABOVE SPACE DESCRIBE PROPOSED PROGRAM: If proposal is to deepen or plug back, give data on present productive zone and proposed new productive zone. If proposal is to drill or deepen directionally, give pertinent data on subsurface locations and measured and true vertical depths. Give blowout preventer program, if any.

24.

SIGNED

TITLE Field Services Adminst.DATE August 6, 1979

(This space for Federal or State office use)

PERMIT NO. _____

APPROVAL DATE _____

APPROVED BY _____

TITLE _____

DATE _____

CONDITIONS OF APPROVAL, IF ANY:

AUG 9 1979

*See Instructions On Reverse Side

U. S. GEOLOGICAL SURVEY
WASHINGTON, D. C.

NEW MEXICO OIL CONSERVATION COMMISSION
WELL LOCATION AND ACREAGE DEDICATION PLAT

Form C-102
Supersedes C-129
Effective 1-1-65

All distances must be from the outer boundaries of the Section.

Operator Energy Reserves Group, Inc.			Lease Jicarilla 35		Well No. 85
Unit Letter N	Section 36	Township 25 North	Range 5 West	County Rio Arriba	
Actual Footage Location of Well: 800 feet from the South line and 1540 feet from the West line					
Ground Level Elev. 6807	Producing Formation Dakota	Pool Basin Dakota		Dedicated Acreage: 320 Acres	

1. Outline the acreage dedicated to the subject well by colored pencil or hatchure marks on the plat below.
2. If more than one lease is dedicated to the well, outline each and identify the ownership thereof (both as to working interest and royalty).
3. If more than one lease of different ownership is dedicated to the well, have the interests of all owners been consolidated by communitization, unitization, force-pooling, etc?

☐ Yes ☐ No If answer is "yes," type of consolidation _____

If answer is "no," list the owners and tract descriptions which have actually been consolidated. (Use reverse side of this form if necessary.) _____

No allowable will be assigned to the well until all interests have been consolidated (by communitization, unitization, forced-pooling, or otherwise) or until a non-standard unit, eliminating such interests, has been approved by the Commission.

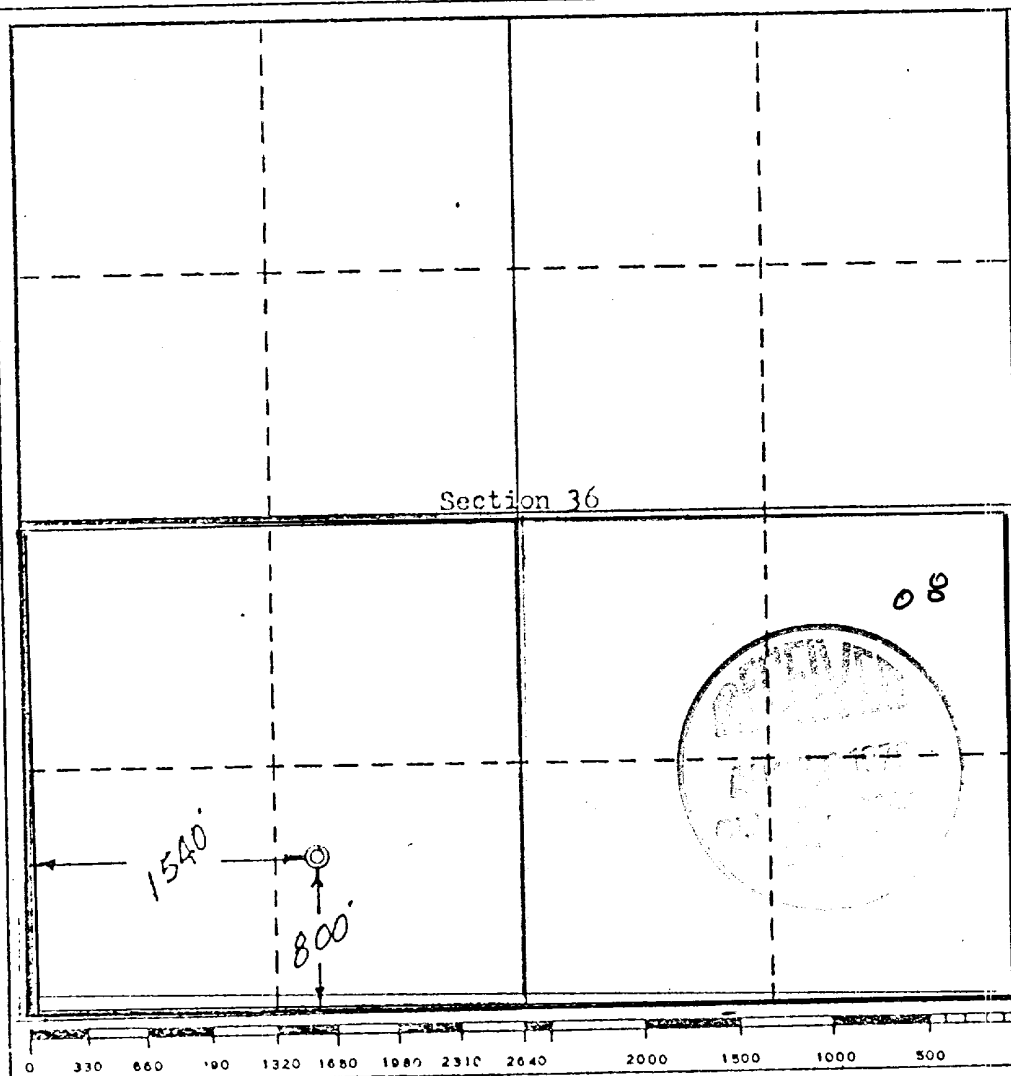

CERTIFICATION

I hereby certify that the information contained herein is true and complete to the best of my knowledge and belief.

Name
[Signature]
Position
Field Services Administ.
Company
Energy Reserves Group, Inc.
Date
August 6, 1979

I hereby certify that the well location shown on this plat was plotted from field notes of actual surveys made by me or under my supervision, and that the same is true and correct to the best of my knowledge and belief.

Date Surveyed
May 7, 1979
Registered Professional Engineer and Land Surveyor
[Signature]
Certificate No.
3084

Supplemental to Form 9-331C

1. The geologic name of the surface formation.

Undivided Tertiary

2. The estimated tops of important geologic markers.

<i>Kirtland</i>	<i>2500'</i>	<i>Mancos</i>	<i>5120'</i>	<i>Dakota</i>	<i>7270'</i>
<i>Pictured Cliffs</i>	<i>2850'</i>	<i>Gallup</i>	<i>6170'</i>	<i>T.D.</i>	<i>7600'</i>
<i>Chacra</i>	<i>3700'</i>	<i>Greenhorn</i>	<i>6770'</i>		
<i>Cliff House</i>	<i>4420'</i>	<i>Graneros</i>	<i>6870'</i>		

3. The estimated depths at which anticipated water, oil, gas, or other mineral-bearing formations are expected to be encountered.

Pictured Cliffs @ 2850' & Chacra @ 3700' are expected to be gas bearing.

The Gallup @ 6170' may be oil & gas bearing. The Dakota @ 7270' is expected to be gas bearing.

4. The proposed casing program, including the size, grade, and weight-per-foot of each string and whether new or used.

8 5/8" - k-55 - 24# - new

4 1/2" - k-55 - 11.60# - new & used

5. The lessee's or operator's minimum specifications for pressure control equipment which is to be used, a schematic diagram thereof showing sizes, pressure ratings (or API series), and the testing procedures and testing frequency.

A 10" series 900 dual ram hydraulic BOP will be used. It will be tested to 800 psi after installation and prior to drilling out from under surface casing. The BOE will be operated on each trip.

6. The type and characteristics of the proposed circulating medium or mediums to be employed for rotary drilling and the quantities and types of mud and weighting material to be maintained.

A fresh water base chemical gel mud will be used for drilling operations. Adequate supplies will be on location to handle minor lost circulation and blow out prevention.

7. The auxiliary equipment to be used, such as (1) kelly cocks, (2) floats at the bit, (3) monitoring equipment on the mud system, (4) a sub on the floor with a full opening valve to be stabbed into drill pipe when the kelly is not in the string.

A kelly cock. a float on the bit, and a sub w/drill pipe thread and full opening valve on the rig floor will be used. Monitoring equipment on the mud system will be used.

8. The testing, logging, fracing, and coring programs to be followed with provision made for required flexibility.

No coring is planned. No DST's are planned. Logs will consist of DIL - Gamma Ray - Density Neutron. Fracing will probably consist of a gel water base material.

9. Any anticipated abnormal pressures or temperatures expected to be encountered or potential hazards such as hydrogen sulfide gas, along with plans for mitigating such hazards.

No abnormal pressures or temperatures are anticipated. H_2S is not a potential problem in the Pictured Cliffs, Chacra, and Dakota Formations.

10. The anticipated starting date and duration of the operations.

It is planned to commence operations as soon as regulatory approval is obtained and a rig becomes available. It is estimated that it will take 15-20 days to drill, log, complete, and test this well.

1. EXISTING ROADS

See attached topographical map

Existing roads in the area are presently maintained by Energy Reserves Group, Inc. and Amoco Production Company.

2. PLANNED ACCESS ROADS

- (1) Maximum width will be a 20' running surface
- (2) Maximum grade will be less than 8%
- (3) No turn outs are planned
- (4&5) Culverts will be installed as per B.I.A. recommendations
- (6) It is not planned to surface any roads
- (7) No gates, cattle guards, or fence cuts are required
- (8) The road route was flagged @ the time the well was staked

3. LOCATION OF EXISTING WELLS

See attached topographical map

4. LOCATION OF EXISTING AND/OR PROPOSED FACILITIES

- (1) There is presently a tank battery @ Well #1
- (2) Oil production facilities are located @ Well #1
- (3) There is an existing buried oil gathering line from Well #2 to the tank battery located @ Well #1
- (4) Gas gathering lines are buried and are owned by El Paso Natural Gas Company
- (5) Injection Lines - NA
- (6) Disposal Lines - NA

NEW FACILITIES:

- (1&2) See attached plat
- (3) Standard oil field construction methods will be used, no tanks will be necessary
- (4) All rotating parts will be guarded, pits if any will be fenced and flagged so as to protect livestock and wildlife.
- (5) After drilling and completion operations have been completed those disturbed areas no longer needed will be recontoured and reseeded as per B.I.A. recommendations.

5. LOCATION AND TYPE OF WATER SUPPLY

- (1) Description of location - Largo Canyon, 7-8 miles SW of lease
- (2) Water will be hauled by truck over existing roads
- (3) It is not planned to drill a water well

6. SOURCE OF CONSTRUCTION MATERIALS

No construction materials will be obtained from Federal or Indian Lands without prior approval. If any material is required it will be hauled over existing access roads.

7. METHODS FOR HANDLING WASTE DISPOSAL

Cuttings and drilling fluids will be contained in the reserve pit. Any produced fluids will be contained in tanks and hauled from the location. Sewage will be disposed of either in a chemical toilet or temporary hole dug with a dry hole digger. Garbage and other waste material will be put into a deep trash pit fenced with sharp wire to prevent scattering. Garbage will be burned and/or buried. Upon completion of operations the entire area will be policed up and all trash placed into the pit. After the reserve pit has dried sufficiently it will be back filled and recontoured to its original condition.

8. ANCILLARY FACILITIES

None are planned

9. WELL SITE LAYOUT

See attached drawing

PAGE TWO

10. PLANS FOR RESTORATION OF SURFACE

Upon completion of operations those areas no longer needed for producing operations will be recontoured and reseeded as per B.I.A. recommendations. The pit will be fenced and allowed to dry before backfilling. If there is oil on the pit it will be removed or flagging will be installed. Clean up operations will commence as soon as the rig has moved and the pit will be covered as soon as it dries.

11. OTHER INFORMATION

The area is generally high desert type country. Numerous gullies and washes with occasional rock out croppings. Vegetation consists of Pinion - Juniper trees, sage and other small bushes, and assorted native grasses. Surface and mineral ownership is the Jicarilla Apache Indian Tribe. There are no occupied dwellings in the immediate vicinity of the area to be disturbed. An archaeological inspection is planned to determine if there are any cultural or historical values.

12. LESSEE'S OR OPERATOR'S REPRESENTATIVES

Bill Fiant or T.C. Durham, or Roscoe Gillespie will be responsible for assuring compliance with approved surface use and operations plan.

BILL FIANT

T.C. DURHAM

R. GILLESPIE

Box 3280
Casper, Wyoming
82602
307-265-7331 (Office)
307-265-2529 (Home)

Box 977
Farmington, New Mexico
87401
505-327-1639 (Office)
505-325-7978 (Home)
505-325-1373 (Mobil)

Box 3280
Casper, Wyoming
82602
307-265-7331 (Office)
307-234-0745 (Home)
307-265-4541 (Mobil)

13. CERTIFICATION

See attached

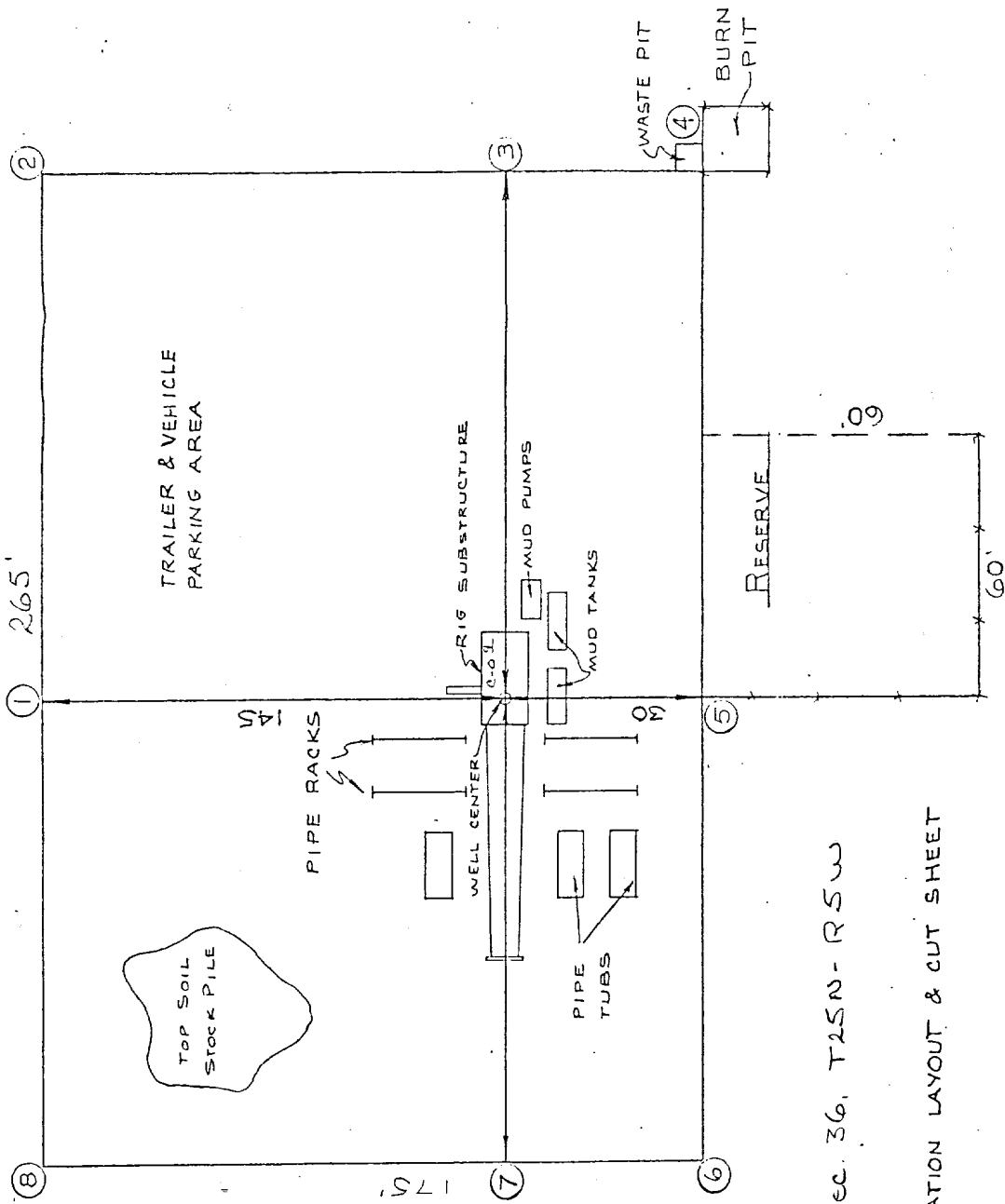

Jicarilla #9
 SE 1/4 SW 1/4
 SEC. 36, T25N-R5W

LOCATION LAYOUT & CUT SHEET

SCALE - 1" = 50'

SOILS LITHOLOGY
 - NO SCALE -

