

NO. OF COPIES RECEIVED	
DISTRIBUTION	
SANTA FE	
FILE	
U.S.G.S.	
LAND OFFICE	
OPERATOR	

5A. Indicate Type of Lease
STATE ☐ FEE ☒
5. State Oil & Gas Lease No.

APPLICATION FOR PERMIT TO DRILL, DEEPEN, OR PLUG BACK

1a. Type of Work
b. Type of Well DRILL ☒ DEEPEN ☐ PLUG BACK ☐
OIL WELL ☐ GAS WELL ☒ OTHER ☐ SINGLE ZONE ☒ MULTIPLE ZONE ☐
2. Name of Operator Jerome P. McHugh
3. Address of Operator P O Box 203, Farmington, NM 87401
4. Location of Well UNIT LETTER N LOCATED 790 FEET FROM THE South LINE
AND 1850' FEET FROM THE West LINE OF SEC. 2 TWP. 24N RGE. 2W NMPM
13. Proposed Depth 2400'
19A. Formation Nacimiento
20. Rotary or C.T. Rotary
21. Elevations (Show whether Df, Kf, etc.) 7224' GL
21A. Kind & Status Plug. Bond State-wide
21B. Drilling Contractor Joe I. Salazar
22. Approx. Date Work will start Dec. 25, 1981

7. Unit Agreement Name
8. Firm or Lease Name Santa
9. Well No. 1
10. Field and Pool, or Wildcat Cavanah Nacimiento Ext
12. County Rio Arriba

23. PROPOSED CASING AND CEMENT PROGRAM

SIZE OF HOLE	SIZE OF CASING	WEIGHT PER FOOT	SETTING DEPTH	SACKS OF CEMENT	EST. TOP
8-3/4"	7"	20#	90'	35	surface
5-1/2"	2-7/8"	6.5#	2400'	290 cu.ft.	surface

Plan to drill with as little mud as possible, using the slim hole technique to test the Nacimiento formation. Will run logs; if productive, will set 2-7/8" casing. Plan to immediately complete well and run 1 1/4" tbg.

NMERB REQUIREMENT: GAS NOT DEDICATED

APPROVAL VALID
FOR 90 DAYS UNLESS
DRILLING COMMENCED,
EXPIRES June 12, 1982

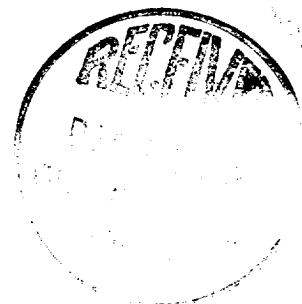

IN ABOVE SPACE DESCRIBE PROPOSED PROGRAM: IF PROPOSAL IS TO DEEPEN OR PLUG BACK, GIVE DATA ON PRESENT PRODUCTIVE ZONE AND PROPOSED NEW PRODUCTIVE ZONE. GIVE BLOWOUT PREVENTER PROGRAM, IF ANY.

I hereby certify that the information above is true and complete to the best of my knowledge and belief.

Signed Jerome P. McHugh Jr. Title Agent Date 12-17-81

(This space for State Use)

SUPERVISOR DISTRICT #3

DEC 17 1981

APPROVED BY [Signature] TITLE DATE

CONDITIONS OF APPROVAL, IF ANY:

OIL CONSERVATION DIVISION

P. O. BOX 2088

SANTA FE, NEW MEXICO 87501

Form C-102
Revised 10-1-78

STATE OF NEW MEXICO

ENERGY AND MINERALS DEPARTMENT

All distances must be from the outer boundaries of the Section.

Operator Jerome P. McHugh		Lease Santa		Well No. 1	
North Letter N	Section 2	Township 24 North	Range 2 West	County Rio Arriba	
Actual Footage Location of Well:					
790	feet from the	South	line and	1850	feet from the West line
Ground Level Elev. 7224	Producing Formation Nacimiento		Pool Gavilan Undesignated	Dedicated Acreage: 160 Acres	

1. Outline the acreage dedicated to the subject well by colored pencil or hatchure marks on the plat below.
2. If more than one lease is dedicated to the well, outline each and identify the ownership thereof (both as to working interest and royalty).
3. If more than one lease of different ownership is dedicated to the well, have the interests of all owners been consolidated by communitization, unitization, force-pooling, etc?

☐ Yes ☐ No If answer is "yes," type of consolidation _____

If answer is "no," list the owners and tract descriptions which have actually been consolidated. (Use reverse side of this form if necessary.) _____

No allowable will be assigned to the well until all interests have been consolidated (by communitization, unitization, forced-pooling, or otherwise) or until a non-standard unit, eliminating such interests, has been approved by the Division.

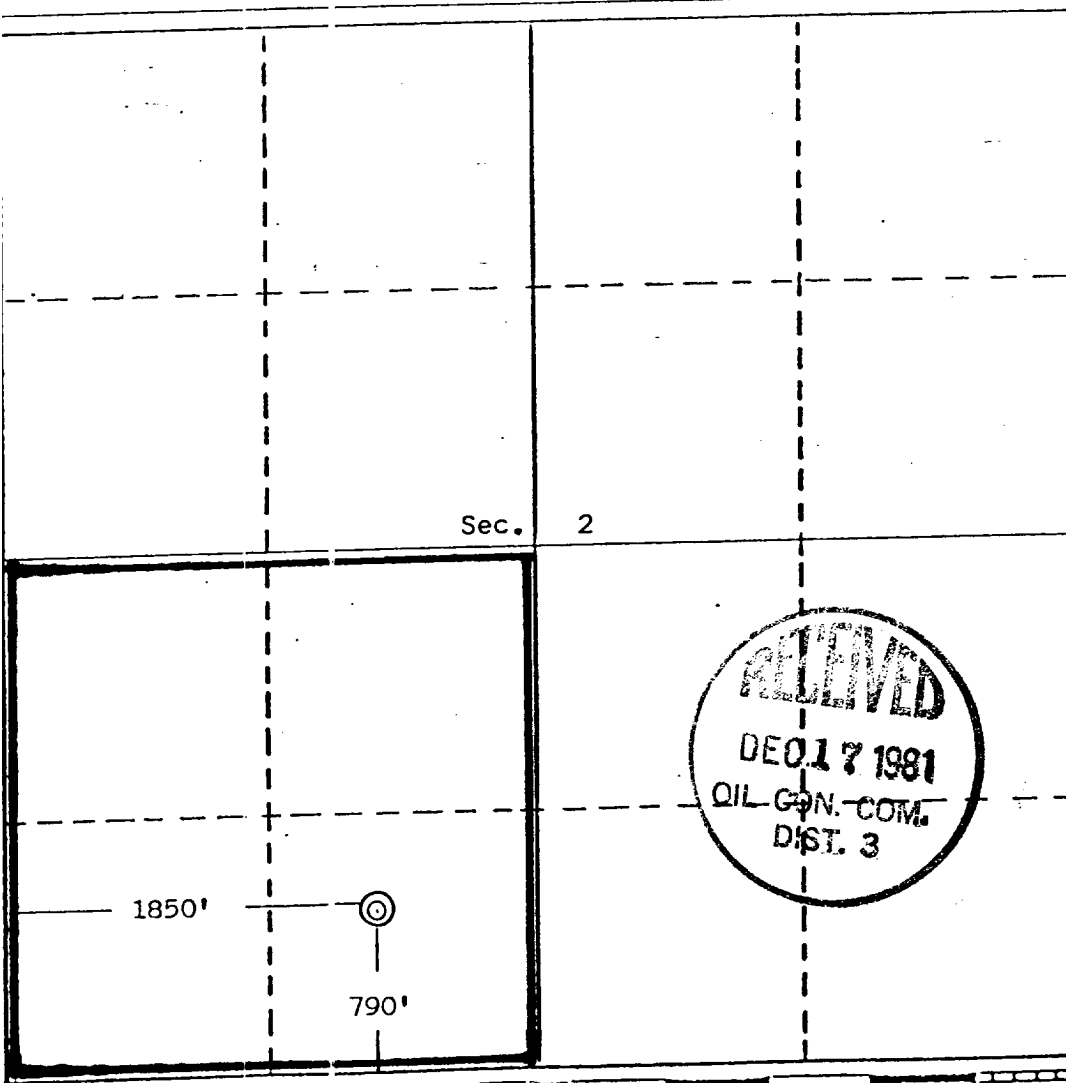

CERTIFICATION

I hereby certify that the information contained herein is true and complete to the best of my knowledge and belief.

Jerome P. McHugh
Name
Jerome P. McHugh

Position
Agent

Company
Jerome P. McHugh

Date
12-17-81

I hereby certify that the location shown on this plat was plotted from field notes of actual surveys made by me or under my supervision and that the same is true and correct to the best of my knowledge and belief.

Date Surveyed

December 11, 1981

Registered Professional Engineer
and/or Land Surveyor

Edgar L. Risenhoover
Certificate No. 5979
Edgar L. Risenhoover, L.S.