

DEPUTY OIL & GAS INSPECTOR

FEB 08 1939

ENVIRONMENTAL PROTECTION OFFICE

**P.O. BOX 507
DULCE, NEW MEXICO 87528**

SUBMIT 1 COPY TO
NATURAL
RESOURCE DEPT
AND OIL-GAS
ADMINISTRATION

PIT REMEDIATION AND CLOSURE REPORT

Operator: PNM Gas Services (WFS) Telephone: 324-3764

Address: 603 W. Elm Street Farmington, NM 87401

Facility or Well Name: JICAR, 1/4 L-10 Drip (WFS)

Location: Unit: D Sec. 9 T. 24 N R. 5 W County Rio Arriba

Pit Type: Separator Dehydrator Other Line Drive

Land Type: Jicarilla Apache

Pit Location: Pit dimensions: length 20' width 20' depth 3'

(Attach diagram) Reference: wellhead other Drip Column

Footage from reference: 30' (KJ)

Direction from reference: Due Degrees East of North X
West of South

Depth to Ground Water:

(Vertical distance from contaminants to seasonal high water elevation of ground water)

Less than 50 feet	(20 points)	
50 feet to 99 feet	(10 points)	
Greater than 100 feet	(0 points)	

Wellhead Protection Area:

(Less than 200 feet from a private domestic water source, or, less than 1,000 feet from all other water sources)

Yes (20 points) 0
No (0 points)

Distance to Surface Water:

(Horizontal distance to perennial lakes, ponds, rivers, streams, creeks, irrigation canals and ditches)

Less than 200 feet	(20 points)	
200 feet to 1,000 feet	(10 points)	
Greater than 1,000 feet	(0 points)	<input checked="" type="radio"/>

Distance to Ephemeral Stream (dry wash):

(Horizontal distance to all downgradient streams having a width of at least 10 feet)

Less than or equal to 100 feet	(10 points)	
Greater than 100 feet	(0 points)	7

Distance to Nearest Lake, Playa, or Watering Pond:

(Horizontal distance to all downgradient lakes, playas, and livestock or wildlife water ponds)

Less than or equal to 100 feet (10 points)
Greater than 100 feet (0 points)

RANKING SCORE (TOTAL POINTS):

Date Remediation Started: 6/23/98 Date Completed: 7/28/98

Remediation Method: Excavation X Approx. Cubic Yards 51

(Check all appropriate sections)

Landfarmed X Amount Landfarmed (cubic yds): 51

Other _____

Remediation Location: Onsite _____ Offsite JICARILLA L-10
(i.e., landfarmed onsite, name and location of offsite facility)

General Description of Remedial Action:

Removed contaminated soil from all four side walls and pit bottom as to get a below 100 ppm headspace reading
Final excavation: 14' X 14' X 7'.

Ground Water Encountered: No X Yes _____ Depth _____

Final Pit Closure Sampling:

Sample Location North East, South, West side walls and pit bottom

(if multiple samples, attach sample result and diagram of sample locations and depths.)

Sample depth 7'

Sample date 6/23/98 Sample time 0931

Sample Results

Soil: Benzene (ppm) _____ Water: Benzene (ppb) _____

Total BTEX (ppm) _____ Toluene (ppb) _____

Field headspace (ppm) 0.0 Ethylbenzene (ppb) _____

TPH 42 ppm Method 8015 Total Xylenes (ppb) _____

Ground Water Sample: Yes _____ No X (If yes, attach sample results)

I HEREBY CERTIFY THAT THE INFORMATION ABOVE IS TRUE AND COMPLETE TO THE BEST OF MY KNOWLEDGE AND MY BELIEF

DATE 7/14/98 PRINTED NAME Roy Burnham

SIGNATURE Roy Burnham AND TITLE Environmental Technician II

AFTER REVIEW OF THE PIT CLOSURE INFORMATION, PIT CLOSURE IS APPROVED IN ACCORDANCE TO JICARILLA APACHE TRIBE PIT CLOSURE ORDINANCE.

APPROVED: YES X NO _____ (REASON): _____

SIGNED: Kearl M. ... DATE: 7-28-98

Jicarilla L-10 DRIP
Sec-9 T-26N R-SW
WFS

Site Drawing

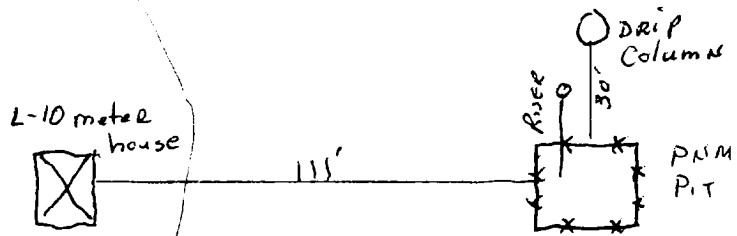

JICARILLA L-10 DRIP
Sec - 9 T-24N R-5W UNIT D
WFS

14'x14'x7'

EXCAVATION DRAWING

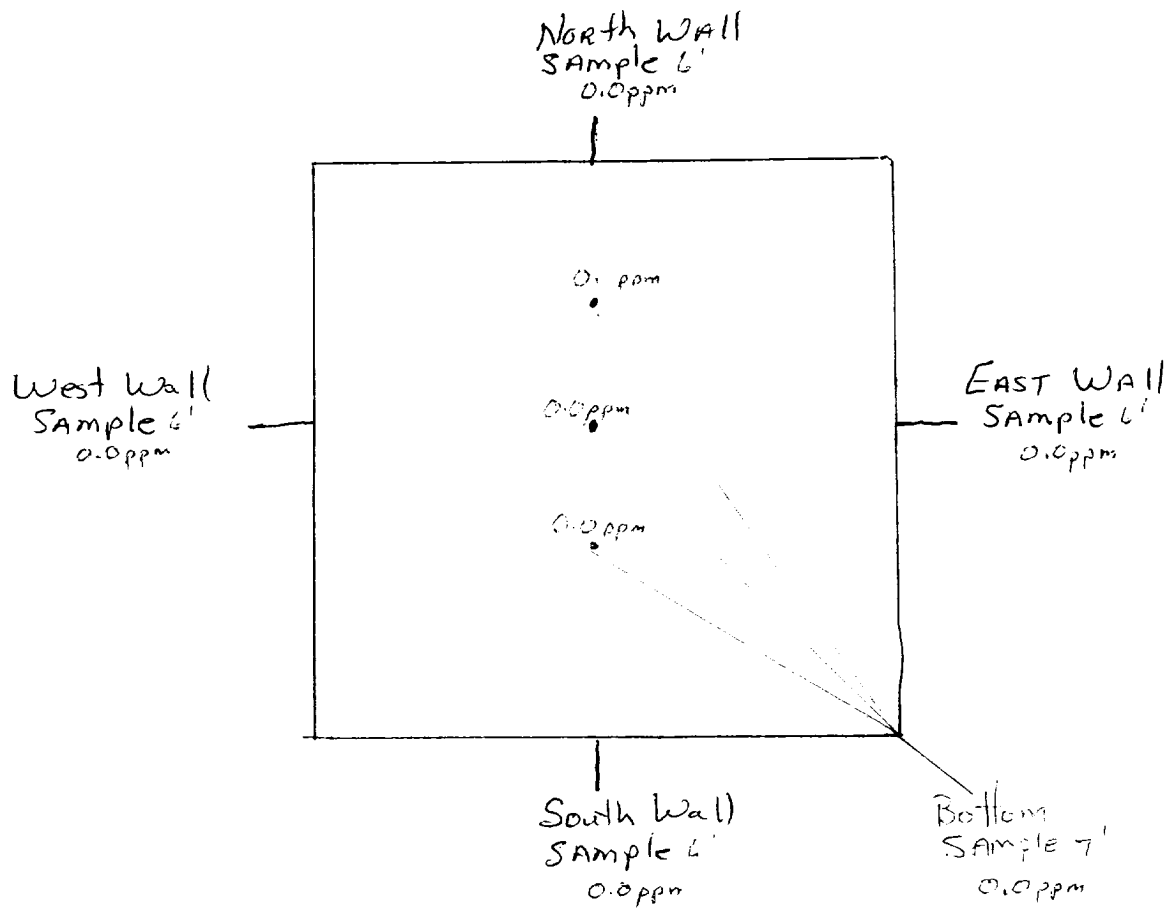

OFF: (505) 325-5667



LAB: (505) 325-1556

On Site Technologies, LTD.

Date: 06-Jul-98

CLIENT: PNM - Public Service Company of NM
Project: Jicarilla Pit Remediation
Lab Order: 9806106

CASE NARRATIVE

Samples were analyzed using the methods outlined in the following references:

Test Methods for Evaluating Solid Waste, Physical/Chemical Methods, SW846, 3rd Edition

All method blanks, laboratory spikes, and/or matrix spikes met quality assurance objectives.

OFF: (505) 325-5667

ON SITE
TECHNOLOGIES, LTD.

LAB: (505) 325-1556

ANALYTICAL REPORT

Date: 06-Jul-98

Client:	PNM - Public Service Company of NM	Client Sample Info:	Jicarilla L-10 Drip
Work Order:	9806106	Client Sample ID:	9806230931; 3pt. Comp. Bottom
Lab ID:	9806106-06A	Matrix:	SOIL
Project:	Jicarilla Pit Remediation	Collection Date:	6/23/98 9:31:00 AM
		COC Record:	5642

Parameter	Result	PQL	Qual	Units	DF	Date Analyzed
DIESEL RANGE ORGANICS		SW8015				Analyst: HR
T/R Hydrocarbons: C10-C28	42	25		mg/Kg	1	6/29/98

Qualifiers:

- PQL - Practical Quantitation Limit
- ND - Not Detected at Practical Quantitation Limit
- J - Analyte detected below Practical Quantitation Limit
- B - Analyte detected in the associated Method Blank

- S - Spike Recovery outside accepted recovery limits
- R - RPD outside accepted recovery limits
- E - Value above quantitation range
- Sur: - Surrogate

1 of 1

OFF: (505) 325-5667



LAB: (505) 325-1556

ANALYTICAL REPORT

Date: 06-Jul-98

Client:	PNM - Public Service Company of NM	Client Sample Info:	Jicarilla L-10 Drip
Work Order:	9806106	Client Sample ID:	9806230930; 4pt. Comp. Walls
Lab ID:	9806106-05A	Matrix:	SOIL
Project:	Jicarilla Pit Remediation	Collection Date:	6/23/98 9:30:00 AM
		COC Record:	5642

Parameter	Result	PQL	Qual	Units	DF	Date Analyzed
DIESEL RANGE ORGANICS		SW8015				
T/R Hydrocarbons: C ⁺ 0-C28	ND	25		mg/Kg	1	Analyst: HR 6/29/98

Qualifiers:

- PQL - Practical Quantitation Limit
- ND - Not Detected at Practical Quantitation Limit
- J - Analyte detected below Practical Quantitation Limit
- B - Analyte detected in the associated Method Blank

- S - Spike Recovery outside accepted recovery limits
- R - RPD outside accepted recovery limits
- E - Value above quantitation range
- Surr: - Surrogate

1 of 1

JICARILLA APACHE TRIBE
ENVIRONMENTAL
PROTECTION OFFICE
P.O. BOX 507
DULCE, NEW MEXICO 87528

SUBMIT 1 COPY TO
NATURAL
RESOURCE DEPT
AND OIL GAS
ADMINISTRATION

ON-SITE SOIL REMEDIATION REPORT

Operator: PNM Gas Services (WFS) Telephone: 324-3764
Address: 603 W. Elm Street Farmington, NM 87401
Facility or Well Name: JICARILLA L-10 DRIP
Location: Unit: D Sec. 9 T. 24 N R. 5 W County Rio Arriba
Land Type: Jicarilla Apache

Date Remediation Started: 6/23/98 Date Completed: 7/22/98
Remediation Method: Landfirmed X Approx. cubic yards 51
Composted
Other

Depth to Ground Water: (pts.) Ø
Distance to an Ephemeral Stream: (pts.) Ø
Distance to Nearest Lake, Playa,
or Watering Pond: (pts.) Ø
Wellhead Protection Area: (pts.) Ø
Distance to Surface Water: (pts.) Ø
Ranking Score (Total Points): Ø

Final Closure Sampling:

Sampling Date: 7/21/98 Time 0837
Sampling Results:
Field Headspace (ppm) 0.0
TPH (ppm) ND Method 8015
Other

I HEREBY CERTIFY THAT THE INFORMATION ABOVE IS TRUE AND COMPLETE TO THE BEST OF MY KNOWLEDGE AND BELIEF

DATE 7/26/98 PRINTED NAME Roy Burnham
SIGNATURE Roy Burnham AND TITLE Environmental Technician II

AFTER REVIEW OF THE SOIL REMEDIATION INFORMATION, ON-SITE REMEDIATION APPROVED IN ACCORDANCE TO THE
JICARILLA APACHE TRIBE PIT CLOSURE ORDINANCE

APPROVED: YES X NO (REASON) use as Backfill
SIGNED: Ken C. Mamm DATE: 7-28-98

JICARIIIA L-10 DRIP
UNIT D SEC 9 T 24 N R-5W
WILLIAMS FIELD SERVICES
LANDFARM

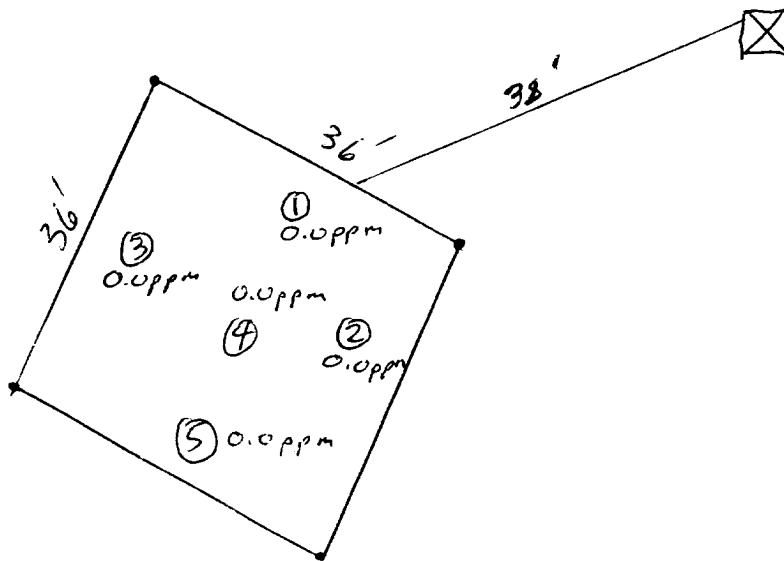

OFF: (505) 325-5667



LAB: (505) 325-1556

On Site Technologies, LTD.

Date: 23-Jul-98

CLIENT: PNM - Public Service Company of NM

Project: PNM Pit Remediation

Lab Order: 9807060

CASE NARRATIVE

Samples were analyzed using the methods outlined in the following references:

Test Methods for Evaluating Solid Waste, Physical/Chemical Methods, SW846, 3rd Edition

All method blanks, laboratory spikes, and/or matrix spikes met quality assurance objectives.

OFF: (505) 325-5667



LAB: (505) 325-1556

ANALYTICAL REPORT

Date: 23-Jul-98

Client:	PNM - Public Service Company of NM	Client Sample Info:	Jicarilla L-10 Drip LF
Work Order:	9807060	Client Sample ID:	9807210837; 5pt. Comp.
Lab ID:	9807060-01A	Matrix:	SOIL
Project:	PNM Pit Remediation	Collection Date:	7/21/98 8:37:00 AM
		COC Record:	7317

Parameter	Result	PQL	Qual	Units	DF	Date Analyzed
DIESEL RANGE ORGANICS		SW8015				Analyst: HR
T/R Hydrocarbons: C10-C28	ND	25		mg/Kg	1	7/22/98

Qualifiers:	PQL - Practical Quantitation Limit	S - Spike Recovery outside accepted recovery limits
	ND - Not Detected at Practical Quantitation Limit	R - RPD outside accepted recovery limits
	J - Analyte detected below Practical Quantitation Limit	E - Value above quantitation range
	B - Analyte detected in the associated Method Blank	Surr: - Surrogate

1 of 1

P.O. BOX 2606 • FARMINGTON, NM 87499