

Denny E. Fort
DEPUTY OIL & GAS INSPECTOR

FEB 6 8 1999

JICARILLA APACHE TRIBE
ENVIRONMENTAL PROTECTION OFFICE
P.O. BOX 507
DULCE, NEW MEXICO 87528

OK
SUBMIT 1 COPY TO
NATURAL
RESOURCE DEPT
AND OIL GAS
ADMINISTRATION

Approved
PIT REMEDIATION AND CLOSURE REPORT

Operator: PNM Gas Services (ForCenergy) Telephone: 324-3764
Address: 603 W. Elm Street Farmington, NM 87401
Facility or Well Name: Jicarilla Apache Tribal 122-2
Location: Unit: P Sec. 4 T. 25 N R. 4 W County Rio Arriba
Pit Type: Separator Dehydrator ☒ Other
Land Type: Jicarilla Apache

Pit Location: Pit dimensions: length 20' width 20' depth 2'
(Attach diagram) Reference: wellhead ☒ other
Footage from reference: 98'
Direction from reference: 20 Degrees ☒ East ☒ North
of West South

Depth to Ground Water:

(Vertical distance from contaminants to seasonal high water elevation of ground water)

Less than 50 feet (20 points)
50 feet to 99 feet (10 points)
Greater than 100 feet (0 points)

Wellhead Protection Area:

(Less than 200 feet from a private domestic water source, or, less than 1,000 feet from all other water sources)

Yes (20 points)
No (0 points)

Distance to Surface Water:

(Horizontal distance to perennial lakes, ponds, rivers, streams, creeks, irrigation canals and ditches)

Less than 200 feet (20 points)
200 feet to 1,000 feet (10 points)
Greater than 1,000 feet (0 points)

Distance to Ephemeral Stream (dry wash):

(Horizontal distance to all downgradient streams having a width of at least 10 feet)

Less than or equal to 100 feet (10 points)
Greater than 100 feet (0 points)

Distance to Nearest Lake, Playa, or Watering Pond:

(Horizontal distance to all downgradient lakes, playes, and livestock or wildlife water ponds)

Less than or equal to 100 feet (10 points)
Greater than 100 feet (0 points)

RANKING SCORE (TOTAL POINTS):

0

Date Remediation Started: 10/26/98 Date Completed: 11/30/98

Remediation Method: Excavation X Approx. Cubic Yards 1697

(Check all appropriate sections)

Landfarmed _____ Amount Landfarmed (cubic yds): 1697

Other _____

Remediation Location: Onsite _____ Offsite JICARILLA LANDFARM #4
(i.e., landfarmed onsite, name and location of offsite facility)

General Description of Remedial Action:

Removed contaminated soil from all four side walls as to get a below 100ppm headspace reading. pit bottom is Sandstone. 3 pt composite of bottom
Final excavation: 42' X 38' X 23' E 22' X 18' X 23'.
(1260 cu yds) (337 cu yds).

Ground Water Encountered: No X Yes _____ Depth _____

Final Pit Closure Sampling:

Sample Location North, East, South, West Side walls and Pit bottom

(if multiple samples, attach sample result and diagram of sample locations and depths.)

Sample depth 23'

Sample date 11/2/98 Sample time 1101 / 1102 ✓

Sample Results

Soil: Benzene (ppm) ND Water: Benzene (ppb) _____

Total BTEX (ppm) 12.42 Toluene (ppb) _____

Field headspace (ppm) 697 Ethylbenzene (ppb) _____

TPH 460 ppm Method 8015 Total Xylenes (ppb) _____

Ground Water Sample: Yes _____ No X (If yes, attach sample results)

I HEREBY CERTIFY THAT THE INFORMATION ABOVE IS TRUE AND COMPLETE TO THE BEST OF MY KNOWLEDGE AND MY BELIEF

DATE 11/23/98

PRINTED NAME Roy Burnham

SIGNATURE Roy Burnham

AND TITLE Environmental Technician II

AFTER REVIEW OF THE PIT CLOSURE INFORMATION, PIT CLOSURE IS APPROVED IN ACCORDANCE TO JICARILLA APACHE TRIBE PIT CLOSURE ORDINANCE.

APPROVED: YES X NO _____ (REASON): _____

SIGNED: Kee C M... DATE: 11-30-98

Jicarilla Apache Tribal 122-2
Sec-4 T-25N R-4W 4L-P
For energy

Site Drawing

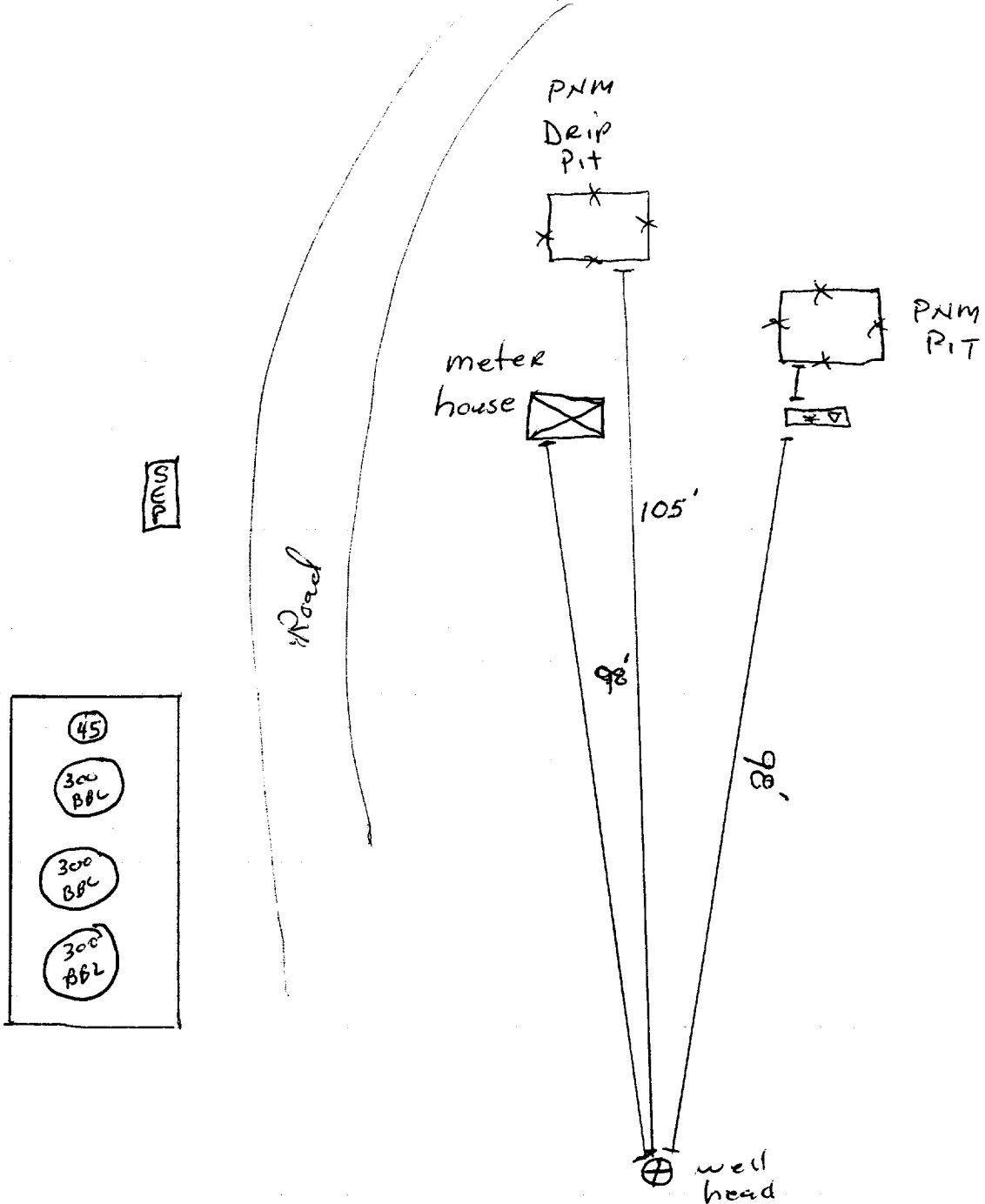

Jicarilla Apache Tribal 122-2
Sec-4 T-25N R-4W 4L-P
Forcenergy

EXCAVATION Drawing

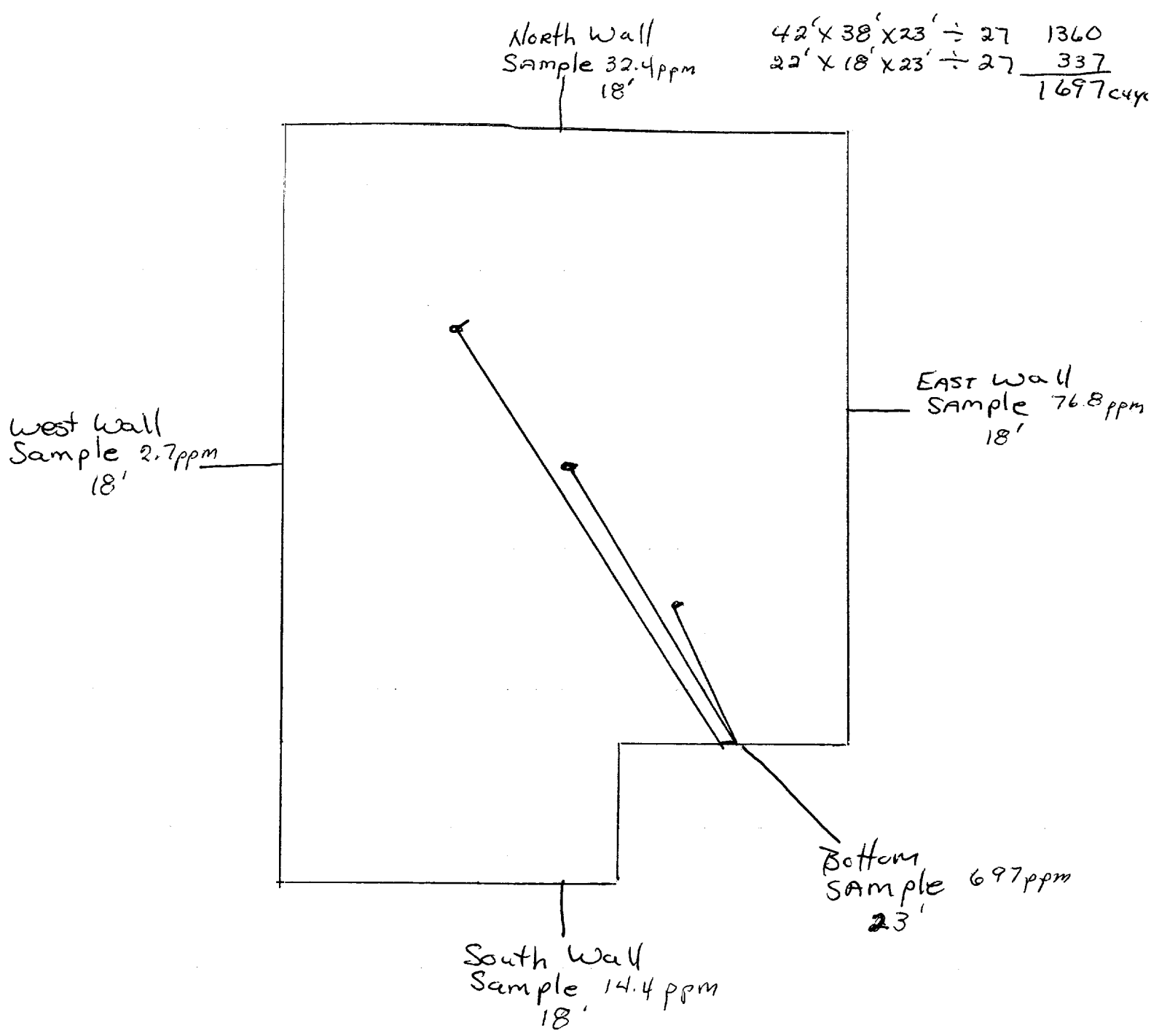

OFF: (505) 325-5667



LAB: (505) 325-1556

On Site Technologies, LTD.

Date: 16-Nov-98

CLIENT: PNM - Public Service Company of NM

Project: Jicarilla Pit Remediation

Lab Order: 9811028

CASE NARRATIVE

Samples were analyzed using the methods outlined in the following references:

Test Methods for Evaluating Solid Waste, Physical/Chemical Methods, SW846, 3rd Edition

All method blanks, laboratory spikes, and/or matrix spikes met quality assurance objectives.

**ANALYTICAL REPORT****Date:** 16-Nov-98

Client: PNM - Public Service Company of NM
Work Order: 9811028
Lab ID: 9811028-02A **Matrix:** SOIL
Project: Jicarilla Pit Remediation

Client Sample Info: Jicarilla Apache Tribal 122-2
Client Sample ID: 9811021102 3pt Comp Bottom
Collection Date: 11/2/98 11:02:00 AM
COC Record: 7360

Parameter	Result	PQL	Qual	Units	DF	Date Analyzed
DIESEL RANGE ORGANICS		SW8015				Analyst: HR
T/R Hydrocarbons: C10-C28	460	25		mg/Kg	1	11/14/98
BTEX		SW8020A				Analyst: HR
Benzene	ND	25		µg/Kg	25	11/9/98
Toluene	1000	50		µg/Kg	25	11/9/98
Ethylbenzene	820	25		µg/Kg	25	11/9/98
m,p-Xylene	9200	50		µg/Kg	25	11/9/98
o-Xylene	1400	25		µg/Kg	25	11/9/98

12420
 12.42 ppm

Qualifiers: PQL - Practical Quantitation Limit
 ND - Not Detected at Practical Quantitation Limit
 J - Analyte detected below Practical Quantitation Limit
 B - Analyte detected in the associated Method Blank

S - Spike Recovery outside accepted recovery limits
 R - RPD outside accepted recovery limits
 E - Value above quantitation range
 Surr: - Surrogate

1 of 1

P.O. BOX 2606 • FARMINGTON, NM 87499

- TECHNOLOGY BLENDING INDUSTRY WITH THE ENVIRONMENT -

OFF: (505) 325-5667



LAB: (505) 325-1556

ANALYTICAL REPORT

Date: 16-Nov-98

Client:	PNM - Public Service Company of NM	Client Sample Info:	Jicarilla Apache Tribal 122-2
Work Order:	9811028	Client Sample ID:	9811021101 4pt Comp Walls
Lab ID:	9811028-01A	Matrix:	SOIL
Project:	Jicarilla Pit Remediation	Collection Date:	11/2/98 11:01:00 AM
		COC Record:	7360

Parameter	Result	PQL	Qual	Units	DF	Date Analyzed
DIESEL RANGE ORGANICS		SW8015				Analyst: HR
T/R Hydrocarbons: C10-C28	140	25		mg/Kg	1	11/14/98

Qualifiers:

PQL - Practical Quantitation Limit

ND - Not Detected at Practical Quantitation Limit

J - Analyte detected below Practical Quantitation Limit

B - Analyte detected in the associated Method Blank

S - Spike Recovery outside accepted recovery limits

R - RPD outside accepted recovery limits

E - Value above quantitation range

Surr: - Surrogate

1 of 1

P.O. BOX 2606 • FARMINGTON, NM 87499

- TECHNOLOGY BLENDING INDUSTRY WITH THE ENVIRONMENT -