

UNITED STATES
DEPARTMENT OF THE INTERIOR
GEOLOGICAL SURVEY

APPLICATION FOR PERMIT TO DRILL, DEEPEN, OR PLUG BACK

1a. TYPE OF WORK DRILL ☒ DEEPEN ☐ PLUG BACK ☐b. TYPE OF WELL
OIL WELL ☒ GAS WELL ☒ OTHER ☐ SINGLE ZONE ☐ MULTIPLE ZONE ☒

2. NAME OF OPERATOR

Supron Energy Corporation

3. ADDRESS OF OPERATOR

P.O. Box 808, Farmington, NM 87401

4. LOCATION OF WELL (Report location clearly and in accordance with any State requirements.)*
At surface 790 ft./S; 790 ft./E line

At proposed prod. zone Same as above

14. DISTANCE IN MILES AND DIRECTION FROM NEAREST TOWN OR POST OFFICE*

7 miles north of Otero, New Mexico

15. DISTANCE FROM PROPOSED*
LOCATION TO NEAREST
PROPERTY OR LEASE LINE, FT.
(Also to nearest drlg. unit line, if any) 790 ft.18. DISTANCE FROM PROPOSED LOCATION*
TO NEAREST WELL, DRILLING, COMPLETED,
OR APPLIED FOR, ON THIS LEASE, FT. 1216 ft.16. NO. OF ACRES IN LEASE
2026.2019. PROPOSED DEPTH
7180 ft.17. NO. OF ACRES ASSIGNED
TO THIS WELL.
5 320 (South Half) / 4020. ROTARY OR CABLE TOOLS
Rotary

21. ELEVATIONS (Show whether DP, RT, GR, etc.)

6699 Gr.

22. APPROX. DATE WORK WILL START*

June 1, 1982

23. PROPOSED CASING AND CEMENTING PROGRAM

SIZE OF HOLE	SIZE OF CASING	WEIGHT PER FOOT	SETTING DEPTH	QUANTITY OF CEMENT
12 1/4"	8 5/8"	24.00	250	200 sx (Circulate)
7 7/8"	5 1/2"	15.50	7180	1100 sx (Cover Ojo Alamo)

We propose to drill a 12 1/4" hole to about 250 ft. using natural mud. 8 5/8", 24.00# casing will be set at approximately 250 ft. The casing will be cemented with enough cement to circulate to the surface (about 200 sacks). We will drill a 7 7/8" hole to total depth of 7180 ft. using a starch-base mud. 5 1/2", 15.50#, K-55 casing will be set at about 7180 ft. with stage collars at about 5250 ft. and 3820 ft. The first stage will be cemented with 250 sacks of 50-50 Pozmix. The second stage will be cemented with 350 sacks of 50-50 Pozmix and 100 sacks of class "B". The third stage will be cemented with 300 sacks of 65-35-6 and 100 sacks of Class "B". We will drill out stage collars and pressure-test casing. We will then perforate and fracture the Dakota zone and run a bridge plug between the zones. The Gallup will be perforated and fractured. The bridge plug will be removed and both zones cleaned up. 2 1/16" tubing will be run to the Dakota zone with a packer to separate the zones. An additional string of 2 1/16" tubing will be run to the Gallup zone. A Packer-Leakage test will be run and the well will be tied into a gas gathering system.

The gas from both zones has been previously dedicated to a gas transporter.

IN ABOVE SPACE DESCRIBE PROPOSED PROGRAM: If proposal is to deepen or plug back, give data on present productive zone and proposed new productive zone. If proposal is to drill or deepen directionally, give pertinent data on subsurface locations and measured and true vertical depths. Give blowout preventer program, if any.

24.

SIGNED

Rudy D. Morro

TITLE Area Superintendent

DATE April 27, 1982

(This space for Federal or State office use)

PERMIT NO.

APPROVAL DATE

APPROVED BY

CONDITIONS OF APPROVAL, IF ANY:

TITLE

MAY 10 1982

MAY 10 1982

APPROVED
AS AMENDEDMAY 6 1982
JAMES F. SIMS
DISTRICT ENGINEER

NEW MEXICO OIL CONSERVATION COMMISSION
WELL LOCATION AND ACREAGE DEDICATION PLAT

Form C-102
Supersedes C-128
Effective 1-1-85

All distances must be from the outer boundaries of the Section.

Operator SUPRON ENERGY CORPORATION			Lease JICARILLA L		Well No. 5-E
Unit Letter P	Section 33	Township 25 NORTH	Range 5 WEST	County RIO ARriba	
Actual Footage Location of Wells 790 feet from the SOUTH line and 790 feet from the EAST line					
Ground Level Elev. 6699	Producing Formation Dakota Gallup		Pool Basin Otero		Dedicated Acreages 5 1/4 320.00 SE of SE 1/4 40.00 Acres

1. Outline the acreage dedicated to the subject well by colored pencil or hachure marks on the plat below.
2. If more than one lease is dedicated to the well, outline each and identify the ownership thereof (both as to working interest and royalty).
3. If more than one lease of different ownership is dedicated to the well, have the interests of all owners been consolidated by communitization, unitization, force-pooling, etc?

☐ Yes ☐ No If answer is "yes," type of consolidation _____

If answer is "no," list the owners and tract descriptions which have actually been consolidated. (Use reverse side of this form if necessary.) _____

No allowable will be assigned to the well until all interests have been consolidated (by communitization, unitization, forced-pooling, or otherwise) or until a non-standard unit, eliminating such interests, has been approved by the Commission.

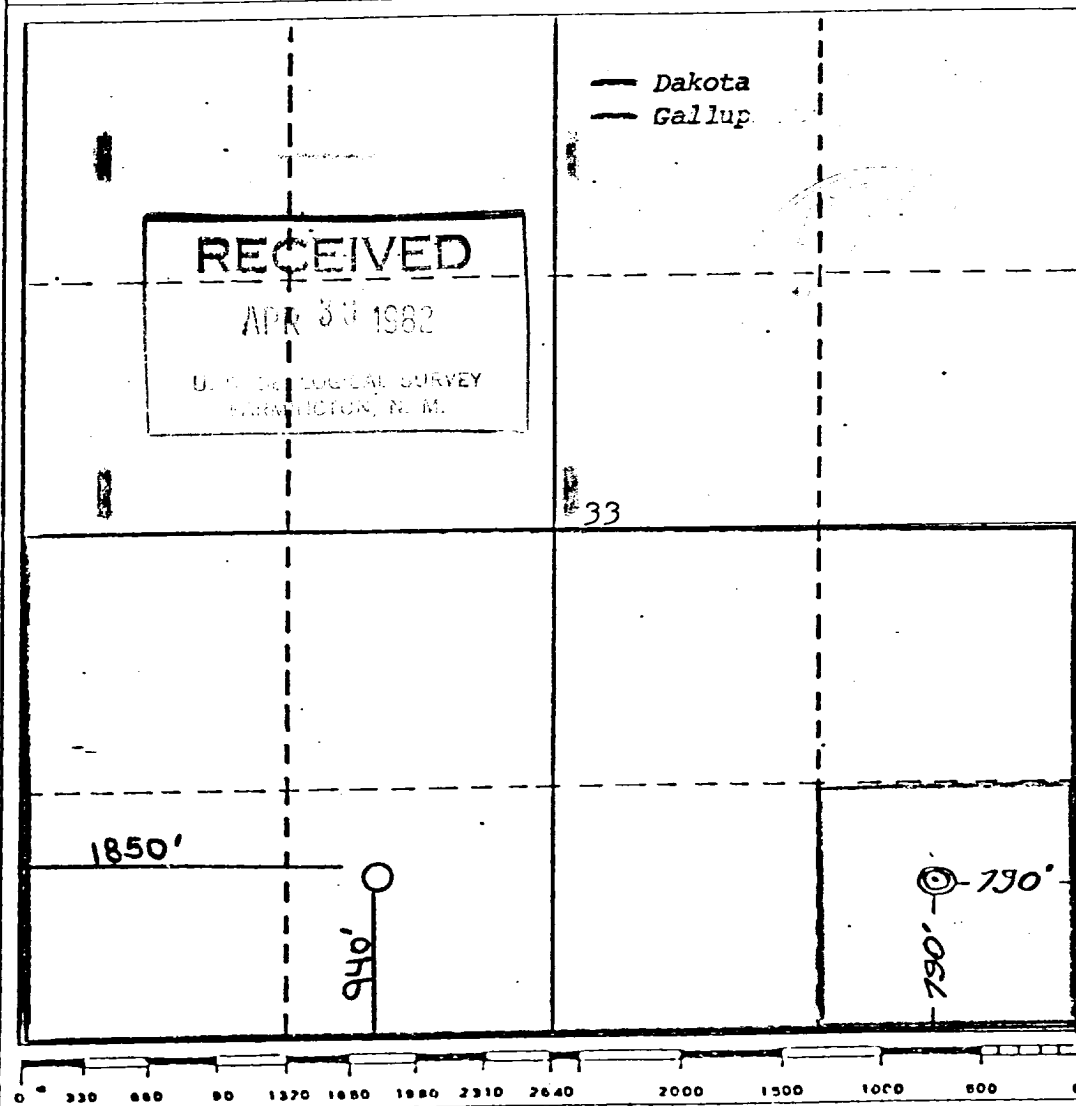

CERTIFICATION

I hereby certify that the information contained herein is true and complete to the best of my knowledge and belief.

Name

Rudy D. Motto

Position

Area Superintendent

Company

Supron Energy Corporation

Date

March 24, 1982

I hereby certify that the well location shown on this plat was plotted from field notes of actual survey made by me or under my supervision, and that the same is true and correct to the best of my knowledge and belief.

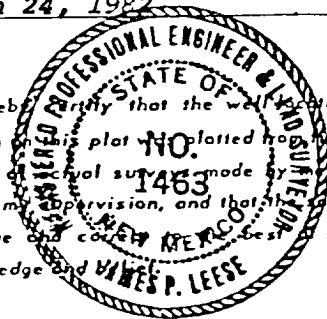

Date Surveyed

March 22, 1982

Registered Professional Engineer and/or Land Surveyor

James P. Leese

Certificate No.

1463

4026' NW
VALLEY MESAL

UNITED STATES

DEPARTI
GE

SUPRON ENERGY CORPORATION
SE $\frac{1}{4}$, Sec. 33, T25N, R5W, N.M.P.M.,
Rio Arriba County, New Mexico

107°22'30"
36°22'30"

290

20

791

4027000m N.

4026

T. 25 N.

T. 24 N.

4025

4024

20

4023

