

NO. OF COPIES RECEIVED	
DISTRIBUTION	
SANTA FE	
FILE	
U.S.G.S.	
LAND OFFICE	
OPERATOR	

NEW MEXICO OIL CONSERVATION COMMISSION



30-039-23057

Form C-101
Revised 1-1-65

5A. Indicate Type of Lease	
STATE <input type="checkbox"/>	FEE <input checked="" type="checkbox"/>

5. State Oil & Gas Lease No.

APPLICATION FOR PERMIT TO DRILL, DEEPEN, OR PLUG BACK

1a. Type of Work		7. Unit Agreement Name	
b. Type of Well DRILL <input checked="" type="checkbox"/> DEEPEN <input type="checkbox"/> PLUG BACK <input type="checkbox"/> OIL WELL <input type="checkbox"/> GAS WELL <input checked="" type="checkbox"/> OTHER <input type="checkbox"/> SINGLE ZONE <input type="checkbox"/> MULTIPLE ZONE <input type="checkbox"/>		8. Farm or Lease Name Canada Mesa Com	
2. Name of Operator Merrion Oil & Gas Corporation		9. Well No. 5	
3. Address of Operator P. O. Box 1017, Farmington, New Mexico 87401		10. Field and Pool, or Wildcat Basin Dakota	
4. Location of Well UNIT LETTER F LOCATED 1520 FEET FROM THE North LINE AND 1650 FEET FROM THE West LINE OF SEC. 10 TWP. 24N RGE. 6W NMPM		12. County Rio Arriba	
19. Proposed Depth 6750'		19A. Formation Dakota	20. Rotary or C.T. 0 - TD
21. Elevations (Show whether DF, RT, etc.) 6441 G.L.	21A. Kind & Status Plug. Bond	21B. Drilling Contractor	22. Approx. Date Work will start Fall, 1982

23.

PROPOSED CASING AND CEMENT PROGRAM

SIZE OF HOLE	SIZE OF CASING	WEIGHT PER FOOT	SETTING DEPTH	SACKS OF CEMENT	EST. TOP
12-1/4"	8-5/8"	24 lb.	200'	170 sx.	
7-7/8"	4-1/2"	11.6 #/ft.	6750'	800 sx.	

Will drill 12-1/4" hole to 200 ft and set 200 ft. of 8-5/8", 24 lb. casing with 170 sx cement. Will drill 7-7/8" hole to 6750' and run open hole logs. If appears productive, will run 6750 ft. of 4-1/2", 11.6 #/ft. casing and cement with 800 sx. Will set stage collar at approximately 2180 ft. and bring cement up across Ojo Alamo Formation. Will set stage collar at approximately 4515 ft. and bring cement up across Mesa Verde Formation. Will perforate and stimulate as required. Minimum specifications for pressure control equipment which is to be used - 10" - 900 series double ram blowout preventer. Gas from this formation is dedicated.

ESTIMATED TOPS

Ojo Alamo	1590	Cliffhouse	3605	Dakota	6395
Kirtland	1660	Menefee	3670		
Fruitland	1875	Pt. Lookout	4280		
Pic. Cliffs	2040	Mancos	4490		
Lewis	2160				

APPROVAL VALID
FOR 90 DAYS UNLESS
DRILLING COMMENCED,

IN ABOVE SPACE DESCRIBE PROPOSED PROGRAM: IF PROPOSAL IS TO DEEPEN OR PLUG BACK, GIVE DATA ON PRESENT PRODUCTIVE ZONE AND PROPOSED NEW PRODUCTIVE ZONE. GIVE BLOWOUT PREVENTER PROGRAM, IF ANY.

I hereby certify that the information above is true and complete to the best of my knowledge and belief.

EXPIRES 2-18-83

Signed [Signature] Title Operations Manager

Date 8/17/82

(This space for State Use)

SUPERVISOR DISTRICT # 3

AUG 19 1982

APPROVED BY [Signature] TITLE

DATE

CONDITIONS OF APPROVAL, IF ANY:

All distances must be from the outer boundaries of the Section.

Operator MERRION OIL & GAS CORPORATION			Lease CANADA MESA COM		Well No. 5
Unit Letter F	Section 10	Township 24N	Range 6W	County Rio Arriba	
Actual Footage Location of Well: 1520 feet from the North line and 1650 feet from the West line					
Ground Level Elev. 6441	Producing Formation Dakota		Pool Basin Dakota		Dedicated Acreage: 1/320 Acres

1. Outline the acreage dedicated to the subject well by colored pencil or hachure marks on the plat below.
2. If more than one lease is dedicated to the well, outline each and identify the ownership thereof (both as to working interest and royalty).
3. If more than one lease of different ownership is dedicated to the well, have the interests of all owners been consolidated by communitization, unitization, force-pooling, etc?

☒ Yes ☐ No If answer is "yes," type of consolidation Communitized

If answer is "no," list the owners and tract descriptions which have actually been consolidated. (Use reverse side of this form if necessary.)

No allowable will be assigned to the well until all interests have been consolidated (by communitization, unitization, forced-pooling, or otherwise) or until a non-standard unit, eliminating such interests, has been approved by the Commission.

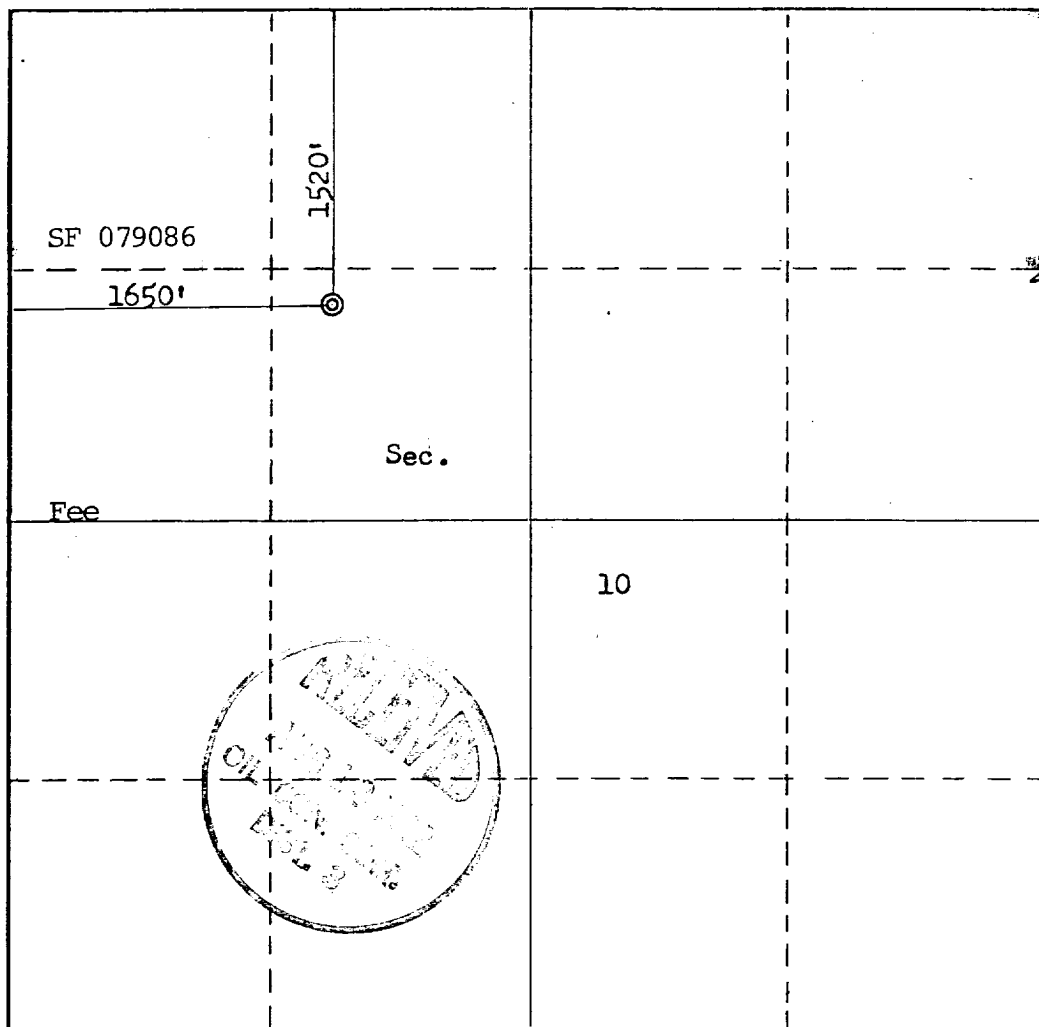

CERTIFICATION

I hereby certify that the information contained herein is true and complete to the best of my knowledge and belief.

Steve S. Dunn
Name

Steve S. Dunn
Position

Operations Manager
Company

Merrion Oil & Gas Corp.
Date

8/16/82

I hereby certify that the well location shown on this plat was plotted from field notes of actual surveys made by me or under my supervision, and that the same is true and correct to the best of my knowledge and belief.

Date Surveyed

August 13, 1982

Registered Professional Engineer and/or Land Surveyor

Fred B. Kerr Jr.
Fred B. Kerr Jr.

Certificate No.

3950

0 330 660 990 1320 1650 1980 2310 2640 2000 1500 1000 500 0