

District I
P.O. Box 1980, Hobbs, NM
District II
P.O. Drawer DD, Artesia, NM
88211
District III
1000 Rio Brazos Rd, Aztec,
NM 87410

sep - Risk backlog

State of New Mexico
Energy, Minerals and Natural Resources Department
OIL CONSERVATION DIVISION
P.O. Box 2088

Santa Fe, New Mexico 87504-2088

SUBMIT 1 COPY TO
APPROPRIATE
DISTRICT OFFICE
AND 1 COPY TO
SANTA FE OFFICE

Revised 3/9/94)

PIT REMEDIATION AND CLOSURE REPORT

Operator: J.B. Gould Company Telephone: (505) 774-6584

Address: P.O. Box 43 Lindrith, New Mexico 87029

Facility Or: Joseph B. Gould 2 Phillips 32,
Well Name

Location: Unit O. Section 32, T25N, R3W

Pit Type: Separator ☒ Dehydrator ☐ Other ☐

Land Type: BLM ☒ State ☐ Fee ☐ Other ☐



Pit Location: Pit dimensions:
length 25', width 25', depth 30 inches below the center of pit
(Attach diagram)

Reference: wellhead ☒ other ☐

Footage from reference: 110'

Direction from reference: 30° Degrees South of East

Depth To Ground Water:

(Vertical distance from
contaminants to seasonal high water elevation of
ground water)

Less than 50 feet (20 points)
50 feet to 99 feet (10 points)
Greater than 100 feet (0 points) 0

Wellhead Protection Area:

(Less than 200 feet from a private domestic water
source, or; less than 1000 feet from all other water
sources)

Yes (20 points)
No (0 points) 0

Distance To Surface Water:

(Horizontal distance to perennial
lakes, ponds, rivers, streams, creeks, irrigation canals
and ditches)

Less than 200 feet (20 points)
200 feet to 1000 feet (10 points)
Greater than 1000 feet (0 points) 0

RANKING SCORE (TOTAL POINTS): 0

Date Remediation Started: January 14, 2000 **Date Completed:** January 14, 2000

Remediation Method: Excavation ☒ Approx. cubic yards 93
(Check all appropriate sections) Landfarmed ☒ Insitu Bioremediation _____
Other _____

Remediation Location: Onsite ☒ Offsite _____
(i.e. landfarmed onsite, name and location of offsite facility)

General Description Of Remedial Action:
Sep pit was excavated to a depth of approximately 30 inches below the center of the pit. Bedrock was encountered at 30 inches below the center of the pit. Samples were taken at the bottom of the excavation. Sidewalls composite taken on 11/02/1999 was below NMOCD standard as reported in *On Site's* report dated 12/7/1999. Excavated soils to be landfarmed onsite.

Ground Water Encountered: No ☒ Yes _____ Depth _____

Final Pit:	Sample location: Refer to attached Table
Closure Sampling: (if multiple samples, attach sample results and diagram of sample locations and depths)	Sample depth _____
	Sample Date _____ Sample Time _____
	Sample Results Refer to attached Table
	Benzene (ppm) _____
	Total BTEX (ppm) _____
	Field headspace (ppm) Refer to attached Table
	TPH _____

Ground Water Sample: Yes _____ No ☒ (If yes, attach sample results)

AS AN AGENT FOR J.B. GOULD COMPANY, I HEREBY CERTIFY THAT THE INFORMATION ABOVE IS TRUE AND COMPLETE TO THE BEST OF MY KNOWLEDGE AND BELIEF

SIGNATURE  DATE 8/23/01
PRINTED NAME Lawrence Trujillo TITLE Senior Environmental Technician

OVM/PID READINGS AND LABORATORY RESULTS

J.B. GOULD #2 PHILLIPS 32 SEP PIT				
Sample Location	PID Units	Date/Time	Diesel Range Organic ppm	Gasoline Range Organics ppm
Center of pit @ bedrock	1800	1/14/00, 12:55	5330.0	86.4
Landfarm 9-point Composite	0.08	1/14/00, 12:30	6930	BDL
SITE ASSESSMENT				
Center of pit @ 20 inches	PID Inop.	11/2/99, 0850	9200.0	461.0
Sidewall Composite @ 3' into sidewall	PID Inop.	11/2/99, 0900	3230.0	0.2
Landfarm Composite	PID Inop.	11/2/99, 08:45	5150.0	0.3

BDL: Below Detection Limits



612 E Murray Dr.
Farmington, NM 87401
PH. (505) 325-5667
FAX. (505) 327-1496

Site Map

Joseph B. Gould 2 Phillips 32
SW/4, SE/4, Sec. 32, T25N, R3W

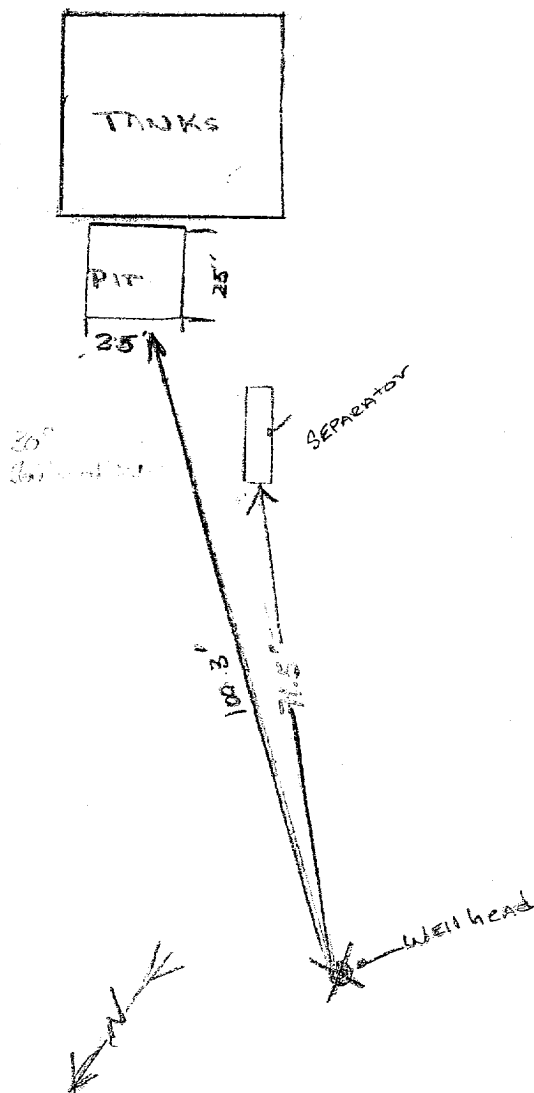

Not to scale

Operator: Joseph B. Gould Company
Location Name: Joseph B. Gould #2 Phillips 32
Location: Unit O. Section 32, T25N, R3W
Risk Ranking: 0

RATIONAL FOR RISK-BASED CLOSURE OF PRODUCTION PITS LOCATED OUTSIDE OF THE VULNERABLE ZONE IN SAN JUAN BASIN

This production pit location was ranked according to the criteria in the New Mexico Oil Conservation Division's Unlined Surface Impoundment Closure Guidelines and received a ranking score of zero. The estimated depth to groundwater is greater than 100-feet beneath ground surface (bgs), the pit is not in a well head protection area, and there is no surface water bodies within 1,000 horizontal feet of the pit location.

The primary source, discharge to pit has been removed. There has been no discharge to the pit for at least four (4) years and the pit has been closed for at least one year.

Each pit was back filled with clean soil and graded in a manner to divert precipitation away from excavated area. Minimal infiltration of rainfall is expected. Any rainfall that does infiltrate the ground surface must migrate through clean backfill before reaching the residual hydrocarbons.

There is no source material at the ground surface, so direct contact with livestock and populous is not likely.

In general, outside of the vulnerable area and alluvial valleys, bedrock material is generally encountered within twenty (20) feet of the ground surface. Bedrock material in the San Juan Basin consists of interbedded sandstone, shale and clays. According to Freeze and Cherry, 1979, the hydraulic conductivity of the bedrock material are as follows:

Sandstone	10^{-9} to 10^{-13} cm/sec
Shale	10^{-12} to 10^{-16} cm/sec
Clay	10^{-12} to 10^{-15} cm/sec

Based on this information, the residual hydrocarbons should not migrate to groundwater.

Natural process (bioremediation) is degrading the residual hydrocarbon to carbon dioxide and water and will continue until source is gone, therefore minimizing any impact to the environment.

Based on the above information, it is highly unlikely that any source material will impact groundwater or ever find an exposure pathway to effect human health, therefore

~~JB Gould and~~ Company requests closure of this pit location.

OFF: (505) 325-5667



LAB: (505) 325-1556

ANALYTICAL REPORT

Date: 28-Jan-00

Client:	On Site Technologies Limited	Client Sample Info:	J.B. Gould #2 Phillip 32
Work Order:	0001014	Client Sample ID:	Center Pit
Lab ID:	0001014-01A	Matrix:	SOIL
Project:	4-1641; J.B. Gould #2 Phillip 32	Collection Date:	1/14/2000 12:50:00 PM
		COC Record:	10488

Parameter	Result	PQL	Qual	Units	DF	Date Analyzed
DIESEL RANGE ORGANICS		SW8015B				Analyst: DM
T/R Hydrocarbons: C10-C28	5330	125		mg/Kg	5	1/21/2000
GASOLINE RANGE ORGANICS		SW8015B				Analyst: DM
T/R Hydrocarbons: C6-C10	86.4	4.5		mg/Kg	25	1/19/2000

Qualifiers:

PQL - Practical Quantitation Limit
ND - Not Detected at Practical Quantitation Limit
J - Analyte detected below Practical Quantitation Limit
B - Analyte detected in the associated Method Blank

S - Spike Recovery outside accepted recovery limits
R - RPD outside accepted recovery limits
E - Value above quantitation range
Sur: - Surrogate

1 of 1

District I
P.O. Box 1980, Hobbs, NM
District II
P.O. Drawer DD, Artesia, NM
88211
District III
1000 Rio Brazos Rd, Aztec,
NM 87410

State of New Mexico
Energy, Minerals and Natural Resources Department

OIL CONSERVATION DIVISION
P.O. Box 2088

SUBMIT 1 COPY TO
APPROPRIATE
DISTRICT OFFICE
AND 1 COPY TO
SANTA FE OFFICE

Landfarm Remediation and Closure Report

Owner/Operator: Joseph B. Gould Company

Telephone: (505) 774-6584

Address: P.O. Box 43 Lindrith, New Mexico 97029

Facility or Well Name: Joseph B. Gould #2 Phillips 32 Landfarm #1

Location: Unit or QTR/Qtr O, Section: 32, T25N, R8W County: Rio Arriba

Land Type BLM X, State , Fee , Other

Landfarm location Length: 120' Width: 50'

Reference: Wellhead: X Other:

Footage from reference: 25 feet

Direction from reference: 25° West of South

Refer to attached map for land farm location

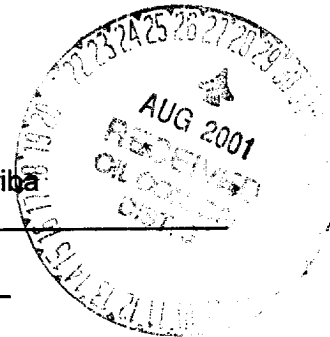

GENERAL DISCRIPTION of LANDFARM ACTIVITIES:

Landfarm was west and north of the well head and measured 120 feet by 50 feet. Soils were placed in landfarm in 8 to 12 inch lifts. Soils were turned approximately every two (2) weeks, when weather allowed. Landfarm was sampled every quarter when weather allowed. For each sampling event 16 grab samples were arbitrarily collect from the landfarm and composited. Refer to attached table for laboratory and field screening results.

SAMPLING INFORMATION

Type of sample: Grab: Composite: 16 points

Sample Depth : 6 to 8 inches

Sample Date: Refer to attached laboratory results Sample Time: Refer to attached laboratory results

Laboratory Analysis: BTEX (ppm) TPH (ppm)

OVM/PID units

Refer to attached map for sample location. Laboratory results attached

AS AN AGENT FOR J.B. GOULD COMPANY, I HEREBY CERTIFY THAT THE INFORMATION ABOVE IS TRUE AND COMPLETE TO THE BEST OF MY KNOWLEDGE AND BELIEF

SIGNATURE

DATE 8-23-01

PRINTED NAME Lawrence Trujillo TITLE Senior Environmental Technician

LANDFARMS LABORATORY RESULTS TABLE

LOCATION/LANDFARM	DATE	OVM/PID READING	DIESEL RANGE ORGANICS (PPM)	GASOLINE RANGE ORGANICS (PPM)
J.B. Gould#2 Land farm #1	1/14/2000	0.8	6930	BDL
J.B. Gould#2 Land farm #1	5/3/2000	0.1	5530	0.32
J.B. Gould#2 Land farm #1	8/8/2000	0.0	3180	BDL



612 E Murray Dr.
Farmington, NM 87401
PH. (505) 325-5667
FAX. (505) 327-1496

Site Map

Landfarm

Location: JB Gould #2 Phillips 32 Unit: O
Section: 32 Township: 25N Range: R8W

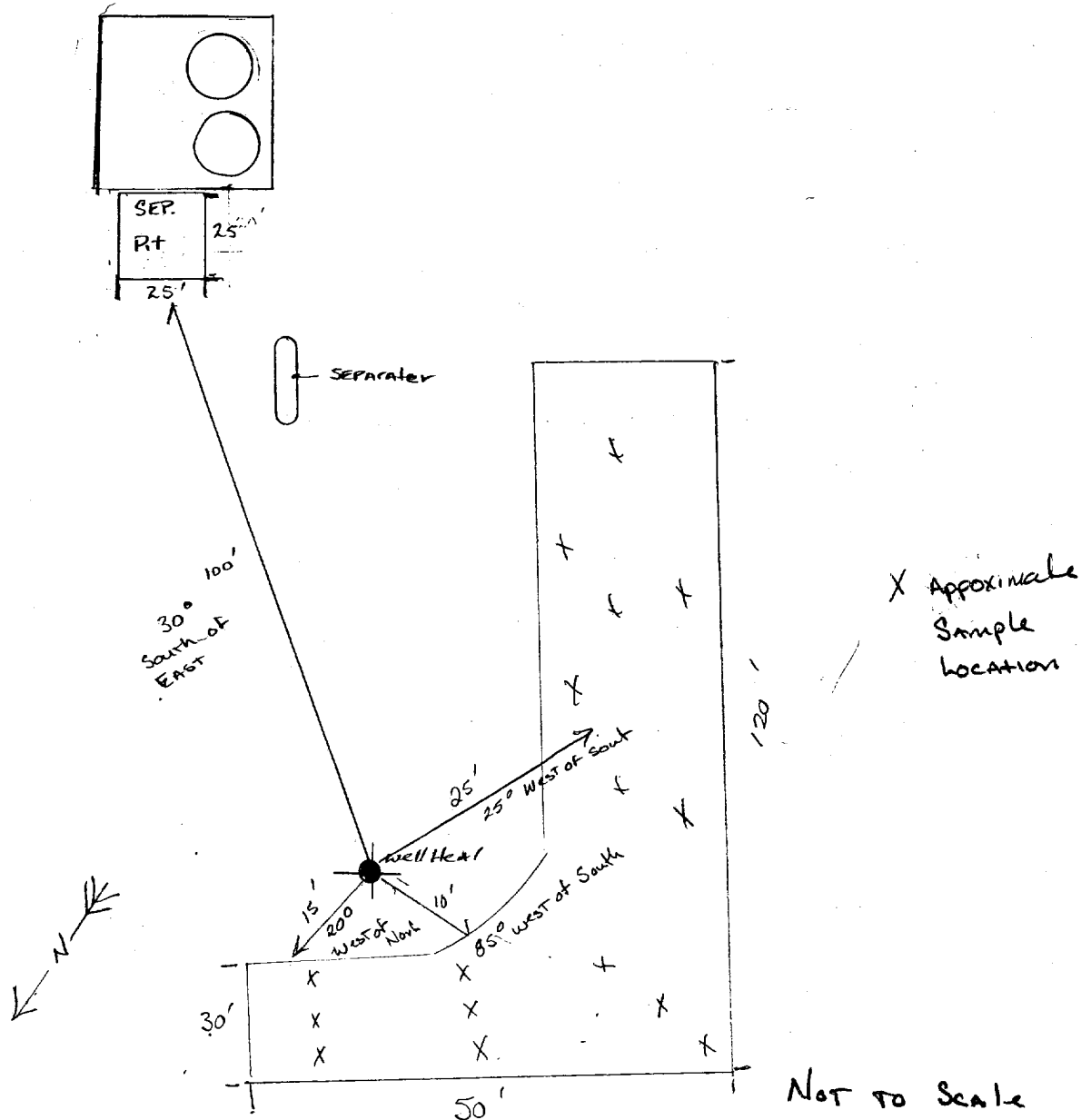

OFF: (505) 325-5667
FAX: (505) 327-1496

ON SITE

TECHNOLOGIES, LTD.

LAB: (505) 325-1556
FAX: (505) 327-1496

ANALYTICAL REPORT

Date: 30-Aug-00

Client:	On Site Technologies Limited	Client Sample Info:	J.B. Gould #2, Phillips 32
Work Order:	0008014	Client Sample ID:	Landfarm Composite
Lab ID:	0008014-01A	Matrix:	SOIL
Project:	4-1641-2; J.B. Gould #2 Phillips 32	Collection Date:	8/8/2000 8:45:00 AM
		COC Record:	10863

Parameter	Result	PQL	Qual	Units	DF	Date Analyzed
DIESEL RANGE ORGANICS		SW8015B				Analyst: DM
T/R Hydrocarbons: C10-C28	3180	25		mg/Kg	1	8/24/2000
GASOLINE RANGE ORGANICS		SW8015B				Analyst: DC
T/R Hydrocarbons: C6-C10	ND	0.18		mg/Kg	1	8/21/2000

Qualifiers:	PQL - Practical Quantitation Limit	S - Spike Recovery outside accepted recovery limits
	ND - Not Detected at Practical Quantitation Limit	R - RPD outside accepted recovery limits
	J - Analyte detected below Practical Quantitation Limit	E - Value above quantitation range
	B - Analyte detected in the associated Method Blank	Surrogate - Surrogate

1 of 1

P.O. BOX 2606 • FARMINGTON, NM 87499

- TECHNOLOGY BLENDING INDUSTRY WITH THE ENVIRONMENT -



CHAIN OF CUSTODY RECORD

Date: 8/16/00

Page: 1 of 1

612 E. Murray Dr. • P.O. Box 2606 • Farmington, NM 87499
LAB: (505) 325-5667 • FAX: (505) 327-1496

Purchase Order No.:		Project No. <u>4-1641-2</u>		REPORT RESULTS TO		Name <u>Lacey Trujillo</u> Title	
SEND INVOICE TO		Name <u>Lacey Trujillo</u>		Company <u>J.E. Gould & Company</u>		Company <u>J.E. Gould & Company</u>	
Address		Dept.		Mailing Address		City, State, Zip	
City, State, Zip				Telephone No.		Telefax No.	
PROJECT LOCATION: <u>J.E. Gould & Co. Phillips St</u> <u>Lawrence, NM</u>				ANALYSIS REQUESTED			
SAMPLER'S SIGNATURE: <u>[Signature]</u>				<div>LAB ID</div> <div>Containers</div> <div>Number of</div> <div>Containers</div> <div>LAB ID</div>			
SAMPLE IDENTIFICATION							
DATE TIME MATRIX PRES.							
<u>8/16/00 0815 501 2001</u>							
Relinquished by: <u>[Signature]</u> Date/Time <u>8/16/00 1300</u>				Received by: Date/Time			
Relinquished by: Date/Time				Received by: Date/Time			
Relinquished by: Date/Time				Received by: Date/Time			
Method of Shipment:				Rush 24-48 Hours 10 Working Days By Date			
Special Instructions / Remarks:							
Authorized by: _____ Date _____							
(Client Signature <u>Must</u> Accompany Request)							

Distribution: White - On Site Yellow - LAB Pink - Sampler Goldenrod - Client