

RECEIVED  
UNITED STATES  
DEPARTMENT OF THE INTERIOR  
GEOLOGICAL SURVEY  
JUL 28 1983Form approved,  
Budget Bureau No. 42-R1425

30-039-23260

## APPLICATION FOR PERMIT TO DRILL OR DEEPEN OR PLUG BACK

## 1a. TYPE OF WORK

DRILL ☒DEEPEN ☐ DIST. 3PLUG BACK ☐

## b. TYPE OF WELL

OIL WELL ☒ GAS WELL ☐ OTHER ☐SINGLE ZONE ☒MULTIPLE ZONE ☐

## 2. NAME OF OPERATOR

Amoco Production Company

## 3. ADDRESS OF OPERATOR

501 Airport Drive, Farmington, NM 87401

## 4. LOCATION OF WELL (Report location clearly and in accordance with any State requirements.)

At surface 1840' FNL &amp; 1850' FWL

At proposed prod. zone same

## 14. DISTANCE IN MILES AND DIRECTION FROM NEAREST TOWN OR POST OFFICE\*

9 miles northwest of Lindrith, New Mexico

## 15. DISTANCE FROM PROPOSED\*

LOCATION TO NEAREST  
PROPERTY OR LEASE LINE, FT.  
(Also to nearest drilg. unit line, if any)

1840'

## 18. DISTANCE FROM PROPOSED LOCATION\*

TO NEAREST WELL, DRILLING, COMPLETED,  
OR APPLIED FOR, ON THIS LEASE, FT.

2688'

## 21. ELEVATIONS (Show whether DF, RT, GR, etc.)

7217'

## 25. PROPOSED CASING AND CEMENTING PROGRAM

SIZE OF HOLE	SIZE OF CASING	WEIGHT PER FOOT	SETTING DEPTH
12-1/4"	8-5/8" (NEW)	24# K-55	300'
7-7/8"	5-1/2" (NEW)	15.5# K-55	8184'

## 16. NO. OF ACRES IN LEASE

2560

## 19. PROPOSED DEPTH

8184'

17. NO. OF ACRES ASSIGNED  
TO THIS WELL

160

## 20. ROTARY OR CABLE TOOLS

Rotary

## 22. APPROX. DATE WORK WILL START\*

As soon as permitted.

This action is subject to administrative  
appeal pursuant to 30 CFR 290.

## QUANTITY OF CEMENT

354 cu. ft. Class "B" w/2% CaCl<sub>2</sub>-circ.  
Stage 1 - 280 cu. ft. Class "B" w/  
50:50 POZ, 6% gel, 2# med tuf plug/  
sx, and 0.8% FLA. Tail in w/118 cu  
ft. Class "B" neat - circ.  
Stage 2 - 900 cu. ft. Class "B" w/  
65:35 POZ, 6% gel, 2# med tuf plug/  
sx, and 0.8% FLA. Tail in w/118 cu  
ft. Class "B" neat - circ.

DV tool set at 5910'.

Amoco proposes to drill the above well to further develop the Gallup-Dakota reservoir. The well will be drilled to the surface casing point using native mud. The well will then be drilled to TD with a low solids non-dispersed mud system. Completion design will be based on open hole logs. Copies of all logs will be filed upon completion. Amoco's standard blowout prevention will be employed; see attached drawing for blowout preventer design.

Upon completion, the well location will be cleaned and the reserve pit filled and leveled.

Gas produced from this well is dedicated to Gas Company of New Mexico under Contract No. 40,825.

IN ABOVE SPACE DESCRIBE PROPOSED PROGRAM: If proposal is to deepen or plug back, give data on present productive zone and proposed new productive zone. If proposal is to drill or deepen directionally, give pertinent data on subsurface locations and measured and true vertical depths. Give blowout preventer program, if any.

24.

Original Signed By  
D. H. SHOEMAKER

TITLE District Engineer

DATE 6-16-83

(This space for Federal or State office use)

PERMIT NO.

APPROVAL DATE

APPROVED  
AS AMENDEDAPPROVED BY  
CONDITIONS OF APPROVAL, IF ANY:

TITLE

DATE JUL 27 1983

AMOCO

J. Bringham  
for Area Mgr

## OIL CONSERVATION DIVISION

P. O. BOX 2088

SANTA FE, NEW MEXICO 87501

Form C-107  
Revised 10-1-78

STATE OF NEW MEXICO

ENERGY AND MINERALS DEPARTMENT

All distances must be from the outer boundaries of the Section.

Operator <b>AMOCO PRODUCTION COMPANY</b>			Lease <b>JICARILLA APACHE TRIBAL 125</b>		Well No. <b>11</b>
Unit Letter <b>F</b>	Section <b>36</b>	Township <b>25N</b>	Range <b>LW</b>	County <b>Rio Arriba</b>	
Actual Footage Location of Well: <b>1840</b> feet from the <b>North</b> line and <b>1850</b> feet from the <b>West</b> line					
Ground Level Elev. <b>7217</b>	Producing Formation <b>Gallup Dakota</b>		Pool <b>West Lindrith Gallup Dakota</b>		Dedicated Acreage: <b>160</b> Acres

1. Outline the acreage dedicated to the subject well by colored pencil or hachure marks on the plat below.
2. If more than one lease is dedicated to the well, outline each and identify the ownership thereof (both as to working interest and royalty).
3. If more than one lease of different ownership is dedicated to the well, have the interests of all owners been consolidated by communitization, unitization, force-pooling, etc?

☐ Yes ☐ No If answer is "yes," type of consolidation \_\_\_\_\_

If answer is "no," list the owners and tract descriptions which have actually been consolidated. (Use reverse side of this form if necessary.) \_\_\_\_\_

No allowable will be assigned to the well until all interests have been consolidated (by communitization, unitization, forced-pooling, or otherwise) or until a non-standard unit, eliminating such interests, has been approved by the Commission.

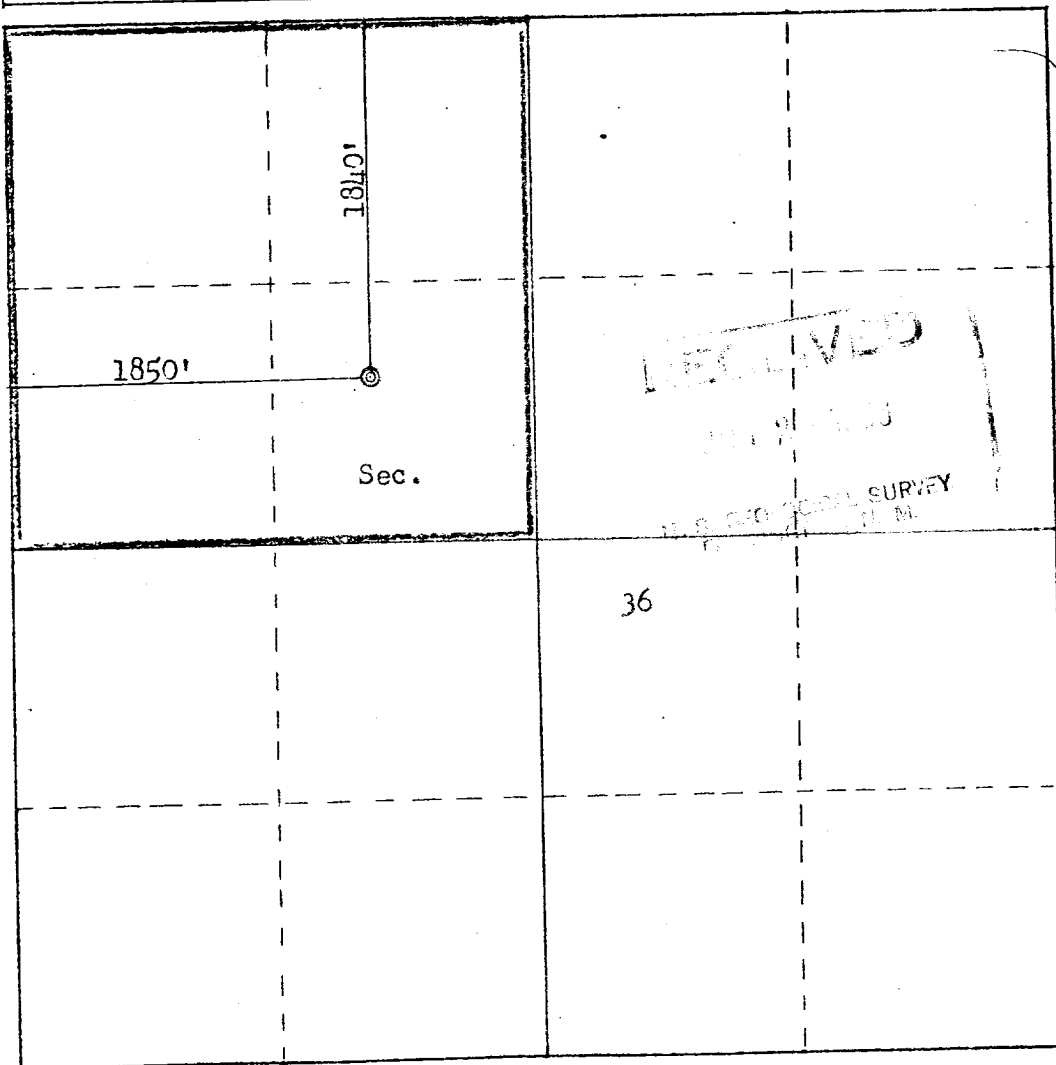

Scale: 1"=1000'

## CERTIFICATION

I hereby certify that the information contained herein is true and complete to the best of my knowledge and belief.

Original Signed by  
**D. H. SHOEMAKER**

Name

**DALE H. SHOEMAKER**

Position

**DISTRICT ENGINEER**

Company

**AMOCO PRODUCTION COMPANY**

Date

**JUNE 6, 1983**

I hereby certify that the well location shown on this plat was plotted from field notes of actual surveys made by me or under my supervision, and that the same is true and correct to the best of my knowledge and belief.

Date Surveyed

**May 27, 1983**

Registered Professional Engineer and Land Surveyor

**Fred B. Kerr Jr.**

Certificate No.

**3950**



UNITED STATES  
DEPARTMENT OF THE INTERIOR  
GEOLOGICAL SURVEY

## SUNDRY NOTICES AND REPORTS ON WELLS

(Do not use this form for proposals to drill or to deepen or plug back to a different reservoir. Use Form 9-331-C for such proposals.)

1. oil well ☒ gas well ☐ other ☐

2. NAME OF OPERATOR

Amoco Production Co.

### 3. ADDRESS OF OPERATOR

501 Airport Dr. Farmington, NM 87401

4. LOCATION OF WELL (REPORT LOCATION CLEARLY. See space 17 below.)

AT SURFACE: 1840' FNL x 1850' FWL

AT TOP PROD. INTERVAL: same

AT TOTAL DEPTH: Same  
Same

16. CHECK APPROPRIATE BOX TO INDICATE NATURE OF NOTICE, REPORT, OR OTHER DATA

REQUEST FOR APPROVAL TO:

### TEST WATER SHUT-OFF

## FRACTURE TREAT

**SHOOT OR ACIDIZE**

REPAIR WELL

PULL OR ALTER CASING

**MULTIPLE COMPLETE**

## CHANGE ZONES

**ABANDON\***

(other) Pipeline Right-of-Way

SUBSEQUENT REPORT OF:

RECEIVED

JUL 14 1983

U. S. GEOLOGICAL SURVEY  
FARMINGTON, N. M.

(NOTE: Report results of multiple completion or zone change on Form 9-230)

RECEIVED

OIL CON. DIV  
DIST. 3

17. DESCRIBE PROPOSED OR COMPLETED OPERATIONS (Clearly state all pertinent details, and give pertinent dates, including estimated date of starting any proposed work. If well is directionally drilled, give subsurface locations and measured and true vertical depths for all markers and zones pertinent to this work.)\*

Amoco Production Co. hereby requests approval of a flowline tie in, which will run from the above well to an existing El Paso Natural Gas Pipeline. The right-of-way requested is 639.1' in length, 30' in width, and will cover approximately .44 acres. The flowline would be constructed of 3" diameter Centron Pronto Loc fiberglass pipe, 500 PSI cyclic working pressure and would be buried 4 to 5 feet deep. Maximum pressure on the flowline would not be expected to exceed 300 PSI. Construction of the flowline would commence immediately upon approval and would last approximately 2 weeks.

Subsurface Safety Valve: Manu. and Type \_\_\_\_\_ Set @ \_\_\_\_\_ Ft.

18. I hereby certify that the foregoing is true and correct.

SIGNED \_\_\_\_\_ TITLE Administrative Supervisor 6-10-83

(This space for Federal or State office use)

APPROVED BY \_\_\_\_\_  
CONDITIONS OF APPROVAL, IF ANY:

TITLE \_\_\_\_\_ DATE \_\_\_\_\_

APPROVED

\*See Instructions on Reverse Side

**NMOCC**

JUL 27 1963  
*John D. Kelly*  
 JAMES F. SIMS  
*Area Manager*  
 DISTRICT OIL & GAS SUPERVISOR