

ENERGY AND MINERALS DEPARTMENT		SANTA FE, NEW MEXICO	
All distances must be from the outer boundaries of the Section.			
Operator Mesa Grande Resources, Inc.		Lease GAVILAN-Howard	
Well No. 1 GAVILAN-HOWARD			
Init Letter F	Section 23	Township 25 N	Range 2 W
		County Rio Arriba	
Actual Footage Location of Wells: 1650.64 feet from the West line and 1850.00 feet from the North line			
Ground Level Elev. 7281.96	Producing Formation Dakota / MANCOS	Pool UNDES / Gavilan	Dedicated Acreage: 40 / 320 acres
<p>1. Outline the acreage dedicated to the subject well by colored pencil or hatchure marks on the plat below.</p> <p>2. If more than one lease is dedicated to the well, outline each and identify the ownership thereof (both as to working interest and royalty).</p> <p>3. If more than one lease of different ownership is dedicated to the well, have the interests of all owners been consolidated by communitization, unitization, force-pooling, etc?</p> <p><input checked="" type="checkbox"/> Yes <input type="checkbox"/> No If answer is "yes," type of consolidation COMMUNITIZATION</p> <p>If answer is "no," list the owners and tract descriptions which have actually been consolidated. (Use reverse side of this form if necessary.)</p> <p>No allowable will be assigned to the well until all interests have been consolidated (by communitization, unitization, forced-pooling, or otherwise) or until a non-standard unit, eliminating such interests, has been approved by the Division.</p>			

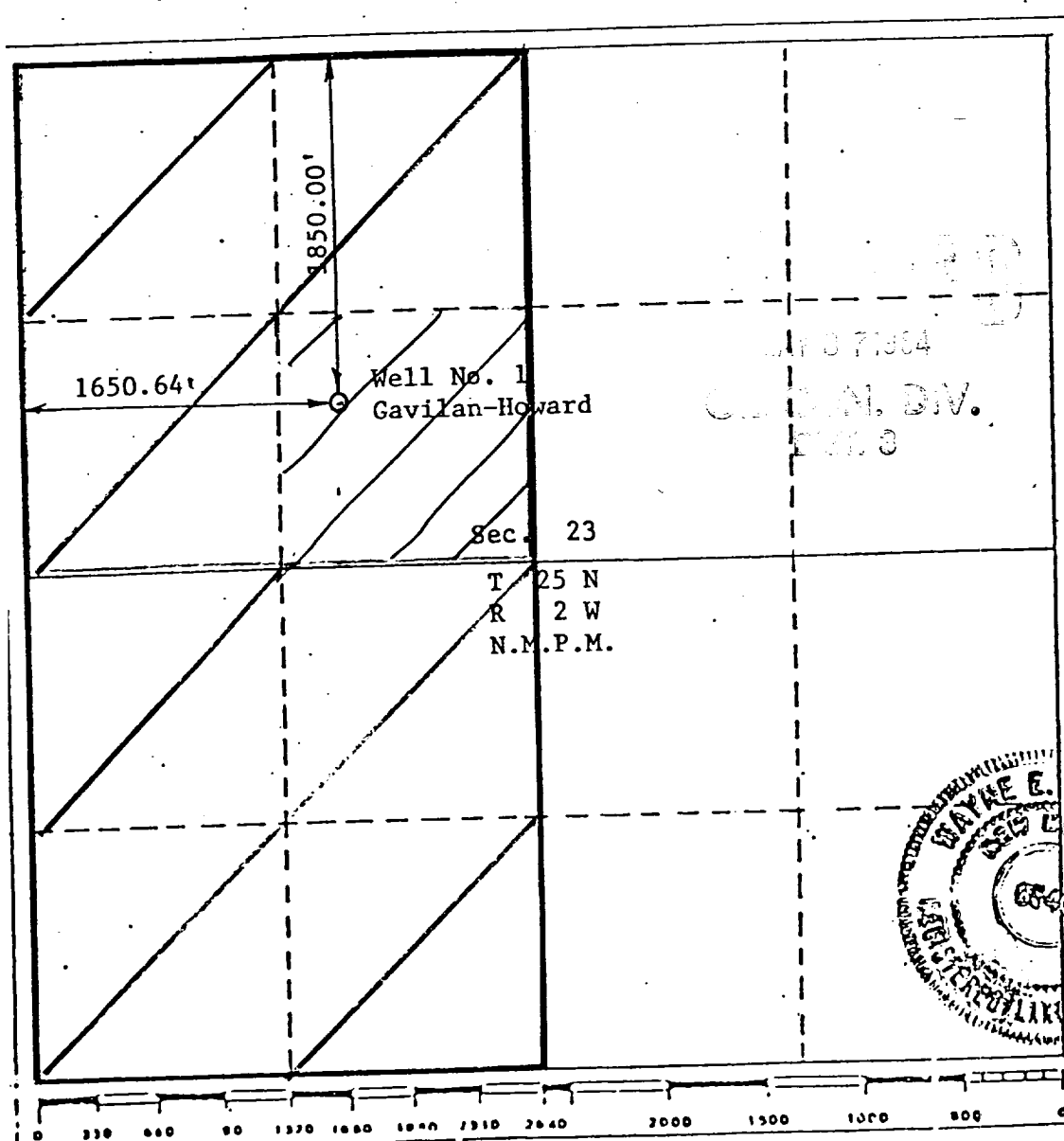

CERTIFICATION	
I hereby certify that the information contained herein is true and complete to the best of my knowledge and belief.	
<i>E. Alex Phillips</i>	Name
President	Position
Mesa Grande Resources, Inc.	Company
September 26, 1983	Date
<p>I hereby certify that the location shown on this plat was placed in the field not actually made by me or under my supervision, and that the same is true and correct to the best of my knowledge and belief.</p> <p>WAYNE E. JOHNSTON August 22, 1983</p> <p><i>Wayne E. Johnston</i> Registered Professional Engineer and Land Surveyor</p>	
6540	Certificate No.