

UNITED STATES
DEPARTMENT OF THE INTERIOR
GEOLOGICAL SURVEY

30-039-23338

5. LEASE DESIGNATION AND SERIAL NO.

SF 078886

6. IF INDIAN, ALLOTTEE OR TRIBE NAME

7. UNIT AGREEMENT NAME

Canyon Largo Unit

8. FARM OR LEASE NAME

Canyon Largo Unit

9. WELL NO.

324

10. FIELD AND POOL, OR WILDCAT

Devils Fork Gallup

11. SEC. T. R. M. OR BLK.

Sec. 20, T-24-N R-6-W

N.M.P.M.

12. COUNTY OR PARISH

Rio Arriba

13. STATE

New Mexico

APPLICATION FOR PERMIT TO DRILL, DEEPEN, OR PLUG BACK

1a. TYPE OF WORK

DRILL ☐

DEEPEN ☐

PLUG BACK ☐

b. TYPE OF WELL

OIL
WELL ☐

GAS
WELL ☐

OTHER

SINGLE
ZONE ☐

MULTIPLE
ZONE ☐

2. NAME OF OPERATOR

El Paso Natural Gas company

3. ADDRESS OF OPERATOR

Box 4289, Farmington, New Mexico 87401

4. LOCATION OF WELL (Report location clearly and in accordance with any State requirements.)
At surface

1850'S, 1465'W

At proposed prod. zone

14. DISTANCE IN MILES AND DIRECTION FROM NEAREST TOWN OR POST OFFICE*

5 Miles North of Counselors; New Mexico 87401

15. DISTANCE FROM PROPOSED*

LOCATION TO NEAREST
PROPERTY OR LEASE LINE, FT.
(Also to nearest drlg. unit line, if any) 1465'

18. DISTANCE FROM PROPOSED LOCATION*

TO NEAREST WELL, DRILLING, COMPLETED,
OR APPLIED FOR, ON THIS LEASE, FT. 2500'

16. NO. OF ACRES IN LEASE

Unit

19. PROPOSED DEPTH

5565'

17. NO. OF ACRES ASSIGNED

TO THIS WELL

20. ROTARY OR CABLE TOOLS

Rotary

21. ELEVATIONS (Show whether DF, RT, GR, etc.)

6585' GL

DRILLING OPERATIONS AUTHORIZED ARE

SUBJECT TO COMPLIANCE WITH ATTACHED

PROPOSED CASING AND CEMENTING PROGRAM
GENERAL REQUIREMENTS

This action is subject to administrative

appeal pursuant to 30 CFR 250.

23.

SIZE OF HOLE	SIZE OF CASING	WEIGHT PER FOOT	SETTING DEPTH	QUANTITY OF CEMENT
12 1/4"	8 5/8"	24#	200'	165 cu. ft. circulated to surface
7 7/8"	4 1/2"	10.5#	5565'	1138 cu. ft. to cover Ojo Alamo

Selectively perforate and sand water frac the Gallup formation.

A 3000 psi WP & 6000 psi test double gate preventor equipped with blind and pipe rams will be used for blow out prevention on this well.

This gas is dedicated/

The W/2 of Section 20 is dedicated to this well.

RECEIVED
NOV 22 1983
OIL CON. DIV.
DIST. 3

IN ABOVE SPACE DESCRIBE PROPOSED PROGRAM: If proposal is to deepen or plug back, give data on present productive zone and proposed new productive zone. If proposal is to drill or deepen directionally, give pertinent data on subsurface locations and measured and true vertical depths. Give blowout preventer program, if any.

24.

SIGNED *D. G. Duisco*

TITLE Drilling Clerk

DATE June 6, 1983

(This space for Federal or State office use)

PERMIT NO.

APPROVAL DATE

APPROVED BY

TITLE

CONDITIONS OF APPROVAL, IF ANY:

ah S

APPROVED
AS AMENDED
NOV 18 1983
[Signature]
AREA MANAGER
FARMINGTON RESOURCE AREA

OIL CONSERVATION DIVISION

STATE OF NEW MEXICO
ENERGY AND MINERALS DEPARTMENTP. O. BOX 2088
SANTA FE, NEW MEXICO 87501Form C-102
Revised 10-1-7

All distances must be from the outer boundaries of the Section.

Operator EL PASO NATURAL GAS COMPANY			Lease Canyon Largo Unit (SF 078886)		Well No. 324
Unit Letter K	Section 20	Township 24-N	Range 6-W	County Rio Arriba	
Actual Footage Location of Well: 1850 feet from the South line and 1465 feet from the West line					
Ground Level Elev. 6585	Producing Formation Gallup		Pool Devils Fork Gallup		Dedicated Acreages 320.00

1. Outline the acreage dedicated to the subject well by colored pencil or hachure marks on the plat below.
2. If more than one lease is dedicated to the well, outline each and identify the ownership thereof (both as to working interest and royalty).
3. If more than one lease of different ownership is dedicated to the well, have the interests of all owners been consolidated by communitization, unitization, force-pooling, etc?

☒ Yes ☐ No If answer is "yes," type of consolidation Unitization

If answer is "no," list the owners and tract descriptions which have actually been consolidated. (Use reverse side of this form if necessary.)

No allowable will be assigned to the well until all interests have been consolidated (by communitization, unitization, forced-pooling, or otherwise) or until a non-standard unit, eliminating such interests, has been approved by the Division

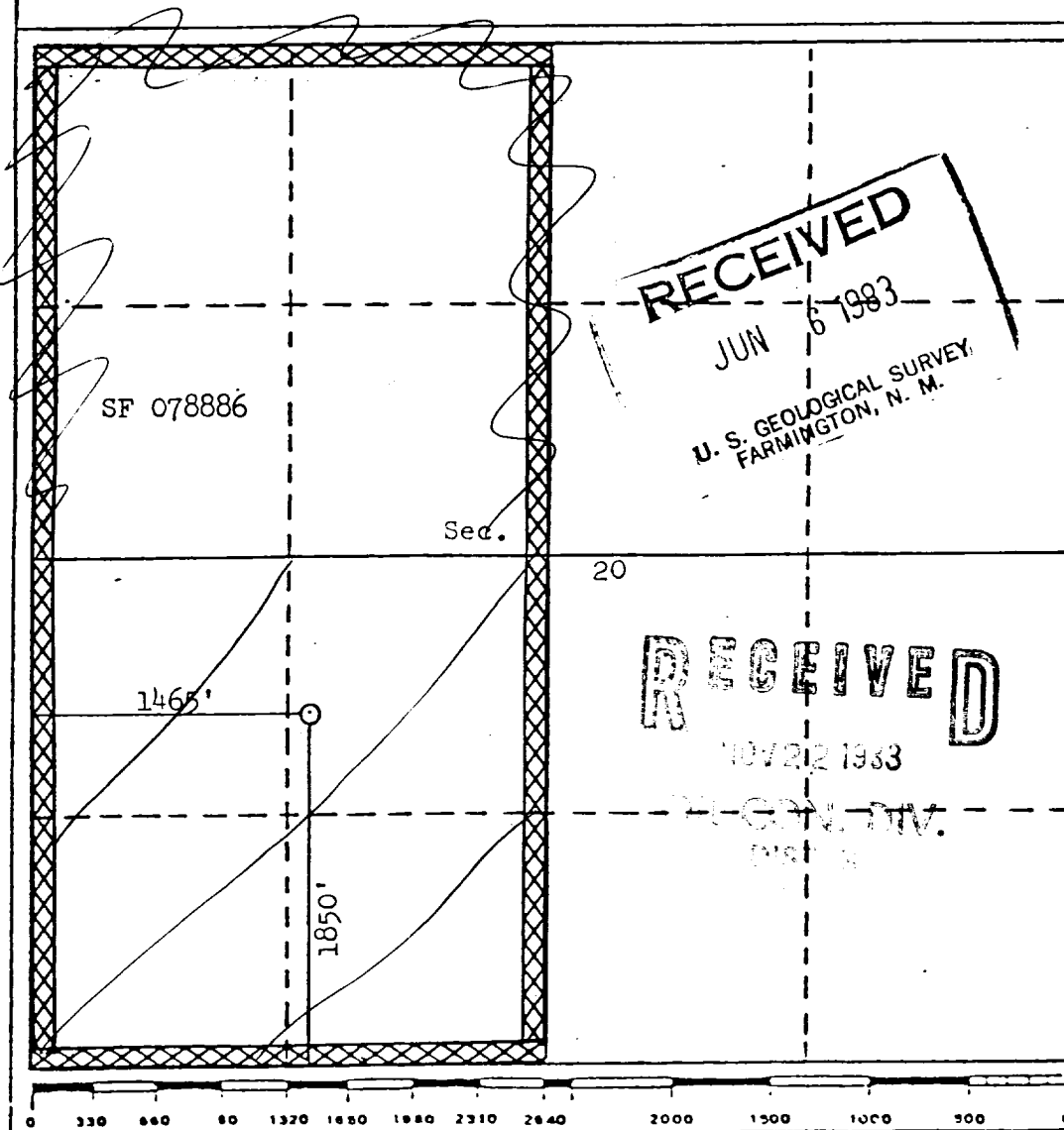

CERTIFICATION

I hereby certify that the information contained herein is true and complete to the best of my knowledge and belief.

D. G. Prisco

Name

Drilling Clerk

Position

El Paso Natural Gas Co

Company

June 6, 1983

Date

I hereby certify that the well location shown on this plat was plotted from field notes of actual surveys made by me or under my supervision, and that the same is true and correct to the best of my knowledge and belief.

Date Surveyed

May 3, 1983

Registered Professional Engineer
and/or Land Surveyor

David M. Kline

Certificate No.

1760