

DEPUTY OIL & GAS INSPECTOR

FEB 08 1999

## JICARILLA APACHE TRIBE

ENVIRONMENTAL PROTECTION OFFICE

P.O. BOX 507  
DULCE, NEW MEXICO 87528

SUBMIT 1 COPY TO  
NATURAL  
RESOURCE DEPT  
AND OIL -GAS  
ADMINISTRATION

Approved  
PIT

# PIT REMEDIATION AND CLOSURE REPORT

<b>Operator:</b>	PNM Gas Services ( WFS )	<b>Telephone:</b>	324-3764
<b>Address:</b>	603 W. Elm Street Farmington, NM 87401		
<b>Facility or Well Name:</b>	JICARILLA N-3 DRIP		
<b>Location:</b>	Unit: <u>  C  </u>	Sec. <u>  4  </u>	T. <u>24 N</u> R. <u>5 W</u> County <u>Rio Arriba</u>
<b>Pit Type:</b>	Separator <u>      </u>	Dehydrator <u>      </u>	Other <u>Line Drip</u>
<b>Land Type:</b>	Jicarilla Apache		

<b>Pit Location:</b>	Pit dimensions:	length <u>18'</u>	width <u>12'</u>	depth <u>4'</u>
(Attach diagram)	Reference:	wellhead <u>      </u>	other <u>Drip Riser</u>	
	Footage from reference:	<u>20'</u>		
	Direction from reference:	<u>DUE</u> Degrees <u>X</u> East	North <u>      </u>	
		<u>      </u> West	South <u>      </u>	

<b>Depth to Ground Water:</b>	Less than 50 feet	(20 points)	
(Vertical distance from contaminants to seasonal high water elevation of ground water)	50 feet to 99 feet	(10 points)	
	Greater than 100 feet	( 0 points)	<u>0</u>

<b>Wellhead Protection Area:</b>	Yes	(20 points)	
(Less than 200 feet from a private domestic water source, or, less than 1,000 feet from all other water sources)	No	( 0 points)	<u>0</u>

<b>Distance to Surface Water:</b>	Less than 200 feet	(20 points)	
(Horizontal distance to perennial lakes, ponds, rivers, streams, creeks, irrigation canals and ditches)	200 feet to 1,000 feet	(10 points)	
	Greater than 1,000 feet	( 0 points)	<u>0</u>

<b>Distance to Ephemeral Stream (dry wash):</b>	Less than or equal to 100 feet	(10 points)	
(Horizontal distance to all downgradient streams having a width of at least 10 feet)	Greater than 100 feet	( 0 points)	<u>0</u>

<b>Distance to Nearest Lake, Playa, or Watering Pond:</b>	Less than or equal to 100 feet	(10 points)	
(Horizontal distance to all downgradient lakes, playas, and livestock or wildlife water ponds)	Greater than 100 feet	( 0 points)	<u>0</u>

<b>RANKING SCORE (TOTAL POINTS) :</b>	<u>0</u>
---------------------------------------	----------

Date Remediation Started: 7/2/98 Date Completed: 8/18/98

Remediation Method: Excavation X Approx. Cubic Yards 813

(Check all appropriate sections)

Landfarmed X Amount Landfarmed (cubic yds): 813

Other \_\_\_\_\_

Remediation Location: Onsite \_\_\_\_\_ Offsite Jicarilla N-3

(i.e., landfarmed onsite, name and location of offsite facility)

**General Description of Remedial Action:**

Removed Contaminated Soil from all four side walls  
as to get a below 100 ppm headspace reading. Pit bottom  
is sandstone rock 3 ft composite of pit bottom  
Final excavation: 35' X 33' X 19'.

Ground Water Encountered: No X Yes \_\_\_\_\_ Depth \_\_\_\_\_

**Final Pit Closure Sampling:**

Sample Location North East West South Side  
walls and Pit bottom

(if multiple samples, attach sample result and diagram of sample locations and depths.)

Sample depth 19'

Sample date 7/6/98 Sample time 1526

**Sample Results**

Soil: Benzene (ppm) \_\_\_\_\_ Water: Benzene (ppb) \_\_\_\_\_

Total BTEX (ppm) \_\_\_\_\_ Toluene (ppb) \_\_\_\_\_

Field headspace (ppm) 60.2 Ethylbenzene (ppb) \_\_\_\_\_

TPH ND ppm Method 8015 Total Xylenes (ppb) \_\_\_\_\_

Ground Water Sample: Yes \_\_\_\_\_ No X (If yes, attach sample results)

I HEREBY CERTIFY THAT THE INFORMATION ABOVE IS TRUE AND COMPLETE TO THE BEST OF MY KNOWLEDGE AND MY BELIEF

DATE Roy B 7/28/98 PRINTED NAME Roy Burnham

SIGNATURE Roy Burnham AND TITLE Environmental Technician II

AFTER REVIEW OF THE PIT CLOSURE INFORMATION, PIT CLOSURE IS APPROVED IN ACCORDANCE TO JICARILLA APACHE TRIBE PIT CLOSURE ORDINANCE.

APPROVED: YES X NO \_\_\_\_\_ (REASON): \_\_\_\_\_

SIGNED: Kenn C Mamm DATE: 7-28-98

Jicarilla N-3 Drip  
Sec-4 T 24N R-5W unit-0

# Site Drawing

N-3 meter house

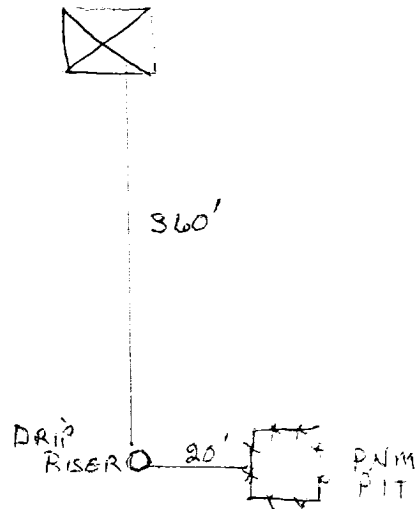

JICARILLA N-3 Drip  
SEC-4 T 24N R-SW unit 0

# EXCAVATION DRAWING

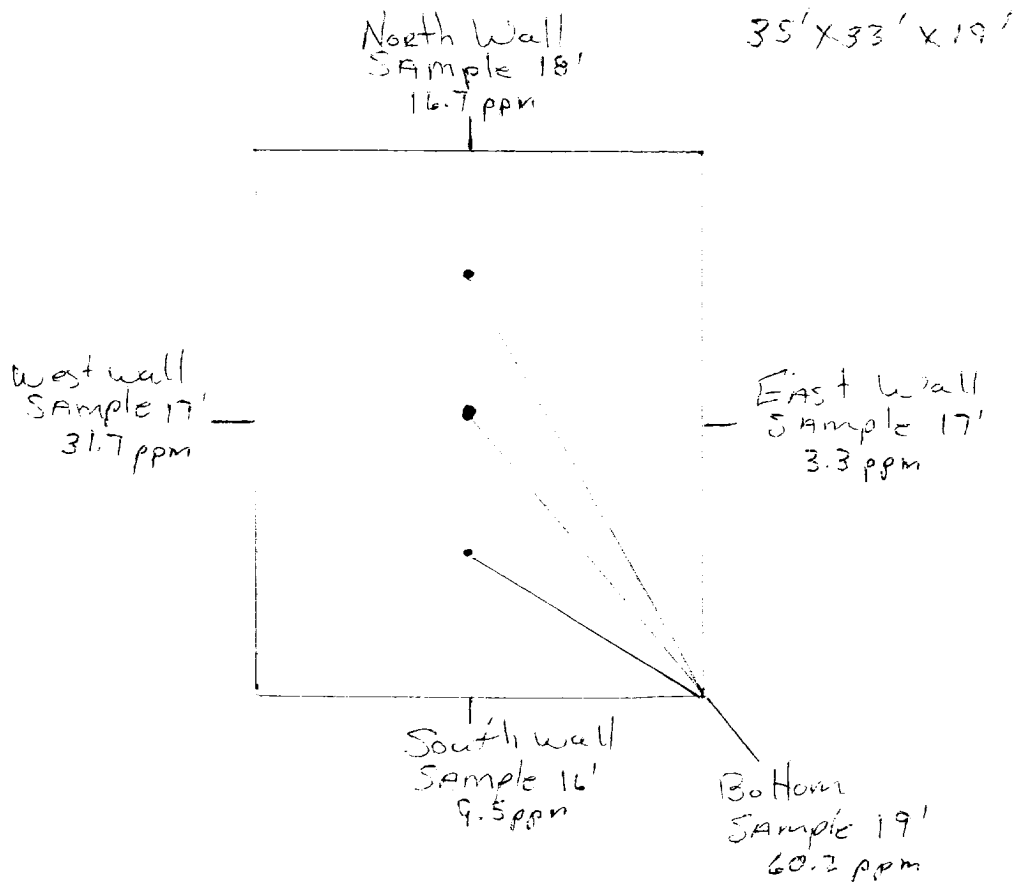

5' sample - 1036 ppm  
10' sample - 923 ppm  
15' sample - 712 ppm  
19' sample - 1291 ppm  
19' sample - 37 ppm  
19' sample - 38 ppm

OFF: (505) 325-5667



LAB: (505) 325-1556

**On Site Technologies, LTD.**

**Date:** 23-Jul-98

---

**CLIENT:** PNM - Public Service Company of NM

**Project:** PNM Pit Remediation

**Lab Order:** 9807020

## **CASE NARRATIVE**

---

Samples were analyzed using the methods outlined in the following references:

Test Methods for Evaluating Solid Waste, Physical/Chemical Methods, SW846, 3rd Edition

All method blanks, laboratory spikes, and/or matrix spikes met quality assurance objectives.

OFF: (505) 325-5667



LAB: (505) 325-1556

## ANALYTICAL REPORT

Date: 23-Jul-98

<b>Client:</b>	PNM - Public Service Company of NM	<b>Client Sample Info:</b>	Jicarilla N-3 Drip
<b>Work Order:</b>	9807020	<b>Client Sample ID:</b>	9807061526; 3pt. Comp. Bottom
<b>Lab ID:</b>	9807020-02A	<b>Matrix:</b>	SOIL
<b>Project:</b>	PNM Pit Remediation	<b>Collection Date:</b>	7/6/98 3:26:00 PM
		<b>COC Record:</b>	5639

Parameter	Result	PQL	Qual	Units	DF	Date Analyzed
<b>DIESEL RANGE ORGANICS</b>		<b>SW8015</b>				Analyst: DC
T/R Hydrocarbons: C10-C28	ND	25		mg/Kg	1	7/14/98

**Qualifiers:**

PQL - Practical Quantitation Limit

S - Spike Recovery outside accepted recovery limits

ND - Not Detected at Practical Quantitation Limit

R - RPD outside accepted recovery limits

J - Analyte detected below Practical Quantitation Limit

E - Value above quantitation range

B - Analyte detected in the associated Method Blank

Surr: - Surrogate

1 of 1

P.O. BOX 2606 • FARMINGTON, NM 87499

- TECHNOLOGY BLENDING INDUSTRY WITH THE ENVIRONMENT -

OFF: (505) 325-5667



LAB: (505) 325-1556

## ANALYTICAL REPORT

Date: 23-Jul-98

<b>Client:</b>	PNM - Public Service Company of NM	<b>Client Sample Info:</b>	Jicarilla N-3 Drip
<b>Work Order:</b>	9807020	<b>Client Sample ID:</b>	9807061525; 4pt. Comp. Walls
<b>Lab ID:</b>	9807020-01A	<b>Matrix:</b>	SOIL
<b>Project:</b>	PNM Pit Remediation	<b>Collection Date:</b>	7/6/98 3:25:00 PM
		<b>COC Record:</b>	5639

Parameter	Result	PQL	Qual	Units	DF	Date Analyzed
<b>DIESEL RANGE ORGANICS</b>		<b>SW8015</b>				Analyst: DC
T/R Hydrocarbons: C10-C28	ND	25		mg/Kg	1	7/14/98

**Qualifiers:**

PQL - Practical Quantitation Limit

ND - Not Detected at Practical Quantitation Limit

J - Analyte detected below Practical Quantitation Limit

B - Analyte detected in the associated Method Blank

S - Spike Recovery outside accepted recovery limits

R - RPD outside accepted recovery limits

E - Value above quantitation range

Surr: - Surrogate

1 of 1

P.O. BOX 2606 • FARMINGTON, NM 87499

- TECHNOLOGY BLENDING INDUSTRY WITH THE ENVIRONMENT -

JICARILLA APACHE TRIBE  
ENVIRONMENTAL  
PROTECTION OFFICE  
P.O. BOX 507  
DULCE, NEW MEXICO 87528

SUBMIT 1 COPY TO  
NATURAL  
RESOURCE DEPT  
AND OIL GAS  
ADMINISTRATION

ON-SITE SOIL REMEDIATION REPORT

Operator: PNM Gas Services ( WFS ) Telephone: 324-3764  
Address: 603 W. Elm Street Farmington, NM 87401  
Facility or Well Name: JICARILLA N-3 DRIP  
Location: Unit: G Sec. 4 T. 24 N R. 5 W County Rio Arriba  
Land Type: Jicarilla Apache

Date Remediation Started: 7/2/98 Date Completed: \_\_\_\_\_  
Remediation Method: Landfirmed ☒ Approx. cubic yards 813  
Composted \_\_\_\_\_  
Other \_\_\_\_\_

Depth to Ground Water: (pts.) φ  
Distance to an Ephemeral Stream: (pts.) φ  
Distance to Nearest Lake, Playa,  
or Watering Pond: (pts.) φ  
Wellhead Protection Area: (pts.) φ  
Distance to Surface Water: (pts.) φ  
Ranking Score (Total Points): φ

Final Closure Sampling:

Sampling Date: 7/30/98 Time 0653  
Sampling Results:  
Field Headspace (ppm) 12.1  
TPH (ppm) ND Method 8015  
Other \_\_\_\_\_

I HEREBY CERTIFY THAT THE INFORMATION ABOVE IS TRUE AND COMPLETE TO THE BEST OF MY KNOWLEDGE AND BELIEF

DATE 8/15/98 PRINTED NAME Roy Burnham  
SIGNATURE Roy Burnham AND TITLE Environmental Technician II

AFTER REVIEW OF THE SOIL REMEDIATION INFORMATION, ON-SITE REMEDIATION APPROVED IN ACCORDANCE TO THE  
JICARILLA APACHE TRIBE PIT CLOSURE ORDINANCE

APPROVED: YES ☒ NO \_\_\_\_\_ (REASON) use as Backfill

SIGNED: Ken C Mammill DATE: 8-18-98



Jicarrilla N-3 Drip  
sec 4 T24N R5W Unit O  
UFS

Land farm

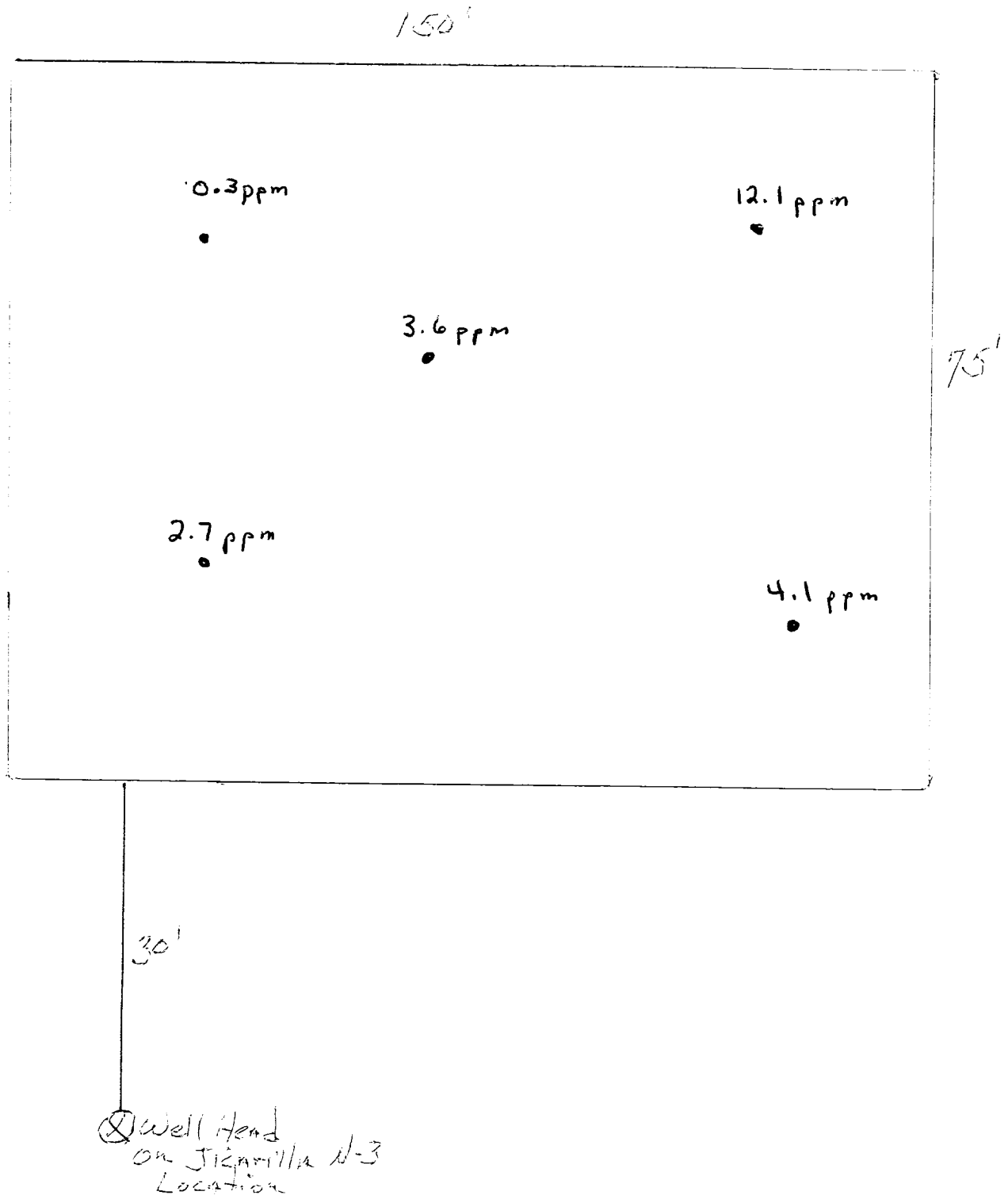

OFF: (505) 325-5667



LAB: (505) 325-1556

**On Site Technologies, LTD.**

**Date:** 04-Aug-98

---

**CLIENT:** PNM - Public Service Company of NM  
**Project:** PNM Pit Remediation  
**Lab Order:** 9807084

---

**CASE NARRATIVE**

Samples were analyzed using the methods outlined in the following references:

Test Methods for Evaluating Solid Waste, Physical/Chemical Methods, SW846, 3rd Edition

All method blanks, laboratory spikes, and/or matrix spikes met quality assurance objectives.

OFF: (505) 325-5667



LAB: (505) 325-1556

## ANALYTICAL REPORT

Date: 04-Aug-98

<b>Client:</b>	PNM - Public Service Company of NM	<b>Client Sample Info:</b>	Jicarilla N-3 Drip LF
<b>Work Order:</b>	9807084	<b>Client Sample ID:</b>	9807300653; 5pt. Comp.
<b>Lab ID:</b>	9807084-05A	<b>Matrix:</b>	SOIL
<b>Project:</b>	PNM Pit Remediation	<b>Collection Date:</b>	7/30/98 6:53:00 AM
		<b>COC Record:</b>	7320

Parameter	Result	PQL	Qual	Units	DF	Date Analyzed
<b>DIESEL RANGE ORGANICS</b>		<b>SW8015</b>				Analyst: HR
T/R Hydrocarbons: C10-C28	ND	25		mg/Kg	1	7/30/98

**Qualifiers:**

PQL - Practical Quantitation Limit

ND - Not Detected at Practical Quantitation Limit

J - Analyte detected below Practical Quantitation Limit

B - Analyte detected in the associated Method Blank

S - Spike Recovery outside accepted recovery limits

R - RPD outside accepted recovery limits

E - Value above quantitation range

Surr: - Surrogate

P.O. BOX 2606 • FARMINGTON, NM 87499

1 of 1