

UNITED STATES
DEPARTMENT OF THE INTERIOR
BUREAU OF LAND MANAGEMENT

APPLICATION FOR PERMIT TO DRILL, DEEPEN, OR PLUG BACK

1a. TYPE OF WORK DRILL <input checked="" type="checkbox"/> DEEPEN <input type="checkbox"/> PLUG BACK <input type="checkbox"/>		5. LEASE DESIGNATION AND SERIAL NO. NM 33008/NM 28702	
b. TYPE OF WELL OIL WELL <input checked="" type="checkbox"/> GAS WELL <input type="checkbox"/> OTHER <input type="checkbox"/> SINGLE ZONE <input type="checkbox"/> MULTIPLE ZONE <input type="checkbox"/>		6. IF INDIAN, ALLOTTEE OR TRIBE NAME	
2. NAME OF OPERATOR Benson-Montin-Greer Drilling Corp.		7. UNIT AGREEMENT NAME Canada Ojitos Unit	
3. ADDRESS OF OPERATOR 221 Petroleum Center Building, Farmington, NM 87401		8. FARM OR LEASE NAME Canada Ojitos Unit	
4. LOCATION OF WELL (Report location clearly and in accordance with any State requirements.) At surface 1650' FSL, 1650' FEL, Sec. 8, T25N, R1W At proposed prod. zone		9. WELL NO. 24	
14. DISTANCE IN MILES AND DIRECTION FROM NEAREST TOWN OR POST OFFICE 1 mile north & 8 miles west of Llaves, NM		10. FIELD AND POOL, OR WILDCAT West Puerto Chiquito Mancos	
15. DISTANCE FROM PROPOSED LOCATION TO NEAREST PROPERTY OR LEASE LINE, FT. (Also to nearest drilg. unit line, if any) 990'		11. SEC., T., R., M., OR BLK. AND SURVEY OR AREA J Sec. 8, T25N, R1W	
16. DISTANCE FROM PROPOSED LOCATION TO NEAREST WELL, DRILLING, COMPLETED, OR APPLIED FOR, ON THIS LEASE, FT.		12. COUNTY OR PARISH Rio Arriba	
17. NO. OF ACRES IN LEASE 320		13. STATE New Mexico	
18. PROPOSED DEPTH 7775'		14. NO. OF ACRES ASSIGNED TO THIS WELL 640	
19. ROTARY OR CABLE TOOLS Rotary		20. APPROX. DATE WORK WILL START As soon as possible	
21. ELEVATIONS (Show whether DF, RT, GR, etc.) 7437' GR		22. APPROX. DATE WORK WILL START As soon as possible	
23. PROPOSED CASING AND CEMENTING PROGRAM			
SIZE OF HOLE 12-1/4"	SIZE OF CASING 9-5/8"	WEIGHT PER FOOT 36# K-55	SETTING DEPTH 500'
8-3/4" to 5000'	7-7/8" 5000' to 77	5-1/2"	15.5# K-55 7775'
QUANTITY OF CEMENT 250 sks (285 cubic feet)			

* First Stage - 200 sacks (235 cubic feet) from TD to 6500'
Second Stage - 150 sacks (225 cubic feet) from 6200' to 5100'
Third Stage - 500 sacks (900 cubic feet) from 3800' to 500'

See attachment for blowout preventer program.

RECEIVED
SEP 14 1984
OIL CON. DIV

IN ABOVE SPACE DESCRIBE PROPOSED PROGRAM: If proposal is to deepen or plug back, give data on present productive zone and proposed new productive zone. If proposal is to drill or deepen directionally, give pertinent data on subsurface locations and measured and true vertical depths. Give blowout preventer program, if any.

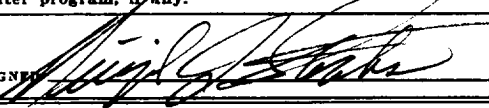
24. SIGNED 		TITLE Vice President		DATE 8/8/84	
(This space for Federal or State office use)				APPROVED AS AMENDED	
PERMIT NO.		APPROVAL DATE		SEP 12 1984	
APPROVED BY		TITLE		DATE	
CONDITIONS OF APPROVAL, IF ANY:		NM000		1st J. Stan McKee M. MILLENBACH AREA MANAGER	

*See Instructions On Reverse Side

NEW MEXICO OIL CONSERVATION COMMISSION
WELL LOCATION AND ACREAGE DEDICATION PLAT

Form C-102
Supersedes C-124
Effective 1-1-65

All distances must be from the outer boundaries of the Section.

Operator BENSON-MONTIN-DRILLING CORP.		Lease Canada Ojitos Unit		Well No. 24 (J-8)
Unit Letter J	Section 8	Township 25 NORTH	Range 1 WEST	County RIO ARRIBA
Actual Footage Location of Well: 1650 feet from the SOUTH line and 1650 feet from the EAST line				
Ground Level Elev. 7437	Producing Formation Niobrara	Pool W. Puerto Chiquito Mancos	Dedicated Acreage: 640 Acres	

1. Outline the acreage dedicated to the subject well by colored pencil or hachure marks on the plat below.
2. If more than one lease is dedicated to the well, outline each and identify the ownership thereof (both as to working interest and royalty).
3. If more than one lease of different ownership is dedicated to the well, have the interests of all owners been consolidated by communitization, unitization, force-pooling, etc?

☒ Yes ☐ No If answer is "yes," type of consolidation Unitization

If answer is "no," list the owners and tract descriptions which have actually been consolidated. (Use reverse side of this form if necessary.)

No allowable will be assigned to the well until all interests have been consolidated (by communitization, unitization, forced-pooling, or otherwise) or until a non-standard unit, eliminating such interests, has been approved by the Commission.

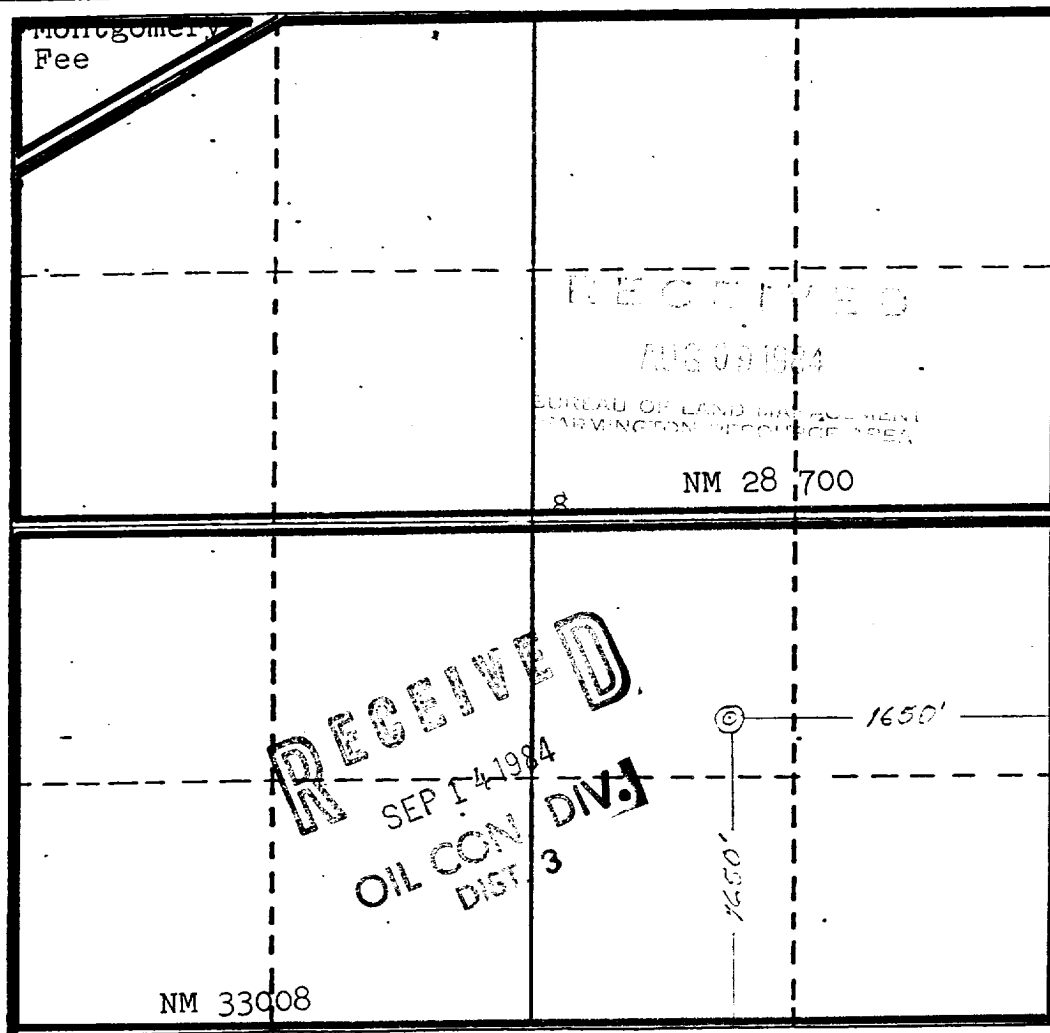

CERTIFICATION

I hereby certify that the information contained herein is true and complete to the best of my knowledge and belief.

Name
Virgil L. Stoabs
Position
Vice President
Company
Benson-Montin-Greer Drilling Corp.
Date
July 27, 1984

I hereby certify that the well location shown on this plat was plotted from field notes of actual surveys made by me or under my supervision, and that the same is true and correct to the best of my knowledge and belief.

Date Surveyed
July 2, 1984
Registered Professional Engineer and/or Land Surveyor
James P. Leese

Certificate No.
1463

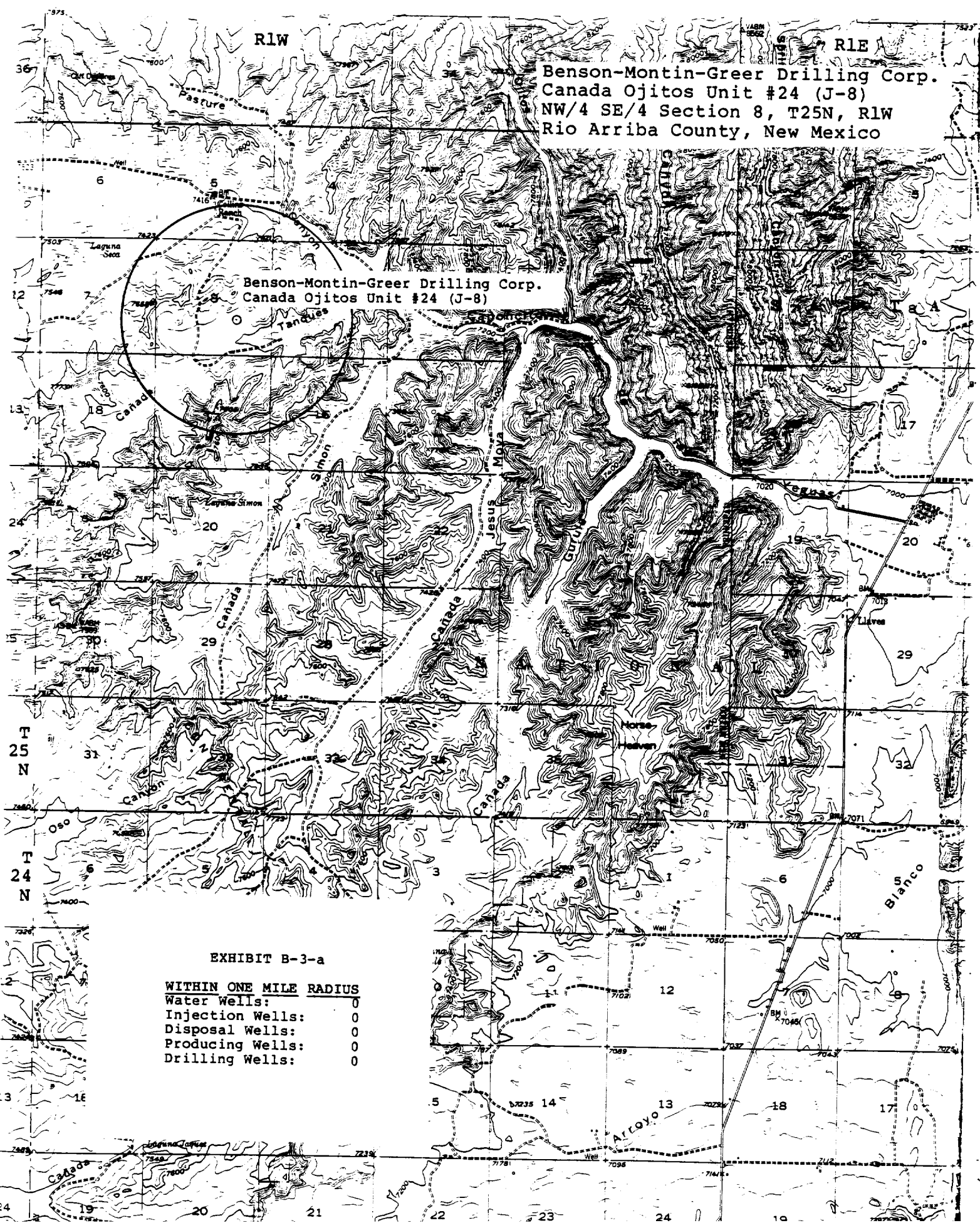

EXHIBIT B-3-a

WITHIN ONE MILE RADIUS
Water Wells: 0
Injection Wells: 0
Disposal Wells: 0
Producing Wells: 0
Drilling Wells: 0