

**NEW MEXICO OIL CONSERVATION COMMISSION
WELL LOCATION AND ACREAGE DEDICATION PLAT**

Form C-102
Supersedes C-128
Effective 1-1-83

All distances must be from the outer boundaries of the Section.

Operator BENSON-MONTIN-DRILLING CORP.			Lease Canada Ojitos Unit		Well No. 26 (K-31)
Unit Letter K	Section 31	Township 25 NORTH	Range 1 WEST	County RIO ARriba	
Actual Footage Location of Well: <div style="display: flex; justify-content: space-between;"> 1650 feet from the SOUTH line and 1650 feet from the WEST line </div>					
Ground Level Elev. 7537	Producing Formation Niobrara	Pool W. Puerto Chiquito Mancos		Dedicated Acreage: 640.00 Acres	

1. Outline the acreage dedicated to the subject well by colored pencil or hachure marks on the plat below.
2. If more than one lease is dedicated to the well, outline each and identify the ownership thereof (both as to working interest and royalty). **Same**
3. If more than one lease of different ownership is dedicated to the well, have the interests of all owners been consolidated by communitization, unitization, force-pooling, etc?

☒ Yes ☐ No If answer is "yes," type of consolidation **Unitization**

If answer is "no," list the owners and tract descriptions which have actually been consolidated. (Use reverse side of this form if necessary.) _____

No allowable will be assigned to the well until all interests have been consolidated (by communitization, unitization, forced-pooling, or otherwise) or until a non-standard unit, eliminating such interests, has been approved by the Commission.

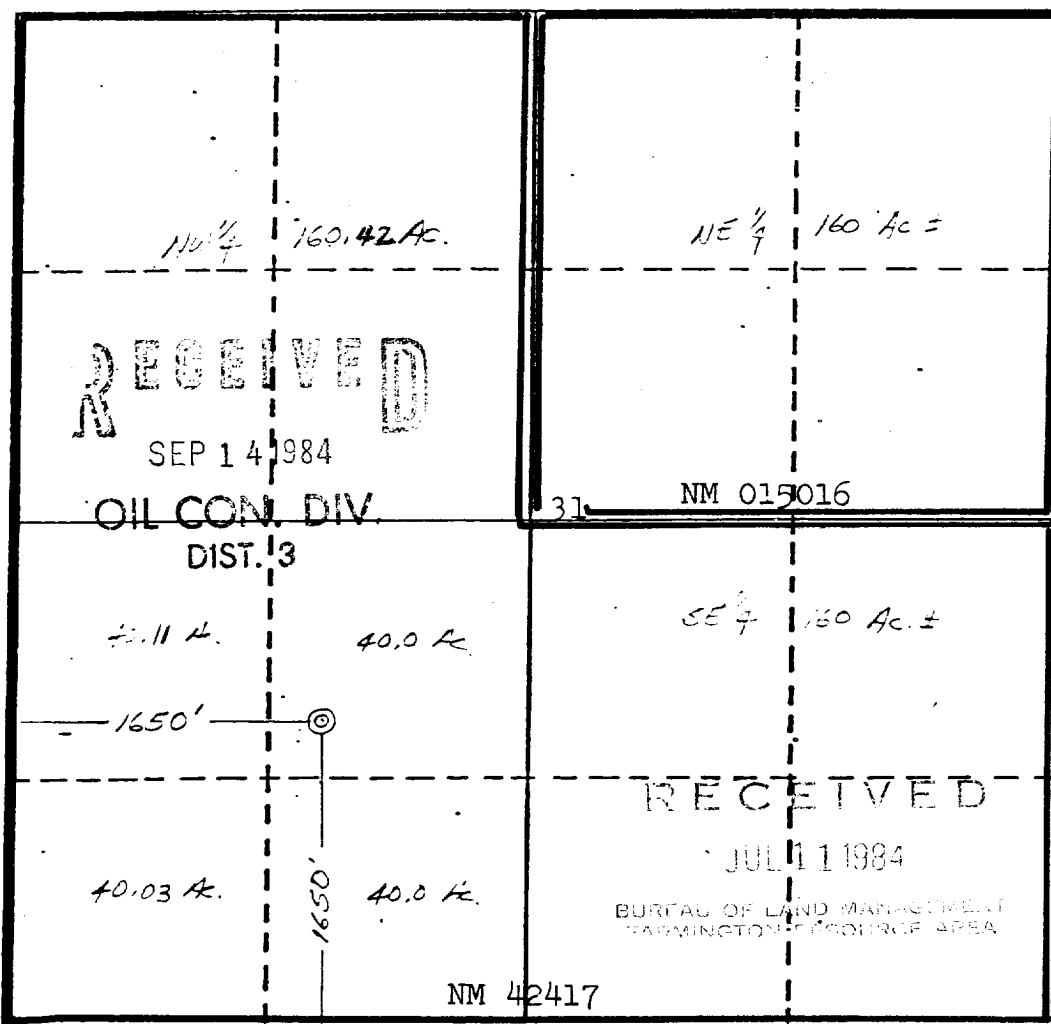

CERTIFICATION

I hereby certify that the information contained herein is true and complete to the best of my knowledge and belief.

Virgil L. Stoabs

Name
Virgil L. Stoabs

Position
Vice President

Company **Benson-Montin Greer Drilling Corp.**

Date
July 9, 1984

I hereby certify that the well location shown on this plat was plotted from field notes of actual surveys made by me or under my supervision, and that the same is true and correct to the best of my knowledge and belief.

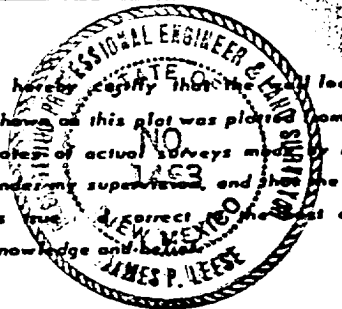

Date Surveyed
July 2, 1984

Registered Professional Engineer and/or Land Surveyor

James P. Leese
James P. Leese

Certificate No.
1463

0 330 660 990 1320 1650 1980 2310 2640 2970 3300 3630 3960 4290 4620 4950 5280 5610 5940 6270 6600

NEW MEXICO-RIO ARRIBA CO. DEPARTMENT OF THE INTERIOR
7.5 MINUTE SERIES (TOPOGRAPHIC) GEOLOGICAL SURVEY

319

320

107° 00'

321000mE

322

323

R 2 W

R 1 W

Benson-Montin-Greer Drilling Corp.
Canada Ojitos Unit #26 (K-31)
NE/4 SW/4 Section 31, T25N, R1W
Rio Arriba County, New Mexico

Monte
Lake

Cañada

Proposed Access Road
Marked In Red

Benson-Montin-Greer Drilling Corp.
Canada Ojitos Unit #26 (K-31)

T
25
N

T
24
N

Canyon

EXHIBIT B-1-b

PROPOSED ACCESS ROAD TO LOCATION
on
Xerox Reproduction of Portion
of Laguna Gurule, NM Quadrangle

NATIONAL