

Denise E. Faust
DEPUTY OIL & GAS INSPECTOR
JICARILLA APACHE TRIBE
ENVIRONMENTAL PROTECTION OFFICE
P.O. BOX 507
DULCE, NEW MEXICO 87528

OCT 08 1999

8JS17

SUBMIT 1 COPY TO

NATURAL RESOURCE DEPT

AND OIL & GAS ADMINISTRATION

Blow - OK
Sept Tank Drain - OK

PIT REMEDIATION AND CLOSURE REPORT

Operator: AMOCO PRODUCTION COMPANY Telephone: (505) 326-9200
Address: 200 Amoco Court, Farmington, NM 87401
Facility or Well Name: JICARILLA CONTRACT 148 - 34
Location: Unit or Qtr/Qtr Sec H Sec H T 25N R 5W County RIO ARriba
Pit Type: Separator Dehydrator Other BLOW
Land Type: RANGE

Pit Location: Pit dimensions: length 35', width 34', depth 8'
(Attach diagram) Reference: wellhead X, other
Footage from reference: 80'
Direction from reference: 14 Degrees East of North
X West of South X

Depth To Groundwater:

(Vertical distance from
contaminants to seasonal
high water elevation of
groundwater)

Less than 50 feet	(20 points)	
50 feet to 99 feet	(10 points)	<u>0</u>
Greater than 100 feet	(0 points)	<u> </u>

Distance to an Ephemeral Stream

(Downgradient dry wash greater than
ten feet in width)

Less than 100 feet	(10 points)	
Greater than 100 feet	(0 points)	<u>0</u>

Distance to Nearest Lake, Playa, or Watering Pond

(Downgradient lakes, playas and
livestock or wildlife watering ponds)

Less than 100 feet	(10 points)	
Greater than 100 feet	(0 points)	<u>0</u>

Wellhead Protection Area:

(Less than 200 feet from a private
domestic water source, or: less than
1000 feet from all other water sources)

Yes	(20 points)	
No	(0 points)	<u>0</u>

Distance To Surface Water:

(Horizontal distance to perennial
lakes, ponds, rivers, streams, creeks,
irrigation canals and ditches)

Less than 100 feet	(20 points)	
100 feet to 1000 feet	(10 points)	<u>0</u>
Greater than 1000 feet	(0 points)	<u> </u>

RANKING SCORE (TOTAL POINTS): 0

BJS17

8LOW PIT

Date Remediation Started: _____

Date Completed: _____

11/23/98

Remediation Method:

(check all appropriate sections)

Excavation ☒Landfarmed ☒

Other _____

Approx. cubic yards _____

125

Insitu Bioremediation _____

Remediation Location:

(i.e. landfarmed onsite,
name and location of
offsite facility)Onsite ☒ Offsite _____General Description of Remedial Action: Excavation

Groundwater Encountered:

No ☒

Yes _____

Depth _____

Final Pit:

Closure Sampling:

(if multiple samples,
attach sample results
and diagram of sample
locations and depths)Sample location see Attached Documents

Sample depth _____

10' (PIT BOTTOM)

Sample date _____

11/22/98

Sample time 1030

Sample Results

Soil: Benzene

(ppm) _____

Water: Benzene

(ppb) _____

Total BTEX

(ppm) _____

Toluene

(ppb) _____

Field Headspace (ppm)

0.0

Ethylbenzene

(ppb) _____

TPH

(ppm)

ND

Total Xylenes

(ppb) _____

Groundwater Sample:

Yes _____

No ☒

(If yes, attach sample results)

I HEREBY CERTIFY THAT THE INFORMATION ABOVE IS TRUE AND COMPLETE TO THE BEST OF MY KNOWLEDGE AND BELIEF

DATE

11/23/98

PRINTED NAME

Buddy D. Shaw

SIGNATURE

Buddy D. Shaw

AND TITLE

Environmental Coordinator

AFTER REVIEW OF THE PIT CLOSURE INFORMATION, PIT CLOSURE IS APPROVED IN ACCORDANCE TO THE JICARILLA APACHE TRIBE PIT CLOSURE ORDINANCE.

APPROVED: YES ☒

NO _____

(REASON) _____

SIGNED:

Kere C Mammall

DATE:

2-6-98

ENVIROTECH LABS

PRACTICAL SOLUTIONS FOR A BETTER TOMORROW

EPA METHOD 418.1 TOTAL PETROLEUM HYDROCARBONS

Client:	Blagg / AMOCO	Project #:	04034-10
Sample ID:	5 @ 10'	Date Reported:	01-23-98
Laboratory Number:	C832	Date Sampled:	01-22-98
Chain of Custody No:	5708	Date Received:	01-23-98
Sample Matrix:	Soil	Date Extracted:	01-23-98
Preservative:	Cool	Date Analyzed:	01-23-98
Condition:	Cool and Intact	Analysis Needed:	TPH-418.1

Parameter	Concentration (mg/kg)	Det. Limit (mg/kg)
Total Petroleum Hydrocarbons	ND	5.0

ND = Parameter not detected at the stated detection limit.

References: Method 418.1, Petroleum Hydrocarbons, Total Recoverable, Chemical Analysis of Water and Waste, USEPA Storet No. 4551, 1978.

Comments: Jicarilla Contract 148-34 Blow Pit.

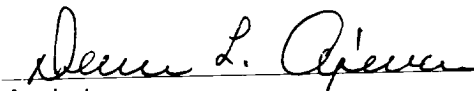
Analyst

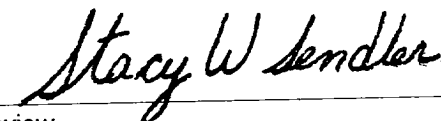
Review

(505) 632-0615

**JICARILLA APACHE TRIBE
ENVIRONMENTAL PROTECTION OFFICE
P.O. BOX 507
DULCE, NEW MEXICO 87528**

87517

SUBMIT 1 COPY TO
NATURAL RESOURCE DEPT
AND OIL & GAS ADMINISTRATION

PIT REMEDIATION AND CLOSURE REPORT

Operator: AMOCO PRODUCTION COMPANY **Telephone:** (505) 326-9200
Address: 200 Amoco Court, Farmington, NM 87401
Facility or Well Name: JICARILLA CONTRACT 148-34
Location: Unit or Qtr/Qtr Sec H Sec 14 T 25N R 5W County RIO ARriba
Pit Type: Separator ☒ Dehydrator ☐ Other PRODUCTION TANK
Land Type: RANGE

Pit Location: (Attach diagram) Pit dimensions: length 27', width 23', depth 13'
Reference: wellhead ☒, other ☐
Footage from reference: 110'
Direction from reference: 16 Degrees ☒ East of North ☒
West of South ☐

Depth To Groundwater: (Vertical distance from contaminants to seasonal high water elevation of groundwater)	Less than 50 feet (20 points) 50 feet to 99 feet (10 points) Greater than 100 feet (0 points)	<u>0</u>
Distance to an Ephemeral Stream (Downgradient dry wash greater than ten feet in width)	Less than 100 feet (10 points) Greater than 100 feet (0 points)	<u>0</u>
Distance to Nearest Lake, Playa, or Watering Pond (Downgradient lakes, playas and livestock or wildlife watering ponds)	Less than 100 feet (10 points) Greater than 100 feet (0 points)	<u>0</u>
Wellhead Protection Area: (Less than 200 feet from a private domestic water source, or: less than 1000 feet from all other water sources)	Yes (20 points) No (0 points)	<u>0</u>
Distance To Surface Water: (Horizontal distance to perennial lakes, ponds, rivers, streams, creeks, irrigation canals and ditches)	Less than 100 feet (20 points) 100 feet to 1000 feet (10 points) Greater than 1000 feet (0 points)	<u>0</u>

RANKING SCORE (TOTAL POINTS): 0

8J517

SEP. / PROD. TANK PIT

Date Remediation Started: _____ Date Completed: 5/4/98

Remediation Method: Excavation ☒ Approx. cubic yards 75
Check all appropriate sections) Landfarmed ☒ Insitu Bioremediation _____
Other _____

Remediation Location: Onsite ☒ Offsite _____
(i.e. landfarmed onsite, name and location of offsite facility)

General Description of Remedial Action: Excavation

Groundwater Encountered: No ☒ Yes _____ Depth _____

Final Pit: Sample location see Attached Documents

Closure Sampling: (if multiple samples, attach sample results and diagram of sample locations and depths)

Sample depth 15' (PIT BOTTOM)

Sample date 5/4/98 Sample time 0930

Sample Results

Soil: Benzene	(ppm)	_____	Water: Benzene	(ppb)	_____
Total BTEX	(ppm)	_____	Toluene	(ppb)	_____
Field Headspace	(ppm)	<u>0.0</u>	Ethylbenzene	(ppb)	_____
TPH	(ppm)	<u>ND</u>	Total Xylenes	(ppb)	_____

Groundwater Sample: Yes _____ No ☒ (If yes, attach sample results)

I HEREBY CERTIFY THAT THE INFORMATION ABOVE IS TRUE AND COMPLETE TO THE BEST OF MY KNOWLEDGE AND BELIEF

DATE 5/4/98 PRINTED NAME Buddy D. Shaw

SIGNATURE Buddy D. Shaw AND TITLE Environmental Coordinator

AFTER REVIEW OF THE PIT CLOSURE INFORMATION, PIT CLOSURE IS APPROVED IN ACCORDANCE TO THE JICARILLA APACHE TRIBE PIT CLOSURE ORDINANCE.

APPROVED: YES ☒ NO _____ (REASON) _____

SIGNED: Ken C Mammill DATE: 5-7-98

CLIENT: <u>AMOCO</u>	BLAGG ENGINEERING, INC. P.O. BOX 87, BLOOMFIELD, NM 87413 (505) 632-1199	LOCATION NO: <u>85517</u> C.O.C. NO: _____
----------------------	--	---

FIELD REPORT: CLOSURE VERIFICATION	PAGE No: <u>1</u> of <u>1</u>
------------------------------------	-------------------------------

LOCATION: NAME <u>TICA CONTR. 148</u> WELL #: <u>34</u> PIT: <u>EP/PROD.</u> QUAD/UNIT: <u>H SEC. 14 TWP. 25N RNG. 5W PM. NM CNTY. RA ST. NM</u> QTR/FOOTAGE: <u>SE 1/4 NE 1/4</u> CONTRACTOR: <u>P+S</u>	DATE STARTED: <u>5/4/98</u> DATE FINISHED: _____ ENVIRONMENTAL SPECIALIST: <u>NV</u>
---	--

EXCAVATION APPROX. <u>27</u> FT. x <u>23</u> FT. x <u>13</u> FT. DEEP.	CUBIC YARDAGE: <u>75</u>
DISPOSAL FACILITY: <u>ON-SITE</u>	REMEDIALATION METHOD: <u>LANDFARMED</u>
LAND USE: <u>RANGE</u>	LEASE: <u>JIC 148</u> FORMATION: <u>OK</u>

FIELD NOTES & REMARKS:	PIT LOCATED APPROXIMATELY <u>110</u> FT. <u>N16E</u> FROM WELLHEAD.
------------------------	---

DEPTH TO GROUNDWATER: <u>7100'</u>	NEAREST WATER SOURCE: <u>>1000'</u>	NEAREST SURFACE WATER: <u>>1000'</u>
------------------------------------	--	---

NMOCD RANKING SCORE: <u>0</u>	NMOCD TPH CLOSURE STD: <u>5000</u> PPM
-------------------------------	--

SOIL AND EXCAVATION DESCRIPTION:

MOSTLY MOD. TO DK. YEEL. BROWN SAND, NON COHESIVE, SLIGHTLY MOIST, FIRM, NO APPARENT STAINING OR HC ODOR OBSERVED W/IN EXCAVATION, NO APPARENT HC ODOR IN ANY OF THE OVM SAMPLES.

CHECK ONE:

- ☒ PIT ABANDONED
- ☐ STEEL TANK INSTALLED
- ☐ FIBERGLASS TANK INSTALLED

CLOSED

FIELD 418.1 CALCULATIONS

TIME	SAMPLE I.D.	LAB No:	WEIGHT (g)	mL. FREON	DILUTION	READING	CALC. ppm
0930	⑤ @ 15'	TPH-1972	5	20	1:1	5	ND

SCALE



PIT PERIMETER

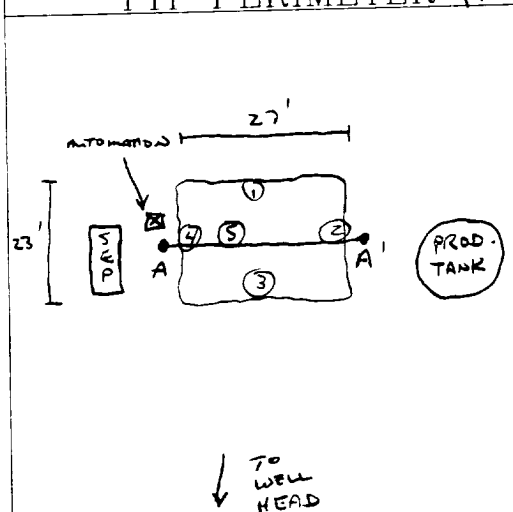

OVM RESULTS

SAMPLE ID	FIELD HEADSPACE PID (ppm)
1 @ 8'	0.0
2 @ 8'	0.0
3 @ 8'	0.0
4 @ 7'	0.0
5 @ 15'	0.0

LAB SAMPLES

SAMPLE ID	ANALYSIS	TIME

PIT PROFILE

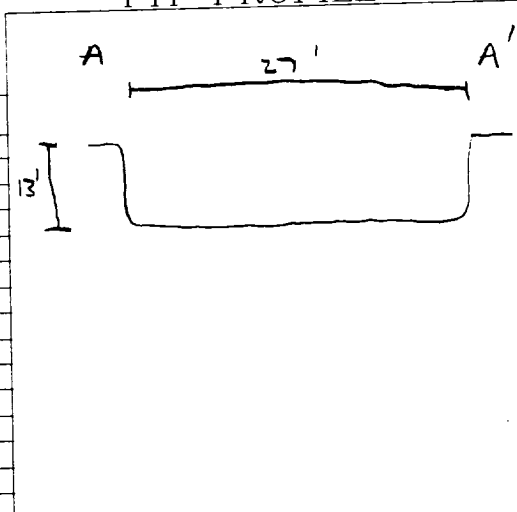

TRAVEL NOTES:	CALLOUT: <u>5/2/98 - MORN.</u>	ONSITE: <u>5/4/98 - MORN.</u>
---------------	--------------------------------	-------------------------------

BLAGG ENGINEERING, INC.

P.O. Box 87, Bloomfield, New Mexico 87413
Phone: (505)632-1199 Fax: (505)632-3903

**FIELD MODIFIED EPA METHOD 418.1
TOTAL PETROLEUM HYDROCARBONS**

Client: AMOCO
Sample ID: 5 @ 15'
Project Location: Jicarilla Contract 148 - 34
Laboratory Number: TPH-1972

Project #:
Date Analyzed: 05-04-98
Date Reported: 05-04-98
Sample Matrix: Soil

Parameter	Result, mg/kg	Detection Limit, mg/kg
Total Recoverable Petroleum Hydrocarbons	ND	20

ND = Not Detectable at stated detection limits.

QA/QC:	QA/QC Sample TPH mg/kg	Duplicate TPH mg/kg	% *Diff.
	1684	1712	1.65

*Administrative Acceptance limits set at 30%.

Method: Modified Method 418.1, Petroleum Hydrocarbons, Total Recoverable, Chemical Analysis of Water and Waste, USEPA Storet No.4551, 1978

Comments: Separator / Production Tank Pit - BJ517

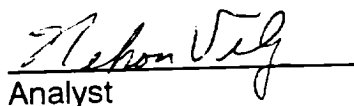
Analyst

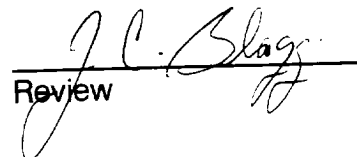
Review

BLAGG ENGINEERING, INC.
P.O. Box 87, Bloomfield, New Mexico 87413
Phone: (505)632-1199 Fax: (505)632-3903

Field TPH-Worksheet

Max Characters:

Client:

Sample ID:

Project Location:

Laboratory Number:

AMOCO

5 @ 15'

Jicarilla Contract 148 - 34

TPH-1972

Project #:

Date Analyzed:

Date Reported:

Sample Matrix:

05-04-98

05-04-98

Soil

Sample Weight: 5.00 grams
Volume Freon: 20.00 mL
Dilution Factor: 1 (unitless)
TPH Reading: 5 mg/kg

TPH Result: 20.0 mg/kg
Reported TPH Result: 20 mg/kg
Actual Detection Limit: 20.0 mg/kg
Reported Detection Limit: 20 mg/kg

QA/QC:	Original TPH mg/kg	Duplicate TPH mg/kg	% Diff.
	----- 1684	----- 1712	----- 1.65

Comments: *****Max Characters*****

Comments: Separator / Production Tank Pit - BJ517

JICARILLA APACHE TRIBE
ENVIRONMENTAL PROTECTION OFFICE
P.O. BOX 507
DULCE, NEW MEXICO 87528

SUBMIT 1 COPY TO
NATURAL RESOURCE DEPT
AND OIL & GAS ADMINISTRATION

ON-SITE SOIL REMEDIATION REPORT

Operator: <u>AMOCO PRODUCTION COMPANY</u>		Telephone: <u>(505) 326-9200</u>
Address: <u>200 Amoco Court, Farmington, NM 87401</u>		
Facility or Well Name: <u>JICARILLA CONTRACT 148-34</u>		
Location: Unit or Qtr/Qtr Sec <u>H</u> Sec <u>14</u> T <u>25N</u> R <u>5W</u> County <u>RIO ARriba</u>		
Land Type: <u>RANGE</u>		
Date Remediation Started: <u>1-22-98</u>		Date Completed: <u>1/12/99</u>
Remediation Method: Landfarmed <input checked="" type="checkbox"/>		Approx. cubic yards <u>200</u>
Composted <input type="checkbox"/>		
Other <input type="checkbox"/>		
Depth To Groundwater: (pts.) <u>0</u>		Final Closure Sampling: Sampling Date: <u>1-7-99</u> Time: <u>1000</u> Sample Results: Field Headspace (ppm) <u>0.0</u> TPH (ppm) <u>69.0</u> Method <u>8015</u> Other _____
Distance to an Ephemeral Stream (pts.) <u>0</u>		
Distance to Nearest Lake, Playa, or Watering Pond (pts.) <u>0</u>		
Wellhead Protection Area: (pts.) <u>0</u>		
Distance To Surface Water: (pts.) <u>0</u>		
RANKING SCORE (TOTAL POINTS): <u>0</u>		
I HEREBY CERTIFY THAT THE INFORMATION ABOVE IS TRUE AND COMPLETE TO THE BEST OF MY KNOWLEDGE AND BELIEF		
DATE <u>1/12/99</u>	PRINTED NAME <u>Buddy D. Shaw</u>	
SIGNATURE <u>Buddy D. Shaw</u>	AND TITLE <u>Environmental Coordinator</u>	
AFTER REVIEW OF THE SOIL REMEDIATION INFORMATION, ON-SITE REMEDIATION IS APPROVED IN ACCORDANCE TO THE JICARILLA APACHE TRIBE PIT CLOSURE ORDINANCE.		
APPROVED: YES _____ NO _____ (REASON) _____		
SIGNED: _____ DATE: _____		

CLIENT: <u>AMOCO</u>	BLAGG ENGINEERING, INC. P.O. BOX 87, BLOOMFIELD, NM 87413 (505) 632-1199	LOCATION NO: <u>83517</u> C.D.C. NO: <u>6536</u>
----------------------	---	---

FIELD REPORT: LANDFARM/COMPOST PILE CLOSURE VERIFICATION

LOCATION: NAME: <u>JICARILLA CONTRACT 148</u> WELL #: <u>34</u> PITS: <u>BLOW, SEP/PROD</u>	DATE STARTED: <u>1.7.99</u>
QUAD/UNIT: <u>H</u> SEC: <u>14</u> TWP: <u>25N</u> RNG: <u>5W</u> PM: <u>NM</u> CNTY: <u>RA</u> ST: <u>NM</u>	DATE FINISHED: <u>1/12/99</u>
QTP/FOOTAGE: <u>SE/4 NE/4</u> CONTRACTOR: <u>P+S</u>	ENVIRONMENTAL SPECIALIST: <u>REP</u>

SOIL REMEDIATION:

 REMEDIATION SYSTEM: LANDFARM

 APPROX. CUBIC YARDAGE: 200

 LAND USE: RANGE

 LIFT DEPTH (ft): 1-2

FIELD NOTES & REMARKS:

 DEPTH TO GROUNDWATER: >100' NEAREST WATER SOURCE: >1000' NEAREST SURFACE WATER: >1000'

 NMOCED RANKING SCORE: 0 NMOCED TPH CLOSURE STD: 5000 PPM

DK YELLOW ORANGE TO DK. BROWN SAND. NON COHESIVE, SLIGHTLY MOIST, FIRM
 SMALL AREA OF STAINING OBSERVED, (SEE SKETCH BELOW) NO H.C. ODOOR DETECTED
 SAMPLING DEPTHS RANGE FROM 6" - 18" TOOK A 5 PT COMPOSITE SAMPLE FOR
 LAB ANALYSIS

CLOSED

FIELD 418.1 CALCULATIONS

SAMP. TIME	SAMPLE I.D.	LAB No.	WEIGHT (g)	mL. FREON	DILUTION	READING	CALC. ppm

SKETCH/SAMPLE LOCATIONS

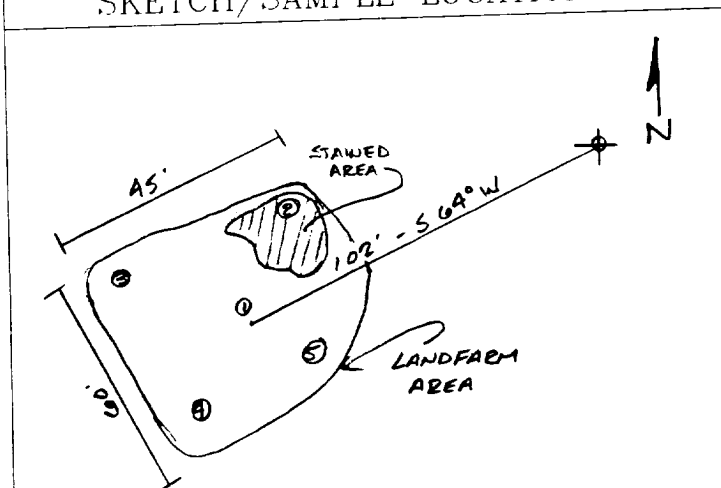

OVM RESULTS

LAB SAMPLES

SAMPLE ID	FIELD HEADSPACE PID (ppm)	SAMPLE ID	ANALYSIS	TIME	RESULTS
LF-1	0.0	LF-1	TPH (80'S)	1000	69.0

SCALE



TRAVEL NOTES:

 CALLOUT: N/A

 ONSITE: 1.7.99

ENVIROTECH LABS

PRACTICAL SOLUTIONS FOR A BETTER TOMORROW

EPA METHOD 8015 Modified Nonhalogenated Volatile Organics Total Petroleum Hydrocarbons

Client:	Blagg / AMOCO	Project #:	04034-10
Sample ID:	LF - 1	Date Reported:	01-11-99
Laboratory Number:	E481	Date Sampled:	01-07-99
Chain of Custody No:	6536	Date Received:	01-08-99
Sample Matrix:	Soil	Date Extracted:	01-11-99
Preservative:	Cool	Date Analyzed:	01-11-99
Condition:	Cool and Intact	Analysis Requested:	8015 TPH

Parameter	Concentration (mg/Kg)	Det. Limit (mg/Kg)
Gasoline Range (C5 - C10)	8.6	0.2
Diesel Range (C10 - C28)	60.4	0.1
Total Petroleum Hydrocarbons	69.0	0.2

ND - Parameter not detected at the stated detection limit.

References: Method 8015B, Nonhalogenated Volatile Organics, Test Methods for Evaluating Solid Waste, SW-846, USEPA, December 1996.

Comments: Jicarilla Contract 148 - 34 Landfarm. 5 Pt. Composite.

Analyst

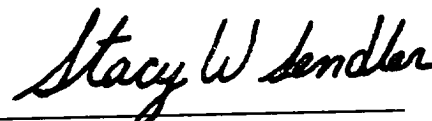
Review

6536

129 Cox's 6536 - 6740