

STATE OF NEW MEXICO
ENERGY AND MINERALS DEPARTMENT

OIL CONSERVATION DIVISION

P. O. BOX 2088

SANTA FE, NEW MEXICO 87501

Form C-101
Revised 10-1-78

NO. OF COPIES RECEIVED	
DISTRIBUTION	
SANTA FE	
FILE	
U.S.G.S.	
LAND OFFICE	
OPERATOR	

APPROVAL EXPIRES 10-7-87 APR 02 1987
UNLESS DRILLING IS COMMENCED.
SPUD NOTICE MUST BE SUBMITTED
WITHIN 10 DAYS.

CON. DIV.
DIST. 3

5A. Indicate Type of Lease
STATE ☐ FEE ☒
5. State Oil & Gas Lease No.

APPLICATION FOR PERMIT TO DRILL, DEEPEN, OR PLUG BACK

1a. Type of Work b. Type of Well DRILL <input checked="" type="checkbox"/> DEEPEN <input type="checkbox"/> PLUG BACK <input type="checkbox"/> OIL WELL <input checked="" type="checkbox"/> GAS WELL <input type="checkbox"/> OTHER <input type="checkbox"/> SINGLE ZONE <input checked="" type="checkbox"/> MULTIPLE ZONE <input type="checkbox"/>		7. Well Agreement Name
2. Name of Operator T. H. McElvain Oil & Gas Properties		8. Form or Lease Name FD
3. Address of Operator P. O. Box 2148, Santa Fe, NM 87504-2148		9. Well No. #1
4. Location of Well UNIT LETTER <u>H</u> LOCATED <u>2840</u> FEET FROM THE <u>North</u> LINE AND <u>950'</u> FEET FROM THE <u>East</u> LINE OF SEC. <u>1</u> TWP. <u>25N</u> RGE. <u>3W</u> NMPM		10. Field and Pool, or Wildcat Ojito Gallup-Dakota
11. County Rio Arriba		
19. Proposed Depth 8400'±		19A. Formation Dakota
21. Elevations (Surface, Footer, etc.) 7335 GL		21B. Drilling Contractor Rotary
21A. Kind & Status Plug. bond One Well		22. Approx. Date Work will start 4-15-87

23.

PROPOSED CASING AND CEMENT PROGRAM

SIZE OF HOLE	SIZE OF CASING	WEIGHT PER FOOT	SETTING DEPTH	SACKS OF CEMENT	EST. TOP
12 1/4"	8 5/8" K-55	24#	200'±	150 sks ClB+2%CaCl	Circulated
7 7/8"	4 1/2" K-55	11.60#	8400'±	2168. sks 3 stgs.	Circulated

1) Propose to drill 12 1/4" hole to approximately 200' using natural mud as a circulating medium. Run new 8 5/8", 24#, K-55 casing to TD & cement with approx 150 sks of Class B+2%CaCl circulated to the surface.

2) BOP to be installed after surface casing is cemented. Prior to drilling out of surface casing, BOP and casing to be tested to OCD specifications. All subsequent work will be conducted through BOP.

3) Drill 7 7/8" hole to TD of approx 8400' using a low solid, non-dispersed mud as a circulating medium.

4) Run Dual Induction SFL Log and Compensated Neutron Formation Density Log prior to running 4 1/2", 11.6# K-55 casing to TD with DV tools at approx 3600' and 6400'.

5) Cement 4 1/2" csg to surface in three stages as follows: 1st stage-590 cu. ft. 50/50 Poz w/ 2% gel, 10% salt & 6 1/4 #/sk gilsonite. 2nd stage-760 cu ft 65/35 Poz w/3% gel, 10% salt, 10% cal seal and 12 1/2 # gilsonite/sk. Tail in with 70 cu ft of Class B neat. 3rd stage-1525 cu ft 65/35 Poz w/6% gel and 1/2 # celloflake/sk. Tail in w/ 70 cu ft Class B neat circulated to the surface.

6) Drill out DV tools & pressure test casing

7) Perforate and fracture Gallup & Dakota zones. Clean up well. Run new 2 3/8" EUE, 4.7# J-55 tubing to the Dakota. Run pump & rods if necessary. Set pumping unit and tanks.

8) Test the well and connect to a gathering system.

The gas from this well is dedicated to a transporter.

IN ABOVE SPACE DESCRIBE PROPOSED PROGRAM: IF PROPOSAL IS TO DEEPEN OR PLUG BACK, GIVE DATA ON PRESENT PRODUCTIVE ZONE AND PROPOSED NEW PRODUCTIVE ZONE. GIVE BLOWOUT PREVENTER PROGRAM, IF ANY.

I hereby certify that the information above is true and complete to the best of my knowledge and belief.

Signed George B. Brown Title Geological Engineer Date 4-1-87
(This space for State Use)

APPROVED BY Essie Busch TITLE DEPUTY OIL & GAS INSPECTOR, DIST. #3 DATE 4-7-87
APR 07 1987

CONDITIONS OF APPROVAL, IF ANY:

All distances must be from the outer boundaries of the Section.

Operator T. H. McElvain Oil & Gas Properties		Lease FD		Well No. 1
Unit Letter H	Section 1	Township 25 North	Range 3 West	County Rio Arriba
Actual Footage Location of Well:				
2840	feet from the	North	line and	950
				feet from the
				East
Ground Level Elev. 7335	Producing Formation Gallup-Dakota		Pool Ojito Gallup-Dakota	Dedicated Acreage: 40 Acres

1. Outline the acreage dedicated to the subject well by colored pencil or hachure marks on the plat below.
2. If more than one lease is dedicated to the well, outline each and identify the ownership thereof (both as to working interest and royalty).
3. If more than one lease of different ownership is dedicated to the well, have the interests of all owners been consolidated by communitization, unitization, force-pooling, etc? NA

☐ Yes ☐ No If answer is "yes," type of consolidation _____

If answer is "no," list the owners and tract descriptions which have actually been consolidated. (Use reverse side of this form if necessary.) _____

No allowable will be assigned to the well until all interests have been consolidated (by communitization, unitization, forced-pooling, or otherwise) or until a non-standard unit, eliminating such interests, has been approved by the Division.

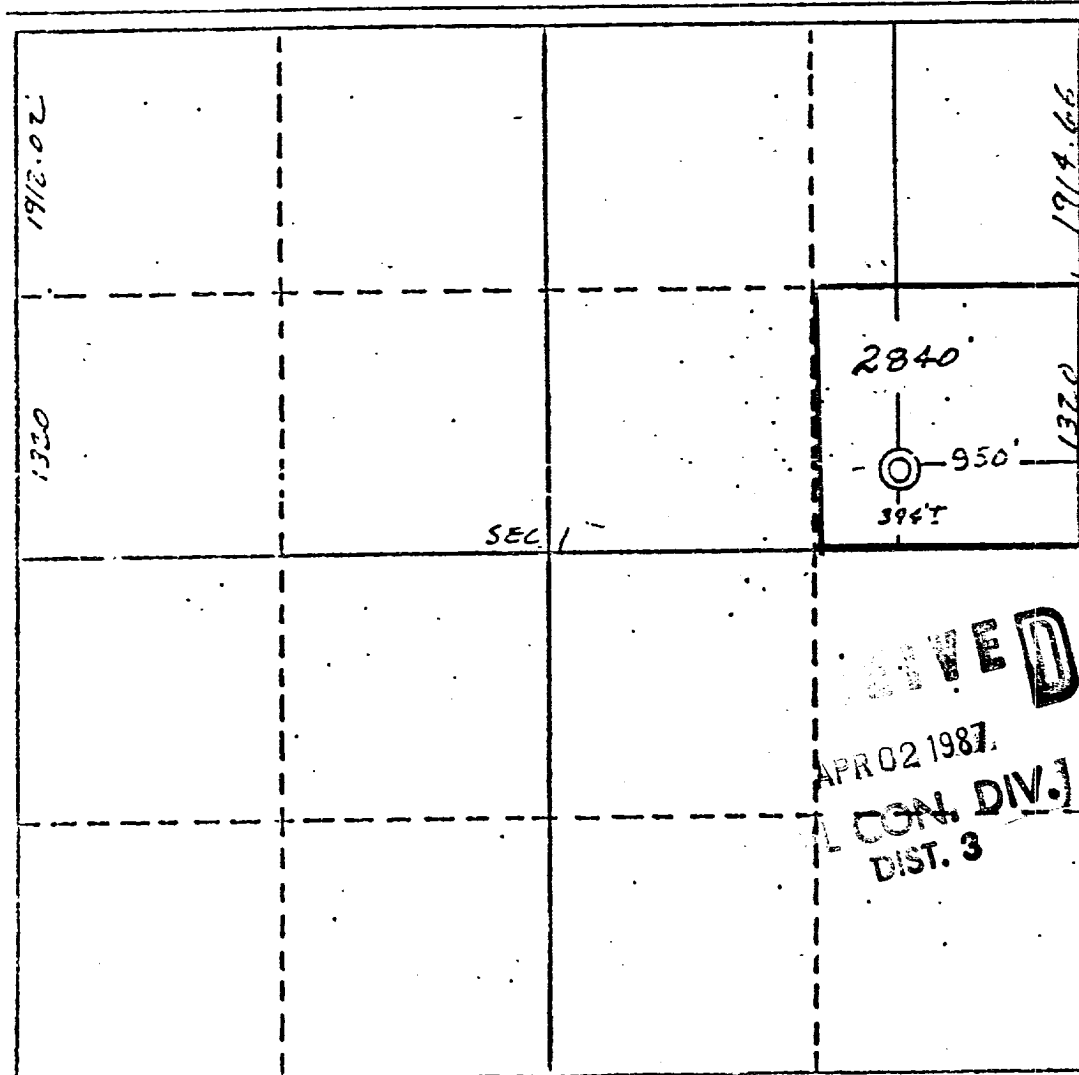

CERTIFICATION

I hereby certify that the information contained herein is true and complete to the best of my knowledge and belief.

George B. Broome
Name
Geological Engineer

Position
T. H. McElvain Oil & Gas
Company Properties
April 1, 1987

Date

I have verified the well location shown on this plat as being from field notes of actual surveys made by me or under my supervision, and that the same is true and correct to the best of my knowledge and belief.

Date Surveyed
January 13, 1987

Registered Professional Engineer
and/or Land Surveyor

Edgar L. Risenhoover
Certificate No. 5979

Edgar L. Risenhoover, L.S.