

UNITED STATES  
DEPARTMENT OF THE INTERIOR  
BUREAU OF LAND MANAGEMENT

APPLICATION FOR PERMIT TO DRILL, DEEPEN, OR PLUG BACK

1a. TYPE OF WORK

DRILL ☒

DEEPEN ☐

PLUG BACK ☐

b. TYPE OF WELL

OIL  
WELL ☐

GAS  
WELL ☒

OTHER

SINGLE  
ZONE ☒

MULTIPLE  
ZONE ☐

2. NAME OF OPERATOR

Union Texas Petroleum

3. ADDRESS OF OPERATOR

375 U.S. Highway 64, Farmington New Mexico 87401

4. LOCATION OF WELL (Report location clearly and in accordance with any State requirements)

At surface

990' FNL & 790' FEL

At proposed prod. zone

14. DISTANCE IN MILES AND DIRECTION FROM NEAREST TOWN OR POST OFFICE

2-1/2 miles west of Ojito, New Mexico

10. DISTANCE FROM PROPOSED

LOCATION TO NEAREST

PROPERTY OR LEASE LINE, FT.

(Also to nearest drlg. unit line, if any)

790' from lease

790' from DU

16. NO. OF ACRES IN LEASE

640

13. DISTANCE FROM PROPOSED LOCATION

TO NEAREST WELL, DRILLING, COMPLETION,

OR APPLIED FOR, ON THIS LEASE, FT.

155'

19. PROPOSED DEPTH

6125'

17. AREA OF ACRES ASSIGNED

TO THIS WELL

N/2 320.00 acres

20. ROTARY OR CABLE TOOLS

Rotary

21. ELEVATIONS (Show whether DF, RT, GR, etc.)

7164 G.L. (graded)

23.

PROPOSED CASING AND CEMENTING PROGRAM

SIZE OF HOLE	SIZE OF CASING	WEIGHT PER FOOT	SETTING DEPTH	QUANTITY OF CEMENT
12-1/4"	9-5/8"	32.3#	300'	175 sxs (207 cu.ft.)
8-3/4"	7"	23.0#	3980'	370 sxs (892 cu.ft.)
6-1/4"	4-1/2" liner	10.5	3780'-6125'	300 sxs (471 cu.ft.)

Union Texas Petroleum wishes to advise we intend to drill 12-1/4" hole with mud to 300+ and set 9-5/8" 32.3#, H-40, ST&C csg. to 300'+, cementing to surface with 175 sxs (207 cu.ft.) C1 "B" with 2% CaCl2 and 1/4# flocele/sk. Wait on cement for 12 hrs.

Nipple up, test BOP. Drill 8-3/4" hole with mud out of surface to 3980'. Set 7", 23.0#, K-55, ST&C intermediate csg. to 3980', cementing to surface with 270 sxs (774 cu.ft.) 65-35 POZ with 12% gel and 12-1/4# gilsonite/sk, tailed by 100 sxs (118 cu.ft) C1 "B" with 2% CaCl2.

Drill 6-1/4" hole with air out of intermediate to a TD of 6125'. Log well, run 4-1/2", 10.5#, K-55, ST&C liner from 3780' to 6125'. Cement liner into intermediate csg with 300 sxs (471 cu.ft.) 50-50 POZ with 4% gel, 6-1/4# gilsonite/sk, and 10# salt/sk.

Following perforation and treatment of the Mesaverde formation, standard production equipment will be installed. Buried cathodic protection cable will be tied into the McCrodren A #1 system. There will be no new disturbance as the well pads are adjacent. A cathodic protection groundbed will be drilled on location.

IN ABOVE SPACE DESCRIBE PROPOSED PROGRAM: If proposal is to deepen or plug back, give data on present productive zone and proposed new productive zone. If proposal is to drill or deepen directionally, give pertinent data on subsurface locations and measured and true vertical depths. Give blowout preventer program, if any.

24.

SIGNED

*Robert C. Frank*

TITLE

Permit Coordinator

DATE

March 30, 1987

(This space for Federal or State office use)

PERMIT NO.

APPROVAL DATE

APPROVED BY

TITLE

DATE

APR 22 1987

CONDITIONS OF APPROVAL, IF ANY:

*OK*  
*EH*

NR000

\*See Instructions On Reverse Side

AREA MANAGER

**NEW MEXICO OIL CONSERVATION COMMISSION  
WELL LOCATION AND ACREAGE DEDICATION PLAT**

Form C-109  
Supersedes C-  
Effective 1-3-8

All distances must be from the outer boundaries of the Section.

Operator <b>Union Texas Petroleum</b>			Lease <b>Mc Croden "A"</b>		Well No. <b># 9</b>
Unit Letter <b>A</b>	Section <b>9</b>	Township <b>25N</b>	Range <b>3W</b>	County <b>Rio Arriba</b>	
Actual Footage Location of Wells <b>990</b> feet from the <b>North</b> line and <b>790</b> feet from the <b>East</b> line					
Ground Level Elev. <b>7164</b>	Producing Formation <b>Mesaverde</b>		Pool <b>Blanco</b>		Dedicated Acres <b>320 N/2</b> <span style="float:right">Act</span>

1. Outline the acreage dedicated to the subject well by colored pencil or hachure marks on the plat below.
2. If more than one lease is dedicated to the well, outline each and identify the ownership thereof (both as to work interest and royalty).
3. If more than one lease of different ownership is dedicated to the well, have the interests of all owners been consolidated by communitization, unitization, force-pooling, etc? Under NMOS P35-210 328

☒ Yes    ☐ No    If answer is "yes," type of consolidation Communitization

If answer is "no," list the owners and tract descriptions which have actually been consolidated. (Use reverse side this form if necessary.)

No allowable will be assigned to the well until all interests have been consolidated (by communitization, unitization, forced-pooling, or otherwise) or until a non-standard unit, eliminating such interests, has been approved by the Commission.

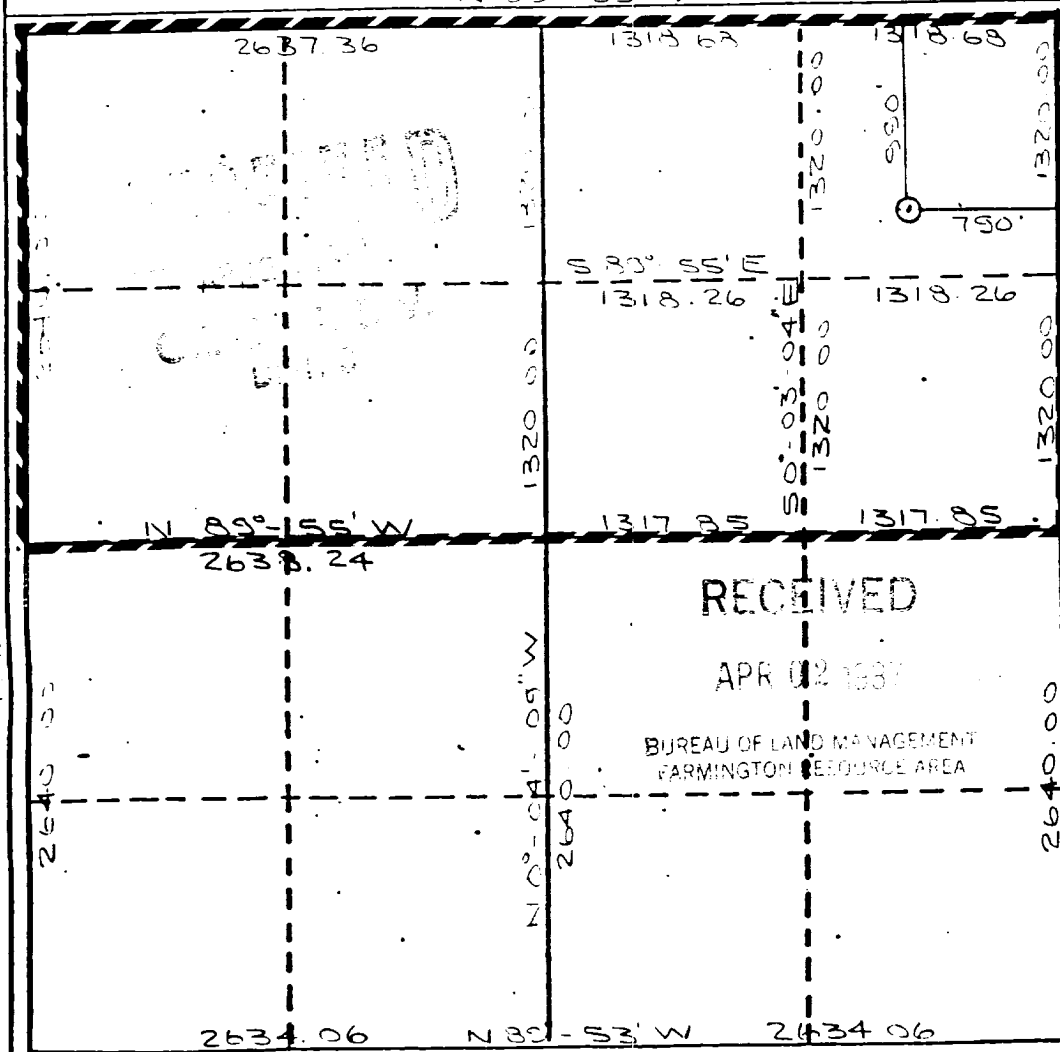

**CERTIFICATION**

I hereby certify that the information contained herein is true and complete to best of my knowledge and belief.

*Robert C. Frank*

Name  
**Robert C. Frank**

Position  
**Permit Coordinator**

Company  
**Union Texas Petroleum**

Date  
**March 30, 1987**

I hereby certify that the well location shown on this plat was plotted from field notes, actual surveys made by me under supervision, and that the same is true to the best of my knowledge and belief.

*Cecil B. Tullis*

Date Surveyed  
**March 6, 1987**

Registered Professional Engineer and/or Land Surveyor

**Cecil B. Tullis**  
Certificate No.

