

UNITED STATES
DEPARTMENT OF THE INTERIOR
BUREAU OF LAND MANAGEMENT

APPLICATION FOR PERMIT TO DRILL, DEEPEN, OR PLUG BACK

1a. TYPE OF WORK

DRILL ☒

DEEPEN ☐

PLUG BACK ☐

b. TYPE OF WELL

OIL
WELL ☒

GAS
WELL ☐

OTHER

SINGLE
ZONE ☒

MULTIPLE
ZONE ☐

2. NAME OF OPERATOR

Jack A. Cole

3. ADDRESS OF OPERATOR

P.O. Box 191, Farmington, New Mexico 87499

4. LOCATION OF WELL (Report location clearly and in accordance with any State requirements.)*

At surface 845' FSL, 1960' FEL

At proposed prod. zone SAME

14. DISTANCE IN MILES AND DIRECTION FROM NEAREST TOWN OR POST OFFICE

8 miles N Counselors Trading Post

15. DISTANCE FROM PROPOSED*

LOCATION TO NEAREST
PROPERTY OR LEASE LINE, FT.
(Also to nearest drig. unit line, if any)

1960'

16. NO. OF ACRES IN LEASE

1202.88

17. NO. OF ACRES ASSIGNED
TO THIS WELL

40

18. DISTANCE FROM PROPOSED LOCATION*

TO NEAREST WELL, DRILLING, COMPLETED,
OR APPLIED FOR, ON THIS LEASE, FT.

2250'

19. PROPOSED DEPTH

5925'

20. ROTARY OR CABLE TOOLS

Rotary

21. ELEVATIONS (Show whether DF, RT, GR, etc.)

7074' GR

7086' KB

This action is subject to technical and
procedural review pursuant to 43 CFR 3160.3
and appeal pursuant to 43 CFR 3160.4

22. APPROX. DATE WORK WILL START*

SEPT. 4, 1987

23. PROPOSED CASING AND CEMENTING PROGRAM

SIZE OF HOLE	SIZE OF CASING	WEIGHT PER FOOT	SETTING DEPTH	QUANTITY OF CEMENT
12 1/4"	8 5/8"	24.0 J-55	250'	250 sacks
7 7/8"	4 1/2"	10.50 K-55	5925'	To be determined after logging.

All producing intervals in Gallup formation will be stimulated as necessary.

Exhibits:

"A" Location and elevation plat

"B" Ten point compliance program

"C" Blowout preventor diagram

"D" Multi-point requirements of APD

"E" Access road to location

"F" Drill rig layout

"G" Fracturing program layout

"H" Location profile

"I" Proposed pipeline

The gas for this well is committed.

IN ABOVE SPACE DESCRIBE PROPOSED PROGRAM: If proposal is to deepen or plug back, give data on present productive zone and proposed new productive zone. If proposal is to drill or deepen directionally, give pertinent data on subsurface locations and measured and true vertical depths. Give blowout preventer program, if any.

24.

SIGNED

Darwayne Blawie

TITLE Production Superintendent

DATE

May 18, 1987

(This space for Federal or State office use)

PERMIT NO.

APPROVAL DATE

APPROVED BY

TITLE

CONDITIONS OF APPROVAL, IF ANY:

NMCC

*See Instructions On Reverse Side

OIL CONSERVATION DIVISION

STATE OF NEW MEXICO
ENERGY AND MINERALS DEPARTMENTP. O. BOX 2088
SANTA FE, NEW MEXICO 87501Form C-102
Revised 11-1-78

All distances must be from the outer boundaries of the Section.

Operator JACK A. COLE		Lease MARCUS "A"		Well No. # 22
Unit Letter 0	Section 31	Township 24 NORTH	Range 6 WEST	County RIO ARriba
Actual Footage Location of Well 845 feet from the SOUTH line and 1960 feet from the EAST line				
Ground Level Elev. 7074	Producing Formation Gallup	Pool Lvbrook Gallup EXT	Dedicated Acreage 40 Acres	

1. Outline the acreage dedicated to the subject well by colored pencil or hachure marks on the plat below.
2. If more than one lease is dedicated to the well, outline each and identify the ownership thereof (both as to working interest and royalty).
3. If more than one lease of different ownership is dedicated to the well, have the interests of all owners been consolidated by communitization, unitization, force-pooling, etc?

☐ Yes ☐ No If answer is "yes," type of consolidation _____

If answer is "no," list the owners and tract descriptions which have actually been consolidated. (Use reverse side of this form if necessary.) _____

No allowable will be assigned to the well until all interests have been consolidated (by communitization, unitization, forced-pooling, or otherwise) or until a non-standard unit, eliminating such interests, has been approved by the Division.

RECEIVED

MAY 19 1987

BUREAU OF LAND MANAGEMENT
FARMINGTON RESOURCE AREARECEIVED
AUG 03 1987
OIL CON. DIV.
DIST. 3

1960'

845'

CERTIFICATION

I hereby certify that the information contained herein is true and complete to the best of my knowledge and belief.

Dewayne Blancett
Name

Dewayne Blancett
Position

Production Superintendent
Company

Cole Production Co.
Date

May 18, 1987

I hereby certify that the location shown on this plat was plotted from field notes of actual surveys made by me or under my supervision, and that the same is true and correct to the best of my knowledge and belief.

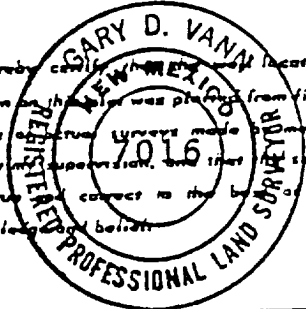

Date Surveyed

January 13, 1986

Registered Professional Engineer
and/or Land Surveyor

Gary D. Vann
Gary D. Vann

Certificate No.

7016

0 320 640 960 1280 1600 1920 2240 2560 2880 3200 3520 3840 4160 4480 4800 5120 5440 5760 6080 6400

UNITED STATES
DEPARTMENT OF THE INTERIOR
BUREAU OF LAND MANAGEMENT

SUBMIT IN TRIPLICATE*
(Other instructions on re-
verse side)

Form approved.
Budget Bureau No. 1004-0135
Expires August 31, 1985

SUNDRY NOTICES AND REPORTS ON WELLS

(Do not use this form for proposals to drill or to deepen or plug back to a different reservoir.
Use "APPLICATION FOR PERMIT—" for such proposals.)

1. OIL WELL <input checked="" type="checkbox"/> GAS WELL <input type="checkbox"/> OTHER <input type="checkbox"/>		5. LEASE DESIGNATION AND SERIAL NO. SF-07834	
2. NAME OF OPERATOR Jack A. Cole		6. IF INDIAN, ALLOTTEE OR TRIBE NAME	
3. ADDRESS OF OPERATOR P.O. Box 191, Farmington, New Mexico 87499		7. UNIT AGREEMENT NAME	
4. LOCATION OF WELL (Report location clearly and in accordance with any State requirements.* See also space 17 below.) At surface 845' FSL, 1960' FEL		8. FARM OR LEASE NAME Marcus "A"	
14. PERMIT NO.		9. WELL NO. 22	
15. ELEVATIONS (Show whether DF, RT, GR, etc.)		10. FIELD AND POOL, OR WILDCAT Lybrook Gallup	
		11. SEC., T., R., M., OR BLK. AND SURVEY OR AREA SWSE Sec. 31-24N-6W	
		12. COUNTY OR PARISH Rio Arriba	
		13. STATE New Mexico	

16.

Check Appropriate Box To Indicate Nature of Notice, Report, or Other Data

NOTICE OF INTENTION TO:

TEST WATER SHUT-OFF ☐
FRACTURE TREAT ☐
SHOOT OR ACIDIZE ☐
REPAIR WELL ☐
(Other) ☐

PULL OR ALTER CASING ☐
MULTIPLE COMPLETE ☐
ABANDON* ☐
CHANGE PLANS ☐

SUBSEQUENT REPORT OF:

WATER SHUT-OFF ☒
FRACTURE TREATMENT ☐
SHOOTING OR ACIDIZING ☐
(Other) ☐

REPAIRING WELL ☐
ALTERING CASING ☐
ABANDONMENT* ☐

(NOTE: Report results of multiple completion on Well Completion or Recompletion Report and Log form.)

17. DESCRIBE PROPOSED OR COMPLETED OPERATIONS (Clearly state all pertinent details, and give pertinent dates, including estimated date of starting any proposed work. If well is directionally drilled, give subsurface locations and measured and true vertical depths for all markers and zones pertinent to this work.)*

8-29-87 Spud 10:15 A.M. TD-282'. Ran 6 joints 8 5/8", 24.0 lb., J-55 casing. Tallied 263.07', set at 275.07'. Cemented with 250 sacks (295 cu. ft.), Class "B", 3% CACI and 1/4 lb. Flocele per sack. Plug down 11:00 P.M. Circulated approximately 20 bbls. cement.

8-30-87 Test B.O.P. to 500 psi for 15 minutes. Test okay.

RECEIVED
BLM MAIL ROOM
SEP 9 1987
#882 IN 8:55

RECEIVED
SEP 09 1987
OIL CON. DIV.
DIST. 3

18. I hereby certify that the foregoing is true and correct

SIGNED Dwayne Blanton

TITLE Production Superintendent

ACCEPTED FOR RECORD

DATE August 31, 1987

(This space for Federal or State office use)

APPROVED BY _____
CONDITIONS OF APPROVAL, IF ANY:

TITLE _____

DATE _____

RV _____

*See Instructions on Reverse Side

NMOCG