

UNITED STATES
DEPARTMENT OF THE INTERIOR
BUREAU OF LAND MANAGEMENT

APPLICATION FOR PERMIT TO DRILL, DEEPEN, OR PLUG BACK

1a. TYPE OF WORK

DRILL ☒

DEEPEN ☐

PLUG BACK ☐

b. TYPE OF WELL

OIL
WELL ☒

GAS
WELL ☐

OTHER ☐

2. NAME OF OPERATOR

New Mexico and Arizona Land Company

3. ADDRESS OF OPERATOR

6100 Indian School, N.E., Ste 120, Albuquerque, NM 87110

4. LOCATION OF WELL (Report location clearly and in accordance with any State requirements.)*

At surface

620' FSL 330' FEL

At proposed prod. zone

14. DISTANCE IN MILES AND DIRECTION FROM NEAREST TOWN OR POST OFFICE*

Nine miles northwest from Lindrith, New Mexico

15. DISTANCE FROM PROPOSED*

LOCATION TO NEAREST
PROPERTY OR LEASE LINE, FT.
(Also to nearest drlg. unit line, if any)

18. DISTANCE FROM PROPOSED LOCATION*
TO NEAREST WELL, DRILLING, COMPLETED,
OR APPLIED FOR, ON THIS LEASE, FT.

16. NO. OF ACRES IN LEASE

160

19. PROPOSED DEPTH

8300

17. NO. OF ACRES ASSIGNED
TO THIS WELL

160

20. ROTARY OR CABLE TOOLS

Rotary

21. ELEVATIONS (Show whether DF, RT, GR, etc.)

7305 GR

22. APPROX. DATE WORK WILL START*

Spring, 1988

23.

PROPOSED CASING AND CEMENTING PROGRAM

SIZE OF HOLE	SIZE OF CASING	WEIGHT PER FOOT	SETTING DEPTH	QUANTITY OF CEMENT
12 3/4"	9 5/8"	36	800	560 cu. ft.
7 7/8"	5 1/2"	15.5 & 17	8300	936 cu. ft. in 3 stages

Completion attempt will be made in the Gallup-Dakota interval. Single completion.

EXHIBITS:

- A. Vicinity Map
- B. Proximity Map
- C. Existing Well Plat
- D. Rig Plan Sheet
- E. Location Topography Plat
- F. Surface Rehabilitation Agreement with Surface Owner
- G. 10-Point Compliance Program
- H. 13-Point Surface Use Plan

The gas from this well is not dedicated.

The SE/4 of Section 12 is dedicated to this well.

IN ABOVE SPACE DESCRIBE PROPOSED PROGRAM: If proposal is to deepen or plug back, give data on present productive zone and proposed new productive zone. If proposal is to drill or deepen directionally, give pertinent data on subsurface locations and measured and true vertical depths. Give blowout preventer program, if any.

SIGNED CR Kerslake TITLE Agent DATE December 14, 1987

(This space for Federal or State office use)

PERMIT NO. _____ APPROVAL DATE _____

APPROVED BY _____ TITLE _____ DATE _____

CONDITIONS OF APPROVAL, IF ANY:

Held C-109 for NGL
JAB

NMOCC

*See Instructions On Reverse Side

Title 18 U.S.C. Section 1001, makes it a crime for any person knowingly and willfully to make to any department or agency of the United States any false, fictitious or fraudulent statements or representations as to any matter within its jurisdiction.

RECEIVED
JAN 13 1988
OIL CON. DIV.
DIST. 2

OIL CONSERVATION DIVISION

STATE OF NEW MEXICO
ENERGY AND MINERALS DEPARTMENTP. O. BOX 2088
SANTA FE, NEW MEXICO 87501Form C-102
Revised 10-1-78

All distances must be from the outer boundaries of the Section.

Operator New Mexico and Arizona Land Company			Lease NZM		Well No. 1
Unit Letter P	Section 12	Township 25 North	Range 3 West	County Rio Arriba	
Actual Footage Location of Well: 620 feet from the South line and 330 feet from the East line					
Ground Level Elev. 7305	Producing Formation Gallup-Dakota		Pool West Lindrith Gallup-Dakota	Dedicated Acreage: 160 Acres	

1. Outline the acreage dedicated to the subject well by colored pencil or hatchure marks on the plat below.
2. If more than one lease is dedicated to the well, outline each and identify the ownership thereof (both as to working interest and royalty).
3. If more than one lease of different ownership is dedicated to the well, have the interests of all owners been consolidated by communitization, unitization, force-pooling, etc?

☐ Yes ☐ No If answer is "yes," type of consolidation _____

If answer is "no," list the owners and tract descriptions which have actually been consolidated. (Use reverse side of this form if necessary.) _____

No allowable will be assigned to the well until all interests have been consolidated (by communitization, unitization, forced-pooling, or otherwise) or until a non-standard unit, eliminating such interests, has been approved by the Division.

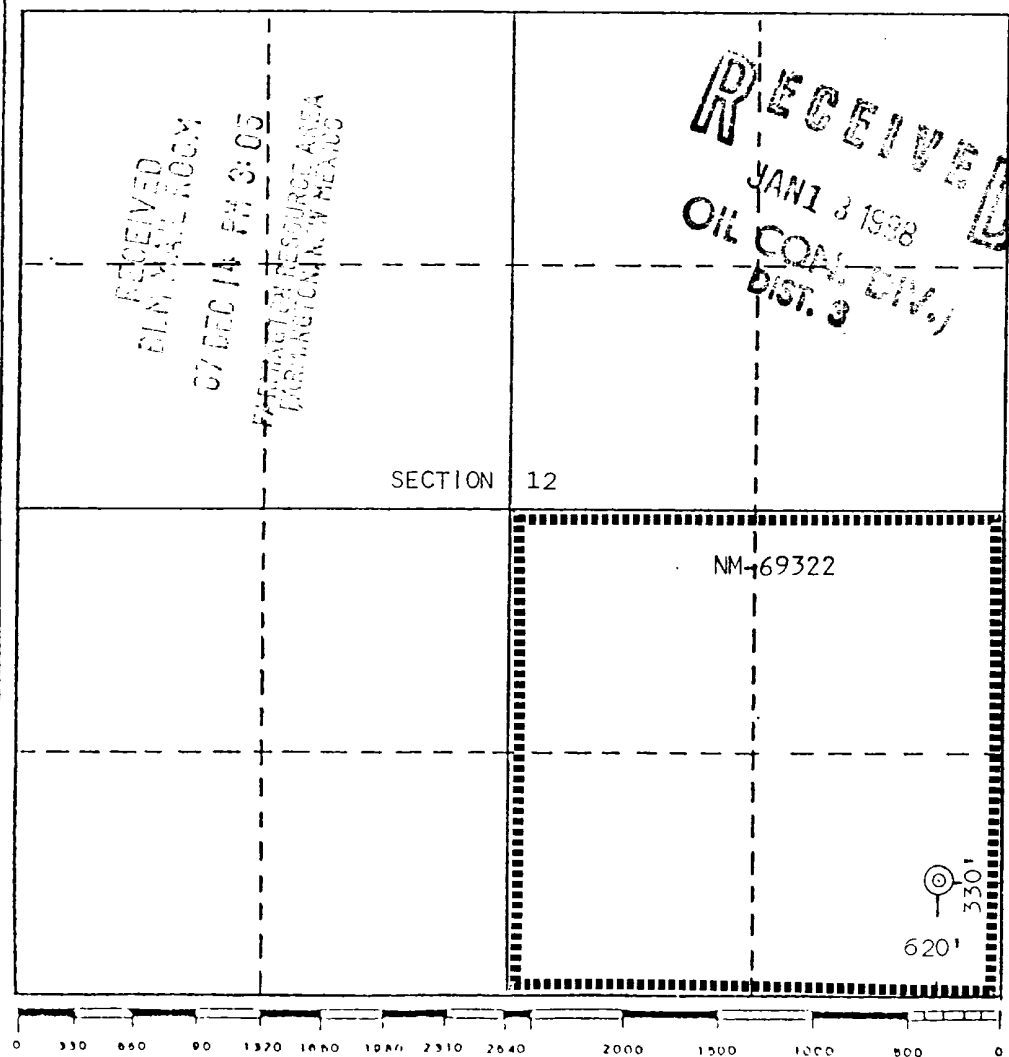

CERTIFICATION

I hereby certify that the information contained herein is true and complete to the best of my knowledge and belief.

Name
A.R. Bendick
Position
Agent
Company
New Mexico and Arizona Land Co.
Date
December 7, 1987

I hereby certify that the location shown on this plat is from field notes of actual survey made by me or under my supervision, and that the same is true and correct to the best of my knowledge and belief.

Date Surveyed
November 30, 1987
Registered Professional Engineer
and/or Land Surveyor

Edgar L. Risenhoover
Certificate No. 5979
Edgar L. Risenhoover, L.S.

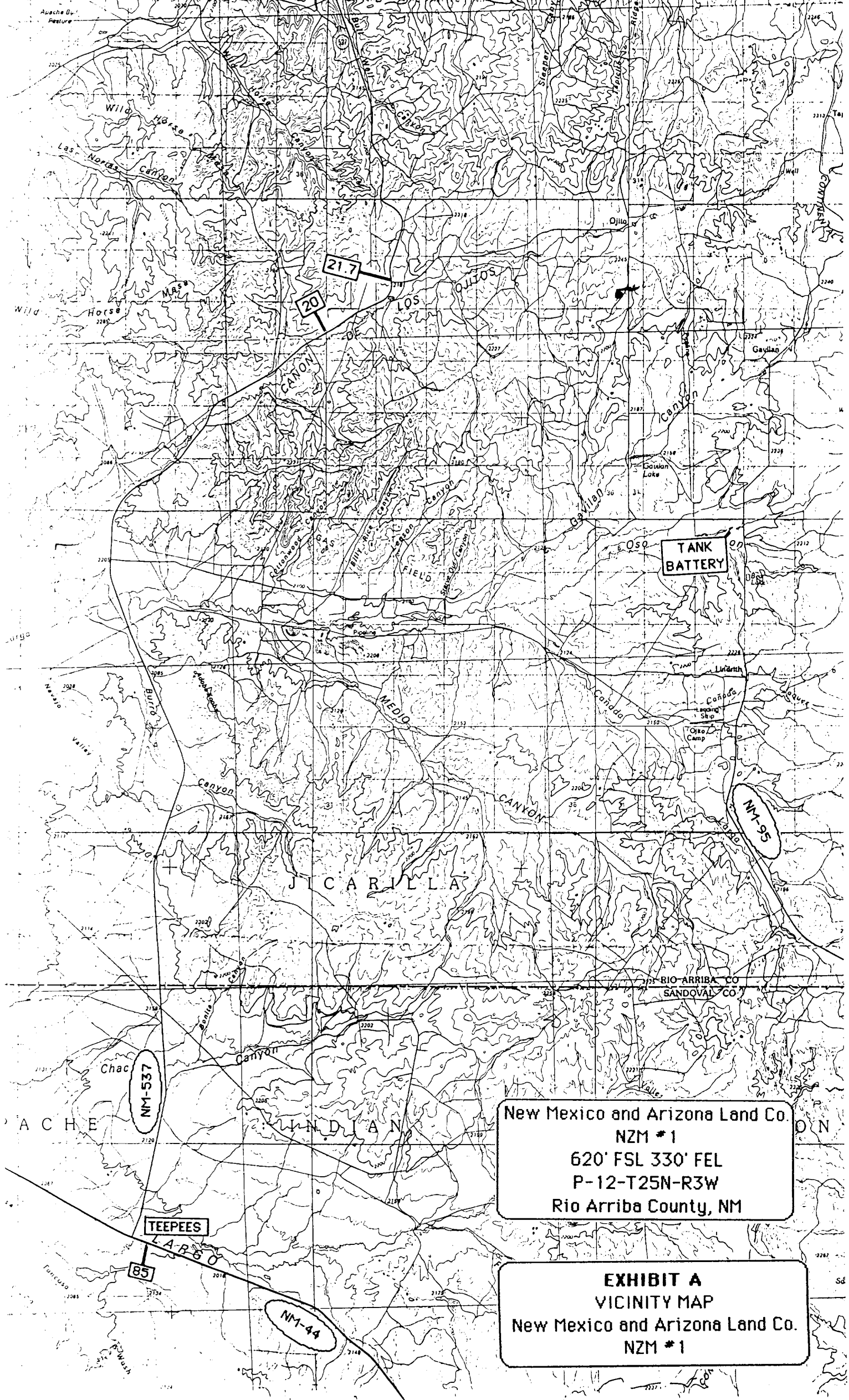

New Mexico and Arizona Land Co.
NZM #1
620' FSL 330' FEL
P-12-T25N-R3W
Rio Arriba County, NM

EXHIBIT A
VICINITY MAP
New Mexico and Arizona Land Co.
NZM #1