

**NEW MEXICO OIL CONSERVATION COMMISSION  
WELL LOCATION AND ACREAGE DEDICATION PLAT**

Form C-102  
Supersedes  
Effective 1-1

All distances must be from the outer boundaries of the Section.

Operator <b>Mobil Producing Texas &amp; New Mexico, Inc.</b>			Lease <b>ARROYO BLANCO 23</b>		Well No. <b>1</b>
Unit Letter <b>K</b>	Section <b>23</b>	Township <b>24 NORTH</b>	Range <b>1 WEST</b>	County <b>RIO ARriba</b>	
Actual Footage Location of Well: <div style="display: flex; justify-content: space-between;"> <span>2047 feet from the</span> <span>SOUTH line and</span> <span>1975 feet from the</span> <span>WEST line</span> </div>					
Ground Level Elev. <b>7159</b>	Producing Formation <b>Gallup</b>	Pool <b>W. Puerto Chiquito Mancos</b>	Dedicated Acreage: <b>640</b> Ac.		

- Outline the acreage dedicated to the subject well by colored pencil or hachure marks on the plat below.
  - If more than one lease is dedicated to the well, outline each and identify the ownership thereof (both as to work interest and royalty).
  - If more than one lease of different ownership is dedicated to the well, have the interests of all owners been consolidated by communitization, unitization, force-pooling, etc?  

Joint operating agreement prior to drilling.  
Communitization once production established.
- ☒ Yes    ☐ No    If answer is "yes," type of consolidation \_\_\_\_\_

If answer is "no," list the owners and tract descriptions which have actually been consolidated. (Use reverse side this form if necessary.) \_\_\_\_\_

No allowable will be assigned to the well until all interests have been consolidated (by communitization, unitization, forced-pooling, or otherwise) or until a non-standard unit, eliminating such interests, has been approved by the Commission.

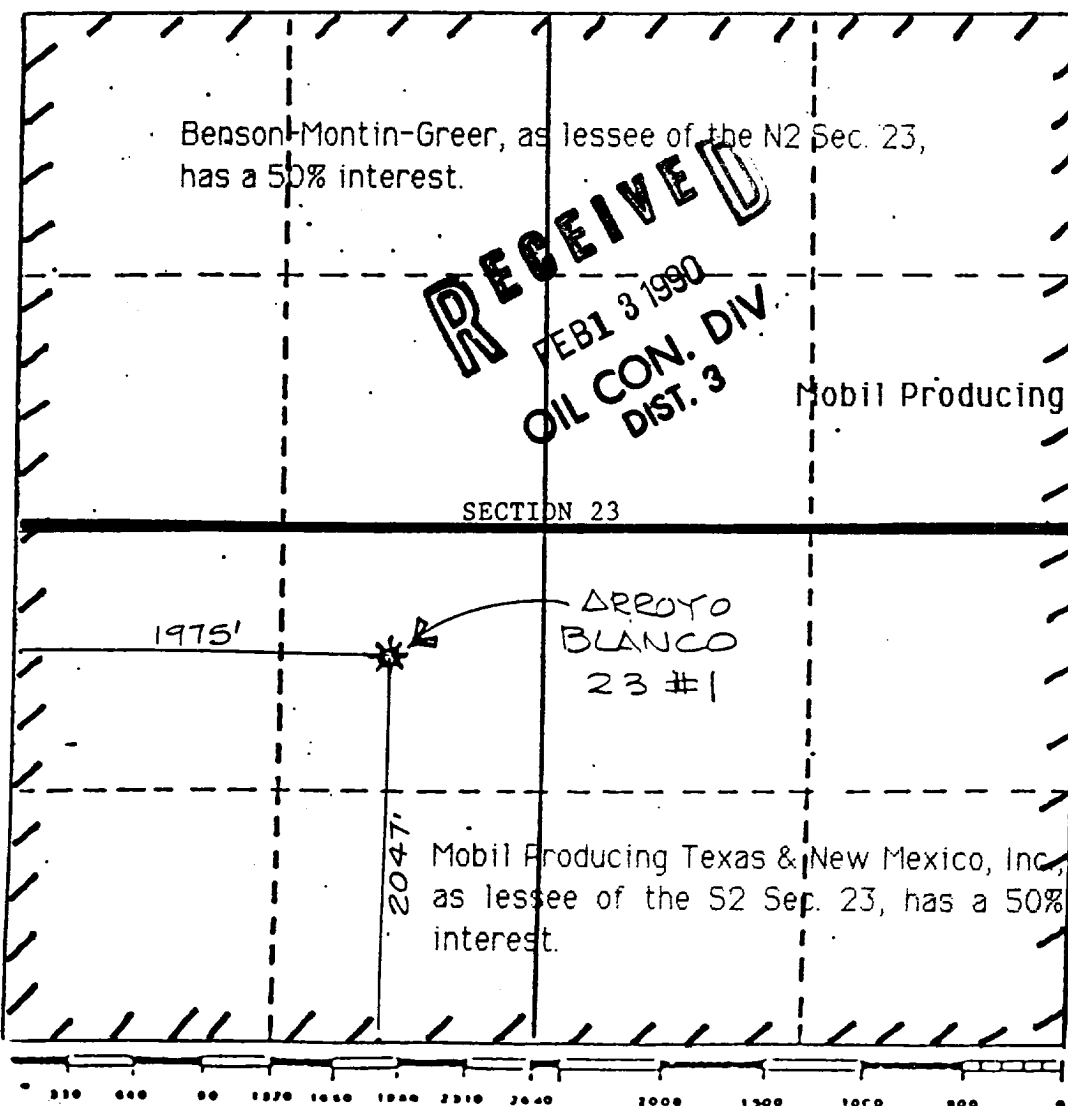

CERTIFICATION	
I hereby certify that the information contained herein is true and complete to the best of my knowledge and belief.	
Name	<b>Clyde J. Benally</b>
Position	<b>Sr. Envi. Engr.</b>
Company	<b>Mobil Producing Texas &amp; New Mexico, Inc.</b>
Date	<b>June 20, 1989</b>
I hereby certify that the well location shown on this plat was plotted from the notes of actual surveys made by me under my supervision and that the same is true and correct to the best of my knowledge and belief.	
Date Surveyed	<b>June 12, 1989</b>
Registered Professional Engineer and/or Land Surveyor	
<b>J. Roger Miller</b>	
Certificate No.	<b>79752</b>