

(July 1992)

**UNITED STATES
DEPARTMENT OF THE INTERIOR
BUREAU OF LAND MANAGEMENT**

(Other instructions on
reverse side)OMB NO. 1004-0136
Expires: February 28, 1995**APPLICATION FOR PERMIT TO DRILL OR DEEPEN**

1a. TYPE OF WORK

DRILL ☐DEEPEN ☐

b. TYPE OF WELL

OIL
WELL ☐GAS
WELL ☒

OTHER

SINGLE
ZONE ☐MULTIPLE
ZONE ☐

2. NAME OF OPERATOR

Elm Ridge Resources, Inc. 149052 (214) 696-8090

3. ADDRESS AND TELEPHONE NO.

4925 Greenville Ave., Suite 1305, Dallas, Tx. 75206

4. LOCATION OF WELL (Report location clearly and in accordance with any State requirements.)*

At surface

890' FNL & 1450' FEL

At proposed prod. zone

Same

14. DISTANCE IN MILES AND DIRECTION FROM NEAREST TOWN OR POST OFFICE*

8 air miles N of Counselor, NM

15. DISTANCE FROM PROPOSED*

LOCATION TO NEAREST
PROPERTY OR LEASE LINE, FT.
(Also to nearest drlg. unit line, if any)

890'

16. NO. OF ACRES IN LEASE

2,640

18. DISTANCE FROM PROPOSED LOCATION*

TO NEAREST WELL, DRILLING, COMPLETED,
OR APPLIED FOR, ON THIS LEASE, FT.

888'

19. PROPOSED DEPTH

6,713'

17. NO. OF ACRES ASSIGNED
TO THIS WELL

160

20. ROTARY OR CABLE TOOLS

Rotary

21. ELEVATIONS (Show whether DF, RT, GR, etc.)

6,497' ungraded ground

22. APPROX. DATE WORK WILL START*

Oct. 1, 1995

23.

PROPOSED CASING AND CEMENTING PROGRAM

SIZE OF HOLE	GRADE SIZE OF CASING	WEIGHT PER FOOT	SETTING DEPTH	QUANTITY OF CEMENT
12-1/4"	8-5/8"	24# (K-55)	200'	≈177 cu ft & to surface
7-7/8"	4-1/2"	10.5# (J-55)	6,713'	≈2810 cu ft & to surface

RECEIVED
SEP 29 1995

OIL CON. DIV.

DIST. 3

RECEIVED
AUG 23 1995

OIL CON. DIV.
DIST. 3~~Held C-104 For 320' AT PROPOSED LOCATION~~~~OFF OPERATOR FOR THE #14 TO ELM~~~~RIDGE OR THE #14 TO FLOYD OIL CO. CANON~~~~+320' OF~~

See Attached

Conditions of Approval

cc: BIA, BLM (3+2 for OCD), Elm (Dallas & Farwell, Tribe

IN ABOVE SPACE DESCRIBE PROPOSED PROGRAM. If proposal is to deepen, give data on present productive zone and proposed new productive zone. If proposal is to drill or deepen directionally, give pertinent data on subsurface locations and measured and true vertical depths. Give blowout preventer program, if any.

24.

SIGNED

TITLE

DATE

Consultant (505) 466-8120

7-20-95

(This space for Federal or State office use)

PERMIT NO.

APPROVAL DATE

Application approval does not warrant or certify that the applicant holds legal or equitable title to those rights in the subject lease which would entitle the applicant to conduct operations thereon.
CONDITIONS OF APPROVAL, IF ANY:

(Original Signed) HECTOR A. VILLALOBOS

AREA MANAGED
RIO PUERCO RESOURCE AREA

AUG 21 1995

APPROVED BY

TITLE

DATE

*See Instructions On Reverse Side

Title 18 U.S.C. Section 1001, makes it a crime for any person knowingly and willfully to make to any department or agency of the United States any false, fictitious or fraudulent statements or representations as to any matter within its jurisdiction.

District I
PO Box 1980, Hobbs, NM 88241-1980
District II
PO Drawer DD, Artesia, NM 88211-0719
District III
1000 Rio Brazos Rd., Aztec, NM 87410
District IV
PO Box 2088, Santa Fe, NM 87504-2088

State of New Mexico
Energy, Minerals & Natural Resources Department

OIL CONSERVATION DIVISION
PO Box 2088
Santa Fe, NM 87504-2088

Form C-102

Revised February 21, 1994

Instructions on back

Submit to Appropriate District Office

State Lease - 4 Copies

Fee Lease - 3 Copies

☐ AMENDED REPORT

WELL LOCATION AND ACREAGE DEDICATION PLAT

API Number <u>30-039-25548</u>		Pool Code <u>71599</u>	Pool Name <u>Basin-Dakota</u>
Property Code <u>17937</u>	Property Name <u>Apache 78</u>		Well Number <u>2</u>
OGRID No. <u>149052</u>	Operator Name <u>Elm Ridge Resources Inc.</u>		Elevation <u>6497'</u>

10 Surface Location



UL or lot no.	Section	Township	Range	Lot Idn	Feet from the	North/South line	Feet from the	East/West line	County
B	18	24 N	5 W		890	North	1450	East	Rio Arriba

11 Bottom Hole Location If Different From Surface

UL or lot no.	Section	Township	Range	Lot Idn	Feet from the	North/South line	Feet from the	East/West line	County

12 Dedicated Acres <u>160</u>	13 Joint or Infill	14 Consolidation Code	15 Order No.
----------------------------------	--------------------	-----------------------	--------------

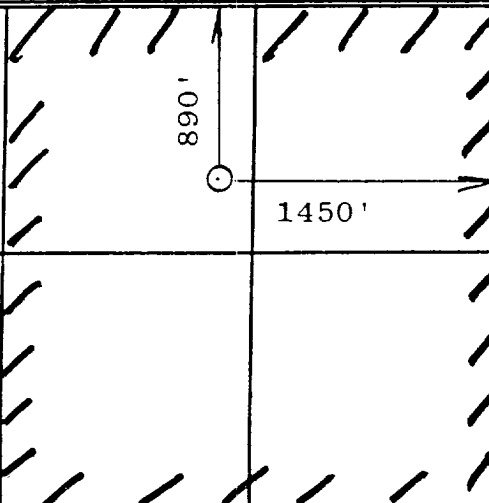
NO ALLOWABLE WILL BE ASSIGNED TO THIS COMPLETION UNTIL ALL INTERESTS HAVE BEEN CONSOLIDATED
OR A NON-STANDARD UNIT HAS BEEN APPROVED BY THE DIVISION

16		17 OPERATOR CERTIFICATION I hereby certify that the information contained herein is true and complete to the best of my knowledge and belief <u>Brian Wood</u> Signature Brian Wood Printed Name Consultant Title July 21, 1995 Date	
		18 SURVEYOR CERTIFICATION I hereby certify that the well location shown on this plat was plotted from field notes of actual surveys made by me or under my supervision, and that the same is true and correct to the best of my belief  Date of Survey Signature 8844 Certificate Number	
RECEIVED SEP 29 1995 OIL CON. DIV. DIST. 3		RECEIVED AUG 23 1995 OIL CON. DIV. DIST. 3	

Elm Ridge Resources, Inc.
 Apache 14-E
 890' FNL & 1450' FEL
 Sec. 18, T. 24 N., R. 5 W.
 Rio Arriba County, NM

PAGE 11

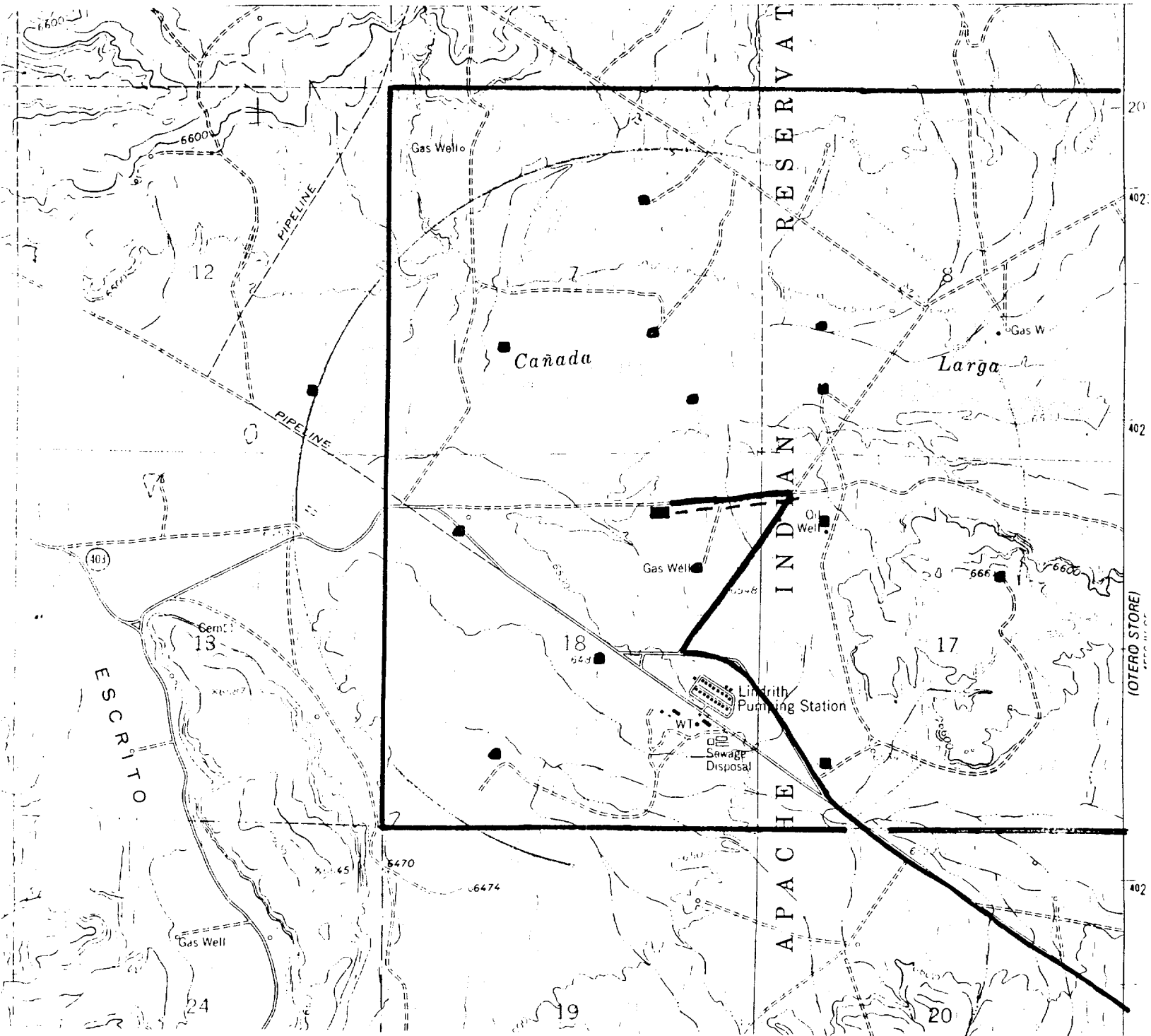

PROPOSED WELL: ■

EXISTING WELL: ■

LEASE: └

PROPOSED PIPELINE: - - -

EXISTING ROAD: —

PERMITS WEST INC.
 PROVIDING PERMITS FOR LAND USERS