

(SUBMIT IN TRIPLICATE)

UNITED STATES  
DEPARTMENT OF THE INTERIOR  
GEOLOGICAL SURVEY

Land Office Santa Fe  
Lease No. 07884  
Unit Canyon Largo Unit

SUNDRY NOTICES AND REPORTS ON WELLS

NOTICE OF INTENTION TO DRILL.....	<input checked="" type="checkbox"/>	SUBSEQUENT REPORT OF WATER SHUT-OFF.....
NOTICE OF INTENTION TO CHANGE PLANS.....		SUBSEQUENT REPORT OF SHOOTING OR ACIDIZING.....
NOTICE OF INTENTION TO TEST WATER SHUT-OFF.....		SUBSEQUENT REPORT OF ALTERING CASING.....
NOTICE OF INTENTION TO RE-DRILL OR REPAIR WELL.....		SUBSEQUENT REPORT OF RE-DRILLING OR REPAIR.....
NOTICE OF INTENTION TO SHOOT OR ACIDIZE.....		SUBSEQUENT REPORT OF ABANDONMENT.....
NOTICE OF INTENTION TO PULL OR ALTER CASING.....		SUPPLEMENTARY WELL HISTORY.....
NOTICE OF INTENTION TO ABANDON WELL.....		

(INDICATE ABOVE BY CHECK MARK NATURE OF REPORT, NOTICE, OR OTHER DATA)

August 29, 1961

Well No. 107 is located 990 ft. from N line and 1000 ft. from E line of sec. 13

NE/4 Sec. 13 25N 6W N.M.P.M.  
(1/4 Sec. and Sec. No.) (Twp.) (Range) (Meridian)  
Otero Chacra Ext. Rio Arriba New Mexico  
(Field) (County or Subdivision) (State or Territory)

The elevation of the derrick floor above sea level is 6622 ft.

DETAILS OF WORK

(State names of and expected depths to objective sands; show sizes, weights, and lengths of proposed casings; indicate mudding jobs, cementing points, and all other important proposed work)

It is intended to drill a well with rotary tools thru the Chacra formation. Possible producing zones will be perforated and fractured. Est. T. D. 3026'.

Casing Program:

9 5/8" set at 100' with 140 sacks of cement circulated to surface.  
2 7/8" set at 3026' with 220 sacks of cement - 150% to cover Fruitland.

The NE/4 of Section 13 is dedicated to this well.

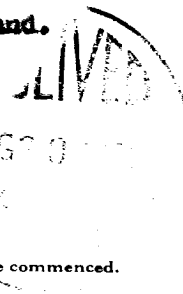

I understand that this plan of work must receive approval in writing by the Geological Survey before operations may be commenced.

Company El Paso Natural Gas Company

Address Box 990

Farrington, New Mexico

Original Signed D. W. Meehan

By Original Signed R. G. MILLER

Title Petroleum Engineer

## NEW MEXICO OIL CONSERVATION COMMISSION

## Well Location and Acreage Dedication Plat

Section A.

Date **May 25, 1961**

Operator **EL PASO NATURAL GAS COMPANY** Lease **CANYON LARGO UNIT** SF **078884**  
 Well No. **107** Unit Letter **A** Section **13** Township **25-N** Range **6-W** NMPM  
 Located **990** Feet From **NORTH** Line **1000** Feet From **EAST** Line  
 County **RIO ARriba** G. L. Elevation **6689** Dedicated Acreage **160** Acres  
 Name of Producing Formation **CHACRA** Pool **OTERO CHACRA EXT.**

1. Is the Operator the only owner in the dedicated acreage outlined on the plat below?  
 Yes ☒ No ☐
2. If the answer to question one is "no", have the interests of all the owners been consolidated by communitization agreement or otherwise? Yes ☐ No ☐ If answer is "yes", Type of Consolidation, \_\_\_\_\_
3. If the answer to question two is "no", list all the owners and their respective interests below:

Owner

Land Description

Section B.

This is to certify that the information in Section A above is true and complete to the best of my knowledge and belief.

**El Paso Natural Gas Company**Original Signed **D. W. Meehan**Original Signed **R. G. MILLER**  
(Representative)**Box 990**

(Address)

**Farmington, New Mexico**

Note: All distances must be from outer boundaries of section.

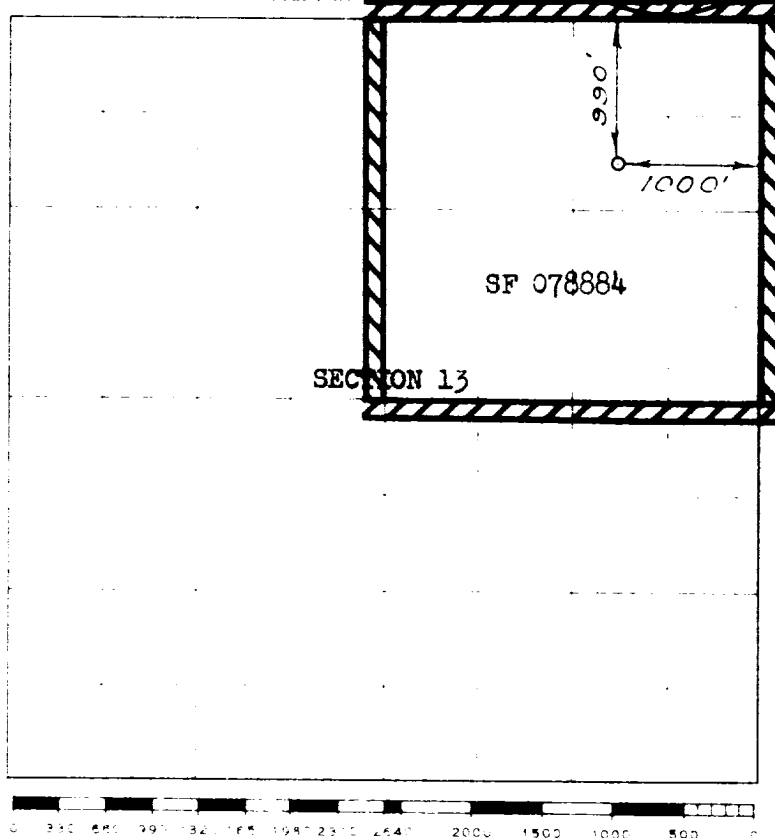

Scale 4 inches equal 1 mile

This is to certify that the above plat was prepared from field notes of actual surveys made by me or under my supervision and that the same are true and correct to the best of my knowledge and belief.

(Seal)

Date Surveyed **May 23, 1961**

Farmington, New Mexico

*David O. Gilman*  
 Registered Professional Engineer and/or Land Surveyor