

(SUBMIT IN TRIPLICATE)

UNITED STATES
DEPARTMENT OF THE INTERIOR
GEOLOGICAL SURVEY

Budget Bureau No. 42-R358.4.
Approval expires 12-31-60.

Land Office **Santa Fe, New Mexico**
Lease No. **013014**
Unit **000000**

SUNDRY NOTICES AND REPORTS ON WELLS

NOTICE OF INTENTION TO DRILL	<input checked="" type="checkbox"/>	SUBSEQUENT REPORT OF WATER SHUT-OFF
NOTICE OF INTENTION TO CHANGE PLANS		SUBSEQUENT REPORT OF SHOOTING OR ACIDIZING
NOTICE OF INTENTION TO TEST WATER SHUT-OFF		SUBSEQUENT REPORT OF ALTERING CASING
NOTICE OF INTENTION TO RE-DRILL OR REPAIR WELL		SUBSEQUENT REPORT OF RE-DRILLING OR REPAIR
NOTICE OF INTENTION TO SHOOT OR ACIDIZE		SUBSEQUENT REPORT OF ABANDONMENT
NOTICE OF INTENTION TO PULL OR ALTER CASING		SUPPLEMENTARY WELL HISTORY
NOTICE OF INTENTION TO ABANDON WELL		

(INDICATE ABOVE BY CHECK MARK NATURE OF REPORT, NOTICE, OR OTHER DATA)

RECEIVED
JUN 20 1959

Well No. **34-23** is located **930** ft. from **T^NS** line and **1830** ft. from **E^W** line of sec. **23**
SE 1/4 Section 23, **25 North** **6 West** **100M**
(1/4 Sec. and Sec. No.) (Twp.) (Range) (Meridian)
Wildcat **Rio Arriba** **New Mexico**
(Field) (County or Subdivision) (State or Territory)

The elevation of the derrick floor above sea level is **6440** ft.

DETAILS OF WORK

(State names of and expected depths to objective sands; show sizes, weights, and lengths of proposed casings; indicate mudding jobs, cementing points, and all other important proposed work)

Objective sand: **Dakota sandstone 6870 feet.**

10-3/4" 325 casing to 300 feet with 325 sacks to be circulated to surface.
9-1/2" 19.00 & 17.00 4-35 casing to 7075 feet with 400 sacks, two stage over
Gilkey and Dakota.

Mad program - spargel-oil emulsion mud 2300 feet to Total Depth.

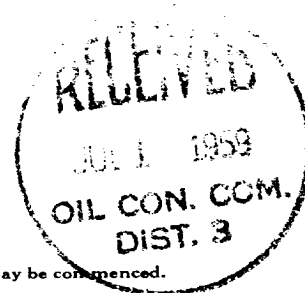

I understand that this plan of work must receive approval in writing by the Geological Survey before operations may be commenced.

Company **ELLEN COUNTY LAND COMPANY**
Address **304 Harbor Building**
Albuquerque, New Mexico

By **John E. Baker**
Title **District Geologist**

CERTIFICATE OF SURVEY

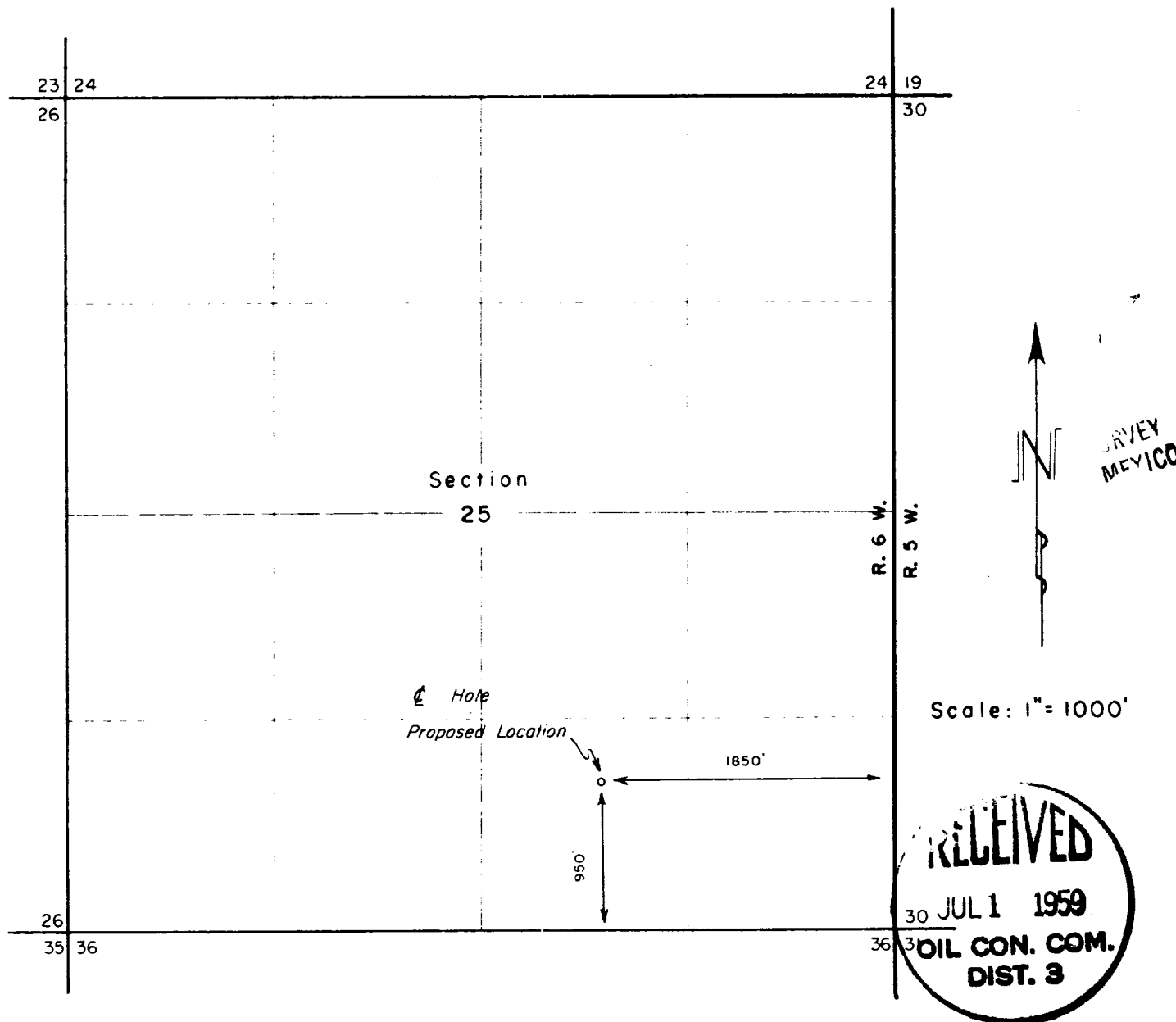

WELL LOCATION: Kern County Land Co. — Mc Kenzie — Fed. No. 34-25

Located 950 feet North of the South line and 1850 feet West of the East line of Section 25,
 Township 25 North Range 6 West New Mexico Principal Meridian
 Rio Arriba County, New Mexico
 Existing ground elevation determined at 6631 feet based on adjoining well location.

I hereby certify the above plat represents a survey
 made under my supervision and is accurate to the
 best of my knowledge and belief.

Elmer M. Clark

ELMER M. CLARK
 Registered Land Surveyor
 State of Colo. (No. 2379)

E.M. CLARK & ASSOCIATES
 Durango, Colorado
 JUNE 25, 1959

OK a1

RECEIVED
FORM C-128
Revised 5/1/57
JUL 1 1959

NEW MEXICO OIL CONSERVATION COMMISSION
WELL LOCATION AND ACREAGE DEDICATION PLAT

SEE INSTRUCTIONS FOR COMPLETING THIS FORM ON THE REVERSE SIDE

U. S. GEOLOGICAL SURVEY
FARMINGTON, NEW MEXICO

SECTION A

Operator KERN COUNTY LAND COMPANY		Lease McKenzie Federal		Well No. 34-25
Unit Letter 0	Section 25	Township 25 North	Range 6 West	County Rio Arriba
Actual Footage Location of Well: 1850 feet from the East line and 950 feet from the South line				
Ground Level Elev. 6626	Producing Formation Dakota		Pool Wildcat	Dedicated Acreage: 320 Acres

1. Is the Operator the only owner in the dedicated acreage outlined on the plat below? YES ☒ NO ☐ . ("Owner" means the person who has the right to drill into and to produce from any pool and to appropriate the production either for himself or for himself and another. (65-3-29 (e) NMSA 1935 Comp.)
2. If the answer to question one is "no," have the interests of all the owners been consolidated by commonization agreement or otherwise? YES ☐ NO ☐ . If answer is "yes," Type of Consolidation _____
3. If the answer to question two is "no," list all the owners and their respective interests below:

Owner	Land Description

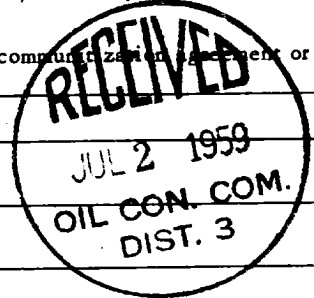

SECTION B

CERTIFICATION

I hereby certify that the information in SECTION A above is true and complete to the best of my knowledge and belief.

Name **John S. Ischer**
Position **District Geologist**
Company **KERN COUNTY LAND COMPANY**
Date **June 29, 1959**

I hereby certify that the well location shown on the plat in SECTION B was plotted from field notes of actual surveys made by me or under my supervision, and that the same is true and correct to the best of my knowledge and belief.

PLEASE SEE ATTACHED PLAT.

Date Surveyed _____
Registered Professional Engineer and/or Land Surveyor _____

Certificate No. _____

0 330 660 990 1320 1650 1980 2310 2640 2000 1500 1000 500 0

INSTRUCTIONS FOR COMPLETION OF FORM C-128

1. Operator shall furnish and certify to the information called for in Section A.
2. Operator shall outline the dedicated acreage for *both* oil and gas wells on the plat in Section B.
3. A registered professional engineer or land surveyor registered in the State of New Mexico or approved by the Commission shall show on the plat the location of the well and certify this information in the space provided.
4. All distances shown on the plat must be from the outer boundaries of the Section.
5. If additional space is needed for listing owners and their respective interests as required in question 3 of Section A, please use space below.