

(SUBMIT IN TRIPLICATE)

UNITED STATES
DEPARTMENT OF THE INTERIOR
GEOLOGICAL SURVEY

Land Office Santa Fe
Lease No. NM-014530
Unit Royal No. 1 - Paqueneche

SUNDRY NOTICES AND REPORTS ON WELLS

NOTICE OF INTENTION TO DRILL.....	<input checked="" type="checkbox"/>	SUBSEQUENT REPORT OF WATER SHUT-OFF.....	
NOTICE OF INTENTION TO CHANGE PLANS.....		SUBSEQUENT REPORT OF SHOOTING OR ACIDIZING.....	
NOTICE OF INTENTION TO TEST WATER SHUT-OFF.....		SUBSEQUENT REPORT OF ALTERING CASING.....	
NOTICE OF INTENTION TO RE-DRILL OR REPAIR WELL.....		SUBSEQUENT REPORT OF RE-DRILLING OR REPAIR.....	
NOTICE OF INTENTION TO SHOOT OR ACIDIZE.....		SUBSEQUENT REPORT OF ABANDONMENT.....	
NOTICE OF INTENTION TO PULL OR ALTER CASING.....		SUPPLEMENTARY WELL HISTORY.....	
NOTICE OF INTENTION TO ABANDON WELL.....			

(INDICATE ABOVE BY CHECK MARK NATURE OF REPORT, NOTICE, OR OTHER DATA)

March 16, 1957

Well No. 1 is located 135 ft. from NM line and 1745 ft. from E line of sec. 10
S34 Sec. 10 T-24-N R-3-E NMPN
(1/4 Sec. and Sec. No.) (Twp.) (Range) (Meridian)
San Juan County New Mexico
(Field) (County or Subdivision) (State or Territory)

The elevation of the derrick floor above sea level is 7000 ft.

DETAILS OF WORK

(State names of and expected depths to objective sands; show sizes, weights, and lengths of proposed casings; indicate mudlogging jobs, cementing points, and all other important proposed work)

Fruitland - 1900'; Pct. Cliffs - 2300'; Cliff House - 4400'
Pt. Lookout - 4700'; Mancos - 4900'; Gallup - 5700'

150' of 10-3/4", 32.75# casing with 100 sacks of cement
5700' of 5 1/2", 15.5# casing with 150 sacks of cement.

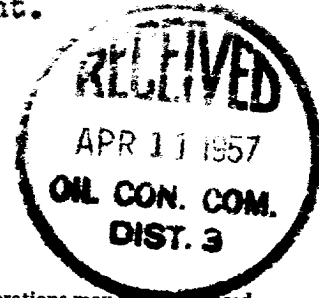

I understand that this plan of work must receive approval in writing by the Geological Survey before operations may be commenced.

Company Roy Sidal dba Royal Development Company
Address P. O. Box 1299
Albuquerque, New Mexico
By [Signature]
Title Business Manager

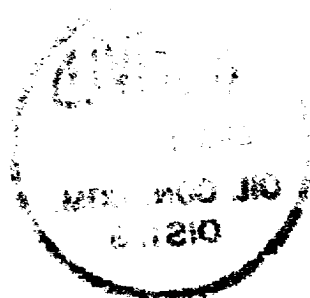

NEW MEXICO
OIL CONSERVATION COMMISSION

Form C-128

Well Location and/or Gas Proration Plat

Date 15 March 1957Operator ROYAL DEVELOPMENT COMPANYLease PAQUENCHEWell No. 1 Section 10 Township 24 NORTH Range 8 WEST, NMPMLocated 465 Feet From the SOUTH Line, 1745 Feet From the EAST Line,SAN JUANCounty, New Mexico. G. L. Elevation 7000.0 GRADED.

Name of Producing Formation _____ Pool _____ Dedicated Acreage _____

(Note: All distances must be from outer boundaries of Section)

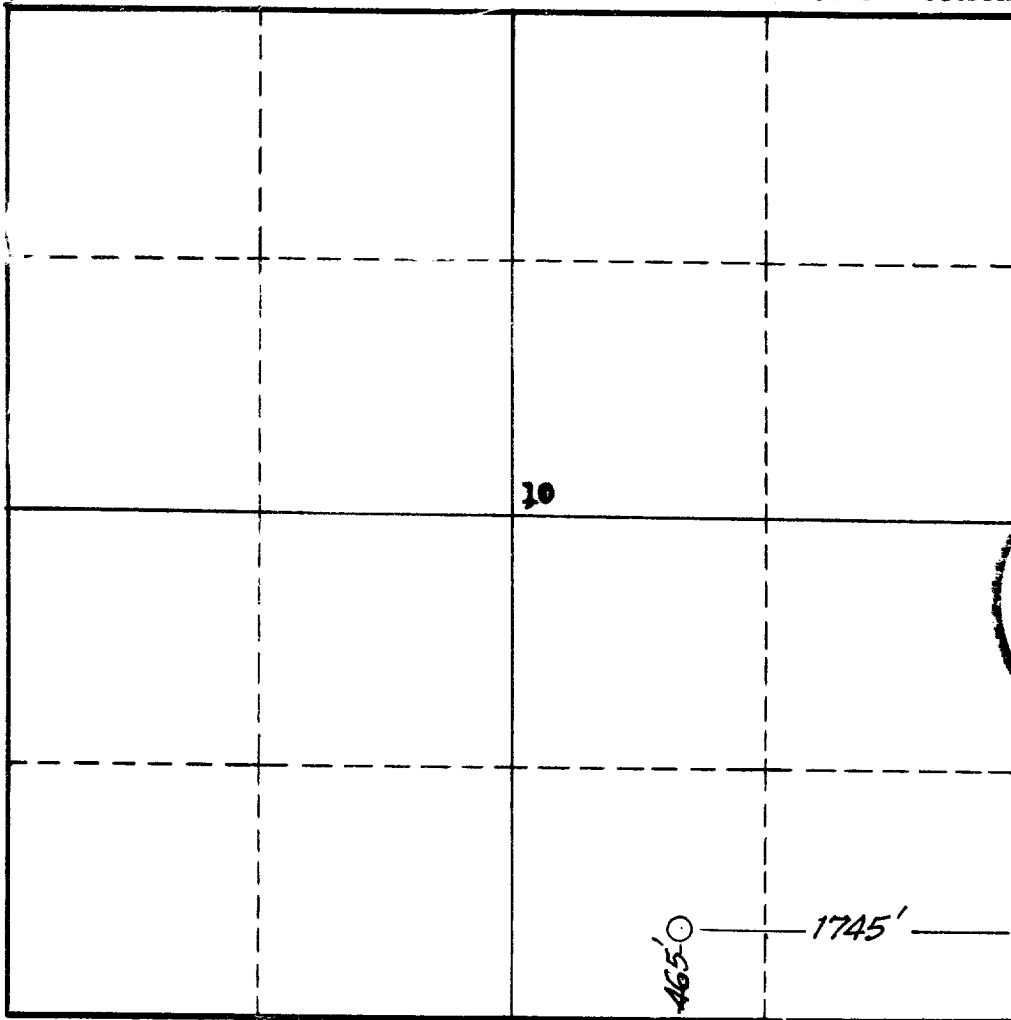

NOTE

This section of
form is to be
used for gas
wells only.



SCALE: 1" = 1000'

1. Is this Well a Dual Comp. ? Yes ___ No ___.
2. If the answer to Question 1 is yes, are there any other dually completed wells within the dedicated acreage? Yes ___ No ___.

Name _____
Position _____
Representing _____
Address _____

This is to certify that the above plat was prepared from field notes of actual surveys made by me or under my supervision and that the same are true and correct to the best of my knowledge and belief.

Date Surveyed 11 MARCH 1957

James P. Leese
Registered Professional Engineer and/or
Land Surveyor James P. Leese
N. Mex. Reg. No. 1463

