

NEW MEXICO OIL CONSERVATION COMMISSION  
Santa Fe, New Mexico

Form C-101  
Revised (12/1/55)

NOTICE OF INTENTION TO DRILL

Notice must be given to the District Office of the Oil Conservation Commission and approval obtained before drilling or recompletion begins. If changes in the proposed plan are considered advisable, a copy of this notice showing such changes will be returned to the sender. Submit this notice in QUINTUPLICATE. One copy will be returned following approval. See additional instructions in Rules and Regulations of the Commission. If State Land submit 6 Copies Attach Form C- 128 in triplicate to first 3 copies of form C-101

Farmington, New Mexico

December 17, 1958

(Place)

(Date)

OIL CONSERVATION COMMISSION  
SANTA FE, NEW MEXICO

Gentlemen:

You are hereby notified that it is our intention to commence the Drilling of a well to be known as

~~Pan American Petroleum Corporation~~

(Company or Operator)

State of New Mexico "AM"

(Lease)

Well No. 1

in L

(Unit)

The well is

located 1980 feet from the South line and 660 feet from the

West

line of Section 2

T. 24N

R. 10W

NMPM.

(GIVE LOCATION FROM SECTION LINE)

Histi-Lower Gallup

Pool,

San Juan

County

If State Land the Oil and Gas Lease is No. E-4912-12

If patented land the owner is ---

Address ---

We propose to drill well with drilling equipment as follows:

Rotary tools to total depth.

The status of plugging bond is ---

Drilling Contractor To be reported later.

We intend to complete this well in the Gallup

formation at an approximate depth of 5700 feet.

Section 2

CASING PROGRAM

We propose to use the following strings of Casing and to cement them as indicated:

Size of Hole	Size of Casing	Weight per Foot	New or Second Hand	Depth	Sacks Cement
11-1/4"	8-5/8"	22.7#	New	200	Amount to Circulate
7-7/8"	5-1/2"	14#	New	5700	150% theoretical fill

If changes in the above plans become advisable we will notify you immediately.

ADDITIONAL INFORMATION (If recompletion give full details of proposed plan of work.) We propose to drill the above well to approximately 5700' and complete in the Gallup zone. Stimulation will be as indicated on reaching this depth. Copies of location plat are attached. A copy of any survey run will be submitted upon completion of well.

Approved 12-22, 1958  
Except as follows:

Sincerely yours,

~~Pan American Petroleum Corporation~~

ORIGINAL SIGNED BY

By D. J. SCOTT

Position Field Clerk

Send Communications regarding well to

Name Pan American Petroleum Corporation

Address Box 487, Farmington, New Mexico

OIL CONSERVATION COMMISSION

By *Ernest C. [Signature]*

## Well Location and Acreage Dedication Plat

Section A.

Date **December 16, 1958**

Operator **PAN AMERICAN PETROLEUM CORPORATION** Lease **STATE OF NEW MEXICO "AW"**  
 Well No. **1** Unit Letter **L** Section **2** Township **24 NORTH** Range **10 WEST** NMPM  
 Located **1980** Feet From **THE SOUTH** Line, **660** Feet From **THE WEST** Line  
 County **SAN JUAN** G. L. Elevation **\*** Dedicated Acreage **80** Acres  
 Name of Producing Formation **Gallup** Pool **Bisti Lower Gallup**

1. Is the Operator the only owner in the dedicated acreage outlined on the plat below?  
 Yes ☒ No ☐ **\*To be reported later**
2. If the answer to question one is "no", have the interests of all the owners been consolidated by communitization agreement or otherwise? Yes ☐ No ☐ If answer is "yes", Type of Consolidation.

Ref: GLO Plat dated 11 June 1924

3. If the answer to question two is "no", list all the owners and their respective interests below:

Owner

Land Description



Section B.

Note: All distances must be from outer boundaries of section.

This is to certify that the information in Section A above is true and complete to the best of my knowledge and belief.

**PAN AMERICAN PETROLEUM CORPORATION**

(Operator)

**R. M. Bauer, Jr.** *R. M. Bauer, Jr.*

(Representative)

**Box 487, Farmington, New Mexico**

(Address)

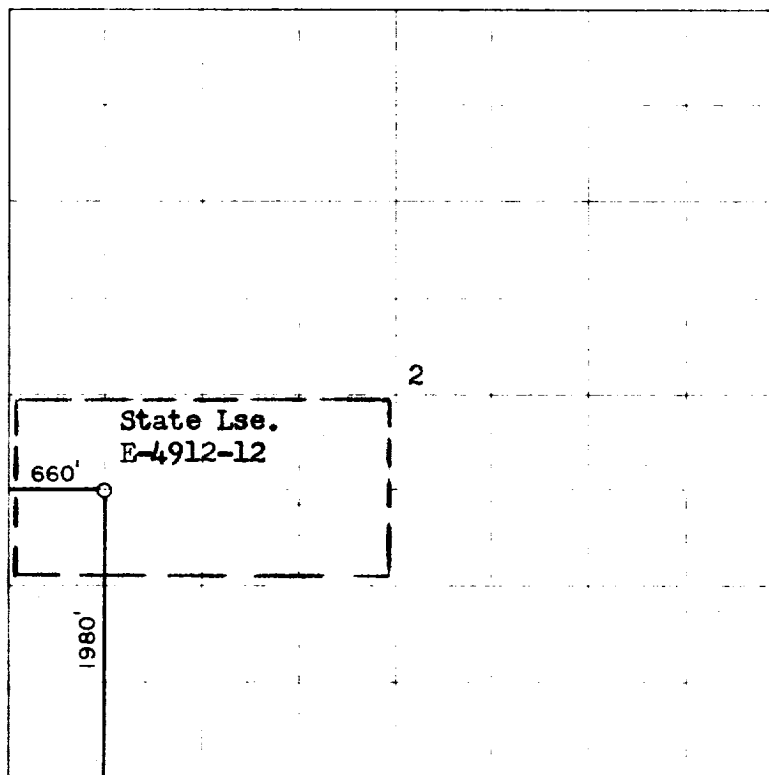

0 330 660 990 1320 1650 1980 2310 2640 2970 3300 3630 3960 4290 4620 4950 5280 5610 5940 6270 6600

Scale 4 inches equal 1 mile

This is to certify that the above plat was prepared from field notes of actual surveys made by me or under my supervision and that the same are true and correct to the best of my knowledge and belief.

(Seal)

Date Surveyed **12 December 1958**

Farmington, New Mexico

*James P. Leese*  
 Registered Professional Engineer and/or Land Surveyor  
**James P. Leese, N. Mex. Reg. No. 1463**

**OIL CONSERVATION COMMISSION****AZTEC DISTRICT OFFICE**No. Copies Received 6**DISTRIBUTION**

	No. FURNISHED	
Operator	1	
Santa Fe	1	
Proration Office		
State Land Office	1	
U. S. G. S.	2	
Transporter		
File	1	✓