

(SUBMIT IN TRIPLICATE)

UNITED STATES  
DEPARTMENT OF THE INTERIOR  
GEOLOGICAL SURVEY

Land Office **SF 078078**  
Lease No. \_\_\_\_\_  
Unit \_\_\_\_\_

**SUNDRY NOTICES AND REPORTS ON WELLS**

|  |  |
|--|--|
| NOTICE OF INTENTION TO DRILL                   | SUBSEQUENT REPORT OF WATER SHUT-OFF        |
| NOTICE OF INTENTION TO CHANGE PLANS            | SUBSEQUENT REPORT OF SHOOTING OR ACIDIZING |
| NOTICE OF INTENTION TO TEST WATER SHUT-OFF     | SUBSEQUENT REPORT OF ALTERING CASING       |
| NOTICE OF INTENTION TO RE-DRILL OR REPAIR WELL | SUBSEQUENT REPORT OF RE-DRILLING OR REPAIR |
| NOTICE OF INTENTION TO SHOOT OR ACIDIZE        | SUBSEQUENT REPORT OF ABANDONMENT           |
| NOTICE OF INTENTION TO PULL OR ALTER CASING    | SUPPLEMENTARY WELL HISTORY                 |
| NOTICE OF INTENTION TO ABANDON WELL            |  |

(INDICATE ABOVE BY CHECK MARK NATURE OF REPORT, NOTICE, OR OTHER DATA)

11-27-

56

**Mims-Carson**

1

660

702

4

Well No. **11/4** is located **24N** ft. from **12W** line and **702** ft. from **12W** line of sec. **4**

**Wildcat** and Sec. No.)

**San Juan**

(Range)

(Meridian)

**New Mexico**

(Field)

(County or Subdivision)

(State or Territory)

6202

The elevation of the derrick floor above sea level is \_\_\_\_\_ ft.

**DETAILS OF WORK**

(State names of and expected depths to objective sands; show sizes, weights, and lengths of proposed casings; indicate mudding jobs, cement-

It is proposed to drill a test thru the Gallup formation to an approx. depth of 5000'.

Approx. 100' of 36# 9 5/8" surface casing will be circulated with cement.

All zones will be cored if favorable showing of oil or gas is found.



I understand that this plan of work must receive approval in writing by the Geological Survey before operations may be commenced.

**Kenneth Murchison**

Company **1315 Pacific Avenue**

Address **Dallas, Texas**

By

**O.J. Lilly**

Agent

Title

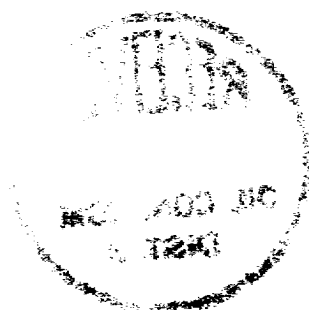

NEW MEXICO  
OIL CONSERVATION COMMISSION

Form C-128

Well Location and/or Gas Proration Plat

Date \_\_\_\_\_

Operator Kenneth Murchison Lease Mims-Carson

Well No. 1 Section 4 Township 24 North Range 12 West NMPM

Located 660 Feet From North Line, 702 Feet From West Line,

San Juan County, New Mexico. G. L. Elevation 6191

Name of Producing Formation \_\_\_\_\_ Pool \_\_\_\_\_ Dedicated Acreage \_\_\_\_\_

(Note: All distances must be from outer boundaries of Section)

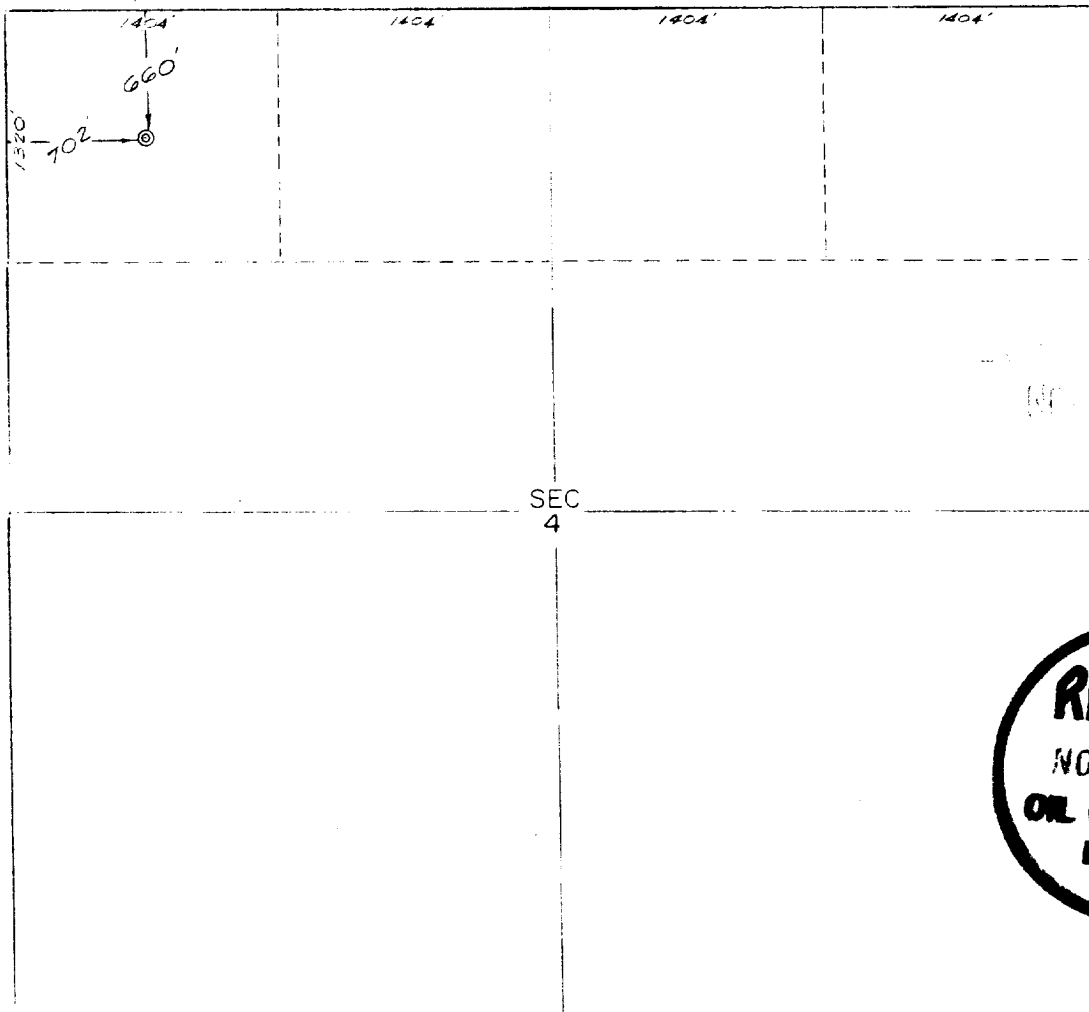

NOTE

This section of plat is to be used for gas wells only.



1. Is this Well a Dual Comp. ? Yes No
2. If the answer to Question 1 is yes, are there any other dually completed wells within the dedicated acreage?  
Yes No

Name \_\_\_\_\_  
Position \_\_\_\_\_  
Representing \_\_\_\_\_  
Address \_\_\_\_\_

This is to certify that the above plat was prepared from field notes of actual surveys made by me or under my supervision and that the same are true and correct to the best of my knowledge and belief.

Date Surveyed November 23, 1956

Ernest V. Echohawk  
Ernest V. Echohawk

Reg. Land Surveyor, N. Mex., Reg. No. 1545