

(SUBMIT IN TRIPLICATE)

UNITED STATES
DEPARTMENT OF THE INTERIOR
GEOLOGICAL SURVEY

Land Office **Santa Fe**
Lease No. **MM-087657**
Unit _____

SUNDRY NOTICES AND REPORTS ON WELLS

NOTICE OF INTENTION TO DRILL.....	<input checked="" type="checkbox"/>	SUBSEQUENT REPORT OF WATER SHUT-OFF.....	
NOTICE OF INTENTION TO CHANGE PLANS.....		SUBSEQUENT REPORT OF SHOOTING OR ACIDIZING.....	
NOTICE OF INTENTION TO TEST WATER SHUT-OFF.....		SUBSEQUENT REPORT OF ALTERING CASING.....	
NOTICE OF INTENTION TO RE-DRILL OR REPAIR WELL.....		SUBSEQUENT REPORT OF RE-DRILLING OR REPAIR.....	
NOTICE OF INTENTION TO SHOOT OR ACIDIZE.....		SUBSEQUENT REPORT OF ABANDONMENT.....	
NOTICE OF INTENTION TO PULL OR ALTER CASING.....		SUPPLEMENTARY WELL HISTORY.....	
NOTICE OF INTENTION TO ABANDON WELL.....			

(INDICATE ABOVE BY CHECK MARK NATURE OF REPORT, NOTICE, OR OTHER DATA)

November 3, 1960

Well No. 2 Federal is located 855 ft. from {N} line and 410 ft. from {E} line of sec. 13
NE/4 13 24N 8W NMPM
(1/4 Sec. and Sec. No.) (Twp.) (Range) (Meridian)
Wildcat San Juan New Mexico
(Field) (County or Subdivision) (State or Territory)

The elevation of the derrick floor above sea level is 7093 ft.

DETAILS OF WORK

(State names of and expected depths to objective sands; show sizes, weights, and lengths of proposed casings; indicate mudding jobs, cementing points, and all other important proposed work)

The operator proposes to drill a test well through the Gallup formation of Upper Cretaceous Age.

Approximately 200' of 9-5/8" J-55 24# surface casing will be cemented and circulated to the surface.

An 8-5/8" hole will be drilled to an estimated total depth of 6000'. Should data prove commercial oil or gas production 5-1/2" casing will be run to total depth and the well completed in good and standard oil field practice.

I understand that this plan of work must receive approval in writing by the Geological Survey before operations may be commenced.

Company Ray Smith, Trustees
Address Simons Building
Dallas, Texas

By O. J. Lilly
Title Agent

100-443887-100

100

NEW MEXICO OIL CONSERVATION COMMISSION

Well Location and Acreage Dedication Plat

SECTION A.

Date _____

Operator Raye Smith Trustee Lease _____
Well No. _____ Unit Letter _____ Section 13 Township 24-North Range 8-West NMPM
Located 855 Feet From North Line, 410 Feet From East Line
County San Juan G. L. Elevation 7098 Dedicated Acreage 4.0 Acres
Name of Producing Formation _____ Pool _____

1. Is the Operator the only owner* in the dedicated acreage outlined on the plat below? Yes L No _____
2. If the answer to question One is "No," have the interests of all the owners been consolidated by communitization agreement or otherwise? Yes _____ No _____ If answer is "Yes," Type of Consolidation _____
3. If the answer to question Two is "No," list all the owners and their respective interests below:

OWNER

LAND DESCRIPTION

SECTION B.

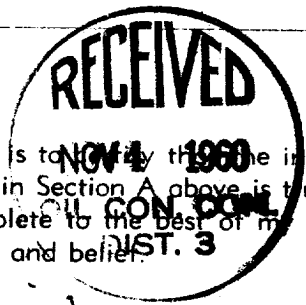
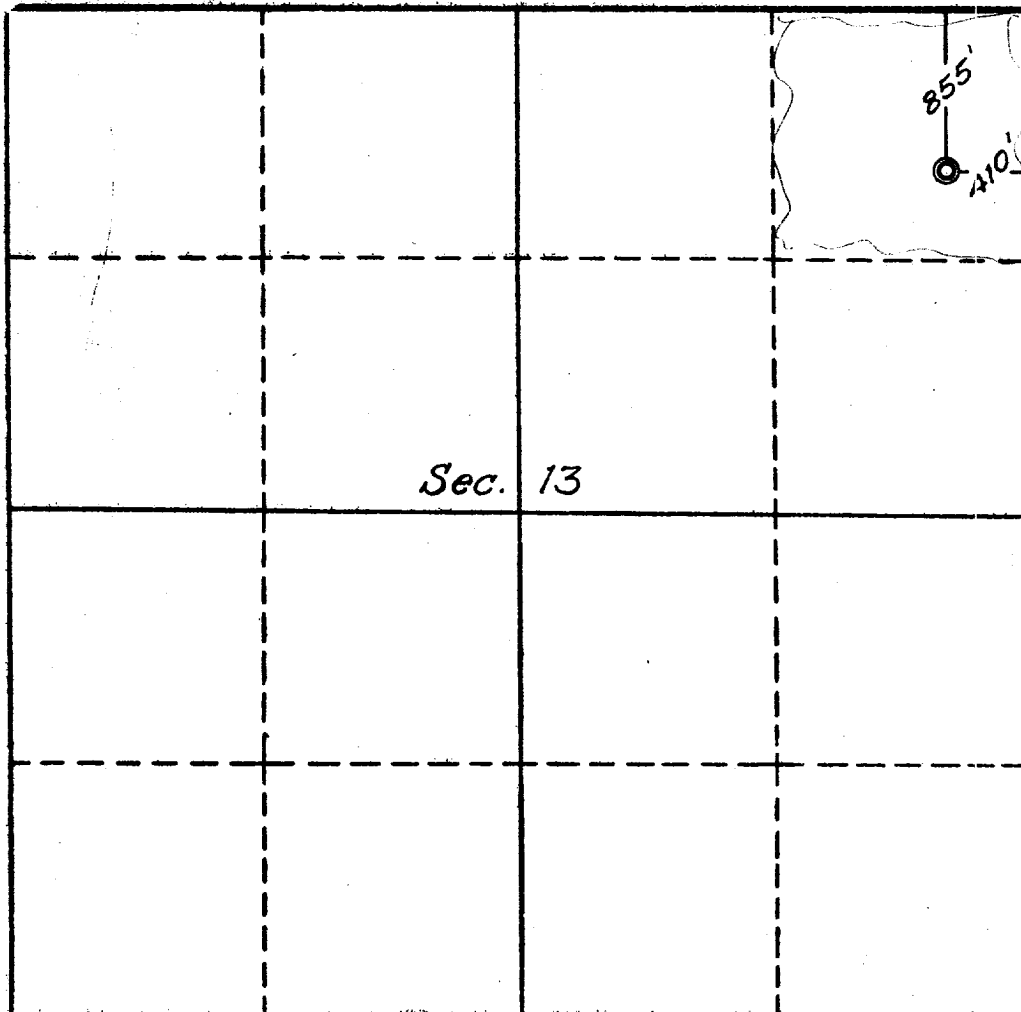

This is to certify that the information in Section A above is true and complete to the best of my knowledge and belief.

(OPERATOR)
[Signature]
(REPRESENTATIVE)

(ADDRESS)

This is to certify that the location shown on the plat in Section B was plotted from field notes of actual surveys made by me or under my supervision and that the same is true and correct to the best of my knowledge and belief.

Date Surveyed 11-1-60

Four States Engineering Co.
FARMINGTON, NEW MEXICO

E. V. Echols-Kauf
REGISTERED ENGINEER OR
LAND SURVEYOR

Certificate No. 1545

