

UNITED STATES
DEPARTMENT OF THE INTERIOR
GEOLOGICAL SURVEY

30-045-20305
5. LEASE DESIGNATION AND SERIAL NO.

NM-19567
6. IF INDIAN, ALLOTTEE OR TRIBE NAME

7. UNIT AGREEMENT NAME

8. FARM OR LEASE NAME

French Wash

9. WELL NO.
4

10. FIELD AND POOL, OR WILDCAT

Wildcat PICTURED CLIFFS

11. SEC., T., R., M., OR BLK. AND SURVEY OR AREA

Sec 8, T24N, R8W

12. COUNTY OR PARISH

San Juan

13. STATE

New Mexico

APPLICATION FOR PERMIT TO DRILL, DEEPEN, OR PLUG BACK

1a. TYPE OF WORK
DRILL DEEPEN PLUG BACK

b. TYPE OF WELL
OIL WELL GAS WELL OTHER
SINGLE ZONE MULTIPLE ZONE

2. NAME OF OPERATOR
Oklahoma Oil Company

3. ADDRESS OF OPERATOR
Suite 1120, One Energy Square, Dallas, Texas 75206

4. LOCATION OF WELL (Report location clearly and in accordance with any State requirements.*)
At surface
1480' FNL & 1850' FEL
At proposed prod. zone

Same

14. DISTANCE IN MILES AND DIRECTION FROM NEAREST TOWN OR POST OFFICE*
6 miles southeast of Blanco Trading Post

15. DISTANCE FROM PROPOSED* LOCATION TO NEAREST PROPERTY OR LEASE LINK, FT. (Also to nearest drlg. unit line, if any)
1480

16. NO. OF ACRES IN LEASE
1240

17. NO. OF ACRES ASSIGNED TO THIS WELL
160

18. DISTANCE FROM PROPOSED LOCATION* TO NEAREST WELL, DRILLING, COMPLETED, OR APPLIED FOR, ON THIS LEASE, FT.

19. PROPOSED DEPTH
2100

20. ROTARY OR CABLE TOOLS
Rotary

21. ELEVATIONS (Show whether DF, RT, GR, etc.)
6915

22. APPROX. DATE WORK WILL START*
1-27-77

PROPOSED CASING AND CEMENTING PROGRAM

SIZE OF HOLE	SIZE OF CASING	WEIGHT PER FOOT	SETTING DEPTH	QUANTITY OF CEMENT
12 1/2	8 5/8	20#	45'	35 sacks class "B" + 2% CaCl ₂
6 1/2	4 1/2	10.5#	2100'	100 sacks 65-35 class "B" Poz + 12% GEI
				150 sacks class "B" + 2% CaCl ₂

Move in - rig up rotary tools. Drill 12 1/2 hole to 45 feet. Set 45 feet of new 8 5/8" 20# casing and cement as indicated above. Wait on cement 12 hours. Install 6" 900 series blow out preventer and test. Drill 6 1/2 hole to 2100 feet. No abnormal temperature or pressure is expected. Well will be drilled with a gel-chem mud to total depth with mud characteristics of 9.0-9.2# per gallon, WL 8-10 cc and 30-40 viscosity. Open hole logs to be run as follows: DIL, FDC-CNL and GR-Caliper. If commercial, 4 1/2 casing will be run and cemented as indicated above. If non-commercial, well will be plugged and abandoned as per U.S.G.S. instructions.

GAS NOT DEDICATED

RECEIVED

IN ABOVE SPACE DESCRIBE PROPOSED PROGRAM: If proposal is to deepen or plug back, give data on present productive zone and proposed new productive zone. If proposal is to drill or deepen directionally, give pertinent data on subsurface locations and measured and true vertical depths. Give blowout preventer program, if any.

24. SIGNED John Alexander TITLE Agent U. S. GEOLOGICAL SURVEY
ADMINISTRATION BLDG. DATE 12-30-76

(This space for Federal or State office use)

PERMIT NO. _____ APPROVAL DATE _____

APPROVED BY _____ TITLE _____ DATE _____

CONDITIONS OF APPROVAL, IF ANY:

**NEW MEXICO OIL CONSERVATION COMMISSION
WELL LOCATION AND ACERAGE DEDICATION PLAT**

All distances must be from the outer boundaries of the Section

Operator OKLAHOMA OIL COMPANY			Lease FRENCHMAN WASH		Well No. 4
Unit Letter G	Section 8	Township 24 NORTH	Range 8 WEST	County SAN JUAN	
Actual Footage Location of Well: 1480 feet from the NORTH line and 1850 feet from the EAST line					
Ground Level Elev. 6915	Producing Formation Pictured Cliff		Pool Wildcat	Dedicated Acreage: 160 Acres	

1. Outline the acreage dedicated to the subject well by colored pencil or hachure marks on the plat below.
2. If more than one lease is dedicated to the well, outline each and identify the ownership thereof (both as to working interest and royalty),
3. If more than one lease of different ownership is dedicated to the well, have the interests of all owners been consolidated by communitization, unitization, force-pooling, etc?

() Yes () No If answer is "yes," type of consolidation

If answer is "no," list the owners and tract descriptions which have actually consolidated. (Use reverse side of this form if necessary.)

No allowable will be assigned to the well until all interests have been consolidated (by communitization, unitization, forced-pooling, or otherwise) or until a non standard unit, eliminating such interests, has been approved by the Commission.

CERTIFICATION

I hereby certify that the information contained herein is true and complete to the best of my knowledge and belief.

John Alexander
Name
Agent
Position
Oklahoma Oil Company
Company
12-30-76
Date

John Alexander

I hereby certify that the well location shown on this plat was plotted from field notes of actual surveys made by me or under my supervision, and that the same is true and correct to the best of my knowledge and belief.

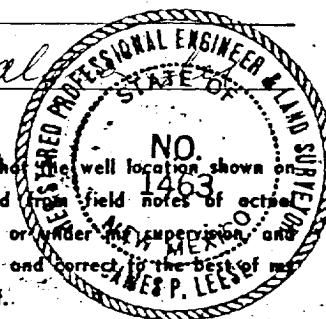

29 December 1976

Date Surveyed
James P. Leese
Registered Professional Engineer
and/or Land Surveyor James P. Leese

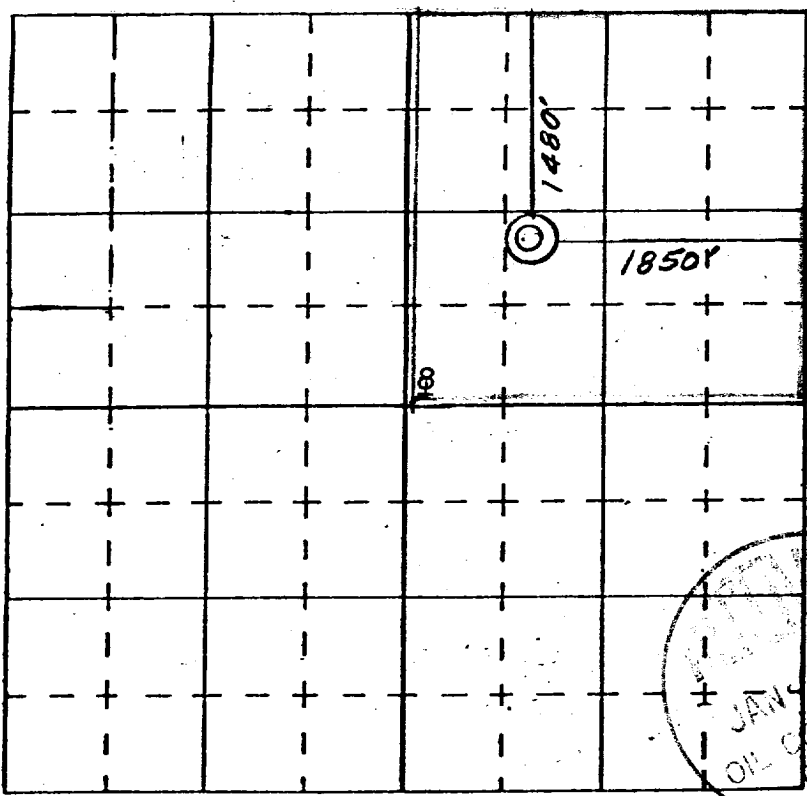

1463

Certificate No.