

Jim  
Duce  
1/28/94  
CJ



STATE OF NEW MEXICO  
ENERGY, MINERALS AND NATURAL RESOURCES DEPARTMENT  
OIL CONSERVATION DIVISION



BRUCE KING  
GOVERNOR  
  
ANITA LOCKWOOD  
CABINET SECRETARY

POST OFFICE BOX 2088  
STATE LAND OFFICE BUILDING  
SANTA FE, NEW MEXICO 87504  
(505) 827-5800

January 28, 1994

Dugan Production Corporation  
P.O. Box 420  
Farmington, NM 87499

Attention: Jim L. Jacobs

*Administrative Order NSL-3344*

Dear Mr. Jacobs:

Reference is made to your application dated January 6, 1994 for a non-standard Basin-Fruitland coal gas well location for your existing Okie Well No. 1 which was drilled in 1977 and completed in the Potwin-Pictured Cliffs Pool at a standard gas well location 1105 feet from the South line and 840 feet from the East line (Unit P) of Section 8, Township 24 North, Range 8 West, NMPM, San Juan County, New Mexico.

It is my understanding that the Pictured Cliffs zone will be properly plugged back and said well will be recompleted to the Basin-Fruitland Coal Gas Pool, which pursuant to the Special Rules and Regulations for the Basin-Fruitland Coal Gas Pool as promulgated by Division Order No. R-8768, as amended, is unorthodox. Further, the S/2 of said Section 8 shall be dedicated to the well forming a standard 320-acre gas spacing and proration unit for said pool.

By the authority granted me under the provisions of Rule 8 of said Division Order No. R-8768, as amended, the above-described unorthodox coal gas well location is hereby approved.

Sincerely,

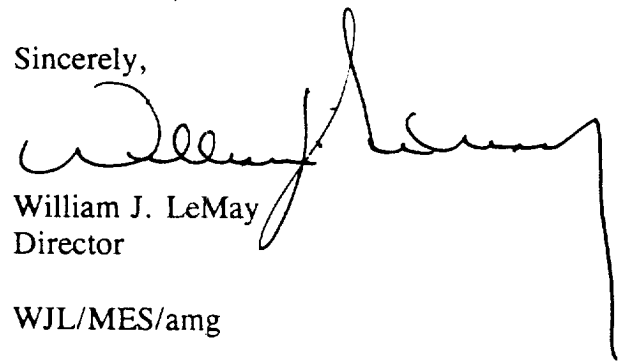
  
William J. LeMay  
Director

WJL/MES/amg

cc: Oil Conservation Division - Aztec  
US Bureau of Land Management - Farmington

**RECEIVED**  
FEB-11-1994  
OIL CON. DIV  
DIST. 3





STATE OF NEW MEXICO  
ENERGY, MINERALS and NATURAL RESOURCES DEPARTMENT  
OIL CONSERVATION DIVISION  
AZTEC DISTRICT OFFICE

1000 RIO BRAZOS ROAD  
AZTEC, NEW MEXICO 87410  
(505) 334-6178

Date: 1-26-94

*Attn: Mike Stogner*

Oil Conservation Division  
P.O. Box 2088  
Santa Fe, NM 87504-2088

RE: Proposed MC \_\_\_\_\_  
Proposed NSL X \_\_\_\_\_  
Proposed WFX \_\_\_\_\_  
Proposed NSP \_\_\_\_\_

Proposed DHC \_\_\_\_\_  
Proposed SWD \_\_\_\_\_  
Proposed PMX \_\_\_\_\_  
Proposed DD \_\_\_\_\_

Gentlemen:

I have examined the application received on 1-7-94  
for the DOGAN PROD CORP French Creek #1  
OPERATOR LEASE & WELL NO.

P 08-241-0870 and my recommendations are as follows:  
UL-S-T-R

Approved  
\_\_\_\_\_  
\_\_\_\_\_  
\_\_\_\_\_  
\_\_\_\_\_  
\_\_\_\_\_

Yours truly,

*Erica Smith*



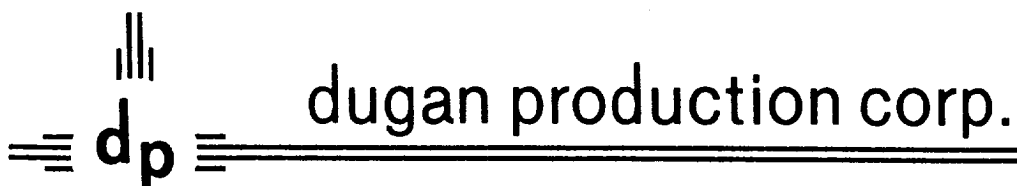

January 6, 1994

Mr. Michael E. Stogner  
New Mexico Oil Conservation Division  
P.O. Box 2088  
Santa Fe, NM 87504-2088

**Re: Application for Administrative Approval of  
Unorthodox Location for Dugan Production Corp's Okie #1  
1105' FSL & 840' FEL, Sec. 8, T24N, R8W, NMPM  
San Juan County, New Mexico  
Basin Fruitland Coal**

Dear Mr. Stogner:

We hereby request approval for an unorthodox location for the subject well. Copies of the well location plat, topographic map, a production map and a map showing offsetting operators are attached for your reference.

The unorthodox location is necessary in order to salvage the wellbore of an unsuccessful Pictured Cliffs test. Originally, the Okie #1 was drilled to test the Pictured Cliffs Sandstone. The test was unsuccessful, the zone will be abandoned and a completion in the Fruitland Coal will be undertaken.

A copy of this application is being submitted to all offsetting operators by certified mail with a request that they furnish your office with a waiver of objection.

We request your approval of this location under the provisions of NMOCD Order No. R-8768, Rule #8.

Sincerely,

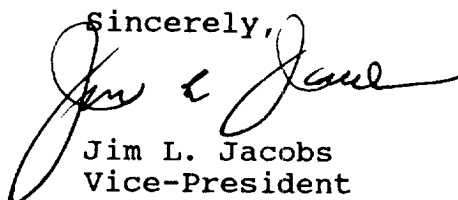

Jim L. Jacobs  
Vice-President

KF/cg

attachs.

cc: Mr. Ernie Busch, NMOCD Aztec  
Offsetting Operators  
BLM, Farmington

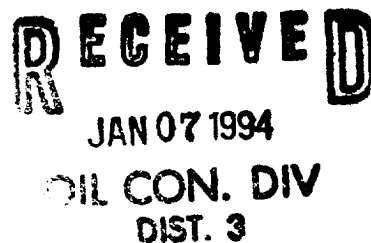



# NEW MEXICO OIL CONSERVATION COMMISSION

## WELL LOCATION AND ACERAGE DEDICATION PLAT

All distances must be from the outer boundaries of the Section

Operator <b>OKLAHOMA OIL COMPANY</b>			Lease <b>FRENCH WASH</b>		Well No. <b>1</b>
Unit Letter <b>P</b>	Section <b>8</b>	Township <b>24 NORTH</b>	Range <b>8 WEST</b>	County <b>SAN JUAN</b>	
Actual Footage Location of Well: <div style="display: flex; justify-content: space-between;"> <span><b>1105</b> feet from the <b>SOUTH</b> line and</span> <span><b>840</b> feet from the <b>EAST</b> line</span> </div>					
Ground Level Elev. <b>6917</b>	Producing Formation <b>Pictured Cliff</b>		Pool <b>Wildcat</b>	Dedicated Acreage: <b>160</b> Acres	

1. Outline the acreage dedicated to the subject well by colored pencil or hatchure marks on the plat below.
  2. If more than one lease is dedicated to the well, outline each and identify the ownership thereof (both as to working interest and royalty),
  3. If more than one lease of different ownership is dedicated to the well, have the interests of all owners been consolidated by communitization, unitization, force-pooling, etc?
- ( ) Yes ( ) No If answer is "yes," type of consolidation \_\_\_\_\_

If answer is "no," list the owners and tract descriptions which have actually consolidated. (Use reverse side of this Form if necessary.) \_\_\_\_\_

No allowable will be assigned to the well until all interests have been consolidated (by communitization, unitization, forced-pooling, or otherwise) or until a non standard unit, eliminating such interests, has been approved by the Commission.

**RECEIVED**  
 JAN 07 1994  
 OIL CON. DIV.  
 DIST. 3

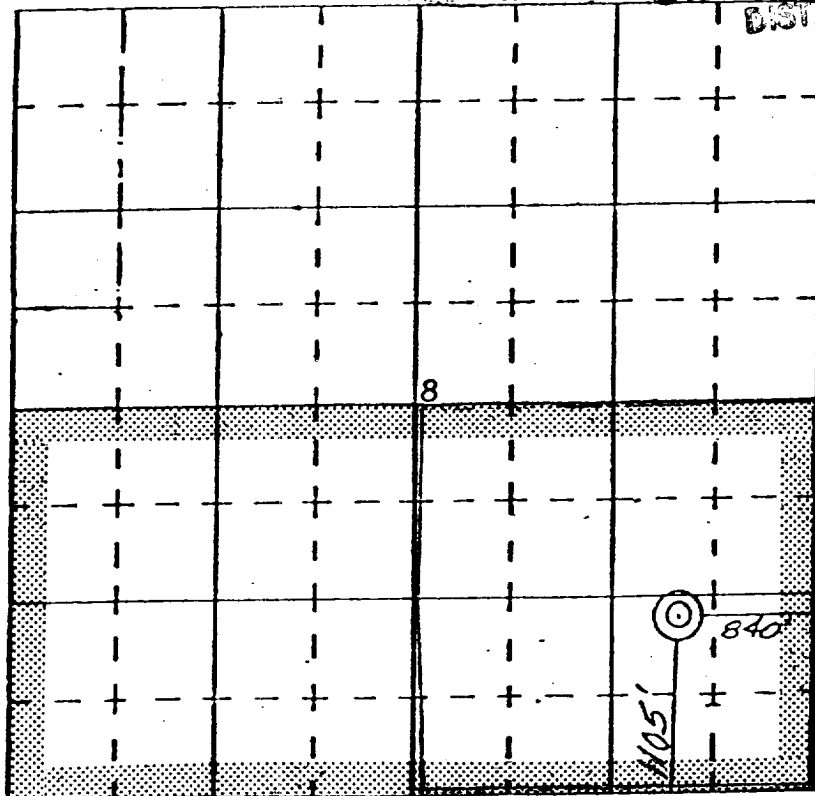

### CERTIFICATION

I hereby certify that the information contained hereon is true and complete to the best of my knowledge and belief.

John Alexander  
 Name  
Agent  
 Position  
Oklahoma Oil Company  
 Company  
12-30-76  
 Date

*John Alexander*

I hereby certify that the well location depicted on this plat was plotted from field notes of actual surveys made by me or under my supervision, that the same is true and correct to the best of my knowledge and belief.

28 Dec 1976  
 Date Surveyed  
*James P. Leese*  
 Registered Professional Engineer  
 and/or Land Surveyor **James P. Leese**

1463

Certificate No.



R8W

T  
24  
N

Okie #1



RECEIVED

JAN 07 1994

OIL CON. DIV.  
DIST. 3

APPLICATION FOR  
UNORTHODOX LOCATION  
TOPOGRAPHIC MAP

DUGAN PRODUCTION CORP.  
OKIE #1  
1105' FSL - 840' FEL  
Sec. 8, T24N, R8W, NMPM  
SAN JUAN CO., NM



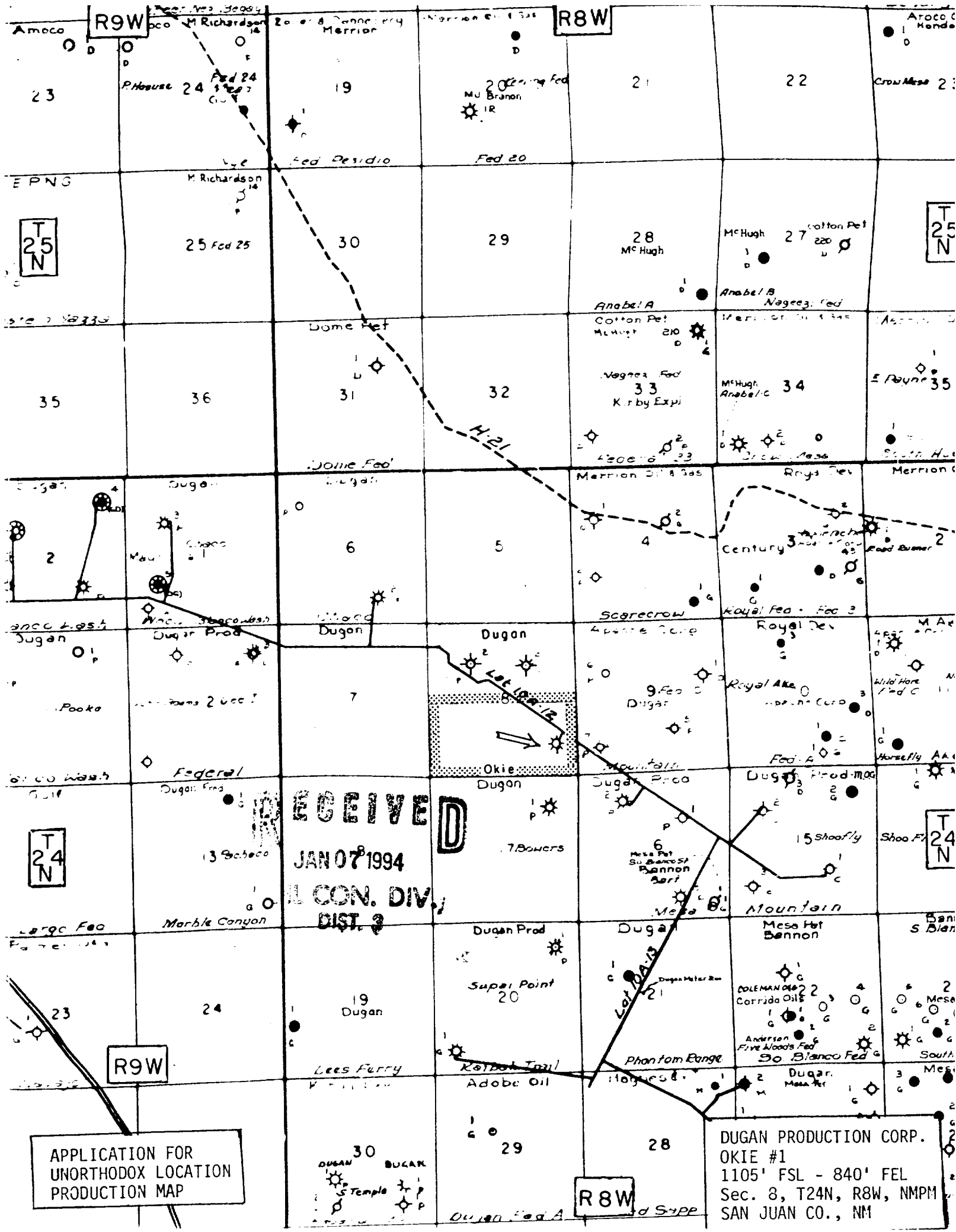

R9W

R8W

T25N

T25N

T24N

T24N

R9W

R8W

RECEIVED  
JAN 07 1994  
U.S. CON. DIV.,  
DIST. 3

APPLICATION FOR  
UNORTHODOX LOCATION  
PRODUCTION MAP

DUGAN PRODUCTION CORP.  
OKIE #1  
1105' FSL - 840' FEL  
Sec. 8, T24N, R8W, NMPM  
SAN JUAN CO., NM



