

NO. OF COPIES RECEIVED	
DISTRIBUTION	
SANTA FE	
FILE	
U.S.G.S.	
AND OFFICE	
OPERATOR	

NEW MEXICO OIL CONSERVATION COMMISSION

30-045-24680
Form C-101
Revised 1-1-65

5A. Indicate Type of Lease STATE <input checked="" type="checkbox"/> FEE <input type="checkbox"/>
5. State Oil & Gas Lease No. NMLG 1034-2
7. Unit Agreement Name
8. Farm or Lease Name SOUTH BLANCO STATE 36
9. Well No. 3
10. Field and Pool, or Wildcat LYBROOK - GALLUP <i>ent</i>
12. County SAN JUAN
19. Proposed Depth 5650
19A. Formation GALLUP
20. Rotary or C.T. ROTARY
21. Elevations (Show whether DF, RT, etc.) 6901 GL
21A. Kind & Status Plug. Bond STATEWIDE
21B. Drilling Contractor YOUNG
22. Approx. Date Work will start December 15, 1980

APPLICATION FOR PERMIT TO DRILL, DEEPEN, OR PLUG BACK

1. Name of Operator MESA PETROLEUM CO.	2. Type of Well DRILL <input type="checkbox"/> DEEPEN <input type="checkbox"/> PLUG BACK <input type="checkbox"/> OIL WELL <input checked="" type="checkbox"/> GAS WELL <input type="checkbox"/> OTHER <input type="checkbox"/>	3. Address of Operator 1660 Lincoln, 2800 Lincoln Center, Denver, Colorado 80264
4. Location of Well UNIT LETTER G LOCATED 1670 FEET FROM THE NORTH LINE AND 1670 FEET FROM THE EAST LINE OF SEC. 36 TWP. 24N RGE. 8W NMPM	5. Name of Operator MESA PETROLEUM CO.	6. Address of Operator 1660 Lincoln, 2800 Lincoln Center, Denver, Colorado 80264
7. Unit Agreement Name	8. Farm or Lease Name SOUTH BLANCO STATE 36	9. Well No. 3
10. Field and Pool, or Wildcat LYBROOK - GALLUP <i>ent</i>	12. County SAN JUAN	19. Proposed Depth 5650
19A. Formation GALLUP	20. Rotary or C.T. ROTARY	21. Elevations (Show whether DF, RT, etc.) 6901 GL
21A. Kind & Status Plug. Bond STATEWIDE	21B. Drilling Contractor YOUNG	22. Approx. Date Work will start December 15, 1980

PROPOSED CASING AND CEMENT PROGRAM

SIZE OF HOLE	SIZE OF CASING	WEIGHT PER FOOT	SETTING DEPTH	SACKS OF CEMENT	EST. TOP
12 1/4	8 5/8	24	250	200	Surface
7 7/8	4 1/2	10.5	5650	1000	900'

GAS UNDER THIS LEASE IS NOT DEDICATED TO A CONTRACT.

A 10" 900 series BOP will be in service from under surface casing. Surface casing and BOP will be tested to 2,000 psi. The BOP will be operated daily. Adequate mud supplies will be available on location to control any blowout situation.

APPROVAL VALID
FOR 90 DAYS UNLESS
DELETED OTHERWISE

EXPIRE 2-22-81



ABOVE SPACE DESCRIBE PROPOSED PROGRAM; IF PROPOSAL IS TO DEEPEN OR PLUG BACK, GIVE DATA ON PRESENT PRODUCTION ZONE AND PROPOSED NEW PRODUCTION ZONE. GIVE BLOWOUT PREVENTER PROGRAM, IF ANY.

I hereby certify that the information above is true and complete to the best of my knowledge and belief.

signed John Alexander Title AGENT Date November 20, 1980

(This space for State Use)

APPROVED BY Ernest J. Garry TITLE SUPERVISOR DISTRICT 3 DATE NOV 24 1980

CONDITIONS OF APPROVAL, IF ANY:

OIL CONSERVATION DIVISION

P. O. BOX 2088

SANTA FE, NEW MEXICO 87501

Form O-107

Revised 10-1-75

STATE OF NEW MEXICO
OIL AND MINERALS DEPARTMENT

All distances must be from the center boundaries of the Section.

Operator MESA PETROLEUM COMPANY		Lease SOUTH BLANCO--STATE 36		Well No. 3
Unit Letter G	Section 36	Township 2LN	Range 8W	County San Juan

Actual Footage Location of Wells

1670	feet from the North	Line and	1670	feet from the East	Line
Ground Level Elev: 6901	Producing Formation GALLUP	Pool LYBROOK - GALLUP	Dedicated Acreage: 40		Acre

1. Outline the acreage dedicated to the subject well by colored pencil or hatchure marks on the plat below.

2. If more than one lease is dedicated to the well, outline each and identify the ownership thereof (both as to working interest and royalty).

3. If more than one lease of different ownership is dedicated to the well, have the interests of all owners been consolidated by communitization, unitization, force-pooling, etc?

☐ Yes ☐ No If answer is "yes," type of consolidation _____

If answer is "no," list the owners and tract descriptions which have actually been consolidated. (Use reverse side of this form if necessary.) _____

No allowable will be assigned to the well until all interests have been consolidated (by communitization, unitization, forced-pooling, or otherwise) or until a non-standard unit, eliminating such interests, has been approved by the Commission.

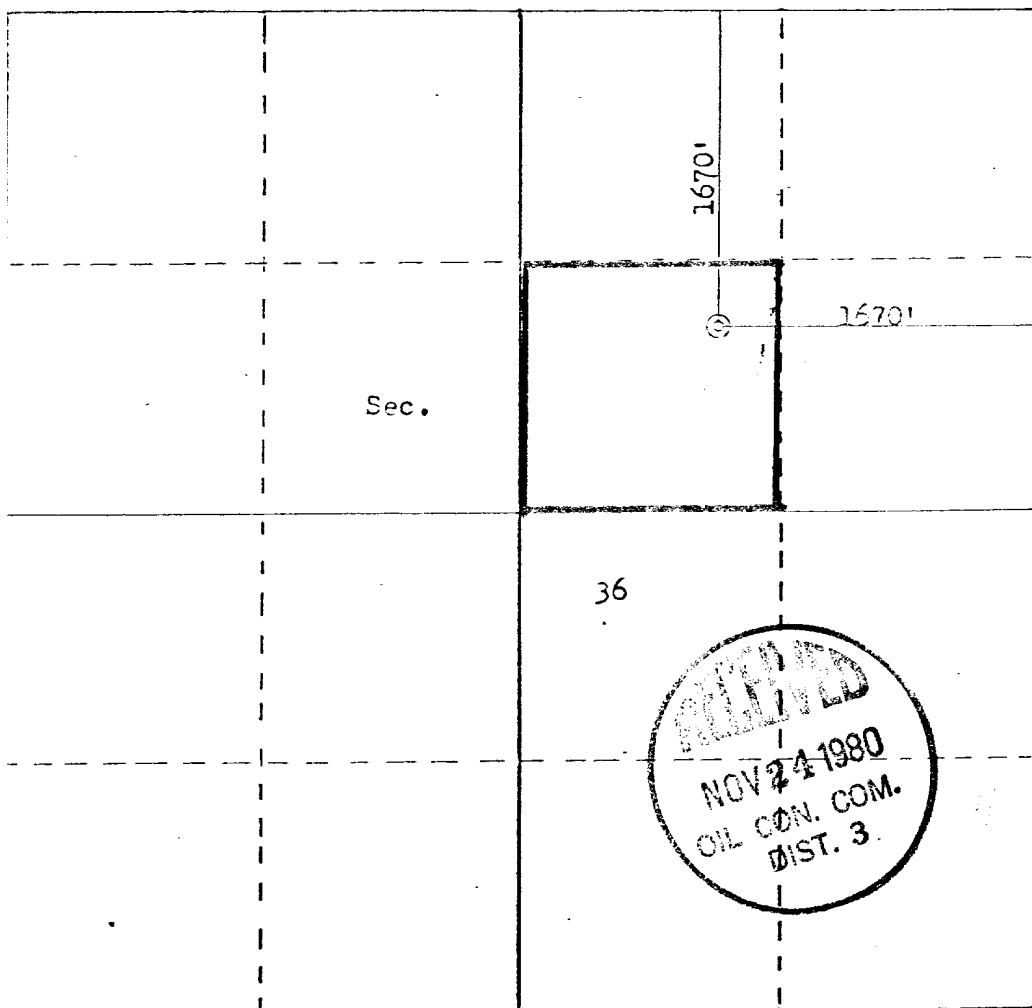

Scale: 1"=1000'

CERTIFICATION

I hereby certify that the information contained herein is true and complete to the best of my knowledge and belief.

John Alexander
Name

JOHN ALEXANDER

Position
AGENT

Company
MESA PETROLEUM CO.

Date
November 20, 1980

I hereby certify that the well location shown on this plat was plotted from field notes of actual surveys made by me or under my supervision, and that the same is true and correct to the best of my knowledge and belief.

Date Surveyed
November 5, 1980

Registered Professional Engineer
and Land Surveyor No. 10

Fred B. Kerr Jr.
Fred B. Kerr Jr.

Certificate No.
3950

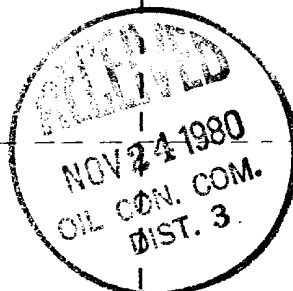

WELL NAME South Blanco #3-36 State FIELD Undesignated Gallup DATE 10-16-80
SURFACE LOCATION 1650' Fm N Line & 1650' Fm E Line, Sec. 36 T 24N R 8W
COUNTY San Juan STATE New Mexico PROPOSED TD 5650'

4. ANTICIPATED FORMATION TOPS:

<u>Formation</u>	<u>Depth</u>	<u>Content</u>	<u>Formation</u>	<u>Depth</u>	<u>Content</u>
<u>Pictured Cliffs</u>	<u>/ 1900'</u>	<u>/</u>	<u>* Upper Gallup</u>	<u>/ 5255'</u>	<u>/ Oil & Gas</u>
<u>Lewis</u>	<u>/ 1975'</u>	<u>/</u>	<u>* Marye Sand</u>	<u>/ 5415'</u>	<u>/ Oil & Gas</u>
<u>Chacra</u>	<u>/ 2760'</u>	<u>/ Gas</u>	<u>* Lower Gallup</u>	<u>/ 5435'</u>	<u>/ Oil & Gas</u>
<u>Cliffhouse</u>	<u>/ 3415'</u>	<u>/</u>		<u>/</u>	<u>/</u>
<u>Point Lookout</u>	<u>/ 4215'</u>	<u>/</u>		<u>/</u>	<u>/</u>
<u>Mancos</u>	<u>/ 4470'</u>	<u>/</u>		<u>/</u>	<u>/</u>

* Denotes primary zones of interest

5. DRILLING SAMPLES:

<u>10</u>	<u>ft. Samples</u>	<u>From 1900'</u>	<u>To 2000'</u>
<u>10</u>	<u>ft. Samples</u>	<u>From 2760'</u>	<u>To 2860'</u>
<u>10</u>	<u>ft. Samples</u>	<u>From 5255'</u>	<u>To TD</u>
	<u>ft. Samples</u>	<u>From</u>	<u>To</u>

6. CORING PROGRAM: NONE

<u>Formation</u>	<u>Interval</u>	<u>Total Footage</u>
	<u>From -- To</u>	
<u>1.</u>		
<u>2.</u>		
<u>3.</u>		
<u>4.</u>		

7. DRILL STEM TESTS: NONE

<u>Depth</u>	<u>Formation</u>	<u>Depth</u>	<u>Formation</u>
<u>1.</u>	<u>/</u>	<u>4.</u>	<u>/</u>
<u>2.</u>	<u>/</u>	<u>5.</u>	<u>/</u>
<u>3.</u>	<u>/</u>	<u>6.</u>	<u>/</u>

8. PROPOSED OPEN HOLE LOGGING PROGRAM:

<u>Type</u>	<u>From</u>	<u>Depth</u>	<u>To</u>
<u>IES</u>	<u>Base surf. csg. /</u>		<u>TD</u>
<u>Gamma Ray - Cal., CNL-FDC</u>	<u>Base surf. csg. /</u>		<u>TD</u>
	<u>/</u>		
	<u>/</u>		

9. MUD LOGGING PROGRAM:

One man portable with trailer on at 1500'.

3. Well site Geologist on well site at 1500' depth.

NOTIFICATION: Telephone Mesa's Denver Office, Operations Dept., Monday thru Friday by 9:00 AM with drilling reports. Call Alex Nash's residence on Weekends & Holidays at 303/741-3353 or 1st. alternate Jim Farrell's residence at 303/759-3165.

Call Geological information to Mesa's Denver office 303/861-4243, Attn. David Hamilton
Weekends & Holidays call David Hamilton at 303/ 751-9560
1st. Alternate John Barwin at 303/ 279-9732
2nd. Alternate Bob King at 303/ 759-2083