

STATE OF NEW MEXICO  
ENERGY AND MINERALS DEPARTMENT

OIL CONSERVATION DIVISION

P. O. BOX 2088

SANTA FE, NEW MEXICO 87501

30-045-25199  
Form C-101  
Revised 10-1-78

NO. OF COPIES RECEIVED	
DISTRIBUTION	
SANTA FE	
FILE	
U.S.G.S.	
LAND OFFICE	
OPERATOR	

5A. Indicate Type of Lease
STATE <input checked="" type="checkbox"/> FEE <input type="checkbox"/>

5. State Oil & Gas Lease No.
L2986

APPLICATION FOR PERMIT TO DRILL, DEEPEN, OR PLUG BACK

14. Type of Work				7. Unit Agreement Name	
b. Type of Well DRILL <input checked="" type="checkbox"/> DEEPEN <input type="checkbox"/> PLUG BACK <input type="checkbox"/> OIL WELL <input checked="" type="checkbox"/> GAS WELL <input type="checkbox"/> OTHER <input type="checkbox"/> SINGLE ZONE <input checked="" type="checkbox"/> MULTIPLE ZONE <input type="checkbox"/>				8. Farm or Lease Name	
2. Name of Operator Kenai Oil & Gas Inc.				State of New Mex. 36	
3. Address of Operator 2000 Energy Center One, 717 17th St. Denver, Colo. 80202				9. Well No. 44	
4. Location of Well UNIT LETTER <u>P</u> LOCATED <u>890'</u> FEET FROM THE <u>South</u> LINE AND <u>790'</u> FEET FROM THE <u>East</u> LINE OF SEC. <u>36</u> TWP. <u>24N</u> RGE. <u>8W</u> NMPM				10. Field and Pool, or Wildcat Lybrook Gallup Ext.	
				12. County San Juan	
19. Proposed Depth 5700		19A. Formation Gallup		20. Rotary or C.T. Rotary	
21. Elevations (Show whether DF, RT, etc.) 6904' GL		21A. Kind & Status Plug. Bond Blanket		21B. Drilling Contractor Young Drilling	
				22. Approx. Date Work will start 10-15-81	

23.

PROPOSED CASING AND CEMENT PROGRAM

SIZE OF HOLE	SIZE OF CASING	WEIGHT PER FOOT	SETTING DEPTH	SACKS OF CEMENT	EST. TOP
12 1/4"	8 5/8"	24 #	250'	250 SX	Surface
7 7/8"	5 1/2"	15.5#	5700'	1000 SX	Cover OJOAlam

Gas is not dedicated

The SESE of section 36 is dedicated to this well.

Selectively test, perforate, and sandwater fracture the Gallup formation. A 3000 psi W.P. and 6000 psi test double gate preventer will be used for blow out prevention. It will be equipped with blind and pipe rams.

APPROVAL VALID  
FOR 90 DAYS UNLESS  
DRILLING COMMENCED,

3-24-82



IN ABOVE SPACE DESCRIBE PROPOSED PROGRAM: IF PROPOSAL IS TO DEEPEN OR PLUG BACK, GIVE DATA ON PRESENT PRODUCTIVE ZONE AND PROPOSED NEW PRODUCTIVE ZONE. GIVE BLOWOUT PREVENTER PROGRAM, IF ANY.

I hereby certify that the information above is true and complete to the best of my knowledge and belief.

Signed Harold P. Howell Title District Engineer Date 9-18-81

(This space for State Use)

APPROVED BY Frank T. Long TITLE SUPERVISOR DISTRICT # 3 DATE SEP 24 1981

CONDITIONS OF APPROVAL, IF ANY:

NEW MEXICO OIL CONSERVATION COMMISSION  
WELL LOCATION AND ACREAGE DEDICATION PLAT

Form C-102  
Supersedes C-128  
Effective 1-1-65

All distances must be from the outer boundaries of the Section.

Operator <b>KENAI OIL &amp; GAS INC.</b>		Lease <b>NEW MEXISO STATE 36</b>		Well No. <b>44</b>
Unit Letter <b>P</b>	Section <b>26</b>	Township <b>24 NORTH</b>	Range <b>8 WEST</b>	County <b>SAN JUAN</b>
Actual Footage Location of Well: <b>890</b> feet from the <b>SOUTH</b> line and <b>790</b> feet from the <b>EAST</b> line				
Ground Level Elev. <b>690L</b>	Producing Formation <b>GALLUP</b>	Pool <b>Lybrook-Gallup Extension</b>	Dedicated Acreage: <b>40</b> Acres	

1. Outline the acreage dedicated to the subject well by colored pencil or hachure marks on the plat below.
2. If more than one lease is dedicated to the well, outline each and identify the ownership thereof (both as to working interest and royalty).
3. If more than one lease of different ownership is dedicated to the well, have the interests of all owners been consolidated by communitization, unitization, force-pooling, etc?

☐ Yes ☐ No If answer is "yes," type of consolidation \_\_\_\_\_

If answer is "no," list the owners and tract descriptions which have actually been consolidated. (Use reverse side of this form if necessary.) \_\_\_\_\_

No allowable will be assigned to the well until all interests have been consolidated (by communitization, unitization, forced-pooling, or otherwise) or until a non-standard unit, eliminating such interests, has been approved by the Commission.

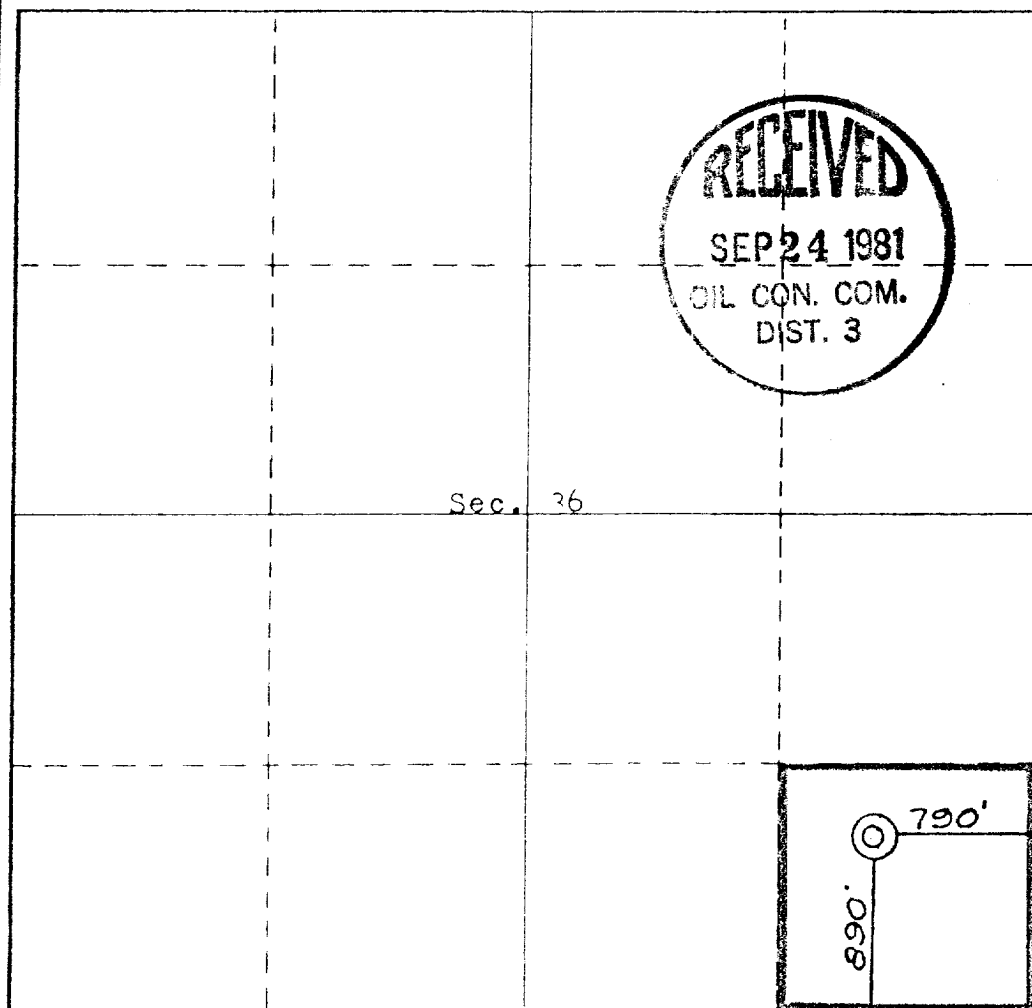

CERTIFICATION

I hereby certify that the information contained herein is true and complete to the best of my knowledge and belief.

*David P. Howell*

Name  
**David P. Howell**  
Position  
**District Engineer**  
Company  
**Kenai Oil and Gas Inc.**  
Date  
**9-16-81**

I hereby certify that the well location shown on this plat was plotted from field notes of actual surveys made by me or under my supervision, and that the same is true and correct to the best of my knowledge and belief.

**5 AUGUST 1981**  
*Charles C. Stucking*  
Registered Professional Engineer and/or Land Surveyor  
**5900 NMLS**  
Certificate No. **U. STUCKING**



