

UNITED STATES
DEPARTMENT OF THE INTERIOR
GEOLOGICAL SURVEY

APPLICATION FOR PERMIT TO DRILL, DEEPEN, OR PLUG BACK

1a. TYPE OF WORK

DRILL ☒DEEPEN ☐PLUG BACK ☐

b. TYPE OF WELL

OIL
WELL ☒GAS
WELL ☐

OTHER

SINGLE
ZONE ☐MULTIPLE
ZONE ☐

2. NAME OF OPERATOR

R.E. Lauritsen Drilling

3. ADDRESS OF OPERATOR

P.O. Box 2364, Farmington, NM 87401

4. LOCATION OF WELL (Report location clearly and in accordance with any State requirements.)*

At surface

2110' FSL & 330' FEL

At proposed prod. zone

14. DISTANCE IN MILES AND DIRECTION FROM NEAREST TOWN OR POST OFFICE*

35 miles south on Bisti Highway from Farmington

15. DISTANCE FROM PROPOSED*

LOCATION TO NEAREST

PROPERTY OR LEASE LINE, FT.

(Also to nearest drig. unit line, if any)

330' FEL

18. DISTANCE FROM PROPOSED LOCATION*

TO NEAREST WELL, DRILLING, COMPLETED,
OR APPLIED FOR, ON THIS LEASE, FT.

19. PROPOSED DEPTH

4300

21. ELEVATIONS (Show whether DF, RT, GR, etc.)

6151.0 GR

23.

PROPOSED CASING AND CEMENTING PROGRAM

SIZE OF HOLE	SIZE OF CASING	WEIGHT PER FOOT	SETTING DEPTH	QUANTITY OF CEMENT
12 1/4"	8 5/8	23# J-55	100'	100 sacks
7 7/8"	4 1/2	10.5 J-55	4300'	650 sacks

Will drill 6 1/2" hole to 4300' and run open hole logs. If appears productive will run 4300' of 4 1/2", 10.5# new casing and cement with 650 sacks. Will perforate and stimulate as required. A 10" - 900 series double Ram Blow-out preventor will be used.

FORMATION	ESTIMATED TOPS	DEPTH	CONTENT
Picture Cliff		600	Salt Water (Possible Gas)
Chacra		980	Gas (Water possible)
Cliff House		1292	Water
Point Look Out		3149	Water
Mancos		3320	Shale
Gallup		4111	Oil

IN ABOVE SPACE DESCRIBE PROPOSED PROGRAM: If proposal is to deepen or plug back, give data on present productive zone and proposed new productive zone. If proposal is to drill or deepen directionally, give pertinent data on subsurface locations and measured and true vertical depths. Give blowout preventer program, if any.

24.

SIGNED

TITLE

Operator

DATE

6/17/82

(This space for Federal or State office use)

PERMIT NO.

APPROVED BY

TITLE

CONDITIONS OF APPROVAL, IF ANY:

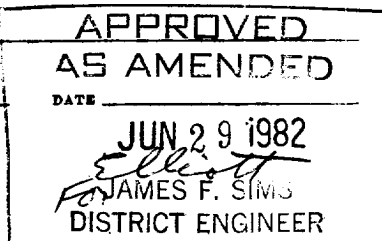
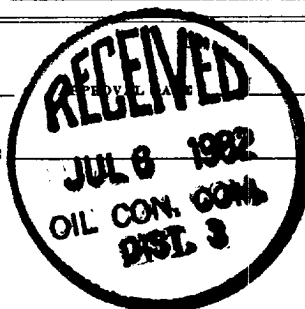



WELL LOCATION AND ACREAGE DEDICATION PLAT

Effective 1-1-82

All distances must be from the outer boundaries of the Section

Operator R. E. LAURITSEN DRILLING			Lease SOUTHERN UNION FEDERAL 12		Well No. 1-E
Unit Letter 1	Section 12	Township 24 NORTH	Range 13 WEST	County SAN JUAN	
Actual Footage Location of Well: 2110 feet from the SOUTH line and 330 feet from the EAST line					
Ground Level Elev. 6151.0	Producing Formation GALLUP	Pool WC	Dedicated Acreage 160 40		

1. Outline the acreage dedicated to the subject well by colored pencil or hatchure marks on the plat below.
2. If more than one lease is dedicated to the well, outline each and identify the ownership thereof (both as to working interest and royalty).
3. If more than one lease of different ownership is dedicated to the well, have the interests of all owners been consolidated by communitization, unitization, force-pooling, etc?

☐ Yes ☐ No If answer is "yes," type of consolidation _____

If answer is "no," list the owners and tract descriptions which have actually been consolidated. (Use reverse side of this form if necessary.) _____

No allowable will be assigned to the well until all interests have been consolidated (by communitization, unitization, forced-pooling, or otherwise) or until a non-standard unit, eliminating such interests, has been approved by the Commission.

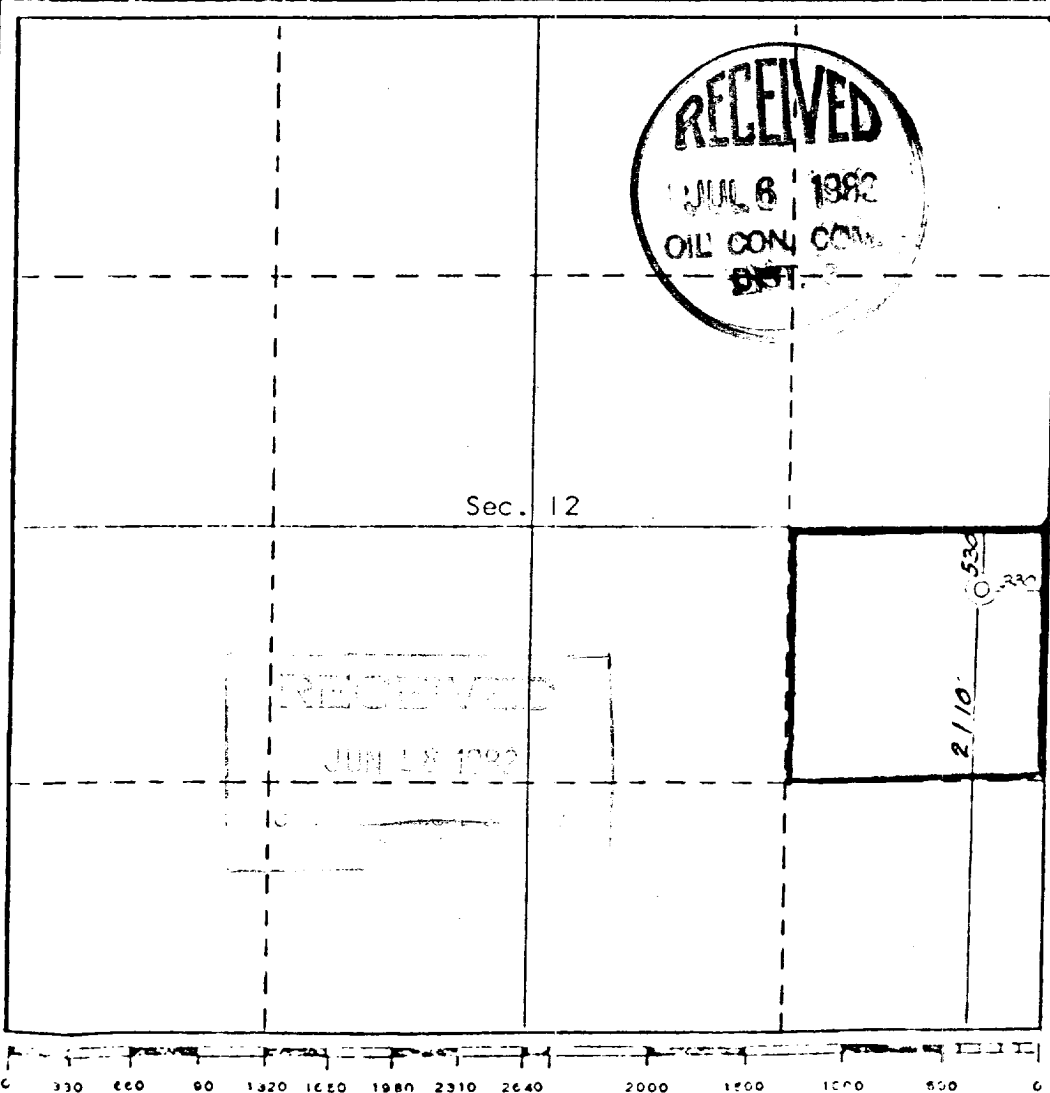

CERTIFICATION

I hereby certify that the information contained herein is true and complete to the best of my knowledge and belief.

Name
G. E. Lauritsen
Position
Agent
Company
R. E. LAURITSEN DRILLING
Date
6-18-82

I hereby certify that the well location shown on this plat was plotted from field notes of actual surveys made by me or under my supervision, and that the same is true and correct to the best of my knowledge and belief.

7 June 1982
Curtis C. Stocking
Curtis C. Stocking
5560

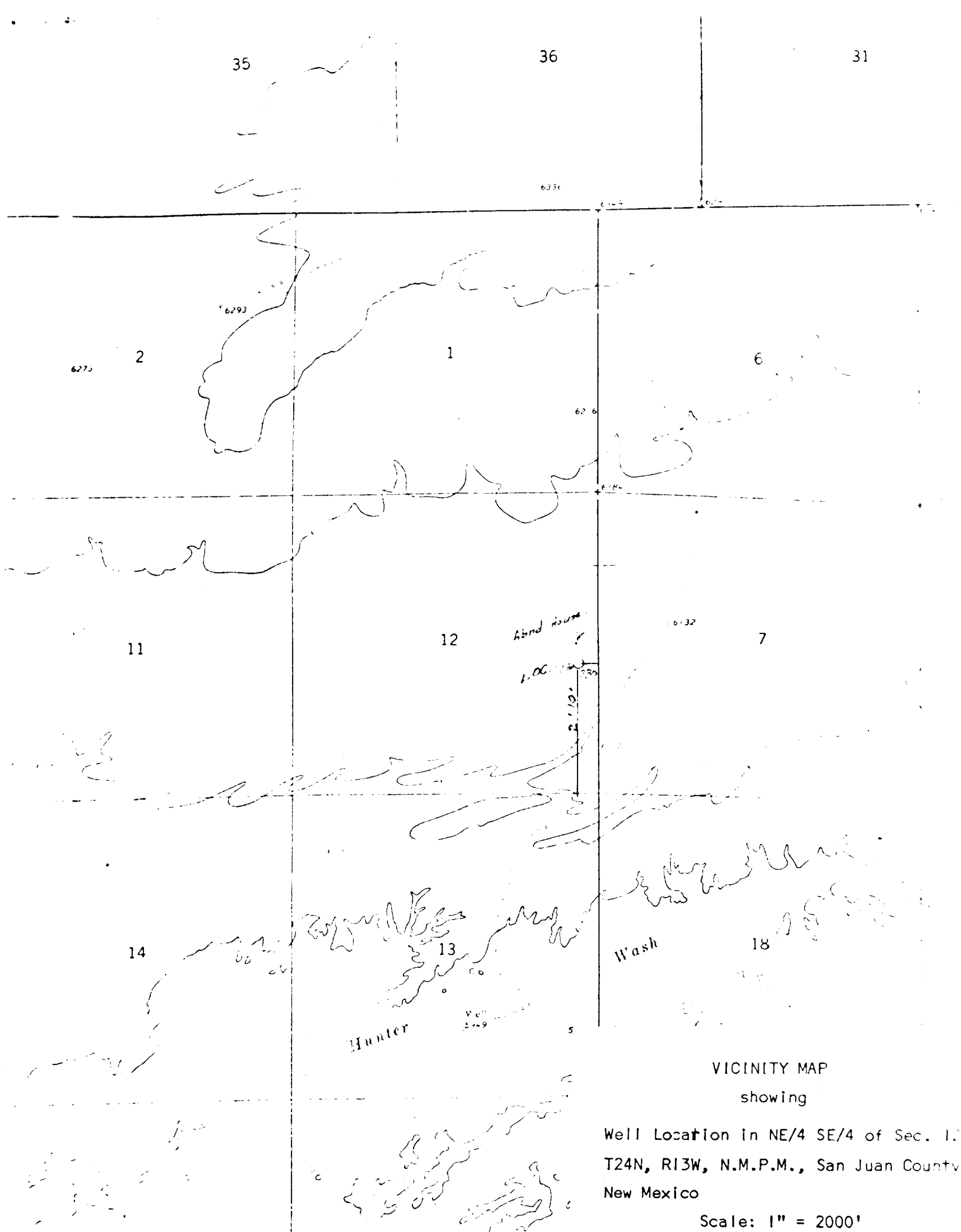

VICINITY MAP
showing

Well Location in NE/4 SE/4 of Sec. 12
T24N, R13W, N.M.P.M., San Juan County
New Mexico

Scale: 1" = 2000'