

UNITED STATES
DEPARTMENT OF THE INTERIOR
BUREAU OF LAND MANAGEMENT

APPLICATION FOR PERMIT TO DRILL, DEEPEN, OR PLUG BACK

1a. TYPE OF WORK DRILL <input checked="" type="checkbox"/> DEEPEN <input type="checkbox"/> PLUG BACK <input type="checkbox"/>				5. LEASE DESIGNATION AND SERIAL NO. NM 16589	
b. TYPE OF WELL OIL WELL <input checked="" type="checkbox"/> GAS WELL <input type="checkbox"/> OTHER <input type="checkbox"/> SINGLE ZONE <input checked="" type="checkbox"/> MULTIPLE ZONE <input type="checkbox"/>				6. IF INDIAN, ALLOTTEE OR TRIBE NAME	
2. NAME OF OPERATOR Merrion Oil & Gas Corporation				7. UNIT AGREEMENT NAME	
3. ADDRESS OF OPERATOR P. O. Box 840, Farmington, New Mexico 87499				8. FARM OR LEASE NAME Shoofly	
4. LOCATION OF WELL (Report location clearly and in accordance with any State requirements.) At surface 340' FNL and 2260' FWL At proposed prod. zone Same				9. WELL NO. 3	
14. DISTANCE IN MILES AND DIRECTION FROM NEAREST TOWN OR POST OFFICE* approximately 16 miles North of Lybrook				10. FIELD AND POOL, OR WILDCAT Dufers Point Gallup Dakota	
15. DISTANCE FROM PROPOSED* LOCATION TO NEAREST PROPERTY OR LEASE LINE, FT. (Also to nearest drlg. unit line, if any) 340		16. NO. OF ACRES IN LEASE 1480		17. NO. OF ACRES ASSIGNED TO THIS WELL 160	
18. DISTANCE FROM PROPOSED LOCATION* TO NEAREST WELL, DRILLING, COMPLETED, OR APPLIED FOR, ON THIS LEASE, FT. 2450'		19. PROPOSED DEPTH 5880		20. ROTARY OR CABLE TOOLS 0 - TD	
21. ELEVATIONS (Show whether DF, RT, GR, etc.) 6930' GL DRILLING OPERATIONS AUTHORIZED ARE				22. APPROX. DATE WORK WILL START* Summer/1985	
23. SUBJECT TO COMPLIANCE WITH ATTACHED PROPOSED CASING AND CEMENTING PROGRAM "GENERAL REQUIREMENTS"				This action is subject to technical and procedural review pursuant to 43 CFR 3165.3 and appeal pursuant to 43 CFR 3165.4.	
SIZE OF HOLE	SIZE OF CASING	WEIGHT PER FOOT	SETTING DEPTH		
12-1/4"	8-5/8", J-55	24 #/ft.	200'	175 sx (206.5) Class B 3% CaCl2	
7-7/8"	4-1/2", J-55	10.5 #/ft.	5880'	As below	

Will drill 12-1/4" surface hole to 200 ft. and set 200 ft. of 8-5/8" 24 #/ft. J-55 grade casing with 175 sx Class B cement with 3% CaCl2. Will drill 7-7/8" hole to 5880 ft. Will run open hole logs. No other testing planned. If well appears productive, will run 5880 ft. of 4-1/2", 10.5 #/ft. J-55 grade casing and stage cement. First stage will cement with 250 sx Class H 2% gel (1.22 cu. ft/sk. yield) 305 cu. ft. cement to cover Gallup interval from TD. Estimated top of cement is 4750 ft. Will set stage collar at approximately 4600 ft., below Point Lookout Formation. Second stage will cement with 700 sx Class B 2% D-79 (2.06 cu. ft/sk.) followed by 50 sx Class H 2% Gel (1.22 cu. ft/sk) 61 cu. ft. to cover Mesaverde, Chacra, Pictured Cliffs, Fruitland and Ojo Alamo. Top of cement will be at surface.

Drilling circulating medium will be low solids, non-dispersed, low water loss mud using bentonite, starch, CMC and fresh water.

Minimum specifications for pressure control is 10" 900 series double ram blow out preventer. Will perforate and stimulate as required for completion.

IN ABOVE SPACE DESCRIBE PROPOSED PROGRAM: If proposal is to deepen or plug back, give data on present productive zone and proposed new productive zone. If proposal is to drill or deepen directionally, give pertinent data on subsurface locations and measured and true vertical depths. Give blowout preventer program if any.

24. SIGNED [Signature] TITLE Operations Manager DATE 8/6/85
(This space for Federal or State office use)
PERMIT NO. _____ APPROVAL DATE SEP 05 1985
APPROVED BY [Signature] TITLE _____ DATE _____
CONDITIONS OF APPROVAL, IF ANY:

NMOCC

*See Instructions On Reverse Side

**NEW MEXICO OIL CONSERVATION COMMISSION
WELL LOCATION AND ACREAGE DEDICATION PLAT**

Form C-102
Supersedes C-128
Effective 1-1-65

All distances must be from the outer boundaries of the Section.

Operator MERRION OIL & GAS CORPORATION			Lease SHOOFLY		Well No. 3
Unit Letter C	Section 15	Township 24N	Range 8W	County San Juan	
Actual Footage Location of Well: 340 feet from the North line and 2260 feet from the West line					
Ground Level Elev: 6930	Producing Formation Gallup		Pool Dufers Point Gallup Dakota		Dedicated Acreage 160 Acres

1. Outline the acreage dedicated to the subject well by colored pencil or hachure marks on the plat below.
2. If more than one lease is dedicated to the well, outline each and identify the ownership thereof (both as to working interest and royalty).
3. If more than one lease of different ownership is dedicated to the well, have the interests of all owners been consolidated by communitization, unitization, force-pooling, etc?

☐ Yes ☐ No If answer is "yes," type of consolidation _____

If answer is "no," list the owners and tract descriptions which have actually been consolidated. (Use reverse side of this form if necessary.) _____

No allowable will be assigned to the well until all interests have been consolidated (by communitization, unitization, forced-pooling, or otherwise) or until a non-standard unit, eliminating such interests, has been approved by the Commission.

2260'	340'	<div style="border: 1px solid black; padding: 10px; text-align: center;"> RECEIVED AUG 09 1985 </div>
	Sec.	
	NM 16589	
	15	
		<div style="border: 1px solid black; padding: 10px; text-align: center;"> RECEIVED SEP 05 1985 OIL CON. DIV. DIST. 3 </div>

Scale: 1"=1000'

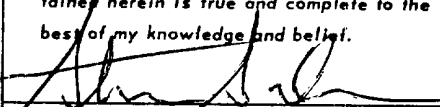
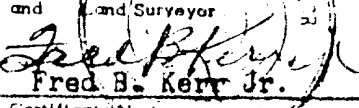
CERTIFICATION	
I hereby certify that the information contained herein is true and complete to the best of my knowledge and belief.	
 Name Steve S. Dunn	
Position Operations Manager	
Company Merrion Oil & Gas Corporation	
Date 7/31/85	
I hereby certify that the well location shown on this plat was plotted from field notes of actual surveys made by me or under my supervision, and that the same is true and correct to the best of my knowledge and belief.	
 Date Surveyed July 25, 1985 Registered Professional Engineer and Land Surveyor Fred B. Kerr Jr.	
Certificate No. 3950	

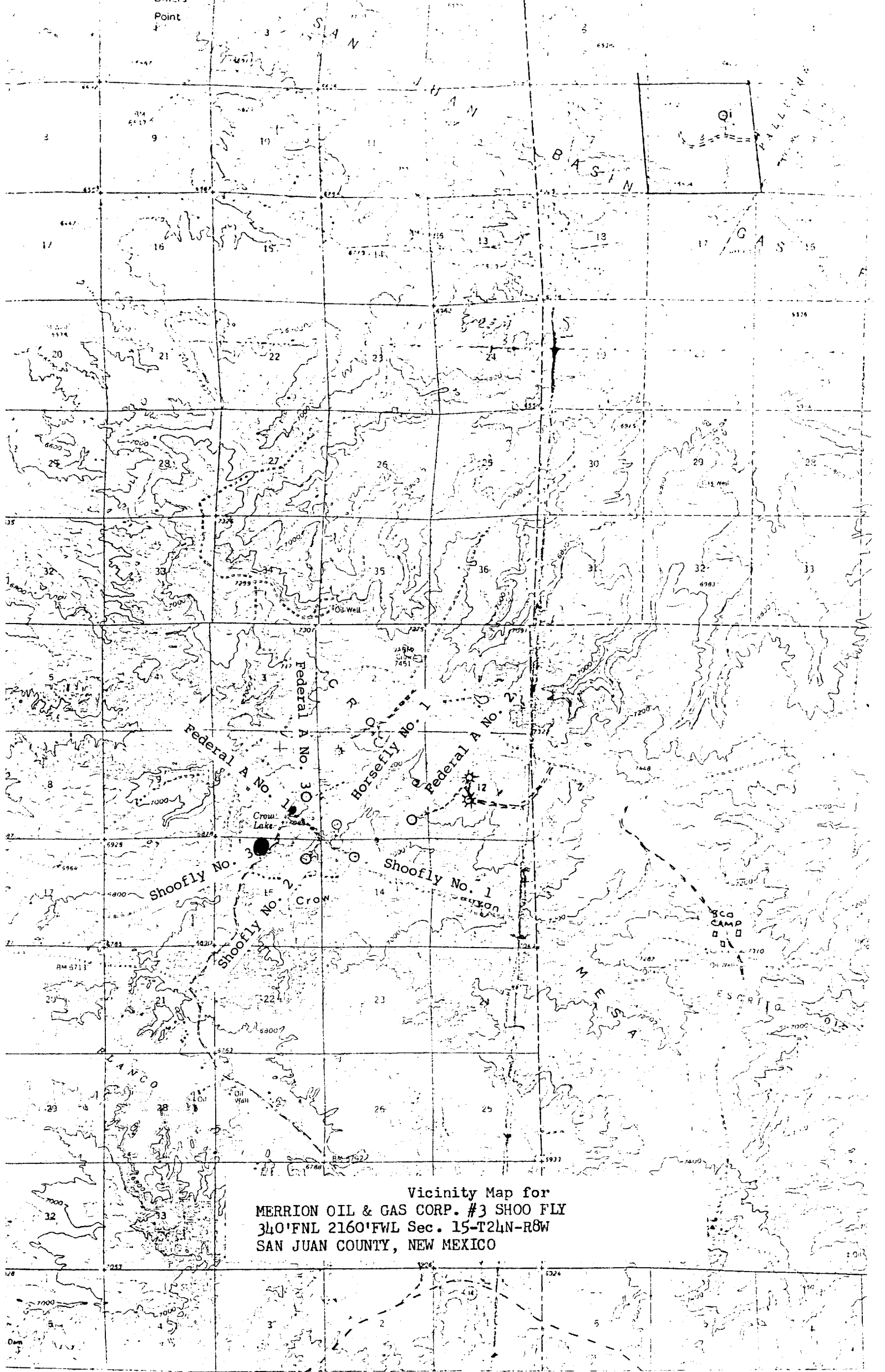

Vicinity Map for
MERRION OIL & GAS CORP. #3 SHOO FLY
340'FNL 2160'FWL Sec. 15-T24N-R8W
SAN JUAN COUNTY, NEW MEXICO