

UNITED STATES
DEPARTMENT OF THE INTERIOR
BUREAU OF LAND MANAGEMENT

APPLICATION FOR PERMIT TO DRILL, DEEPEN, OR PLUG BACK

1A. TYPE OF WORK

DRILL ☒

DEEPEN ☐

PLUG BACK ☐

B. TYPE OF WELL

OIL
WELL ☒

GAS
WELL ☐

OTHER ☐

SINGLE
ZONE ☐

MULTIPLE
ZONE ☐

2. NAME OF OPERATOR

Bannon Energy, Inc. c/o Helcomb Oil & Gas

3. ADDRESS OF OPERATOR

P.O. Box 2058, Farmington, NM 87499

4. LOCATION OF WELL (Report location clearly and in accordance with any State requirements.)

At surface

Unit I 1760' FSL x 475 FEL

At proposed prod. zone

14. DISTANCE IN MILES AND DIRECTION FROM NEAREST TOWN OR POST OFFICE*

5 miles NW of Lybrook

15. DISTANCE FROM PROPOSED*
LOCATION TO NEAREST
PROPERTY OR LEASE LINE, FT.
(Also to nearest drig. unit line, if any)

18. DISTANCE FROM PROPOSED LOCATION*
TO NEAREST WELL, DRILLING, COMPLETED,
OR APPLIED FOR, ON THIS LEASE, FT.

16. NO. OF ACRES IN LEASE

160

19. PROPOSED DEPTH

5800'

17. NO. OF ACRES ASSIGNED
TO THIS WELL

40

20. ROTARY OR CABLE TOOLS

Rotary

21. ELEVATIONS (Show whether DP, RT, GR, etc.)

6920' GR

22. APPROX. DATE WORK WILL START*

June 1, 1990

This action is subject to technical and
procedural review pursuant to 43 CFR 3100.3
and appeal pursuant to 43 CFR 3100.4

PROPOSED CASING AND CEMENTING PROGRAM

DRILLING OPERATIONS AUTHORIZED ARE
SUBJECT TO COMPLIANCE WITH ATTACHED
"GENERAL REQUIREMENTS"

	WEIGHT PER FOOT	SETTING DEPTH
12 1/4"	8 5/8"	24.0 lb. J-55
7 7/8"	4 1/2"	11.6 lb. K-55

Cement to surface.
800 sx-volume to be calculated
subsequent to logging & circulated
to surface.

Well to be drilled to penetrate the Gallup formation. Production intervals
in the Gallup will be stimulated as necessary.

EXHIBITS:

- "A" Location & Elevation Plat
- "B" Ten Point Compliance Program
- "C" Blowout Preventor Diagram
- "D" Multi-point requirments of APD
- "E" Site specific checklist for roads
(Attachment to "E" - Topo map)

- "F" Drill Rig Layout
- "G" Completion Program Layout
- "H" Location Profile

The gas from this lease is
committed.

RECEIVED

APR 24 1991

OIL CON. DIV.

DIST 2

IN ABOVE SPACE DESCRIBE PROPOSED PROGRAM: If proposal is to deepen or plug back, give data on present productive zone and proposed new productive
zone. If proposal is to drill or deepen directionally, give pertinent data on subsurface locations and measured and true vertical depths. Give blowout
preventer program, if any.

24. W. J. Helcomb

SIGNED

Agent, Bannon Energy

TITLE

(This space for Federal or State office use)

PERMIT NO.

APPROVAL DATE

APPROVED BY

TITLE

CONDITIONS OF APPROVAL, IF ANY:

NMOCD

*See Instructions On Reverse Side

APPROVED
AS AMENDED

APR 12 1991

AREA MANAGER

THE SECRETARY OF THE ARMY
WASHINGTON, D. C. 20315
OFFICE OF THE SECRETARY
ATTENTION: ASST. SEC. FOR
MILITARY PERSONNEL

1. THE SECRETARY OF THE ARMY
WASHINGTON, D. C. 20315
OFFICE OF THE SECRETARY
ATTENTION: ASST. SEC. FOR
MILITARY PERSONNEL

RECEIVED
MAY 14 1964
OIL CON. DIV.
PRT. 3

APPROVED
BY: [Signature]

1. [Signature]

1. [Signature]

Submit to Appropriate
District Office
State Lease - 4 copies
Fee Lease - 3 copies

State of New Mexico
Energy, Minerals and Natural Resources Department

Form C-102
Revised 1-1-89

OIL CONSERVATION DIVISION

P.O. Box 2088
Santa Fe, New Mexico 87504-2088

DISTRICT I
P.O. Box 1980, Hobbs, NM 88240

DISTRICT II
P.O. Drawer DD, Artesia, NM 88210

DISTRICT III
1000 Rio Brazos Rd., Aztec, NM 87410

WELL LOCATION AND ACREAGE DEDICATION PLAT

All Distances must be from the outer boundaries of the section

Operator BANNON ENERGY, INC.			Lease NAVAJO 25		Well No. 4
Unit Letter I	Section 25	Township T.24 N.	Range R.8 W.	County SAN JUAN COUNTY	
Actual Footage Location of Well: 1760 feet from the SOUTH line and 475 feet from the EAST line					
Ground level Elev. 6920	Producing Formation Gallup		Pool Lybrook Gallup		Dedicated Acreage: 40 Acres
<p>1. Outline the acreage dedicated to the subject well by colored pencil or hatchure marks on the plat below.</p> <p>2. If more than one lease is dedicated to the well, outline each and identify the ownership thereof (both as to working interest and royalty).</p> <p>3. If more than one lease of different ownership is dedicated to the well, have the interest of all owners been consolidated by communitization, unitization, force-pooling, etc.? <input type="checkbox"/> Yes <input type="checkbox"/> No If answer is "yes" type of consolidation _____</p> <p>If answer is "no" list the owners and tract descriptions which have actually been consolidated. (Use reverse side of this form if necessary.) _____</p> <p>No allowable will be assigned to the well until all interests have been consolidated (by communitization, unitization, forced-pooling, or otherwise) or until a non-standard unit, eliminating such interest, has been approved by the Division.</p>					

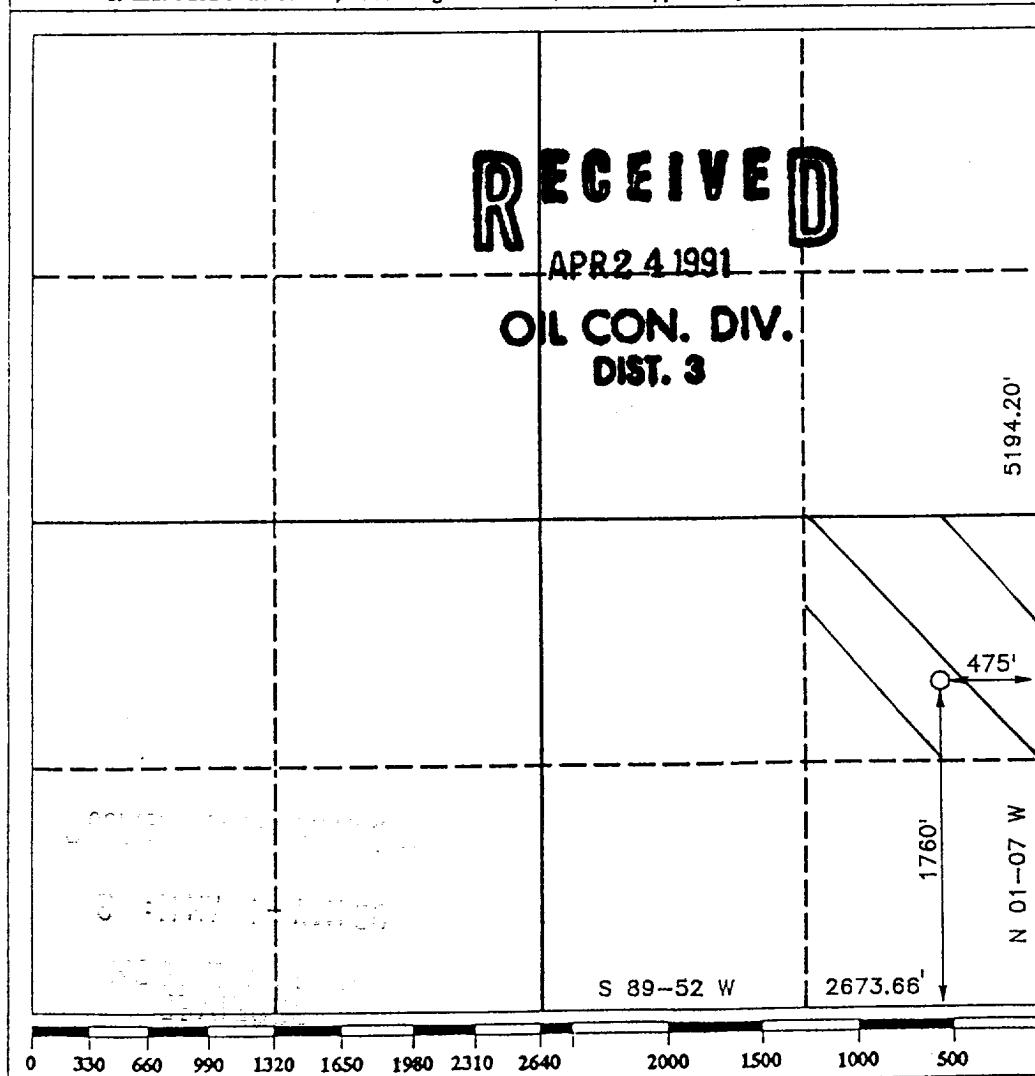

OPERATOR CERTIFICATION

I hereby certify that the information contained herein is true and complete to the best of my knowledge and belief.

Signature *W. J. Holcomb*
Printed Name **W. J. Holcomb**
Position **Agent**
Company **Bannon Energy, Inc.**
Date **3-20-90**

SURVEYOR CERTIFICATION

I hereby certify that the well location shown on this plat was plotted from field notes of actual surveys made by me or under my supervision, and that the same is true and correct to the best of my knowledge and belief.

Date Surveyed **FEBRUARY 26, 1990**
Signature & Seal of Professional Surveyor
R. EDWARD DAGGE
R. Edward Dagge
Certificate No. **9879**
Registered Professional Land Surveyor

RECEIVED

APR 24 1961

OIL CON. DIV.
DIST. 3

anyon

Navajo 25
1760' FEL
300' 25 T2
San Juan 98

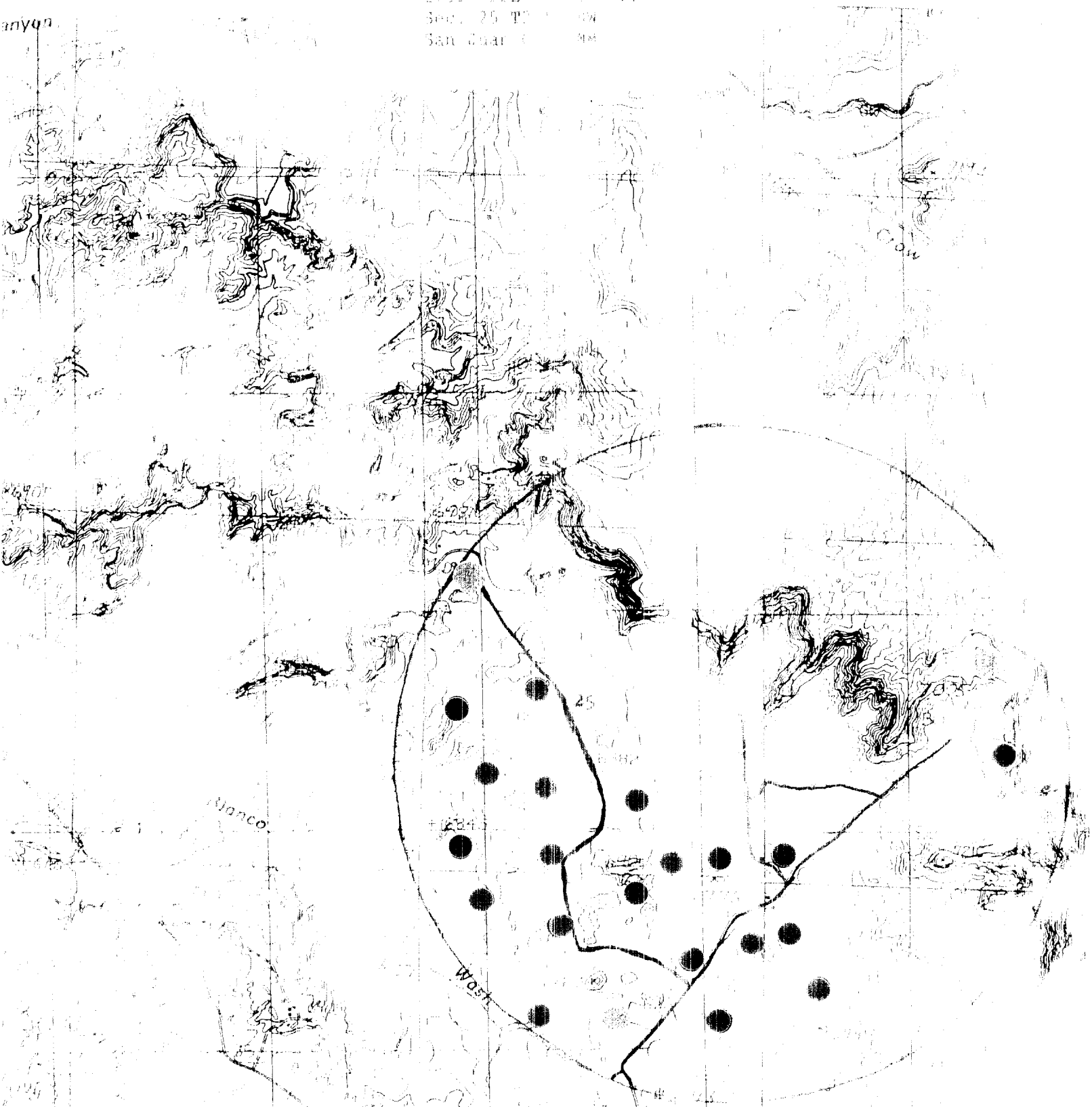

- | | | | |
|---|-------------------|---|---------------|
| — | Proposed Road | ● | Existing Well |
| — | Proposed Pipeline | ● | Existing Well |
| ● | Proposed Well | ● | Existing Well |

ARIZONA