

(SUBMIT IN TRIPLICATE)

Land Office Santa Fe

Lease No. 079288-3

Unit \_\_\_\_\_

UNITED STATES  
DEPARTMENT OF THE INTERIOR  
GEOLOGICAL SURVEY

SUNDRY NOTICES AND REPORTS ON WELLS

RECEIVED

NOTICE OF INTENTION TO DRILL	<input checked="" type="checkbox"/>	SUBSEQUENT REPORT OF WATER SHUT-OFF	JAN 22 1960
NOTICE OF INTENTION TO CHANGE PLANS		SUBSEQUENT REPORT OF SHOOTING OR ACIDIZING	
NOTICE OF INTENTION TO TEST WATER SHUT-OFF		SUBSEQUENT REPORT OF ALTERING CASING	
NOTICE OF INTENTION TO RE-DRILL OR REPAIR WELL		SUBSEQUENT REPORT OF RE-DRILLING OR REPAIR	
NOTICE OF INTENTION TO SHOOT OR ACIDIZE		SUBSEQUENT REPORT OF ABANDONMENT	
NOTICE OF INTENTION TO PULL OR ALTER CASING		SUPPLEMENTARY WELL HISTORY	
NOTICE OF INTENTION TO ABANDON WELL			

(INDICATE ABOVE BY CHECK MARK NATURE OF REPORT, NOTICE, OR OTHER DATA)

January 19, 1960

VEL Rajo

Well No. 1 is located 1900 ft. from N line and 1900 ft. from W line of sec. 9

SE/4 of NW/4  
(1/4 Sec. and Sec. No.)

T. 26 N., R. 1 E.  
(Twp.) (Range)

N.M.P.M.  
(Meridian)

(Field)

Rio Arriba  
(County or Subdivision)

New Mexico  
(State or Territory)

The elevation of the derrick floor above sea level is \_\_\_\_\_ ft.

DETAILS OF WORK

(State names of and expected depths to objective sands; show sizes, weights, and lengths of proposed casings; indicate mudding jobs, cementing points, and all other important proposed work)

Drill to approximately 2000' with cable tools, 9 5/8" casing cemented through Mesa Verde water at approximately 750'. Subsequently smaller strings to 3 1/2" casing as required to T.D. The Greenhorn Line will be tested in this well.

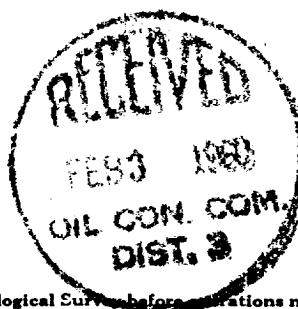

I understand that this plan of work must receive approval in writing by the Geological Survey before operations may be commenced.

Company INTEK OIL COMPANY

Address P.O. Box 1411

Bakersfield, California

By R. S. Miller

R. S. Miller

Title Production Manager



# CERTIFICATE OF SURVEY

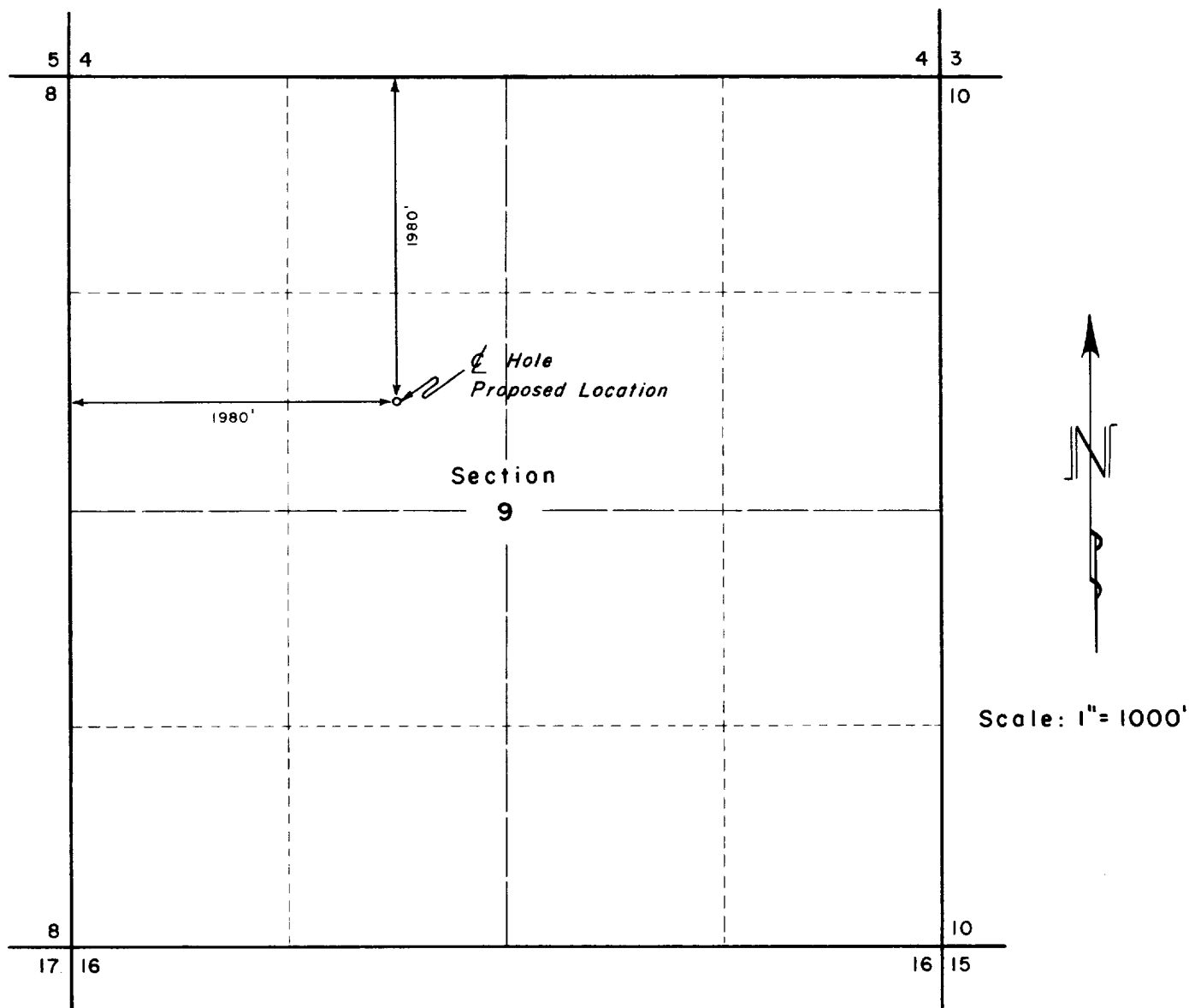

## WELL LOCATION: Intex Oil Co. — U.S.L. Bajo No. 1

Located 1980 feet South of the North line and 1980 feet East of the West line of Section 9  
Township 26 North Range 1 East New Mexico Principal Meridian  
Rio Arriba County, New Mexico  
Existing ground elevation determined at 7057 feet based on U.S.G.S. datum

I hereby certify the above plot represents a survey  
made under my supervision and is accurate to the  
best of my knowledge and belief.

*Elmer M. Clark*

ELMER M. CLARK  
Registered Land Surveyor  
State of New Mexico (No. 3189)

**E.M. CLARK & ASSOCIATES**  
Durango, Colorado  
JAN. 19, 1960