

NEW MEXICO OIL CONSERVATION COMMISSION
Santa Fe, New Mexico

NOTICE OF INTENTION TO DRILL OR RECOMPLETE

Notice must be given to the District Office of the Oil Conservation Commission and approval obtained before drilling or recompletion begins. If changes in the proposed plan are considered advisable, a copy of this notice showing such changes will be returned to the sender. Submit this notice in QUINTUPLICATE. One copy will be returned following approval. See additional instructions in Rules and Regulations of the Commission.

Midland, Texas

May 2, 1955

(Place)

(Date)

OIL CONSERVATION COMMISSION
SANTA FE, NEW MEXICO

Gentlemen:

You are hereby notified that it is our intention to commence the (Drilling) ~~Recompletion~~ of a well to be known as

The Superior Oil Company

(Company or Operator)

Albuquerque - State

(Lease)

Well No. **1-36**, in **P** (Unit) The well is

located **1053** feet from the **South** line and **990** feet from the **East** line of Section **36**, T. **25-N**, R. **7-W**, NMPM.

(GIVE LOCATION FROM SECTION LINE)

Wildcat Pool, **Rio Arriba** County

E-809-A-10

If State Land the Oil and Gas Lease is No.

If patented land the owner is

Address.

We propose to drill well with drilling equipment as follows: **Rotary**

The status of plugging bond is **Active**

Drilling Contractor **Unknown at this time**

We intend to complete this well in the **Pictured Cliffs** formation at an approximate depth of **2400** feet.

CASING PROGRAM

We propose to use the following strings of Casing and to cement them as indicated:

Size of Hole	Size of Casing	Weight per Foot	New or Second Hand	Depth	Sacks Cement
12-1/4"	9-5/8"	32.34	New	250'	Circ. Cement
8-3/4"	7"	20 1/2	New	2400'	150 Sacs

If changes in the above plans become advisable we will notify you immediately.

ADDITIONAL INFORMATION (If recompletion give full details of proposed plan of work.)

Approved.....
Except as follows:

5-13, 1955

Sincerely yours,

THE SUPERIOR OIL COMPANY

(Company or Operator)

By **L. J. Willis** (L. J. Willis)

Position **Petroleum Engineer**

Send Communications regarding well to

Name **Mr. J. E. Roskey**

Address **The Superior Oil Company
Midland, Texas**

OIL CONSERVATION COMMISSION

By **Emory E. Arnold**

Title **Oil and Gas Inspector Dist. #3**

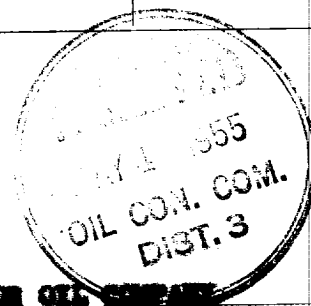

W. W. STUDDERT
MEMBER
AMERICAN SOCIETY OF
CIVIL ENGINEERS

REGISTERED ENGINEERS
& LAND SURVEYORS

ARIZONA
COLORADO
IDAHO
LOUISIANA
MONTANA
NEVADA
NEW MEXICO
OKLAHOMA
TEXAS
UTAH
WYOMING

STUDDERT ENGINEERING CO.

CIVIL ENGINEERS

TELEPHONES 4-8682 & 2-1373

221 SOUTH COLORADO
MIDLAND, TEXAS

26 25
35 36
COR. ESTABLISHED

THE SUPERIOR OIL CO.

30
31
COR. ESTABLISHED

SECTION 36, T-25-N, R-7-W
RIO ARriba COUNTY, NEW MEXICO

RECEIVED
APR 12 1955
U. S. GEOLOGICAL SURVEY
FARMINGTON, NEW MEXICO

SCALE 1" = 1000'

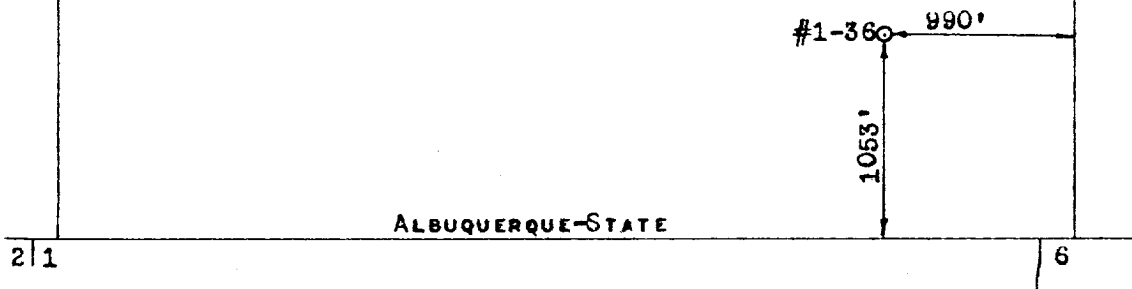

I, EARL K. MONTEITH, REGISTERED LAND SURVEYOR, STATE OF NEW MEXICO, HEREBY CERTIFY THAT THIS WELL LOCATION: SUPERIOR-ALBUQUERQUE-STATE #1-36, 990' FROM THE EAST LINE AND 1053' FROM THE SOUTH LINE, SECTION 36, T-25-N, R-7-W, RIO ARriba COUNTY, NEW MEXICO, WAS STAKED ON THE GROUND UNDER MY SUPERVISION AND THAT THIS PLAT IS TRUE AND CORRECT.

APRIL 2, 1955

Earl K. Monteith
EARL K. MONTEITH

OIL CONSERVATION COMMISSION		
AZTEC DISTRICT OFFICE		
No. Copies Received <u>5</u>		
DISTRIBUTION		
	NO. FURNISHED	
Operator	<u>1</u>	
Santa Fe	<u>1</u>	
Proration Office		
State Land Office	<u>1</u>	
U. S. G. S.	<u>1</u>	
Transporter		
File	<u>1</u>	
		<u>5</u>

NEW MEXICO
OIL CONSERVATION COMMISSION

Gas Well Plat

Date May 9, 1955

The Superior Oil Company Albuquerque-State 1-36
Operator Lease Well No.

Name of Producing Formation Pictured Cliffs Pool Canyon Largo

No. Acres Dedicated to the Well 320 ✓ Lease: #X-809-A-10

SECTION 36 TOWNSHIP 25-N RANGE 7-W

RECEIVED
MAY 13 1955
OIL CON. COM.
DIST. 3

X

I hereby certify that the information given above is true and complete to the best of my knowledge.

Name D.V. Prescott D.V. Prescott
Position Division Engineer
Representing The Superior Oil Company
Address Midland, Texas

(over)

INSTRUCTIONS

1. Is this gas well a dual completion? Yes _____ No _____.
2. If the answer to Question 1 is Yes, are there any other dually completed wells within the dedicated acreage?
Yes _____ No _____.

A separate plat must be filed for each gas well, outlining the area dedicated to such well and showing the location of all other wells (oil and gas) within the outlined area.

Mail in duplicate to the district office for the district in which the well is located.

OIL CONSERVATION COMMISSION		
AZTEC DISTRICT OFFICE		
No. Copies Received <u>2</u>		
DISTRIBUTION		
	NO. FURNISHED	
Operator		
Santa Fe	1	
Proration Office		
State Land Office		
U. S. G. S.		
Transporter	1	
File		✓