

NEW MEXICO OIL CONSERVATION COMMISSION
Santa Fe, New Mexico

Form C-101
Revised (12/1/55)

NOTICE OF INTENTION TO DRILL

Notice must be given to the District Office of the Oil Conservation Commission and approval obtained before drilling or recompletion begins. If changes in the proposed plan are considered advisable, a copy of this notice showing such changes will be returned to the sender. Submit this notice in QUINTUPLICATE. One copy will be returned following approval. See additional instructions in Rules and Regulations of the Commission. If State Land submit 6 Copies Attach Form C-128 in triplicate to first 3 copies of form C-101

Farmington, New Mexico
(Place)

June 29, 1961
(Date)

OIL CONSERVATION COMMISSION
SANTA FE, NEW MEXICO

Gentlemen:

You are hereby notified that it is our intention to commence the Drilling of a well to be known as

Othel Development Co.

(Company or Operator)

Othel State
(Lease)

Well No. 1, in A (Unit) The well is

located 290 feet from the North line and 790 feet from the

East line of Section 22, T. 25N, R. 7W, NMPM.

(GIVE LOCATION FROM SECTION LINE)

Bellevue Pool, Rio Arriba County

If State Land the Oil and Gas Lease is No. E-5805 E-6234

If patented land the owner is

Address

We propose to drill well with drilling equipment as follows: Drill & complete with rotary rig.

The status of plugging bond is In effect to cover plugging of well.

Drilling Contractor Drilling & Coring Exploration Co.
1800 Laguna, Farmington, N. M.

We intend to complete this well in the Pictured Cliffs formation at an approximate depth of 2350 feet.

CASING PROGRAM

We propose to use the following strings of Casing and to cement them as indicated:

Size of Hole	Size of Casing	Weight per Foot	New or Second Hand	Depth	Sacks Cement
<u>9"</u>	<u>7"</u>	<u>20 1/2</u>	<u>New</u>	<u>120'</u>	<u>75</u>
<u>6 1/2"</u>				<u>2250</u>	
<u>5"</u>	<u>2 7/8"</u>	<u>8 1/2</u>	<u>New</u>	<u>2350</u>	<u>100</u>

If changes in the above plans become advisable we will notify you immediately.

ADDITIONAL INFORMATION (If recompletion give full details of proposed plan of work.)

Approved 7-3, 1961
Except as follows:

OIL CONSERVATION COMMISSION

By General C. [Signature]

Sincerely yours,

Othel Development Co.
(Company or Operator)

By O. B. Manger

Position Partner Send Communications regarding well to

Name O. B. Manger
Address 668-5th St. Madison Wyo

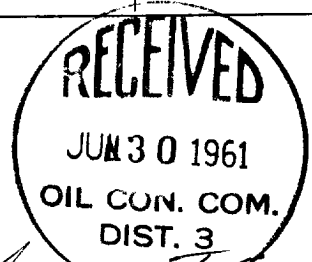

NUMBER OF COPIES RECEIVED	
DISTRIBUTION	
SANTA FE	
FILE	
U.S.G.S.	
LAND OFFICE	
TRANSPORTER	OIL GAS
PRORATON OFFICE	
OPERATOR	

NEW MEXICO OIL CONSERVATION COMMISSION
WELL LOCATION AND ACREAGE DEDICATION PLAT
 SEE INSTRUCTIONS FOR COMPLETING THIS FORM ON THE REVERSE SIDE

FORM C-128
 Revised 5/1/57

SECTION A

Operator OTHEL DEVELOPMENT COMPANY		Lease OTHEL - STATE		Well No. 1
Unit Letter A	Section 32	Township 25 NORTH	Range 7 WEST	County Red Owl
Actual Footage Location of Well: 990 feet from the NORTH line and 790 feet from the EAST line				
Ground Level Elev. 6652.0	Producing Formation Ballard	Pool P.E.	Dedicated Acreage: 160 Acres	

Ref: GLO plat dated 4 November 1882

1. Is the Operator the only owner in the dedicated acreage outlined on the plat below? YES _____ NO _____. ("Owner" means the person who has the right to drill into and to produce from any pool and to appropriate the production either for himself or for himself and another. (65-3-29 (e) NMSA 1935 Comp.)
2. If the answer to question one is "no," have the interests of all the owners been consolidated by communitization agreement or otherwise? YES _____ NO _____. If answer is "yes," Type of Consolidation _____
3. If the answer to question two is "no," list all the owners and their respective interests below:

Owner	Land Description

SECTION B

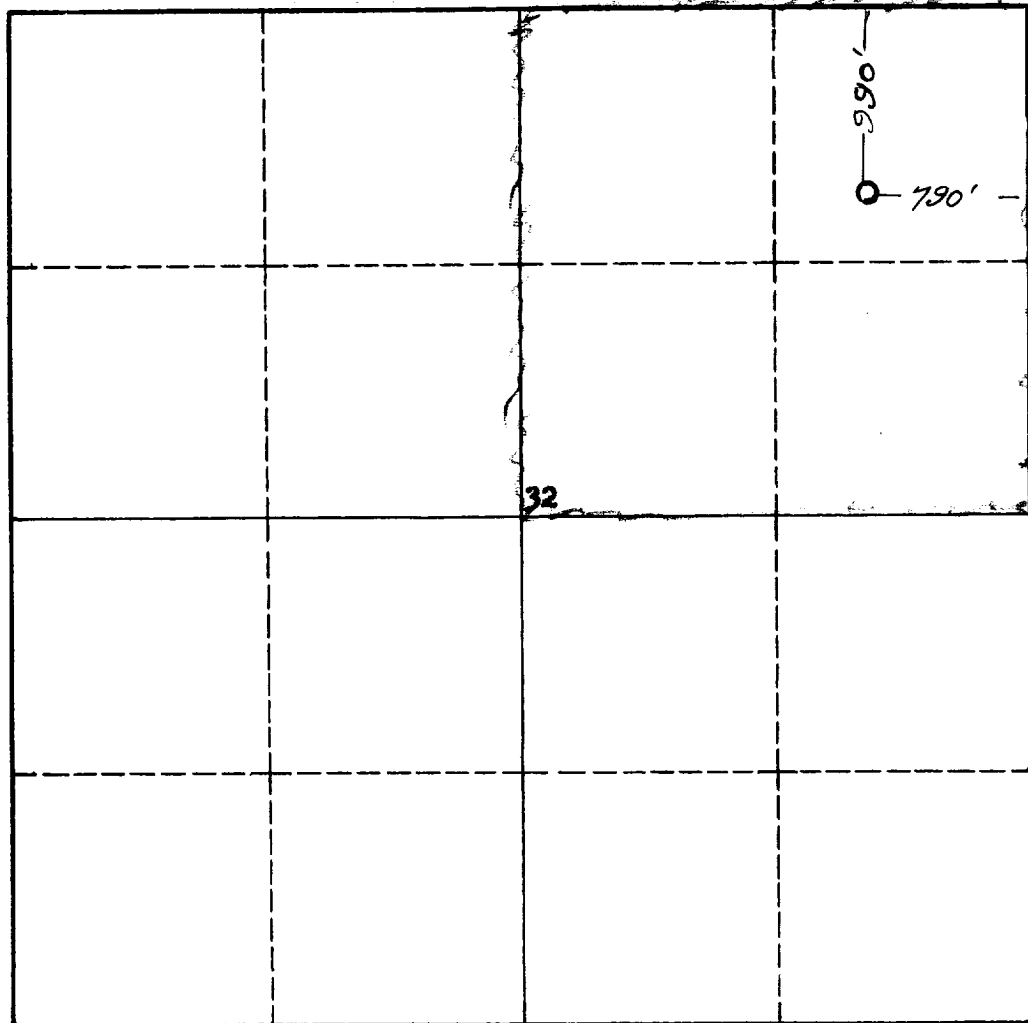

CERTIFICATION

I hereby certify that the information in SECTION A above is true and complete to the best of my knowledge and belief.

Name J. B. Manger
Position Othel Development Co.
Company Operator
Date 6/29/61

RECEIVED

I hereby certify that the well location shown on the plat in SECTION B was plotted from field notes of actual surveys made by me or under my supervision, and that the same is true and correct to the best of my knowledge and belief.

Date Surveyed 27 June 1961
Registered Professional Engineer and/or Land Surveyor James P. Leese
Certificate No. 1463
San Juan Engineering Company

0 330 660 990 1320 1650 1980 2310 2640 2000 1500 1000 500 0

INSTRUCTIONS FOR COMPLETION OF FORM C-128

1. Operator shall furnish and certify to the information called for in Section A.
2. Operator shall outline the dedicated acreage for *both* oil and gas wells on the plat in Section B.
3. A registered professional engineer or land surveyor registered in the State of New Mexico or approved by the Commission shall show on the plat the location of the well and certify this information in the space provided.
4. All distances shown on the plat must be from the outer boundaries of the Section.
5. If additional space is needed for listing owners and their respective interests as required in question 3 of Section A, please use space below.