

(SUBMIT IN TRIPLICATE)

UNITED STATES  
DEPARTMENT OF THE INTERIOR  
GEOLOGICAL SURVEY

Land Office Santa Fe  
Lease No. 079139-A  
Unit \_\_\_\_\_

**ILLEGIBLE**  
SUNDRY NOTICES AND REPORTS ON WELLS  
RECEIVED

NOTICE OF INTENTION TO DRILL	SUBSEQUENT REPORT OF WATER SHUT-OFF
NOTICE OF INTENTION TO CHANGE PLANS	SUBSEQUENT REPORT OF SHOOTING OR ACIDIZING
NOTICE OF INTENTION TO TEST WATER SHUT-OFF	SUBSEQUENT REPORT OF ALTERING CASING
NOTICE OF INTENTION TO RE-DRILL OR REPAIR WELL	SUBSEQUENT REPORT OF RE-DRILLING OR REPAIR
NOTICE OF INTENTION TO SHOOT OR ACIDIZE	SUBSEQUENT REPORT OF ABANDONMENT
NOTICE OF INTENTION TO PULL OR ALTER CASING	SUPPLEMENTARY WELL HISTORY
NOTICE OF INTENTION TO ABANDON WELL	

(INDICATE ABOVE BY CHECK MARK NATURE OF REPORT, NOTICE, OR OTHER DATA)

Well No. Warren-Federal 1-35 / 35 is located 790 ft. from [N] line and 890 ft. from [E] line of sec. 35  
25 North, 6 West RMPN  
11441 (Twp.) (Range) (Meridian)  
Alameda Rio Arriba New Mexico  
(Field) (County or Subdivision) (State or Territory)

The elevation of the derrick floor above sea level is 5753.02 ft.

DETAILS OF WORK

(State names of and expected depths to objective sands; show sizes, weights, and lengths of proposed casings; indicate mudding jobs, cementing points, and all other important proposed work)

We propose to drill with rotary tools, cement 8 5/8 inch surface casing at 300 feet, drill to a depth of approximately 7500 feet and run electrical surveys. If oil or gas production is encountered we propose to set 5 1/2 inch production casing through and perforate the indicated pay zone.

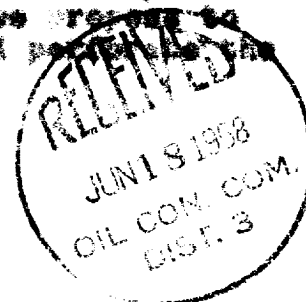

I understand that this plan of work must receive approval in writing by the Geological Survey before operations may be commenced.

Company Ray Minbell  
Address 7114 Central  
Albuquerque, New Mexico

By Ben Doregan  
Geologist  
Title \_\_\_\_\_

NEW MEXICO OIL CONSERVATION COMMISSION

Well Location and Acreage Dedication Plat

Section A.

ILLEGIBLE

Date June 14, 1958

Operator Kay Kimbell

Well No. 1-35 Unit Letter A Section 35 Township 25 North Range 6 West NMPM  
Located 790 Feet From North Line, 890 Feet From East Line  
County Rio Arriba G. L. Elevation 6763 Dedicated Acreage 1.00 Acres  
Name of Producing Formation Sabote test Pool Wildcat

1. Is the Operator the only owner\* in the dedicated acreage outlined on the plat below?  
Yes X No
2. If the answer to question one is "no," have the interests of all the owners been consolidated by communitization agreement or otherwise? Yes        No       . If answer is "yes,"  
Type of Consolidation
3. If the answer to question two is "no," list all the owners and their respective interests below:

Owner

Land Description



RECEIVED  
JUN 17 1958  
U. S. GEOLOGICAL  
FARMINGTON, N.M.

Section. B

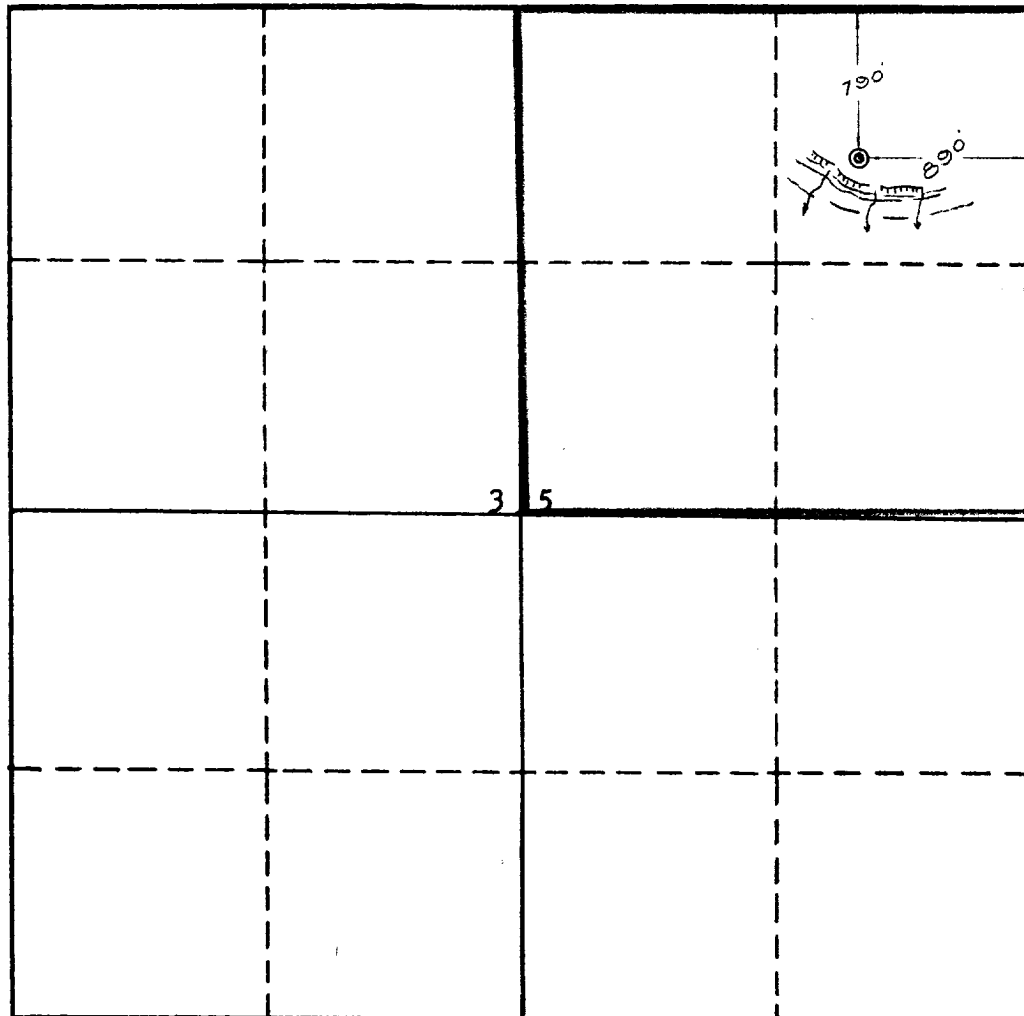

This is to certify that the information in Section A above is true and complete to the best of my knowledge and belief.

Kay Kimbell

(Operator)

Bert Dorgan  
Bert Dorgan (representative)  
7114 Central St

Address

Albuquerque, New Mexico

This is to certify that the well location shown on the plat in Section B was plotted from field notes of actual surveys made by me or under my supervision and that the same is true to the best of my knowledge and belief.

Date Surveyed June 13, 1958

Ernest V. Echohawk  
Ernest V. Echohawk  
Registered Land Surveyor.

Certificate No. 1545