



COPY TO O.C.C.

UNITED STATES  
DEPARTMENT OF THE INTERIOR  
GEOLOGICAL SURVEY  
P. O. Box 965  
Farmington, New Mexico

April 27, 1956

The Superior Oil Company  
Midland, Texas

Re: Santa Fe 078878

Gentlemen:

Receipt is acknowledged of your "Notice of Intention to Drill" dated April 24, 1956 covering your well No. 1-28 Sadler in Sec. 28, T. 25 N., R. 7 W., N. M. P. M., Rio Arriba County, New Mexico, Wildcat pool.

Your proposed work is hereby approved subject to compliance with the provisions of the "Oil and Gas Operating Regulations" revised May 25, 1942, a copy of which will be sent to you on request, and subject to the following conditions:

1. Drilling operations so authorized are subject to the attached sheet for general conditions of approval.
2. Furnish copies of all logs.

Very truly yours,

(Orig. Sgd.) P. T. McGrath

P. T. McGrath  
District Engineer

PTMcGrath:ac



X			

(SUBMIT IN TRIPLICATE)

UNITED STATES  
DEPARTMENT OF THE INTERIOR  
GEOLOGICAL SURVEY

Land Office Santa Fe  
Lease No. 078878  
Unit Canyon Largo

## SUNDRY NOTICES AND REPORTS ON WELLS

NOTICE OF INTENTION TO DRILL.....	<input checked="" type="checkbox"/>	SUBSEQUENT REPORT OF WATER SHUT-OFF.....	
NOTICE OF INTENTION TO CHANGE PLANS.....		SUBSEQUENT REPORT OF SHOOTING OR ACIDIZING.....	
NOTICE OF INTENTION TO TEST WATER SHUT-OFF.....		SUBSEQUENT REPORT OF ALTERING CASING.....	
NOTICE OF INTENTION TO RE-DRILL OR REPAIR WELL.....		SUBSEQUENT REPORT OF RE-DRILLING OR REPAIR.....	
NOTICE OF INTENTION TO SHOOT OR ACIDIZE.....		SUBSEQUENT REPORT OF ABANDONMENT.....	
NOTICE OF INTENTION TO PULL OR ALTER CASING.....		SUPPLEMENTARY WELL HISTORY.....	
NOTICE OF INTENTION TO ABANDON WELL.....			

(INDICATE ABOVE BY CHECK MARK NATURE OF REPORT, NOTICE, OR OTHER DATA)

SADLER - GOVERNMENT #1-26

April 24, 1956

Well No. 1-26 is located 940 ft. from N line and 1290 ft. from W line of sec. 28

Ru/4, Section 28  
(1/4 Sec. and Sec. No.)

25N  
(Twp.)

7W  
(Range)

10NEM  
(Meridian)

Wildcat  
(Field)

Rio Arriba  
(County or Subdivision)

New Mexico  
(State or Territory)

(Canyon Largo Unit)

The elevation of the derrick floor above sea level is 6663 ft. GL

### DETAILS OF WORK

(State names of and expected depths to objective sands; show sizes, weights, and lengths of proposed casings; indicate mudding jobs, cementing points, and all other important proposed work)

Propose to drill to Pictured Cliffs, or 2800', or Production, whichever is lesser.

Propose to set 8-5/8" Surface casing @ 150' w/100 sax circulated cement

Propose to set 5-1/2" casing @ TD w/125 sax.

I understand that this plan of work must receive approval in writing by the Geological Survey before operations may be commenced.

Company THE SUPERIOR OIL COMPANY

Address MIDLAND, TEXAS

By D. W. Prescott  
Title Division Petroleum Engineer

NEW MEXICO  
OIL CONSERVATION COMMISSION

Form C-128

Well Location and/or Gas Proration Plat

Date April 24, 1956

Operator The Superior Oil Company Lease SADDLER - GOVERNMENT

Well No. 1-28 Section 28 Township 25-N Range 7-W NMPM

Located 1290 Feet From WEST Line, 940 Feet From NORTH Line,

RIO ARRIBA County, New Mexico. G. L. Elevation 6663'

Name of Producing Formation Pictured Cliffs Pool Canyon Largo <sup>P.C. Unit</sup> Dedicated Acreage 160

(Note: All distances must be from outer boundaries of Section)

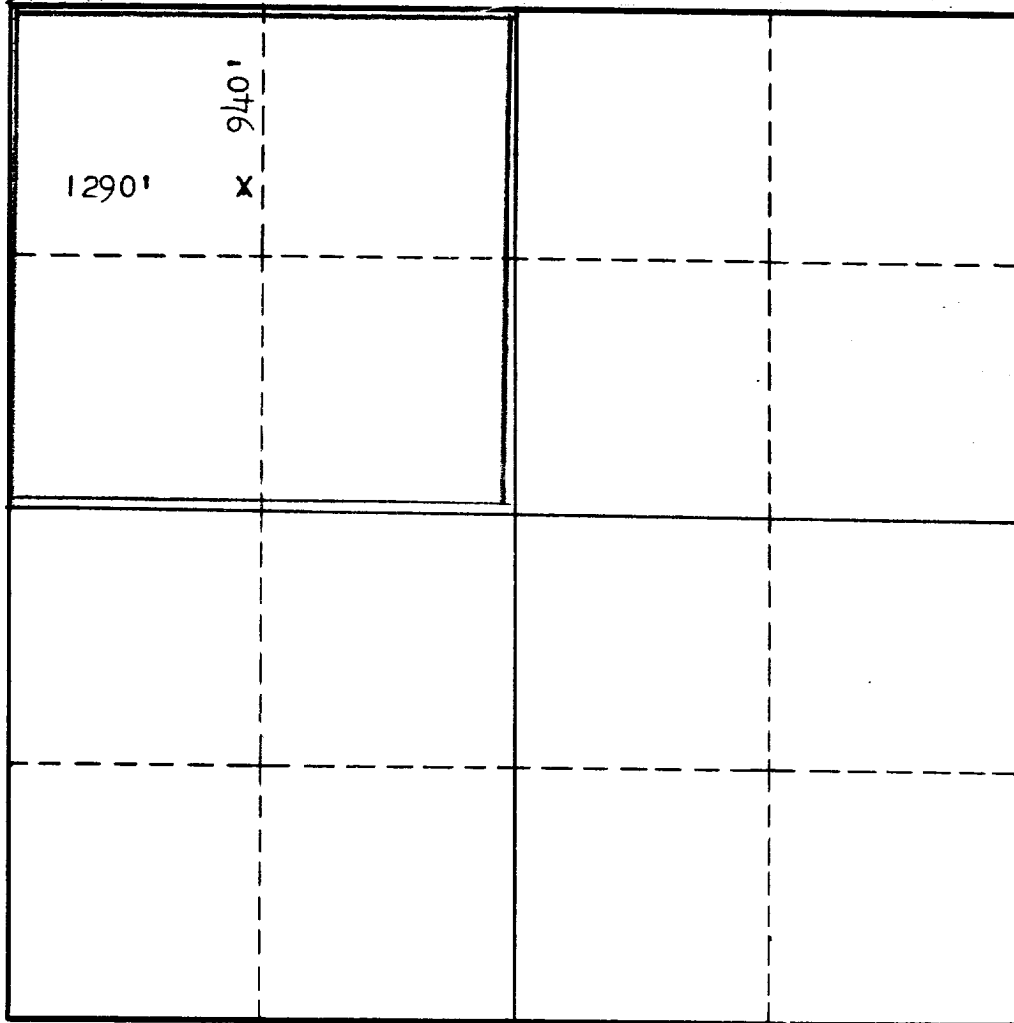

SCALE: 1"=1000'

1. Is this Well a Dual Comp.? Yes    No X.
2. If the answer to Question 1 is yes, are there any other dually completed wells within the dedicated acreage? Yes    No   .

This is to certify that the above plat was prepared from field notes of actual surveys made by me or under my supervision and that the same are true and correct to the best of my knowledge and belief.

Name L. J. Willis (L.J. Willis)  
Position Petroleum Engineer  
Representing The Superior Oil Company  
Address Midland, Texas

Date Surveyed APRIL 22, 1956  
[Signature]  
Registered Professional Engineer and/or  
Land Surveyor