

(SUBMIT IN TRIPLICATE)

UNITED STATES
DEPARTMENT OF THE INTERIOR
GEOLOGICAL SURVEY

Land Office **Santa Fe**
Lease No. **88 070477**
Unit _____

SUNDRY NOTICES AND REPORTS ON WELLS

NOTICE OF INTENTION TO DRILL _____	<input checked="" type="checkbox"/>	SUBSEQUENT REPORT OF WATER SHUT-OFF _____
NOTICE OF INTENTION TO CHANGE PLANS _____		SUBSEQUENT REPORT OF SHOOTING OR ACIDIZING _____
NOTICE OF INTENTION TO TEST WATER SHUT-OFF _____		SUBSEQUENT REPORT OF ALTERING CASING _____
NOTICE OF INTENTION TO RE-DRILL OR REPAIR WELL _____		SUBSEQUENT REPORT OF RE-DRILLING OR REPAIR _____
NOTICE OF INTENTION TO SHOOT OR ACIDIZE _____		SUBSEQUENT REPORT OF ABANDONMENT _____
NOTICE OF INTENTION TO PULL OR ALTER CASING _____		SUPPLEMENTARY WELL HISTORY _____
NOTICE OF INTENTION TO ABANDON WELL _____		

(INDICATE ABOVE BY CHECK MARK NATURE OF REPORT, NOTICE, OR OTHER DATA)

December 4, 1954

Nordhaus-Federal

Well No. **5** is located **1463** ft. from **[N]** line and **1166** ft. from **[E]** line of sec. **19**

SE/4 NE/4 19

(1/4 Sec. and Sec. No.)

25-E

(Twp.)

7-W

(Range)

(Meridian)

Undesignated

(Field)

Rio Arriba

(County or Subdivision)

New Mexico

(State or Territory)

The elevation of the derrick floor above sea level is _____ ft. **6484.22 C.L.**

DETAILS OF WORK

(State names of and expected depths to objective sands; show sizes, weights, and lengths of proposed casings; indicate mudding jobs, cementing points, and all other important proposed work)

Plan to drill and complete in the Pictured Cliffs formation.
Will set 100' 8 5/8" casing with 100 sacks cement; set 5 1/2" 13.30
J-35 now casing at expected TD of 2300' and cement with 100 sacks
cement. Perforate 5 1/2" casing and fracture treat formation with
40,000 gallons of water mixed 1 1/2 pounds of sand to the gallon.
Expected top of Pictured Cliff 2300'.

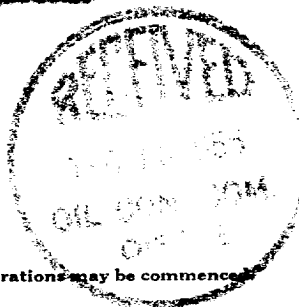

I understand that this plan of work must receive approval in writing by the Geological Survey before operations may be commenced.

Company **WESTERN NATURAL GAS COMPANY**

Address **823 Midland Tower**

Midland, Texas

By

Title

Office Manager

NEW MEXICO
OIL CONSERVATION COMMISSION

WELL LOCATION AND PROSPERATION PLAT

DECEMBER 3, 1956

WESTERN NATURAL GAS CO. ETAL

NORDHAUS FEDERAL

SF 078477

5

19

25 N

7 W

1463

NORTH

1166

EA ST

RIO ARriba

6484.22

PICTURED CLIFF

WILDCAT

160 AC
(1882 PLAT)

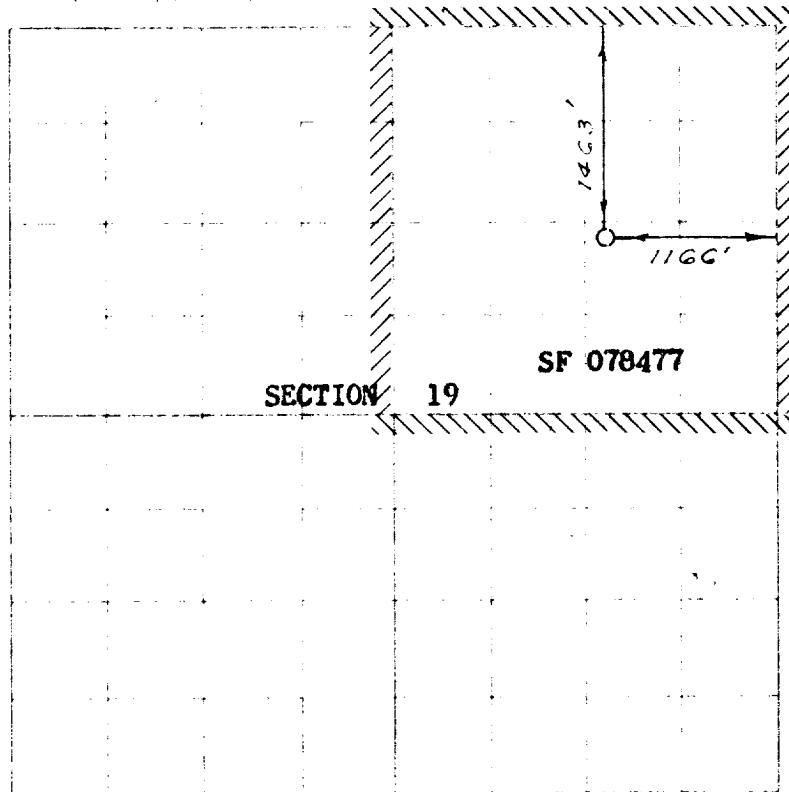

NOTE
This plat is for use
for gas wells only



1. This plat is for use for gas wells only.
2. This plat is for use for gas wells only.
3. This plat is for use for gas wells only.

NOVEMBER 19, 1956
C. O. Walker
County Clerk

1. This well is located only
At the corner of Section 19, Township 25 N, Range 7 W, EA ST, 1463.
2. In the answer to question 1,
is gas there any, and if so, is it
completed with casing and
cemented to bottom?
- At the corner of Section 19, Township 25 N, Range 7 W, EA ST, 1463.
- Not completed with casing and cemented to bottom.
- Position of well is as shown on plat.
- Represented by _____
- At the corner of Section 19, Township 25 N, Range 7 W, EA ST, 1463.