

NEW MEXICO  
OIL CONSERVATION COMMISSION

Form C-128

WELL LOCATION AND/OR GAS PRORATION PLAT

DATE April 15, 1957

OPERATOR THE OHIO OIL COMPANY LEASE JICARILLA

WELL NO. 1 SECTION 33 TOWNSHIP 26 NORTH RANGE 5 WEST NMPM

LOCATED 990 FEET FROM the NORTH LINE 990 FEET FROM the WEST LINE  
RIO ARRIBA COUNTY, NEW MEXICO G.L. ELEVATION 6546.9 UNGRADED

NAME OF PRODUCING FORMATION Pictured Cliffs POOL So. Blanco DEDICATED ACREAGE 160.00

Note: All distances must be from outer boundaries of section.

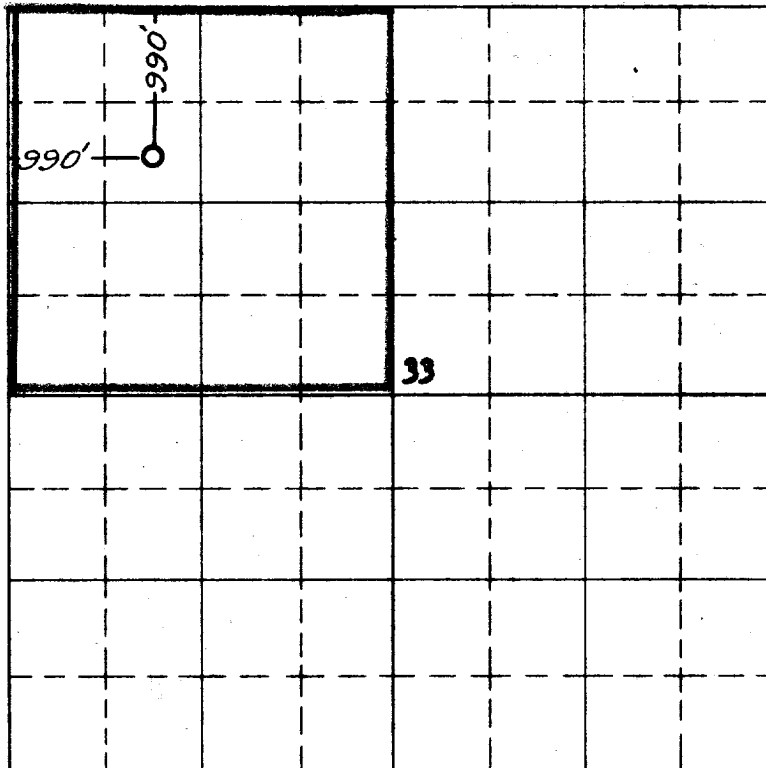

Scale 4 inches equal 1 mile

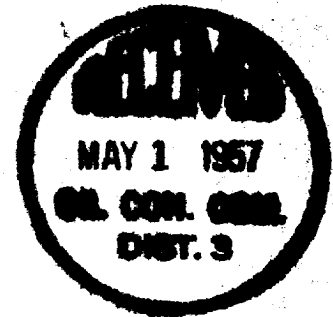

NOTE

This section of  
form is to be used  
- for gas wells only

This is to certify that the above plat was prepared from  
field notes of actual surveys made by me or under my  
supervision and that the same are true and correct to the  
best of my knowledge and belief.

Date Surveyed 9 SEPTEMBER 1955

James P. Leese  
Registered Professional Engineer and/or Land Surveyor  
JAMES P. LEESE  
EX. NO. 1463

1. Is this well a Dual Comp.  
Yes \_\_\_\_\_ No X
2. If the answer to Question 1  
is yes, are there any other dually  
completed wells within the  
dedicated acreage.  
Yes \_\_\_\_\_ No \_\_\_\_\_

Name M. J. Boyce

Position Division Production Sup't

Representing The Ohio Oil Company

Address Box 120, Casper, Wyoming

OIL CONSERVATION COMMISSION		
AZTEC DISTRICT OFFICE		
No. Copies Received		2
DISTRIBUTION		
	NO. FURNISHED	
Operator		
Santa Fe	1	
Protraction Office		
State Land Office		
U. S. G. S.		
Transporter		
File	1	✓