

Form 9-331b
(April 1952)

(SUBMIT IN TRIPLICATE)

Indian Agency _____

UNITED STATES
DEPARTMENT OF THE INTERIOR
GEOLOGICAL SURVEY

Jicarilla Tribal _____

Allottee _____

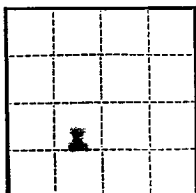
Lease No. Jicarilla Tribal
Contract No. 155

SUNDRY NOTICES AND REPORTS ON WELLS

NOTICE OF INTENTION TO DRILL _____	<input checked="" type="checkbox"/>	SUBSEQUENT REPORT OF WATER SHUT-OFF _____	
NOTICE OF INTENTION TO CHANGE PLANS _____		SUBSEQUENT REPORT OF SHOOTING OR ACIDIZING _____	
NOTICE OF INTENTION TO TEST WATER SHUT-OFF _____		SUBSEQUENT REPORT OF ALTERING CASING _____	
NOTICE OF INTENTION TO REDRILL OR REPAIR WELL _____		SUBSEQUENT REPORT OF REDRILLING OR REPAIR _____	
NOTICE OF INTENTION TO SHOOT OR ACIDIZE _____		SUBSEQUENT REPORT OF ABANDONMENT _____	
NOTICE OF INTENTION TO PULL OR ALTER CASING _____		SUPPLEMENTARY WELL HISTORY _____	
NOTICE OF INTENTION TO ABANDON WELL _____			

(INDICATE ABOVE BY CHECK MARK NATURE OF REPORT, NOTICE, OR OTHER DATA)

Jicarilla Contract 155

Farmington, New Mexico January 13, 1961

Well No. 12 is located 1700 ft. from N line and 1050 ft. from W line of sec. 32T-15N R-15W Section 32
(1/4 Sec. and Sec. No.)T-15N
(Twp.)R-15W
(Range)T-15N R-15W
(Meridian)Basin Lakota Field
(Field)Rio Arriba
(County or Subdivision)New Mexico
(State or Territory)

The elevation of the derrick floor above sea level is _____ ft. (To be reported later)

DETAILS OF WORK

(State names of and expected depths to objective sands; show sizes, weights, and lengths of proposed casings; indicate mudding jobs, cementing points, and all other important proposed work)

We propose to drill Jicarilla Contract 155 No. 12 to an approximate total depth of 7450' with rotary tools to evaluate Lakota prospects. Stimulation and completion will be as indicated upon reaching total depth. The following casing program is proposed:

Size	Depth	Cement
5-7/8"	500'	300 sacks
4-1/2"	7450'	875 sacks

Remarks

Hest - Circulate

Production string will be cemented by

2 - stage method with stage tool set

about 100' below base of Chaco. First stage will have sufficient cement to fill 300-500' above top of Gallup. Second stage will have sufficient cement to fill 300' above top of Pictured Cliffs. A copy of any survey taken will be submitted upon completion of well. Copies of location plat attached.

I understand that this plan of work must receive approval in writing by the Geological Survey before operations may be commenced.

Company Pan American Petroleum Corporation

Address Box 480

Farmington, New Mexico

Attn: L. O. Green, Jr.

By ORIGINAL SIGNED BY
R. M. Bauer, Jr.

Title Senior Petroleum Engineer

NEW MEXICO OIL CONSERVATION COMMISSION

Well Location and Acreage Dedication Plat

Section A.

Date January 10, 1961

Operator PAN AMERICAN PETROLEUM CORPORATION Lease JICARILLA CONTRACT 155
 Well No. 12 Unit Letter K Section 32 Township 26 NORTH Range 5 WEST, NMPM
 Located 1700 Feet From the SOUTH Line. 1850 Feet From the WEST Line
 County RIO ARriba G. L. Elevation To be reported later Dedicated Acreage 320 Acres
 Name of Producing Formation Dakota Pool Basin Dakota

1. Is the Operator the only owner in the dedicated acreage outlined on the plat below?
 Yes X No
2. If the answer to question one is "no", have the interests of all the owners been consolidated by communitization agreement or otherwise? Yes No If answer is "yes", Type of Consolidation.
3. If the answer to question two is "no", list all the owners and their respective interests below:

Owner

Land Description

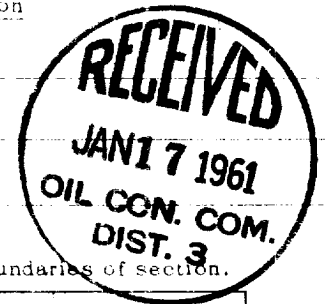

Section B.

Note: All distances must be from outer boundaries of section.

This is to certify that the information in Section A above is true and complete to the best of my knowledge and belief.

Pan American Petroleum Corporation

(Operator)

R. M. Bauer, Jr. *RMB*

(Representative)

Box 480, Farmington, New Mexico
(Address)

Ref: GLO plat dated 4 NOVEMBER 1882

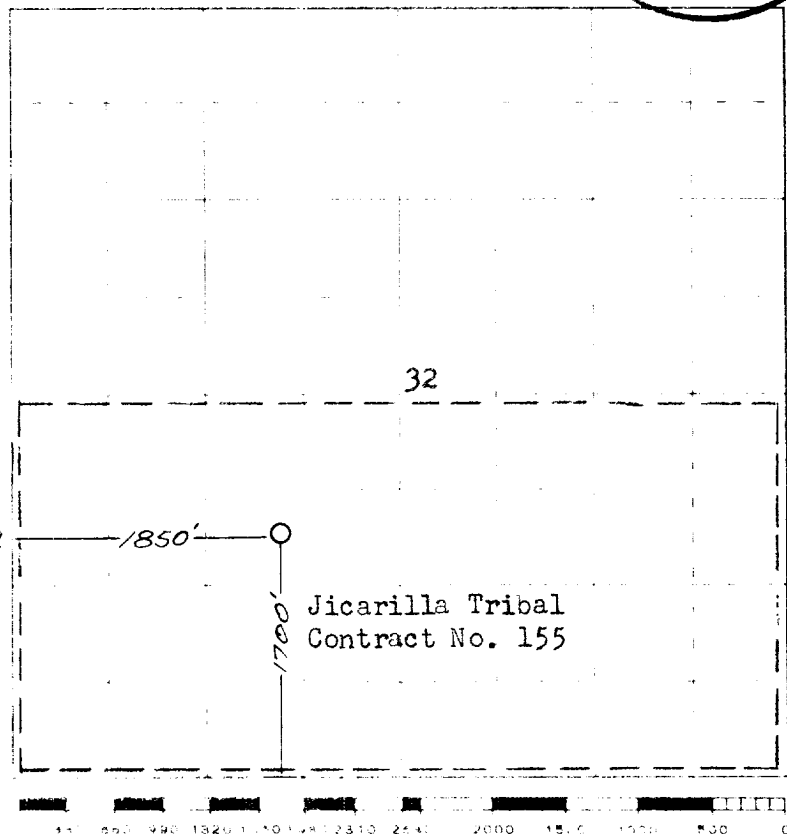

Scale 1 inch equals 1 mile

This is to certify that the above plat was prepared from field notes of actual surveys made by me or under my supervision and that the same are true and correct to the best of my knowledge and belief.

(Seal)

Farmington, New Mexico

Date surveyed 6 January 1961

James P. Leese
 Registered Professional Engineer and/or Land Surveyor
 James P. Leese N. Mex. Reg. No. 1463