

(SUBMIT IN TRIPLICATE)

UNITED STATES
DEPARTMENT OF THE INTERIOR
GEOLOGICAL SURVEY

Land Office Santa Fe
Lease No. 079265
Unit Klein

SUNDRY NOTICES AND REPORTS ON WELLS

NOTICE OF INTENTION TO DRILL.....	<input checked="" type="checkbox"/>	SUBSEQUENT REPORT OF WATER SHUT-OFF.....
NOTICE OF INTENTION TO CHANGE PLANS.....		SUBSEQUENT REPORT OF SHOOTING OR ACIDIZING.....
NOTICE OF INTENTION TO TEST WATER SHUT-OFF.....		SUBSEQUENT REPORT OF ALTERING CASING.....
NOTICE OF INTENTION TO RE-DRILL OR REPAIR WELL.....		SUBSEQUENT REPORT OF RE-DRILLING OR REPAIR.....
NOTICE OF INTENTION TO SHOOT OR ACIDIZE.....		SUBSEQUENT REPORT OF ABANDONMENT.....
NOTICE OF INTENTION TO PULL OR ALTER CASING.....		SUPPLEMENTARY WELL HISTORY.....
NOTICE OF INTENTION TO ABANDON WELL.....		

(INDICATE ABOVE BY CHECK MARK NATURE OF REPORT, NOTICE, OR OTHER DATA)

May 8, 1957

Well No. 6 is located 1750 ft. from SW line and 1750 ft. from W line of sec. 35

SW Section 35

(1/4 Sec. and Sec. No.)

26N

(Twp.)

6W

(Range)

N.M.P.M.

(Meridian)

So. Blanco P.C. Ext.

(Field)

Rio Arriba

(County or Subdivision)

New Mexico

(State or Territory)

The elevation of the derrick floor above sea level is 6337 ft.

DETAILS OF WORK

(State names of and expected depths to objective sands; show sizes, weights, and lengths of proposed casings; indicate mudding, cementing points, and all other important proposed work)

It is intended to drill a well thru the Pictured Cliffs formation using rotary tools and to perforate and water fracture possible producing zones. Estimated Total Depth 2680'.

Casing Program:

9-5/8" at 120' with 125 sacks regular cement circulated to surface.

5-1/2" at 2680' with 75 sacks regular cement, 75 sacks Pozmix.

The SW/4 of Section 35 is dedicated to this well.

SW SP 079265.

I understand that this plan of work must receive approval in writing by the Geological Survey before operations may be commenced.

Company El Paso Natural Gas Company

Address Box 997

Farmington, New Mexico

By Original Signed D. C. Johnson

Title Petroleum Engineer





100-100000-100

NEW MEXICO
OIL CONSERVATION COMMISSION

Form O.C.C. 1

WELL LOCATION AND/OR GAS PRODUCTION PLAT

APRIL 29, 1957

EL PASO NATURAL GAS COMPANY

KLEIN

SF 079265

6

35

26-N

6-W

1750

SOUTH

1750

WEST

RIO ARRIBA

6327

PICTURED CLIFF

SO. BLANCO
P.C. EXTEN.

160 ACRES
(1882 PLAT)

Note: All distances and bearings from water boundaries or sections.

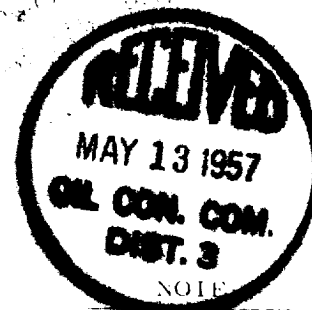
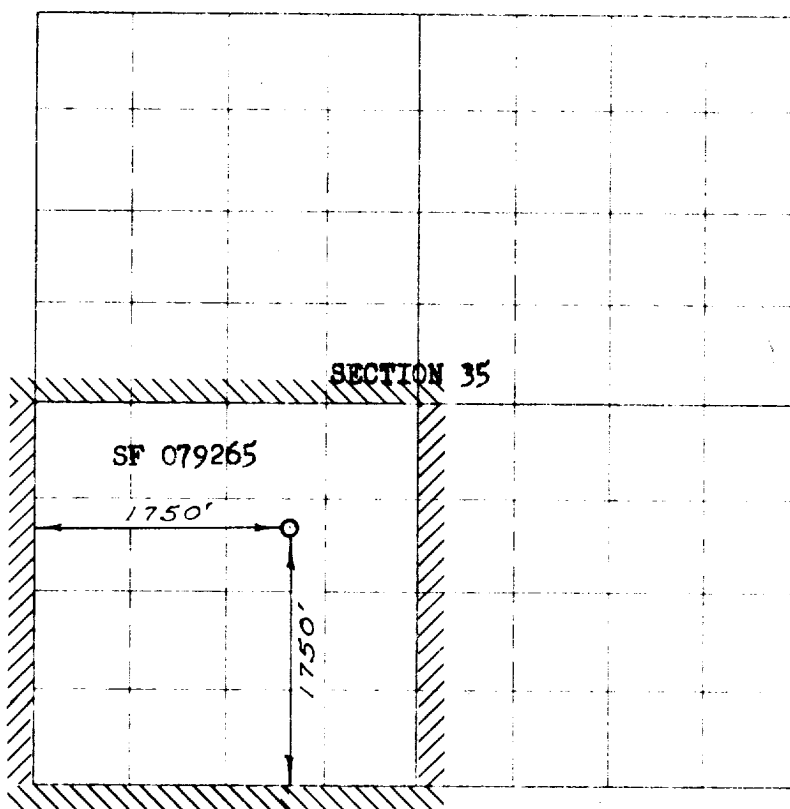

This section of
form is to be used
for gas wells only

I hereby certify that the above plat was prepared from
field notes of actual surveys made by me or under my
supervision and that the same are true and correct to the
best of my knowledge and belief.

Date Surveyed MARCH 13, 1957

C. D. Walker
Registered Professional Engineer and/or Land Surveyor

1. Is this well a Dual Comp.

Yes _____ No X

2. If the answer to Question 1

is yes, are there any other dually
completed wells within the
dedicated acreage.

Yes _____ No _____

Original Signed D. C. Johns on
Name _____

Position Petroleum Engineer

Representing El Paso Natural Gas

Address Box 997, Farmington, N.M.

Scale

Farmington, New Mexico