

NEW MEXICO OIL CONSERVATION COMMISSION  
Santa Fe, New Mexico

Form G-101  
Revised (12/1/55)

NOTICE OF INTENTION TO DRILL

Notice must be given to the District Office of the Oil Conservation Commission and approval obtained before drilling or recompletion begins. If changes in the proposed plan are considered advisable, a copy of this notice showing such changes will be returned to the sender. Submit this notice in QUINTUPPLICATE. One copy will be returned following approval. See additional instructions in Rules and Regulations of the Commission. If State Land submit 6 Copies Attach Form G-128 in triplicate to first 3 copies of form G-101

Farmington, New Mexico

(Place)

April 7, 1961

(Date)

OIL CONSERVATION COMMISSION  
SANTA FE, NEW MEXICO

Gentlemen:

You are hereby notified that it is our intention to commence the Drilling of a well to be known as

Pan American Petroleum Corporation

(Company or Operator)

Jicarilla Gas Unit "B"

(Lease)

Well No. 1

G

(Unit)

The well is

located 1450 feet from the North line and 1850 feet from the

East

line of Section 31, T. 26N, R. 5W, NMPM.

(GIVE LOCATION FROM SECTION LINE)

Basin Dakota

Pool, Rio Arriba

County

If State Land the Oil and Gas Lease is No.

If patented land the owner is First National Bank of Albuquerque Trustee

Address Albuquerque, New Mexico

We propose to drill well with drilling equipment as follows: Rotary tools to total depth

The status of plugging bond is State wide.

Drilling Contractor Brannon and Murray Drilling Company  
Box 672

Coleman, Texas

We intend to complete this well in the Dakota

formation at an approximate depth of 7300

CASING PROGRAM

We propose to use the following strings of Casing and to cement them as indicated:

Size of Hole	Size of Casing	Weight per Foot	New or Second Hand	Depth	Sacks Cement
12-1/4"	8-5/8"	20#	New	500	400
7-7/8"	4-1/2"	9.5#	New	7400	875

If changes in the above plans become advisable we will notify you immediately.

ADDITIONAL INFORMATION (If recompletion give full details of proposed plan of work.)

Oil String Casing to be two staged. First stage 500 sacks 6 percent gel with 1-1/2 pounds tuf plug per sack. Second stage 375 sacks 6 percent gel cement. Two stage tool to be set 100 feet below base of Pictured Cliffs or Chacra.

Approved 4-10, 1961  
Except as follows:

Sincerely yours,

Pan American Petroleum Corporation

(Company or Operator)

By R. M. Bauer, Jr.

Position Senior Petroleum Engineer

Send Communications regarding well to

Name Pan American Petroleum Corporation

Address Box 480, Farmington, New Mexico

Attn: L. O. Spear, Jr.

OIL CONSERVATION COMMISSION

By

## NEW MEXICO OIL CONSERVATION COMMISSION

## Well Location and Acreage Dedication Plat

Section A.

Date March 27, 1961

Operator PAN AMERICAN PETROLEUM CORPORATION Lease JICARILLA GAS UNIT "B"  
 Well No. 1 Unit Letter G Section 31 Township 26 NORTH Range 5 WEST, NMPM  
 Located 1450 Feet From the NORTH Line, 1850 Feet From the EAST Line  
 County RIO ARriba G. L. Elevation To report later Dedicated Acreage 319.40 Acres  
 Name of Producing Formation Dakota Pool Basin Dakota

1. Is the Operator the only owner in the dedicated acreage outlined on the plat below?  
 Yes X No \_\_\_\_\_
2. If the answer to question one is "no", have the interests of all the owners been consolidated by communitization agreement or otherwise? Yes \_\_\_\_\_ No \_\_\_\_\_. If answer is "yes", Type of Consolidation \_\_\_\_\_
3. If the answer to question two is "no", list all the owners and their respective interests below:

Owner

Land Description



Section B.

Note: All distances must be from outer boundaries of section.

This is to certify that the information in Section A above is true and complete to the best of my knowledge and belief.

Pan American Petroleum Corporation

(Operator)

R. M. Bauer, Jr. *R. M. Bauer Jr.*

(Representative)

Box 480, Farmington, New Mexico

(Address)

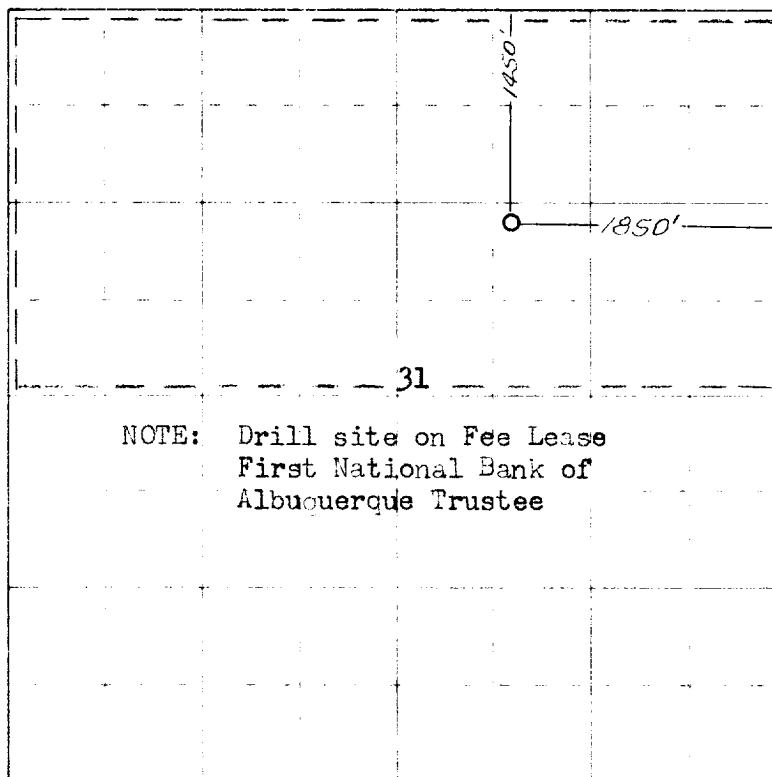

0 330 660 990 1320 1650 1980 2310 2640 2000 1500 1000 500 0

Scale 4 inches equal 1 mile

Ref: GLO plat dated 4 November 1882

(Seal) \_\_\_\_\_ is to certify that the above plat was prepared from field notes of actual surveys by me or under my supervision and that the same are true and correct to the best of my knowledge and belief.

(Seal)

Farmington, New Mexico

Date Surveyed 24 March 1961

*James P. Leese*  
 Registered Professional Engineer and/or Land Surveyor  
 James P. Leese N. Mex. Reg. No. 1463