

(SUBMIT IN TRIPLICATE)

Land Office \_\_\_\_\_  
Lease No. 111 01 06  
Unit Gardner

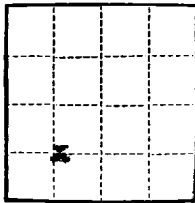

UNITED STATES  
DEPARTMENT OF THE INTERIOR  
GEOLOGICAL SURVEY

SUNDRY NOTICES AND REPORTS ON WELLS

NOTICE OF INTENTION TO DRILL	<input checked="" type="checkbox"/>	SUBSEQUENT REPORT OF WATER SHUT-OFF	
NOTICE OF INTENTION TO CHANGE PLANS		SUBSEQUENT REPORT OF SHOOTING OR ACIDIZING	
NOTICE OF INTENTION TO TEST WATER SHUT-OFF		SUBSEQUENT REPORT OF ALTERING CASING	
NOTICE OF INTENTION TO RE-DRILL OR REPAIR WELL		SUBSEQUENT REPORT OF RE-DRILLING OR REPAIR	
NOTICE OF INTENTION TO SHOOT OR ACIDIZE		SUBSEQUENT REPORT OF ABANDONMENT	
NOTICE OF INTENTION TO PULL OR ALTER CASING		SUPPLEMENTARY WELL HISTORY	
NOTICE OF INTENTION TO ABANDON WELL			

(INDICATE ABOVE BY CHECK MARK NATURE OF REPORT, NOTICE, OR OTHER DATA)

October 10, 1960

Well No. 1 is located 150 ft. from N line and 100 ft. from E line of sec. 29

8-10-20 (Twp.) 2 (Range) 111 (Meridian)  
111 (Field) 111 (County or Subdivision) 111 (State or Territory)

The elevation of the derrick floor above sea level is 7190 ft.

DETAILS OF WORK

(State names of and expected depths to objective sands; show sizes, weights, and lengths of proposed casings; indicate mudding jobs, cementing points, and all other important proposed work)

Set a 5/8" surface casing at 100' with 75 lbs. c. Drill  
6 3/4" hole to approximately 1200'. Run 1200' of  
casing to log and set 4 1/2", 9.5 lb., J-55 casing to total depth.  
Perforate casing opposite fractured cliffs sand with 2/ft.  
Fr c fractured cliffs with approx. 20,000 gals. water and  
20,000 sand. Sub 11 ft.



I understand that this plan of work must receive approval in writing by the Geological Survey before operations may be commenced.

Company John A. Egan

Address XXXXXX P. O. Box 208

Edlington, Mo. Mexico

By John A. Egan

Title \_\_\_\_\_

NUMBER	SECTION
DATE	
FILE	
U.S.S.	
LAND OFFICE	
TRANSPORTER	OIL
OPERATION	WAS
OPERATOR	

# **NEW MEXICO OIL CONSERVATION COMMISSION** **WELL LOCATION AND ACREAGE DEDICATION FORM** SEE INSTRUCTIONS FOR COMPLETING THIS FORM ON THE REVERSE SIDE

## **SECTION A**

Operator <b>John A. Egan</b> <b>MOUNTAIN STATES PETROLEUM CORPORATION</b>	Lease <b>Gardner</b>
Unit Letter <b>J</b>	Section <b>29</b>
Township <b>26 NORTH</b>	Range <b>2 WEST</b>
County <b>HIO. ARIZONA</b>	

Actual Proposed Location of Well: **1850** feet from the **SOUTH** line and **1800** feet from the **EAST** line

Ground Level Elev. <b>5600.0</b>	Producing Formation	Pool	Bottom
-------------------------------------	---------------------	------	--------

**Ref: GLO plat dated 3 August 1918**

1. Is the Operator the only owner in the dedicated acreage outlined on the plat below? YES ☐ NO ☐ ("Owner" means one who has the right to drill into and to produce from any pool and to appropriate the production either for himself or for another. (69-3-29 (c) NMSA 1935 Comp.)
2. If the answer to question one is "no," have the interests of all the owners been consolidated by contract or otherwise? YES ☐ NO ☐ . If answer is "yes," Type of Consolidation \_\_\_\_\_
3. If the answer to question two is "no," list all the owners and their respective interests below:

Owner	Land Description

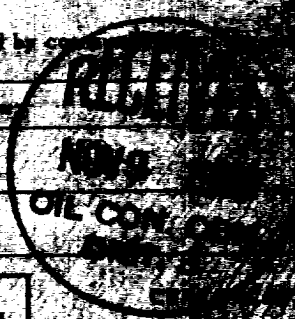

## **SECTION B**

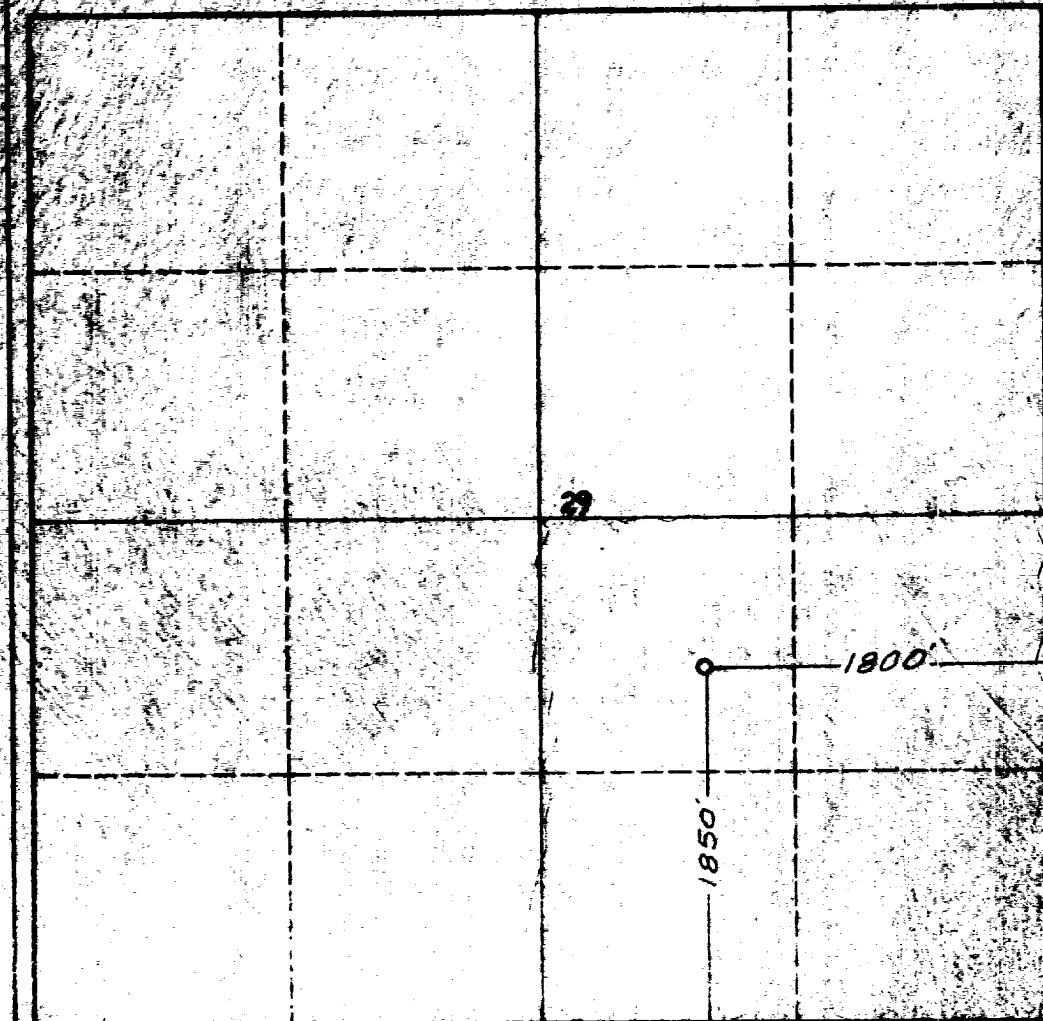

I hereby certify that the location shown on this plat is in accordance with the plat to the best of my belief.

Name <b>John A. Egan</b>
Position
Company
Date <b>10/2/20</b>

I hereby certify that the location shown on this plat is in accordance with the plat to the best of my belief.

Date <b>29 August 1920</b>
Registered Surveyor and/or Land Surveyor <b>John A. Egan</b>
Commissioner <b>John A. Egan</b>

