

OK
BJ696

SUBMIT 1 COPY TO

NATURAL RESOURCE DEPT

AND OIL & GAS ADMINISTRATION

RECEIVED
AUG 27 1999

AUG 27 1999

OIL CON. DIR.
DICE

(505) 923-9200

Land Type: RANGE

Direction from reference: 83 Degrees X East of North X
West of South _____

RANKING SCORE (TOTAL POINTS): 0

B1696 Blow PIT

Date Remediation Started: _____ Date Completed: 12/1/98

Remediation Method: Excavation ☒ Approx. cubic yards 20
(Check all appropriate sections) Landfarmed ☒ Insitu Bioremediation _____
Other _____

Remediation Location: Onsite ☒ Offsite _____
(i.e. landfarmed onsite, name and location of offsite facility)

General Description of Remedial Action: Excavation. ENTIRE EXCAVATION CONSISTED OF BEDROCK, THEREFORE NO TPH ANALYSIS WAS CONDUCTED.

Groundwater Encountered: No ☒ Yes _____ Depth _____

Final Pit: Sample location see Attached Documents

Closure Sampling: (if multiple samples, attach sample results and diagram of sample locations and depths)

Sample depth 3' (PIT BOTTOM)

Sample date 12/1/98 Sample time 1010

Sample Results

Soil: Benzene	(ppm) _____	Water: Benzene	(ppb) _____
Total BTEX	(ppm) _____	Toluene	(ppb) _____
Field Headspace	(ppm) <u>0.0</u>	Ethylbenzene	(ppb) _____
TPH	(ppm) <u>NA</u>	Total Xylenes	(ppb) _____

Groundwater Sample: Yes _____ No ☒ (If yes, attach sample results)

I HEREBY CERTIFY THAT THE INFORMATION ABOVE IS TRUE AND COMPLETE TO THE BEST OF MY KNOWLEDGE AND BELIEF

DATE 12/1/98 PRINTED NAME Buddy D. Shaw

SIGNATURE Buddy D. Shaw AND TITLE Environmental Coordinator

AFTER REVIEW OF THE PIT CLOSURE INFORMATION, PIT CLOSURE IS APPROVED IN ACCORDANCE TO THE JICARILLA APACHE TRIBE PIT CLOSURE ORDINANCE.

APPROVED: YES ☒ NO _____ (REASON) _____

SIGNED: Ken C Mammell DATE: 12-28-98

06288

CLIENT: <u>AMOCO</u>	BLAGG ENGINEERING, INC. P.O. BOX 87, BLOOMFIELD, NM 87413 (505) 632-1199	LOCATION NO: <u>8J696</u> C.O.C. NO: _____
----------------------	--	---

FIELD REPORT: CLOSURE VERIFICATION	PAGE No: <u>1</u> of <u>1</u>
---	-------------------------------

LOCATION: NAME: <u>JICA CONTR. 155</u> WELL #: <u>10</u> PIT: <u>BLOW</u> QUAD/UNIT: <u>M SEC: 30 TWP: 26N RNG: 5W PM: NM CNTY: RA ST: NM</u> QTR/FOOTAGE: <u>SW/4 SW/4</u> CONTRACTOR: <u>P+S</u>	DATE STARTED: <u>12/1/98</u> DATE FINISHED: _____ ENVIRONMENTAL SPECIALIST: <u>NV</u>
--	---

EXCAVATION APPROX. <u>22</u> FT. x <u>19</u> FT. x <u>3</u> FT. DEEP. CUBIC YARDAGE: <u>26</u>	DISPOSAL FACILITY: <u>ON-SITE</u> REMEDIATION METHOD: <u>LANDFARM</u> LAND USE: <u>RANGE</u> LEASE: <u>JICA 155</u> FORMATION: <u>PC</u>
--	---

FIELD NOTES & REMARKS:	PIT LOCATED APPROXIMATELY <u>155</u> FT. <u>N83E</u> FROM WELLHEAD. DEPTH TO GROUNDWATER: <u>>100'</u> NEAREST WATER SOURCE: <u>>1000'</u> NEAREST SURFACE WATER: <u>>1000'</u> NMDCD RANKING SCORE: <u>0</u> NMDCD TPH CLOSURE STD: <u>5000</u> PPM SOIL AND EXCAVATION DESCRIPTION:
------------------------	---

CHECK ONE:
☒ PIT ABANDONED
☐ STEEL TANK INSTALLED
☐ FIBERGLASS TANK INSTALLED

ENTIRE EXCAVATION CONSISTED OF BEDROCK (SANDSTONE), VERY PALE TO MOD. YELL. ORANGE IN COLOR, VERY HARD, NO APPARENT STAINING OBSERVED, NO APPARENT HC DOOR w/in EXCAVATION OR IN ANY OF THE OVM SAMPLES, ALL SAMPLES COLLECTED FROM BEDROCK, THEREFORE NO TPH ANALYSIS WAS CONDUCTED.

ENTIRE EXCAVATION BEDROCK

CLOSED

SCALE

0 FT

FIELD 418.1 CALCULATIONS

TIME	SAMPLE I.D.	LAB No:	WEIGHT (g)	mL. FREON	DILUTION	READING	CALC. ppm
1010							

PIT PERIMETER

PIT PROFILE

OVM RESULTS

SAMPLE ID	FIELD HEADSPACE PID (ppm)
1 @ 1 1/2'	2.0
2 @ 1 1/2'	0.0
3 @ 1 1/2'	0.0
4 @ 1 1/2'	0.0
5 @ 3'	0.0

LAB SAMPLES

SAMPLE ID	ANALYSIS	TIME

TRAVEL NOTES:	CALLOUT: _____
ONSITE: _____	

**JICARILLA APACHE TRIBE
ENVIRONMENTAL PROTECTION OFFICE
P.O. BOX 507
DULCE, NEW MEXICO 87528**

SUBMIT 1 COPY TO
NATURAL RESOURCE DEPT
AND OIL & GAS ADMINISTRATION

ON-SITE SOIL REMEDIATION REPORT

Operator: <u>AMOCO PRODUCTION COMPANY</u>		Telephone: <u>(505) 326-9200</u>	
Address: <u>200 Amoco Court, Farmington, NM 87401</u>			
Facility or Well Name: <u>JICARILLA CONTRACT 155-10</u>			
Location: Unit or Qtr/Qtr Sec <u>M</u> Sec <u>30</u> T <u>24N</u> R <u>5W</u> County <u>BLA AIRIBA</u>			
Land Type: <u>RANGE</u>			
Date Remediation Started: <u>12-1-98</u>		Date Completed: <u>6/8/99</u>	
Remediation Method: Landfarmed <input checked="" type="checkbox"/>		Approx. cubic yards <u>850</u>	
Composted <input type="checkbox"/>			
Other <input type="checkbox"/>			
Depth To Groundwater: (pts.) <u>0</u>		Final Closure Sampling: Sampling Date: <u>6-7-99</u> Time: <u>1245</u> Sample Results: Field Headspace (ppm) <u>97.6</u> TPH (ppm) <u>489</u> Method <u>TPH (8015)</u> Other _____	
Distance to an Ephemeral Stream (pts.) <u>0</u>			
Distance to Nearest Lake, Playa, or Watering Pond (pts.) <u>0</u>			
Wellhead Protection Area: (pts.) <u>0</u>			
Distance To Surface Water: (pts.) <u>0</u>			
RANKING SCORE (TOTAL POINTS): <u>0</u>			
I HEREBY CERTIFY THAT THE INFORMATION ABOVE IS TRUE AND COMPLETE TO THE BEST OF MY KNOWLEDGE AND BELIEF DATE <u>6/8/99</u> PRINTED NAME <u>Buddy D. Shaw</u> SIGNATURE <u>Buddy D. Shaw</u> AND TITLE <u>Environmental Coordinator</u>			
AFTER REVIEW OF THE SOIL REMEDIATION INFORMATION, ON-SITE REMEDIATION IS APPROVED IN ACCORDANCE TO THE JICARILLA APACHE TRIBE PIT CLOSURE ORDINANCE. APPROVED: YES <input type="checkbox"/> NO <input type="checkbox"/> (REASON) _____ _____ SIGNED: _____ DATE: _____			

CLIENT: <u>AMOCO</u>	BLAGG ENGINEERING, INC. P.O. BOX 87, BLOOMFIELD, NM 87413 (505) 632-1199	LOCATION NO: <u>83696</u> C.D.C. NO: <u>7066</u>
----------------------	---	---

FIELD REPORT: LANDFARM/COMPOST PILE CLOSURE VERIFICATION

LOCATION:	NAME: <u>SICABILLA</u>	ISS: <u>155</u>	WELL #: <u>10</u>	PITS: <u>SEE NOTE BELOW</u>	DATE STARTED: <u>6.7.99</u>
QUAD/UNIT: <u>M</u> SEC: <u>30</u> TWP: <u>20N</u> RNG: <u>5W</u> PM: <u>NM</u> CNTR: <u>2A</u> ST: <u>NM</u>					DATE FINISHED: _____
QTR/FOOTAGE: <u>SW/4</u> <u>SW/4</u> CONTRACTOR: <u>P+S</u>					ENVIRONMENTAL SPECIALIST: <u>REP</u>

SOIL REMEDIATION:

REMEDIATION SYSTEM: LANDFARM APPROX. CUBIC YARDAGE: 850
 LAND USE: RANGE LIFT DEPTH (ft): 1.5'

FIELD NOTES & REMARKS:

DEPTH TO GROUNDWATER: >100' NEAREST WATER SOURCE: >1000' NEAREST SURFACE WATER: >1000'
 NMOCED RANKING SCORE: 6 NMOCED TPH CLOSURE STD: 5000 PPM

DR. YELLOWISH BROWN SAND, NON COHESIVE, SLIGHTLY MOIST, FIRM.
 SMALL AREA OF STAINING OBSERVED IN LANDFARM AREA #1, AND A LARGE
 AREA OF STAINING OBSERVED IN LANDFARM #3 AREA (SEE SKETCH BELOW)
 H₂S ODOR DETECTED IN SAMPLING PTS. ① + ⑤. SAMPLING DEPTHS RANGE
 FROM 6" - 12". COLLECTED A SPT. COMPOSITE SAMPLE FOR LAB ANALYSIS.

NOTE: SOME SOIL WAS MOVED FROM THE 155.13 M TO THIS LOC.

CLOSED

FIELD 418.1 CALCULATIONS

SAMP. TIME	SAMPLE I.D.	LAB No:	WEIGHT (g)	mL. FREON	DILUTION	READING	CALC. ppm

SKETCH/SAMPLE LOCATIONS

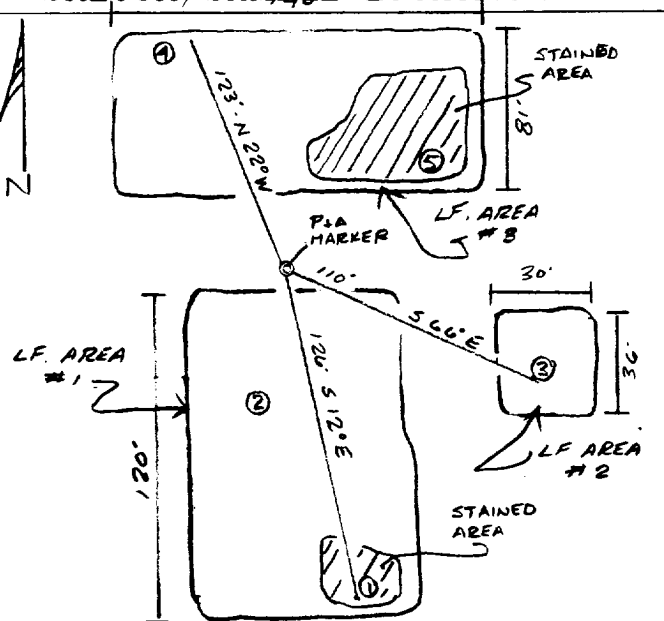

OVM RESULTS

LAB SAMPLES

SAMPLE ID	FIELD HEADSPACE PID (ppm)	SAMPLE ID	ANALYSIS	TIME	RESULTS
LF-1	97.6	LF-1	TPH (80.5)	1245	489

SCALE



TRAVEL NOTES: 115' CALLOUT: NA ONSITE: 6.7.99

ENVIROTECH LABS

PRACTICAL SOLUTIONS FOR A BETTER TOMORROW

EPA METHOD 8015 Modified Nonhalogenated Volatile Organics Total Petroleum Hydrocarbons

Client:	Blagg / AMOCO	Project #:	403410
Sample ID:	LF - 1	Date Reported:	06-08-99
Laboratory Number:	F464	Date Sampled:	06-07-99
Chain of Custody No:	7066	Date Received:	06-08-99
Sample Matrix:	Soil	Date Extracted:	06-08-99
Preservative:	Cool	Date Analyzed:	06-08-99
Condition:	Cool and Intact	Analysis Requested:	8015 TPH

Parameter	Concentration (mg/Kg)	Det. Limit (mg/Kg)
Gasoline Range (C5 - C10)	124	0.2
Diesel Range (C10 - C28)	365	0.1
Total Petroleum Hydrocarbons	489	0.2

ND - Parameter not detected at the stated detection limit.

References: Method 8015B, Nonhalogenated Volatile Organics, Test Methods for Evaluating Solid Waste, SW-846, USEPA, December 1996.

Comments: Jicarilla Contract 155 - 10 Landfarm. 5 Pt. Composite.

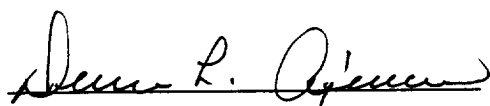
Analyst

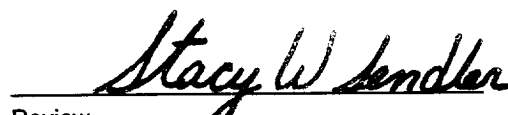
Review

CHAIN OF CUSTODY RECORD

7066

Client / Project Name BLAKE/AMOCO			Project Location LANDFARM			ANALYSIS / PARAMETERS																	
Sampler:			Client No. 403410			No. of Containers TPH (8015)								Remarks									
Sample No./ Identification	Sample Date	Sample Time	Lab Number	Sample Matrix																			
LF-1	6-7-99	1245	F464	SOIL	1	✓										SPR. COMPOSITE							
																SAMPLE PRESERVE							
																COOL							
Relinquished by: (Signature)			Date	Time	Received by: (Signature)										Date	Time							
<i>[Signature]</i>			6-8-99	7:05	<i>[Signature]</i>										6-8-99	7:05							
Relinquished by: (Signature)					Received by: (Signature)																		
Relinquished by: (Signature)					Received by: (Signature)																		
<div style="display: flex; justify-content: space-between; align-items: center;"> <div> <p>ENVIROTECH INC.</p> <p>5796 U.S. Highway 64 Farmington, New Mexico 87401 (505) 632-0615</p> </div> <div> <p>Sample Receipt</p> <table border="1"> <tr> <td>Received Intact</td> <td>Y</td> <td>N</td> <td>N/A</td> </tr> <tr> <td>Cool - Ice/Blue Ice</td> <td>✓</td> <td></td> <td></td> </tr> </table> </div> </div>																Received Intact	Y	N	N/A	Cool - Ice/Blue Ice	✓		
Received Intact	Y	N	N/A																				
Cool - Ice/Blue Ice	✓																						